

Order Plans

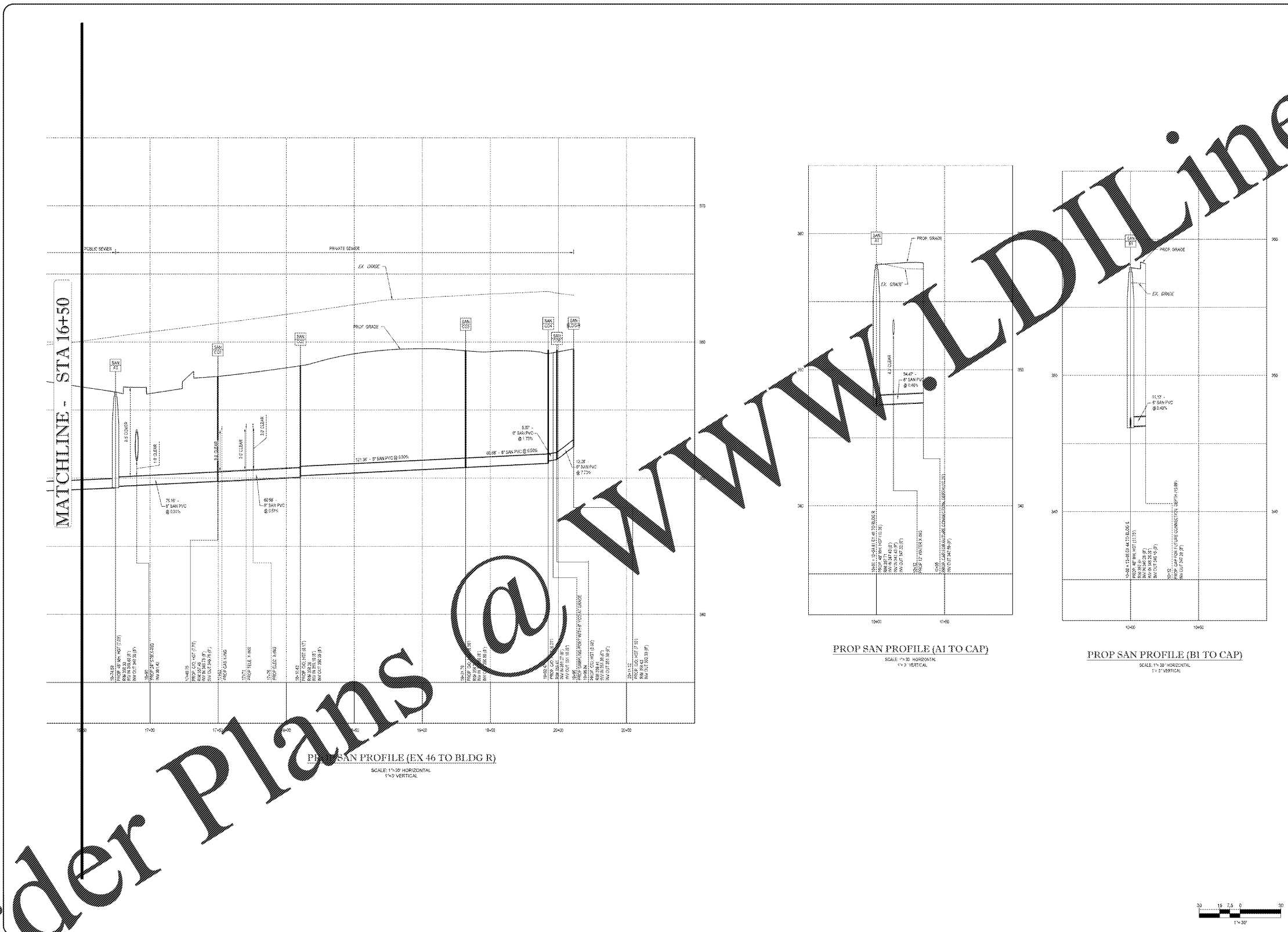

REVISIONS	BY
△ REVISED PER COUNTY AND TOWN COMMENTS	GR
△ REVISED PER COUNTY AND TOWN COMMENTS	GR
△ REVISED PER COUNTY AND TOWN COMMENTS	GR
△	
△	
△	

THE FOLLOWING STATE NOTICE IS REQUIRED BY REGULATORY AGENCIES OF THE COMMONWEALTH OF VIRGINIA TO BE DISPLAYED ON ALL PROJECTS OF PROFESSIONAL ENGINEERS AND ARCHITECTS REGISTERED IN THE STATE OF VIRGINIA. ANY VIOLATION OF THIS NOTICE IS A VIOLATION OF THE PROFESSIONAL ENGINEERING AND ARCHITECTURE ACT OF 1970, AS AMENDED, AND IS A CRIMINAL OFFENSE UNDER THE LAWS OF THE COMMONWEALTH OF VIRGINIA.

BOHLER ENGINEERING
 22636 DAVIS DRIVE, SUITE 260
 STEELING, VIRGINIA 22154
 Phone: (703) 709-6500
 Fax: (703) 709-6501
 VA@BohlerEng.com

SANITARY PROFILES
 WALMART SUPERCENTER #1904-005 - SPAM #1
 CATOCTIN ELECTION DISTRICT
 LEESBURG, LOUDOUN COUNTY, VA
 WAL-MART STORES, INC.
 BENTONVILLE, AR

DRAWN	GR
CHECKED	MJB
DATE	12/22/16
SCALE	AS SHOWN
JOB NO.	S148200
SHEET	C-21

SHEET 24 OF 103

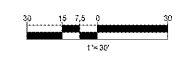

www.DIline.com