

MATCHLINE - SHEET C-12

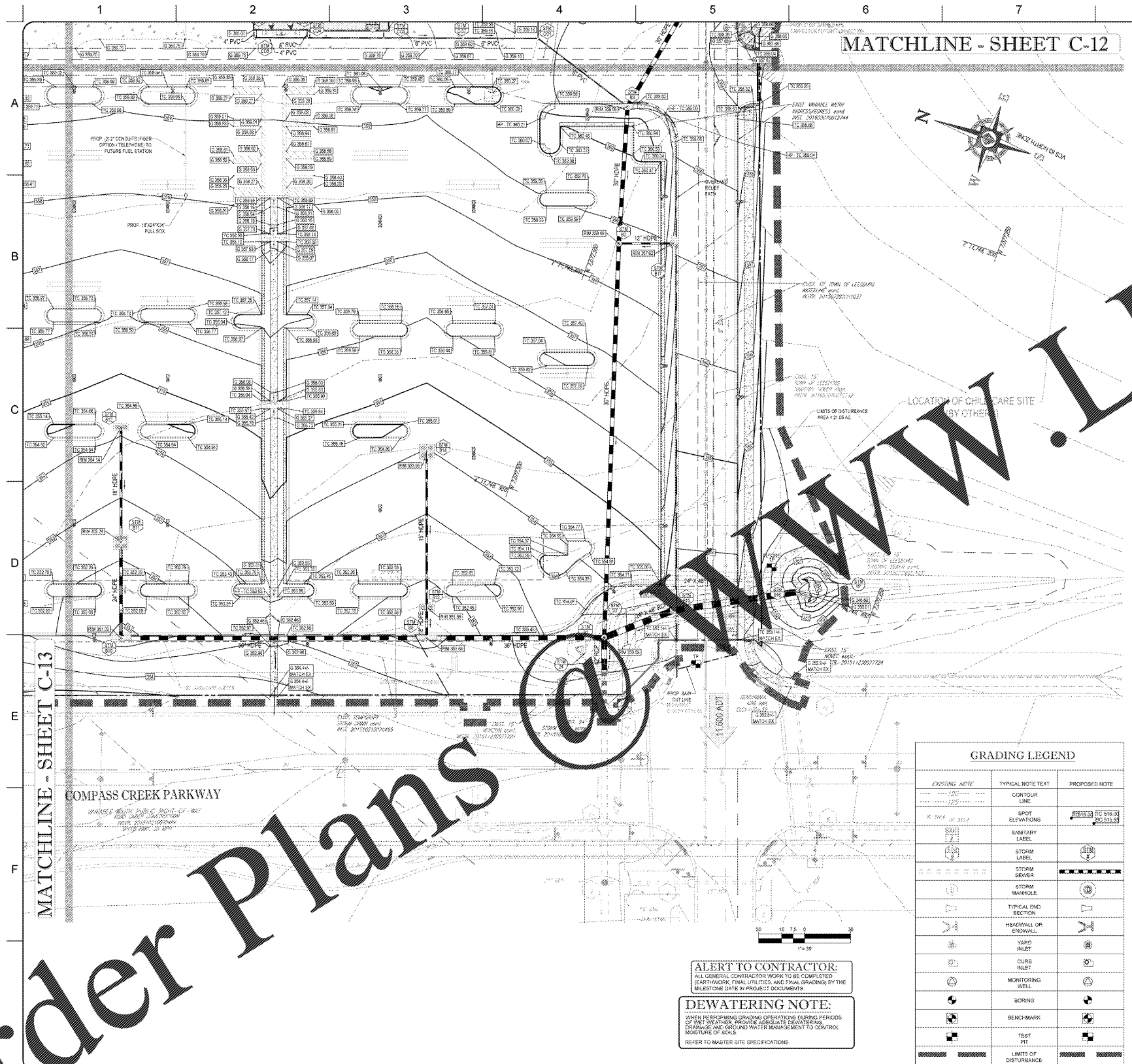

GRADING NOTES

- 1. CONTRACTOR IS RESPONSIBLE FOR DEMOLITION OF EXISTING STRUCTURES INCLUDING REMOVAL OF ANY EXISTING UTILITIES. UTILITIES ARE TO BE REMOVED TO THE RIGHT-OF-WAY...

FOUNDATION SUBSURFACE PREPARATION

UNLESS SPECIFICALLY INDICATED OTHERWISE IN THE DRAWINGS AND/OR SPECIFICATIONS, THE DATE OF THIS SUBSURFACE PREPARATION REPORT IS TO BE THE DATE OF THE REPORT...

GRADING LEGEND

Table with 3 columns: EXISTING NOTE, TYPICAL NOTE TEXT, PROPOSED NOTE. Includes symbols for contours, spot elevations, sanitary labels, storm inlets, etc.

ALERT TO CONTRACTOR: ALL GENERAL CONTRACTOR WORK TO BE COMPLETED (EARTHWORK, FINAL UTILITIES, AND FINAL GRADING) BY THE BUILDING DATE IN PROJECT DOCUMENTS.

DEWATERING NOTE: WHEN PERFORMING GRADING OPERATIONS DURING PERIODS OF THE WETTER MONTHS, ADEQUATE SEWERING, DRAINAGE AND GROUND WATER MANAGEMENT TO CONTROL MOISTURE OF SOILS REFER TO MASTER SITE SPECIFICATIONS.

REVISIONS table with columns for revision number, description, and date.

BOHLER ENGINEERING logo and contact information: 22838 DAVIS DRIVE, SUITE 250, STERLING, VIRGINIA 20164.

GRADING PLAN WALMART SUPERCENTER #1904-005 - SPAM #1 CATAOCHIN ELECTION DISTRICT, VA LEESBURG, LOUDOUN COUNTY, VA WAL-MART STORES, INC. BENTONVILLE, AR

DRAWN: GRP, CHECKED: MJB, DATE: 12/22/16, SCALE: 1" = 30', SHEET: C-14, SHEET 17 OF 103.

Order Plans

Walmart.com watermark