

- SHEET NOTES**
1. FOOD SERVICE EQUIPMENT INSTALLED BY GC UNO ON FIXTURE PLAN, GROCERY FIXTURE PLANS.
 2. LOCATE ALL RACKS LESS THAN 4" DEEP 3" FROM WALLS AND COLUMNS UNLESS NOTED OTHERWISE.
 3. EQUIPMENT LOCATIONS ARE DESIGNED TO MEET HEALTH REQUIREMENTS, OPERATIONS, AND SAFETY COMPLIANCE. ANY CHANGES TO LAYOUT OR EQUIPMENT MUST BE DIRECTED TO THE WALMART DESIGN TEAM.
 4. REFERENCE FR2 FOR FURNISHING SCHEDULE AND EQUIPMENT LEGEND.

RETAIL DESIGN COLLABORATIVE
 Retail Design Collaborative
 11000
 713.333.8854
 rdcollab@live.com

STIPULATION FOR THE USER:
 THE DRAWINGS AND INFORMATION CONTAINED HEREIN ARE THE PROPERTY OF RETAIL DESIGN COLLABORATIVE. ANY REPRODUCTION OR TRANSMISSION OF THIS INFORMATION WITHOUT THE WRITTEN PERMISSION OF RETAIL DESIGN COLLABORATIVE IS STRICTLY PROHIBITED. THIS INFORMATION IS PROVIDED FOR YOUR INFORMATION ONLY AND IS NOT TO BE USED FOR ANY OTHER PURPOSES WITHOUT THE WRITTEN PERMISSION OF RETAIL DESIGN COLLABORATIVE.

CONSULTANTS

Walmart
LEESBURG, VIRGINIA
 STORE NO: 1904-05
 11/04/28 | PROJECT: C-19-LSL-CL
 JOB NUMBER:

ISSUE BLOCK

OTB	11/30/17

CHECKED BY:
 DRAWN BY:
 PROTO CYCLE: 04/28/17
 DOCUMENT DATE: 09/13/17

BID SET NOT FOR CONSTRUCTION

THIS SHEET IS INCLUDED FOR INFORMATIONAL PURPOSES ONLY AND IS NOT TO BE SIGNED

CUSTOMER SERVICE FF AND E (NOT IN PERMIT SET)

SHEET: FR.1.9

WWW.LDILine.com

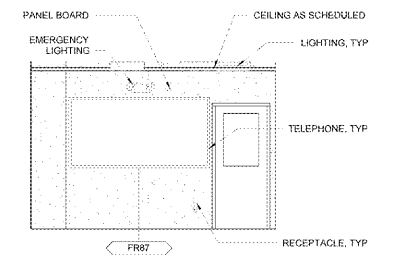

11 ENLARGED UPC/UPS ELEVATION
 1/4" = 1'-0"

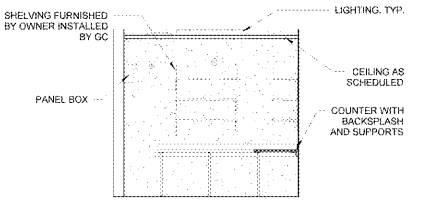

10 ENLARGED AP OFFICE ELEVATION
 1/4" = 1'-0"

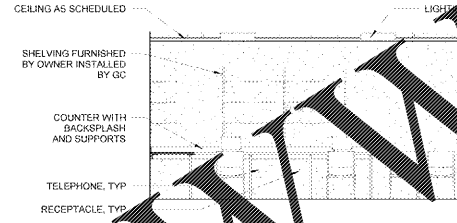

9 ENLARGED AP OFFICE ELEVATION
 1/4" = 1'-0"

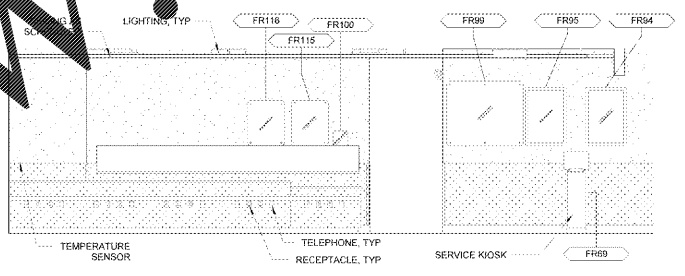

8 ENLARGED CUSTOMER SERVICE ELEVATION
 1/4" = 1'-0"

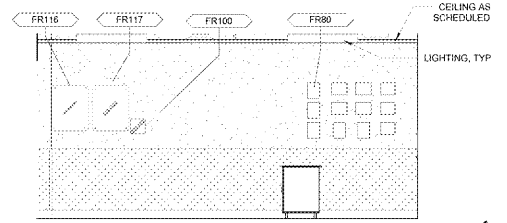

7 ENLARGED CUSTOMER SERVICE ELEVATION
 1/4" = 1'-0"



6 ENLARGED STORE MANAGERS OFFICE ELEVATION
 1/4" = 1'-0"

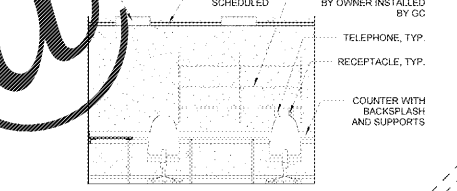

5 ENLARGED STORE MANAGERS OFFICE ELEVATION
 1/4" = 1'-0"

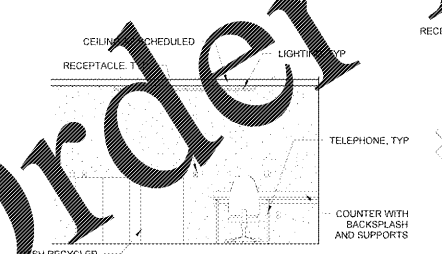

4 ENLARGED COUNTING ELEVATION
 1/4" = 1'-0"

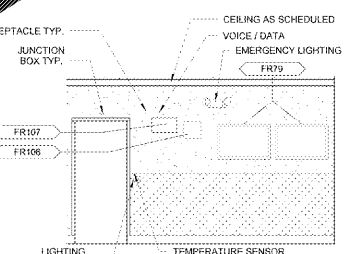

3 ENLARGED CASH ELEVATION
 1/4" = 1'-0"

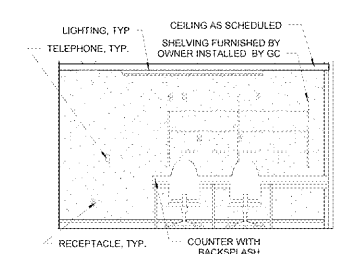

2 ENLARGED CASH ELEVATION
 1/4" = 1'-0"

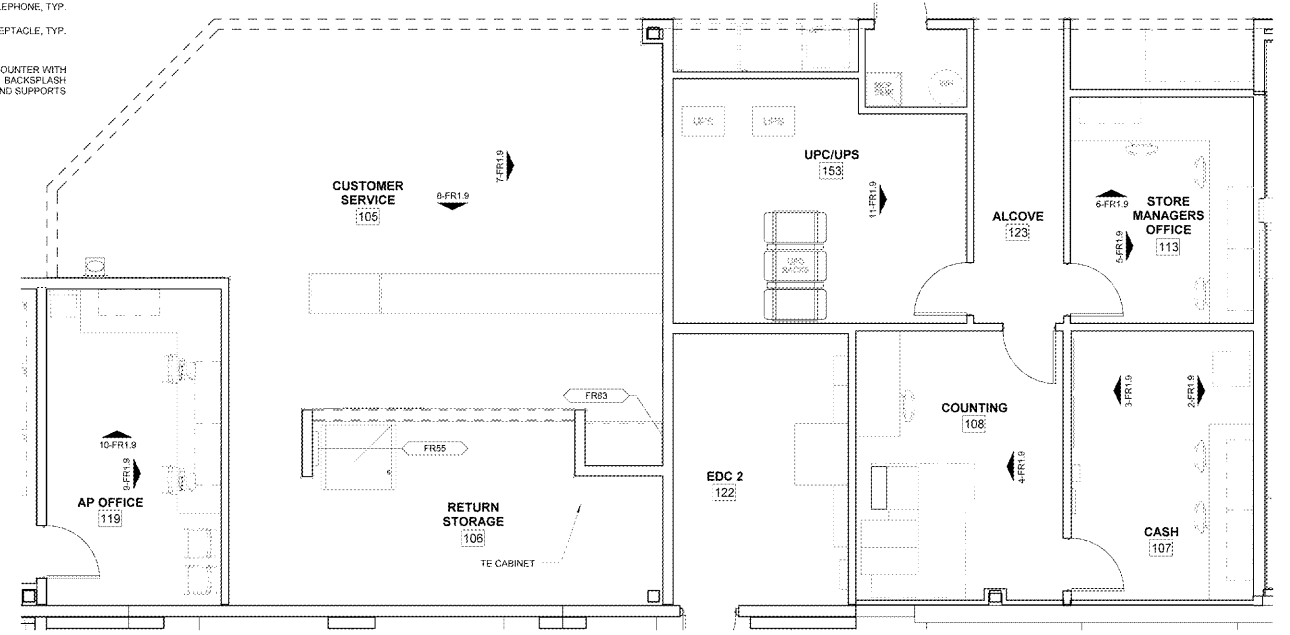

1 ENLARGED CUSTOMER SERVICE PLAN
 1/4" = 1'-0"

Order Plans

© 2017 Retail Design Collaborative