

Order Plans @ [www.WLDLine.com](http://www.WLDLine.com)

### PICKUP CANOPY SPECIAL INSPECTIONS

1. SPECIAL INSPECTION

A. SPECIAL INSPECTIONS ARE REQUIRED FOR THE PICKUP CANOPY TO BE PERFORMED BY THE OWNER'S CONSTRUCTION TESTING LABORATORY (CTL). REFER TO APPENDIX B OF THE PROJECT SPECIFICATIONS FOR THE REQUIREMENTS OF SPECIAL INSPECTIONS.

B. ADDITIONAL INSPECTIONS ARE REQUIRED FOR THE PICKUP CANOPY FOUNDATIONS. THESE SHALL INCLUDE THE STRUCTURAL CONCRETE (03319) INSPECTIONS AND FREQUENCIES LISTED IN APPENDIX B OF THE PROJECT SPECIFICATIONS.

- 1. CONCRETE REINFORCEMENT
- 2. EMBEDDED ITEMS
- 3. CONCRETE FOUNDATIONS STRUCTURAL INSPECTIONS
- 4. CONCRETE MIX
- 5. PREPARATION AND PLACEMENT
- 6. PROTECTION AND CURING

C. REFER TO APPENDIX B OF THE PROJECT SPECIFICATIONS FOR INSPECTOR QUALIFICATIONS AND RESPONSIBILITIES.

### PICKUP CANOPY DESIGN LOADS

1. BUILDING CODE	2012 VIRGINIA REFORM STATE BUILDING CODE (2009)
A. BUILDING CODE	2012 VIRGINIA REFORM STATE BUILDING CODE (2009)
2. GRAVITY LOADS	
B. DEAD LOAD (P <sub>D</sub> )	PER CANOPY MANUF
C. SNOW LOAD (P <sub>S</sub> )	20 PSF (MIN OR SNOW LOAD)
1. GRAVITY LOAD (P <sub>G</sub> )	30 PSF
2. IMPACT LOAD (P <sub>I</sub> )	PER CANOPY MANUF
3. SNOW EXPOSURE FACTOR (C <sub>e</sub> )	PER CANOPY MANUF
4. THERMAL FACTOR (C <sub>t</sub> )	PER CANOPY MANUF
5. EXPOSURE FACTOR (C <sub>d</sub> )	PER CANOPY MANUF
6. COMBINATIONS WITH SNOW LOAD SHALL ALSO INCLUDE WINDS FROM HIGH-LOW ROOF DRIFTING FROM MAIN BUILDING ROOF, PER CODE.	
3. LATERAL LOADS	
A. WIND LOADS	
1. BASIC WIND SPEED (3-SECOND GUST)	120 MPH
- ULTIMATE DESIGN WIND SPEED	80 MPH
- BASIC DESIGN WIND SPEED (SERVICE)	C
2. WIND EXPOSURE CATEGORY	C
3. RISK CATEGORY	PER CANOPY MANUF
B. SEISMIC LOADS	
1. 5% DAMPED MAPPED ACCELERATION PARAMETER (S <sub>s</sub> )	0.124
2. 1-SEC PERIOD MAPPED ACCELERATION PARAMETER (S <sub>1</sub> )	0.052
3. 5% DAMPED SPECTRAL RESPONSE COEFF. (S <sub>s</sub> )	0.132
4. 1-SEC PERIOD SPECTRAL RESPONSE COEFF. (S <sub>1</sub> )	0.083
5. SITE CLASS	D
6. RISK CATEGORY	PER CANOPY MANUF
7. IMPORTANCE FACTOR (I)	PER CANOPY MANUF
8. SEISMIC DESIGN CATEGORY	PER CANOPY MANUF
9. BASIC STRUCTURAL SEISMIC RESPONSE SYSTEM	PER CANOPY MANUF
10. ANALYSIS PROCEDURE	PER CANOPY MANUF
11. SEISMIC RESPONSE COEFFICIENT (C <sub>s</sub> )	PER CANOPY MANUF
12. RESPONSE MODIFICATION FACTOR (R)	PER CANOPY MANUF
13. DESIGN BASE SHEAR (V)	PER CANOPY MANUF

### PICKUP CANOPY GENERAL NOTES

1.0 GENERAL

- 1.1 MANUFACTURER SHALL DESIGN AND SUPPLY ALL CANOPY FRAMING AND SUBSEQUENT CONNECTIONS (INCLUDING BASEPLATES AND ANCHOR BOLTS) TO MEET THE CANOPY DESIGN LOAD CRITERIA SHOWN.
- 1.2 STRUCTURAL DESIGN OF THE CANOPY SHALL BE PERFORMED BY AN ENGINEER LICENSED IN THE PROJECT STATE.
- 1.3 PROFILES ARE SHOWN FOR GRAPHICAL PURPOSES ONLY AND NOT INTENDED TO SUGGEST CONFIGURATION OF PRIMARY MEMBERS.

2.0 FOUNDATIONS AND SUBGRADE

- 2.1 REFER TO GENERAL NOTES SECTION 10 ON SHEET S0 FOR SUBGRADE GENERAL NOTES.
- 2.2 REFER TO GENERAL NOTES SECTION 2 ON SHEET S0 FOR FOUNDATION GENERAL NOTES.

3.0 CONCRETE AND REINFORCING STEEL

- 3.1 REFER TO GENERAL NOTES SECTION 3 ON SHEET S0 FOR CONCRETE AND REINFORCING STEEL GENERAL NOTES.

4.0 CANOPY REACTIONS

- 4.1 MANUFACTURER SHALL PROVIDE ALL CALCULATIONS AND SHOP DRAWINGS TO THE BUILDING ENGINEER FOR REVIEW PRIOR TO THE START OF CONSTRUCTION.
- 4.2 MANUFACTURER SHALL PROVIDE ALL FOUNDATION REACTIONS TO THE BUILDING ENGINEER FOR REVIEW AND VERIFICATION OF FOUNDATION DESIGN (FOUNDATION DESIGN BY BUILDING ENGINEER). WIND AND SEISMIC REACTIONS SHALL BE PROVIDED AT ASH SERVICE LEVEL. MANUFACTURER SHALL PROVIDE A REACTION TABLE ON THE SHOP DRAWINGS LISTING THE VERTICAL LOADS, SHEAR LOADS, AND MOMENTS FOR EACH OF THE FOLLOWING LOAD CATEGORIES: DEAD, LIVE, SNOW, WIND, AND SEISMIC. DO NOT PROVIDE COMBINED LOAD REACTIONS.
- 4.3 MANUFACTURER SHALL PROVIDE THE MINIMUM AND MAXIMUM REACTIONS NOTED ABOVE FOR THE WIND AND SEISMIC LOAD CATEGORIES.
- 4.4 SHOW REACTIONS SHALL INCLUDE UNBALANCED SNOW LOADS AND/OR HIGH-LOW ROOF DRIFTING FROM THE MAIN BUILDING WHEN APPLICABLE.

5.0 CONSTRUCTION AND SAFETY

- 5.1 CANOPY ERECTOR SHALL PROVIDE TEMPORARY BRACING FOR THE ENTIRE CANOPY STRUCTURE UNTIL ALL STRUCTURE AND CONNECTIONS ARE INSTALLED AND FUNCTIONING AS THE DESIGNED UNIT.
- 5.2 THE CONTRACTOR SHALL BE RESPONSIBLE FOR THE MEANS, METHODS, TECHNIQUES, SEQUENCES AND PROCEDURES OF CONSTRUCTION SELECTED.
- 5.3 THE CANOPY ERECTOR SHALL BE SOLELY AND COMPLETELY RESPONSIBLE FOR THE CONDITIONS OF THE JOB SITE IN AND AROUND THE CANOPY INCLUDING THE SAFETY OF ALL PERSONS AND PROPERTY.

### NOTES:

- 1. CC SHALL COORDINATE TOP OF FOOTING ELEVATION WITH CANOPY SUPPLIER PRIOR TO THE PLACEMENT OF THE FOOTING.
- 2. CC SHALL VERIFY FOOTING THICKNESS PROVIDES 3" MIN COVER FOR ANCHOR BOLTS. IF NECESSARY, INCREASE FOOTING THICKNESS TO PROVIDE ADEQUATE COVER. CANOPY FOUNDATION DESIGN IS PRELIMINARY ONLY. FINAL DESIGN WILL BE BASED ON LOADING PROVIDED BY THE CANOPY MANUFACTURER. FOUNDATION SHALL NOT BE PLACED UNTIL CANOPY DESIGN SUBMITTAL IS APPROVED BY THE ENGINEER OF RECORD AND ANY REQUIRED REVISIONS TO THE FOUNDATION DESIGN HAVE BEEN MADE.

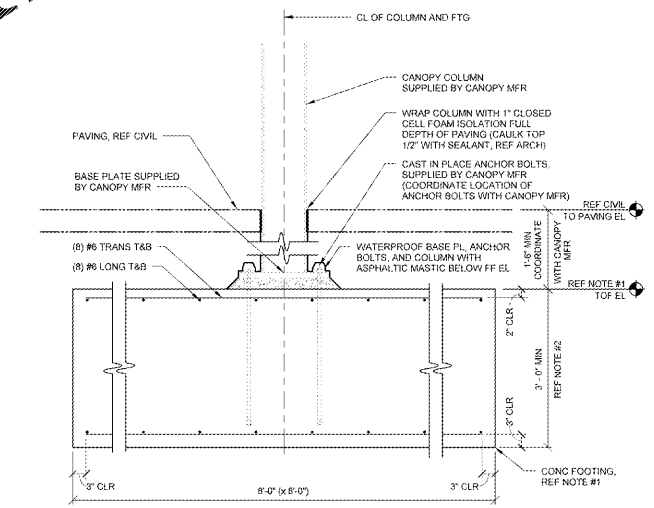

2 CANOPY FOOTING SECTION  
3/4" = 1'-0"

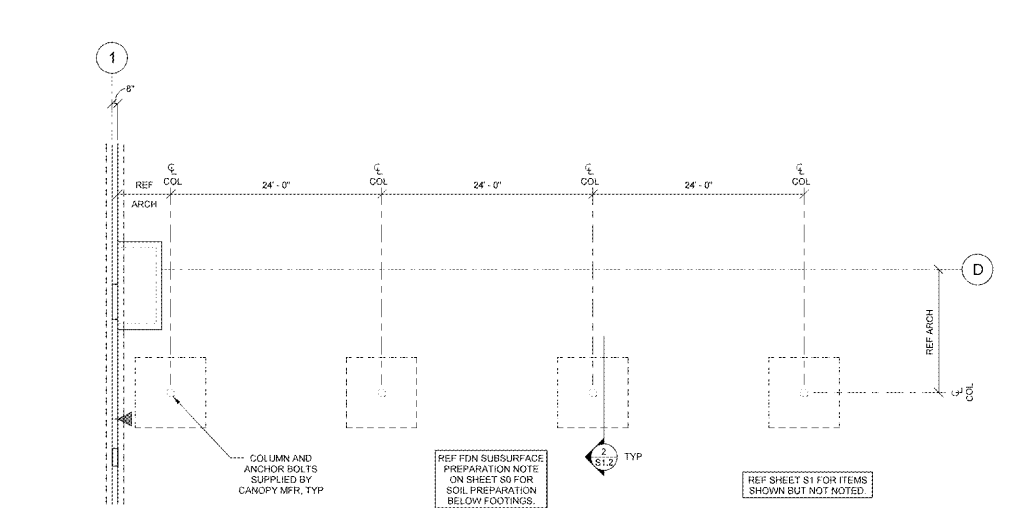

1 GROCERY PICKUP CANOPY FOUNDATION PLAN  
1/8" = 1'-0"



STIPULATION FOR REVIEW  
THE DRAWINGS AND INFORMATION CONTAINED HEREIN ARE THE PROPERTY OF RETAIL DESIGN COLLABORATIVE. ANY REUSE OR REPRODUCTION OF THESE DRAWINGS WITHOUT THE WRITTEN PERMISSION OF RETAIL DESIGN COLLABORATIVE IS STRICTLY PROHIBITED. RETAIL DESIGN COLLABORATIVE SHALL BE RESPONSIBLE FOR THE ACCURACY OF THE INFORMATION PROVIDED. THE USER SHALL BE RESPONSIBLE FOR OBTAINING ALL NECESSARY PERMITS AND APPROVALS FROM THE APPLICABLE JURISDICTIONAL AUTHORITIES.



### ISSUE BLOCK

DTB	11/30/17

CHECKED BY:	BCB
DRAWN BY:	BWN
PROTO CYCLE:	04/28/17
DOCUMENT DATE:	08/13/17
JBA PROJECT NO:	96601904R

BID SET  
NOT FOR  
CONSTRUCTION

GROCERY  
PICKUP  
FOUNDATION  
PLAN AND  
DETAILS

SHEET  
S1.2