

GENERAL NOTES

1. PROPER INSTALLATION OF JOINT SEALANTS IS CRITICAL TO MEETING OWNER QUALITY ASSURANCE STANDARDS. PROVIDE SEALANTS IN ACCORDANCE WITH DRAWINGS AND SPECIFICATIONS.
2. ALL JOINTS BETWEEN DISSIMILAR MATERIALS SHALL BE SEALED AS REQUIRED FOR A COMPLETE AND PROPER INSTALLATION. REGARDLESS OF WHETHER SHOWN ON THE DRAWINGS OR INDICATED IN THE SPECIFICATIONS. SUCH JOINTS NOT SHOWN OR SCHEDULED SHALL BE SEALED WITH SEALANTS CONSISTENT WITH SPECIFIED MATERIALS OR RECOMMENDED BY THE MANUFACTURER FOR THE SPECIFIC APPLICATION.
3. INTERIOR SEALANTS USED IN FOOD PREPARATION AREAS SHALL MEET THE REQUIREMENTS FOR USE IN USDA REGULATED AREAS.
4. REF. AT FOR FINISH SCHEDULE.
5. REF. FINISHING PLANS FOR ITEMS FINISHED BY OWNER.

GENERAL NOTES

1. STUB ALL DIMENSIONS ARE TO THE FACE OF THE STUDS, UNLESS NOTED OTHERWISE.
2. ROUTE ALL UTILITY SERVICE LINES (PIPES AND CONDUIT) WITHIN STUD WALLS WHEREVER POSSIBLE. ON WALK-IN PANELS IN FOOD PREP AREAS WHERE UTILITIES MUST BE EXPOSED, CONTRACTOR TO HAVE THE OPTION OF THE FOLLOWING:
 - A. SURFACE MOUNT UTILITIES WITH NON-CORROSIVE ANCHORS; SEAL BOTH SIDES OF PIPE/CONDUIT TO PANEL CONTINUOUSLY WITH SEALANT.
 - B. INSTALL UTILITIES 1/2" MIN. OFF FACE OF PANEL TO ALLOW FOR CLEANING. USE ONLY NON-CORROSIVE MATERIALS FOR SPACERS AND ANCHORS.
 - C. COVER UTILITIES WITH 20 GAUGE STAINLESS STEEL BENT PLATES MOUNTED TO WALL WITH NON-CORROSIVE ANCHORS; APPLY CONTINUOUS SEALANT ALONG EDGES AND JOINTS.
3. INSTALL CONTINUOUS USDA APPROVED SEALANT AT ALL JOINTS BETWEEN MATERIALS ON WALLS AND FLOORS IN FOOD PREPARATION WALK-IN AREAS.
4. PROVIDE PLYWOOD BACKBOARD(S) FOR ENERGY MANAGEMENT REFRIGERATED CASE INPUT MODULE MOUNTING. COORDINATE EXACT LOCATION OF BACKBOARD PRIOR TO INSTALLATION. REF SHEET EM1.
5. REFERENCE ARCHITECTURAL DETAILS FOR BOLLARD PLANS.

KEYNOTE LEGEND

2.02	CHAIN LINK FENCING (HEIGHT NOTED ADJACENT TO KEYNOTE)
3.13	6" WIDE X 8" HIGH CONTINUOUS CONCRETE CURB WITH SMOOTH HAND TROUVEL FINISH AT BASE OF WALK-IN BOX
5.52	3/2" CORE DRILLED UNO GALVANIZED STEEL BOLLARD 4" OD
5.54	3/2" GALVANIZED STEEL BOLLARD, 4" OD FURNISHED BY OWNER. INSTALLED BY GC
6.24	PROVIDE 1/2" PLYWOOD BLOCKING FROM 48" TO 96" AFF BETWEEN STUDS INSIDE ENTIRE LENGTH OF WALL
6.27	48" HIGH WAINSCOT
9.13	PROVIDE 6" HIGH X 48" WIDE NRP PANELS BEHIND AND TO THE SIDE OF MOP SINK
9.33	BUILDING TAPE INSTALLED PRIOR TO INSTALLATION OF SANITARY COVE BASE
9.51	1/2" GYPSUM BOARD INSTALLED TO FACE OF WALK-IN AS INDICATED ON PLANS. FASTENERS NOT TO EXCEED 1 1/2" IN LENGTH
9.91	PVC PIPE REFRIGERATION CHASE PROVIDED BY REFRIGERATION CONTRACTOR. COORDINATE WITH REFRIGERATION PIPING AND ELECTRICAL CONDUIT PIPE SIZE NOTED ADJACENT TO KEYNOTE

STIPULATION FOR THE CONTRACTOR

THE CONTRACTOR SHALL BE RESPONSIBLE FOR OBTAINING ALL NECESSARY PERMITS AND APPROVALS FROM ALL APPLICABLE AGENCIES AND AUTHORITIES. THE CONTRACTOR SHALL BE RESPONSIBLE FOR OBTAINING ALL NECESSARY PERMITS AND APPROVALS FROM ALL APPLICABLE AGENCIES AND AUTHORITIES. THE CONTRACTOR SHALL BE RESPONSIBLE FOR OBTAINING ALL NECESSARY PERMITS AND APPROVALS FROM ALL APPLICABLE AGENCIES AND AUTHORITIES.

Walmart
LEESBURG, VIRGINIA

STORE NO.: 1504-05
JOB NUMBER: 1190628 | PHOTO

ISSUE BLOCK

OTB	11/30/17
-----	----------

CHECKED BY: RAV
DRAWN BY: EH
FILE NAME: 190401.1
PROTO CYCLE: 042817
DOCUMENT DATE: 09/13/17

BID SET NOT FOR CONSTRUCTION

REAR GROCERY FLOOR PLAN AND DETAILS

SHEET: GA.1.1

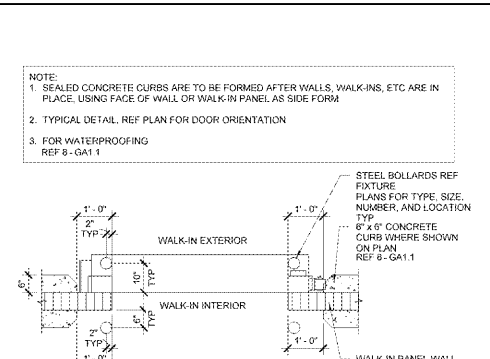

12 ROLL-DOWN DOOR AT WALK-IN
1 1/2" x 1'-0"

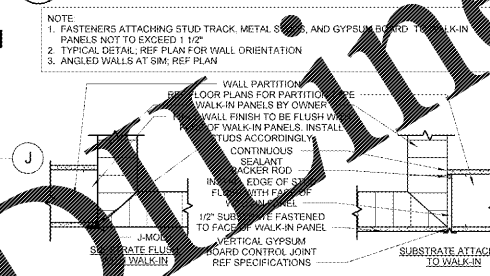

11 WALL JOINT AT WALK-IN CORNERS
1 1/2" x 1'-0"

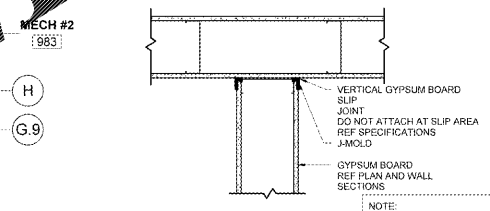

10 CONTROL JOINT AT BULKHEAD CONNECTION
1 1/2" x 1'-0"

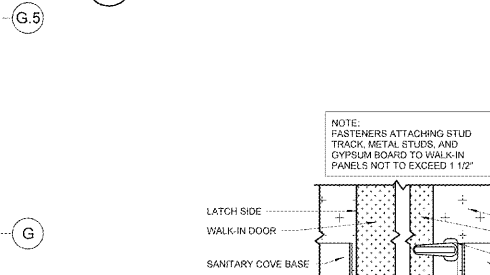

7 SANITARY COVE BASE AT WALK-IN DOOR JAMBS
3/4" x 1'-0"

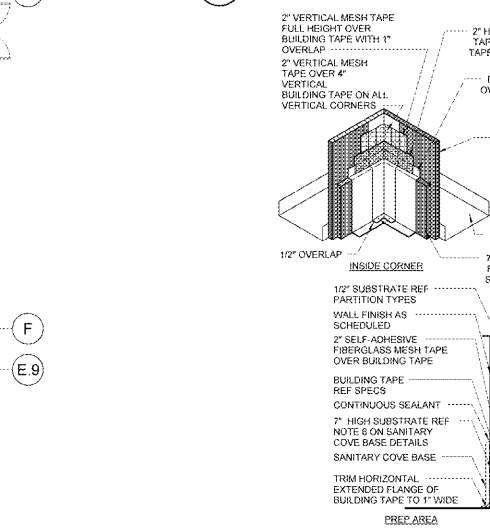

3 WALL DETAIL
1 1/2" x 1'-0"

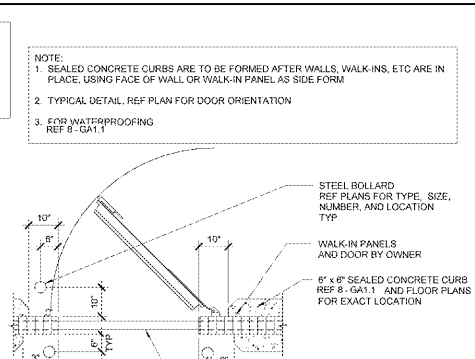

13 SINGLE ACTING DOOR AT WALK-IN
1 1/2" x 1'-0"

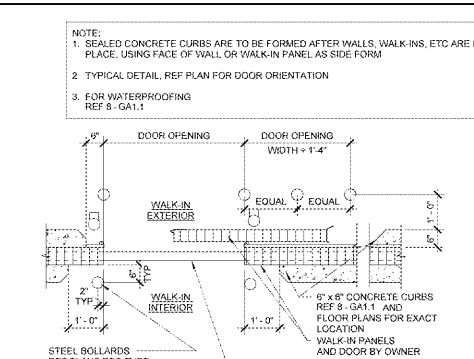

14 SLIDING DOOR AT WALK-IN
1 1/2" x 1'-0"

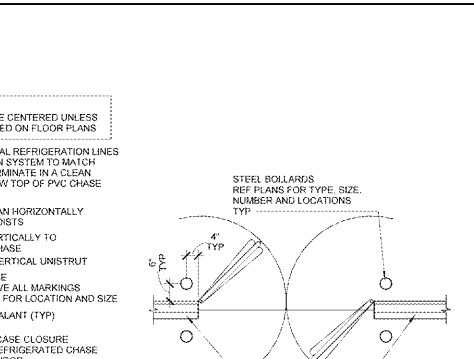

15 DOUBLE ACTING DOOR AT WALK-IN
1 1/2" x 1'-0"

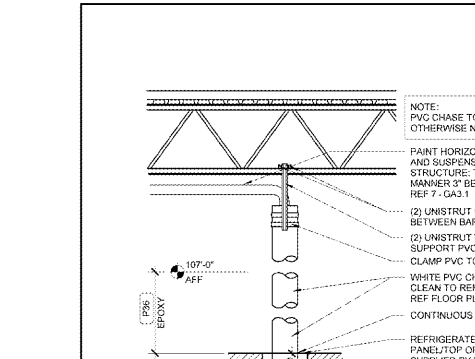

16 PVC REFRIGERATION CHASE
1/2" x 1'-0"

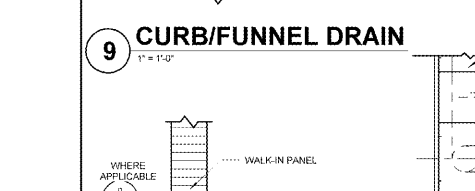
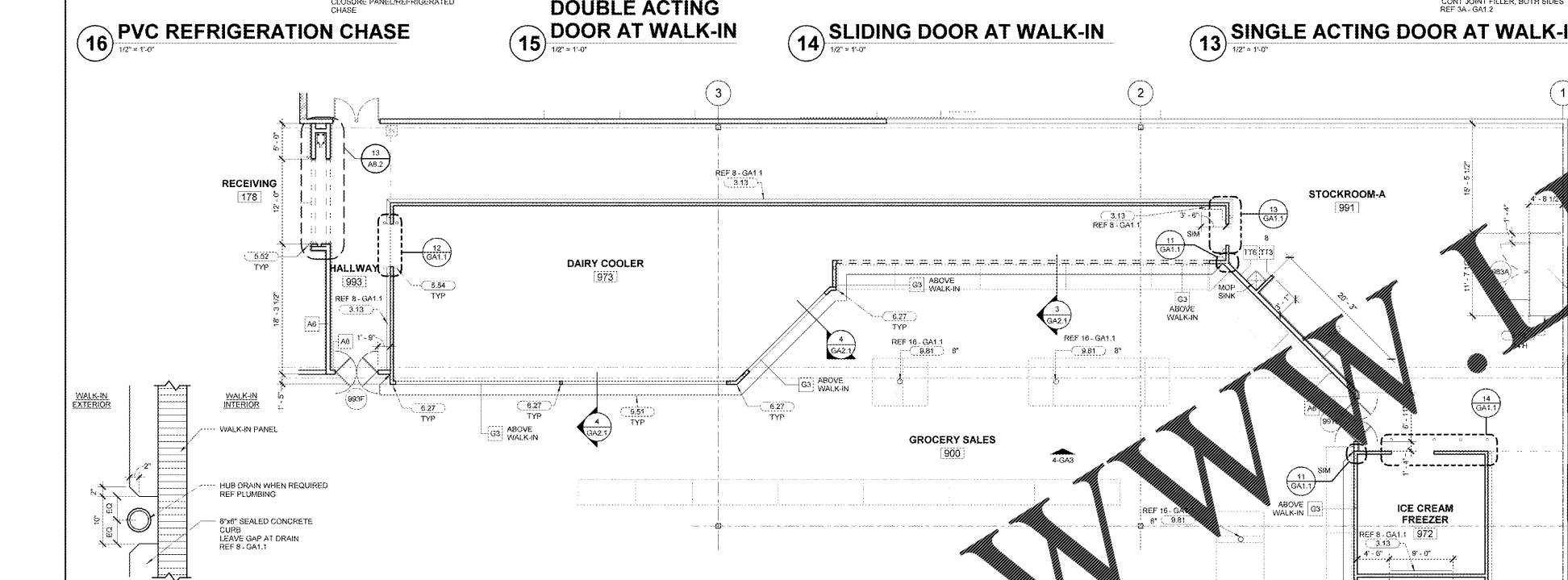

9 CURB/FUNNEL DRAIN
1" x 1'-0"

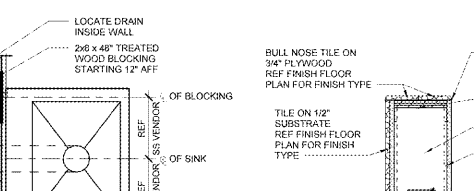

4 BLOCKING AT WALL MOUNTED HAND SINK
1 1/2" x 1'-0"

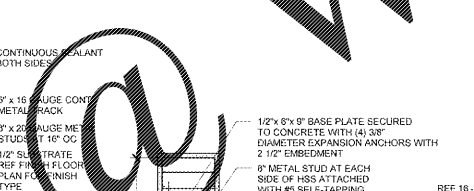

5 SECTION AT HALF WALL
1 1/2" x 1'-0"

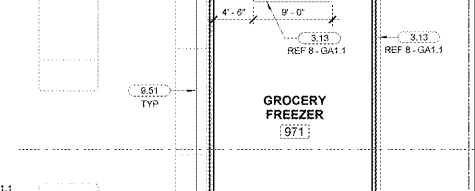

6 PLAN AT HALF WALL
1 1/2" x 1'-0"

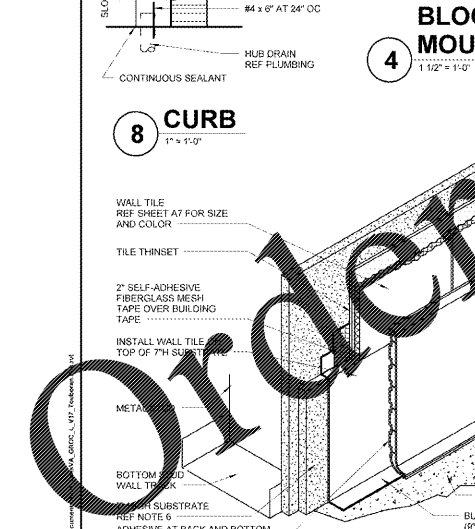

8 CURB
1" x 1'-0"

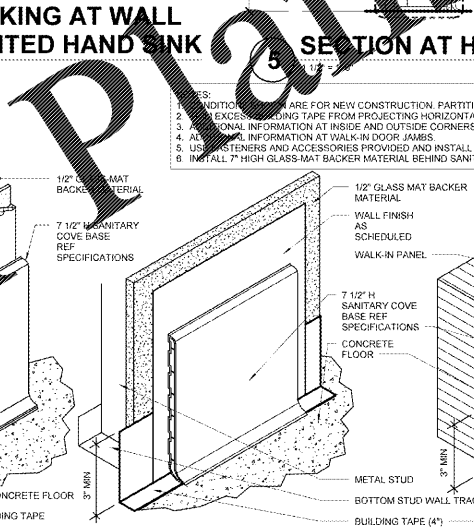

2 SANITARY COVE BASE DETAILS
3" x 1'-0"

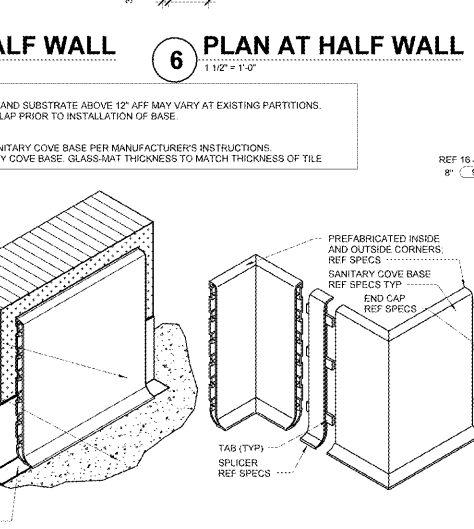

1 ENLARGED REAR GROCERY FLOOR PLAN
1 1/2" x 1'-0"

Order Plans

WWW.WALMART.COM