

STIPULATION FOR THE...
 THE DRAWING AND SPECIFICATIONS...
 CONTRACTOR SHALL BE RESPONSIBLE FOR...
 VERIFYING ALL DIMENSIONS AND...
 CONDITIONS PRIOR TO CONSTRUCTION...
 IF ANY DISCREPANCIES OR...
 CONFLICTS ARE FOUND, THE...
 CONTRACTOR SHALL NOTIFY THE...
 ARCHITECT IMMEDIATELY AND...
 NO CLAIMS WILL BE MADE...
 FOR ANY DAMAGES OR...
 DELAYS RESULTING FROM...
 THESE CONDITIONS.

CONSULTANTS
 WASHINGTON STATE UNIVERSITY

Walmart
 LEESBURG, VIRGINIA
 STORE NO. 1504-05
 1/19/06 - 1/19/06 PHOTO

ISSUE BLOCK	
OTB	11/30/17

CHECKED BY:	RMV
DRAWN BY:	EH
FILE NAME:	190GA1
PROTO CYCLE:	042817
DOCUMENT DATE:	06/13/17

**BID SET
 NOT FOR
 CONSTRUCTION**

**FRONT
 GROCERY FLOOR PLAN
 AND
 REFLECTED
 CEILING PLAN**

GENERAL NOTES

1. PROPER INSTALLATION OF JOINT SEALANTS IS CRITICAL TO MEETING OWNER QUALITY ASSURANCE STANDARDS. PROVIDE SEALANTS IN ACCORDANCE WITH DRAWINGS AND SPECIFICATIONS.
2. ALL JOINTS BETWEEN DISSIMILAR MATERIALS SHALL BE SEALED AS REQUIRED FOR A COMPLETE AND PROPER INSTALLATION. REGARDLESS OF WHETHER SHOWN ON THE DRAWINGS OR INDICATED IN THE SPECIFICATIONS, SUCH JOINTS NOT SHOWN OR SCHEDULED SHALL BE SEALED WITH SEALANTS CONSISTENT WITH SPECIFIED MATERIALS OR AS RECOMMENDED BY THE MANUFACTURER FOR THE SPECIFIC APPLICATION.
3. INTERIOR SEALANTS USED IN FOOD PREPARATION AREAS SHALL MEET THE REQUIREMENTS FOR USE AS USDA REGULATED JOINTS.
4. REF AT FINISH SCHEDULE.
5. REF FINISHING PLANS FOR ITEMS FINISHED BY OWNER.

SHEET NOTES

1. STUD WALL DIMENSIONS ARE TO THE FACE OF THE STUDS, UNLESS NOTED OTHERWISE.
2. ROUTE ALL UTILITY SERVICE LINES (PIPES AND CONDUIT) WITHIN STUD WALLS WHEREVER POSSIBLE. ON WALK-IN PANELS IN FOOD PREP AREAS WHERE UTILITIES MUST BE EXPOSED, CONTRACTOR TO HAVE THE OPTION OF THE FOLLOWING:
 - A. SURFACE MOUNT UTILITIES WITH NON-CORROSIVE ANCHORS; SEAL BOTH SIDES OF PIPE/CONDUIT TO PANEL CONTINUOUSLY WITH SEALANT.
 - B. INSTALL UTILITIES 1/2" MIN. OFF FACE OF PANEL TO ALLOW FOR CLEANING; USE ONLY NON-CORROSIVE MATERIALS FOR SPACERS AND ANCHORS.
 - C. COVER UTILITIES WITH 20 GAUGE STAINLESS STEEL BENT PLATES MOUNTED TO WALL WITH NON-CORROSIVE ANCHORS; APPLY CONTINUOUS SEALANT ALONG EDGES AND JOINTS.
3. INSTALL CONTINUOUS USDA APPROVED SEALANT AT ALL JOINTS BETWEEN MATERIALS ON WALLS AND FLOORS IN FOOD PREPARATION WALK-IN AREAS.
4. PROVIDE PLYWOOD BACKBOARDS FOR ENERGY MANAGEMENT REFRIGERATED CASE IN/PT MODULE MOUNTING. COORDINATE EXACT LOCATION OF BACKBOARD PRIOR TO INSTALLATION. REF SHEET EM1.
5. REFERENCE ARCHITECTURAL DETAILS FOR BOLLARD PLANS.

**REFLECTED CEILING
 PLAN FINISH KEY**

(Pattern: Dotted)	WALK-IN PANEL
(Pattern: Grid)	ACT (REF AT FOR TYPE)
(Pattern: Empty)	OPEN TO STRUCTURE

**REFLECTED CEILING
 PLAN NOTES**

1. FIRE, MECHANICAL, AND ELECTRICAL ITEMS SHOWN ON THE REFLECTED CEILING PLAN ARE FOR COORDINATION PURPOSES ONLY.
2. REF ARCHITECTURAL, FIRE, MECHANICAL, AND ELECTRICAL FOR SYMBOL LEGENDS.

KEYNOTE LEGEND

- 3.13 6" WIDE X 6" HIGH CONTINUOUS CONCRETE CURB WITH SMOOTH HAND TROWEL FINISH AT BASE OF WALK-IN BOX.
- 3.52 32" CORE DRILLED UNO GALVANIZED STEEL BOLLARD 4" OD.
- 3.54 32" GALVANIZED STEEL BOLLARD 4" OD FURNISHED BY OWNER. INSTALLED BY GC.
- 3.82 90" HIGH PLYWOOD WAINGCOT.
- 3.19 PROVIDE 2240 CONTINUOUS HORIZONTAL WOOD BLOCKING AT 34" AFF INSIDE FULL LENGTH OF WALL. PROVIDE 1/2" PLYWOOD BLOCKING FROM 48" TO 96" AFF BETWEEN STUDS INSIDE ENTIRE LENGTH OF WALL.
- 3.24 SUSPENDED BULKHEADS/OFFIT HEIGHT AT BOTTOM OF STUD NOTED ABOVE KEYNOTE.
- 3.33 BUILDING TAPE INSTALLED PRIOR TO INSTALLATION OF SANITARY COVE BASE.
- 3.35 CLEAR OPENING IS FROM INSIDE FACE OF WALL SUBSTRATE.
- 3.41 1/2" WATER RESISTANT GYPSUM BOARD INSTALLED TO FACE OF WALK-IN AS INDICATED ON PLANS. FASTENERS NOT TO EXCEED 1 1/2" IN LENGTH.
- 3.51 1/2" GYPSUM BOARD INSTALLED TO FACE OF WALK-IN AS INDICATED ON PLANS. FASTENERS NOT TO EXCEED 1 1/2" IN LENGTH.
- 3.81 PVC PIPE REFRIGERATION CHASE PROVIDED BY REFRIGERATION CONTRACTOR. COORDINATE WITH REFRIGERATION PIPING AND ELECTRICAL CONDUIT. PIPE SIZE NOTED ADJACENT TO KEYNOTE.
- 15.07 EXHAUST HOOD REF-MECHANICAL.

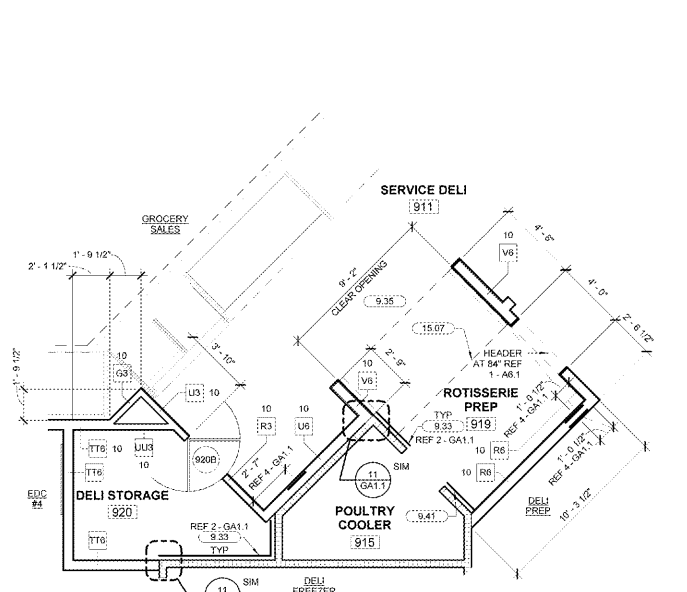

3 ENLARGED SERVICE DELI
 1/4" = 1'-0"

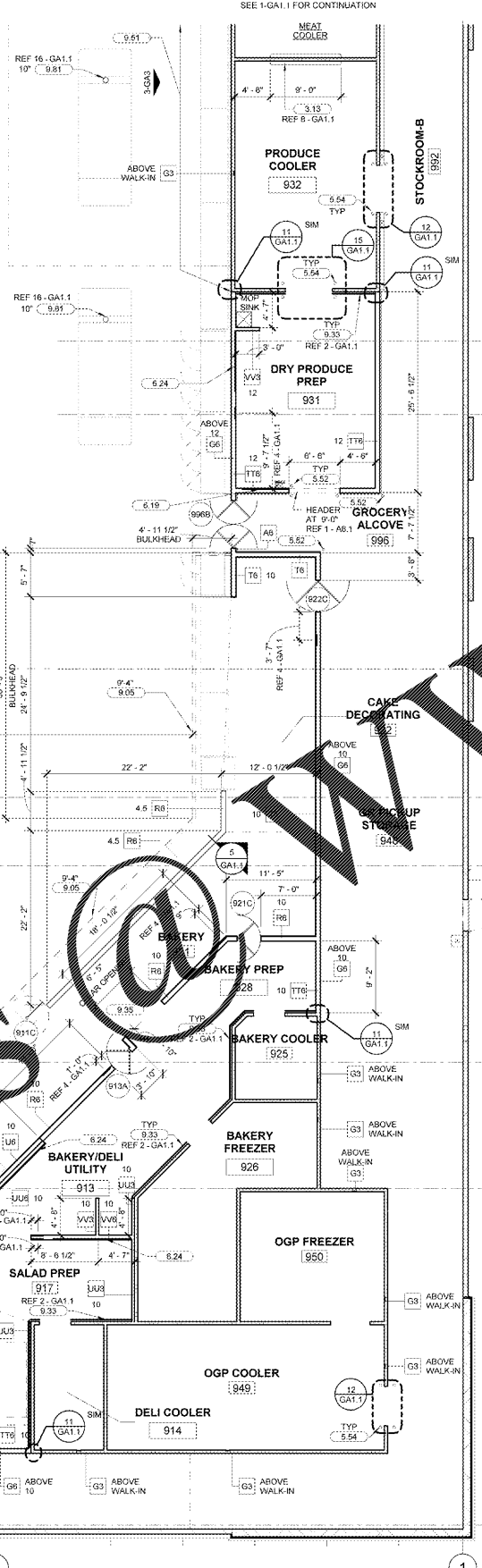

1 ENLARGED FRONT GROCERY FLOOR PLAN
 1/8" = 1'-0"

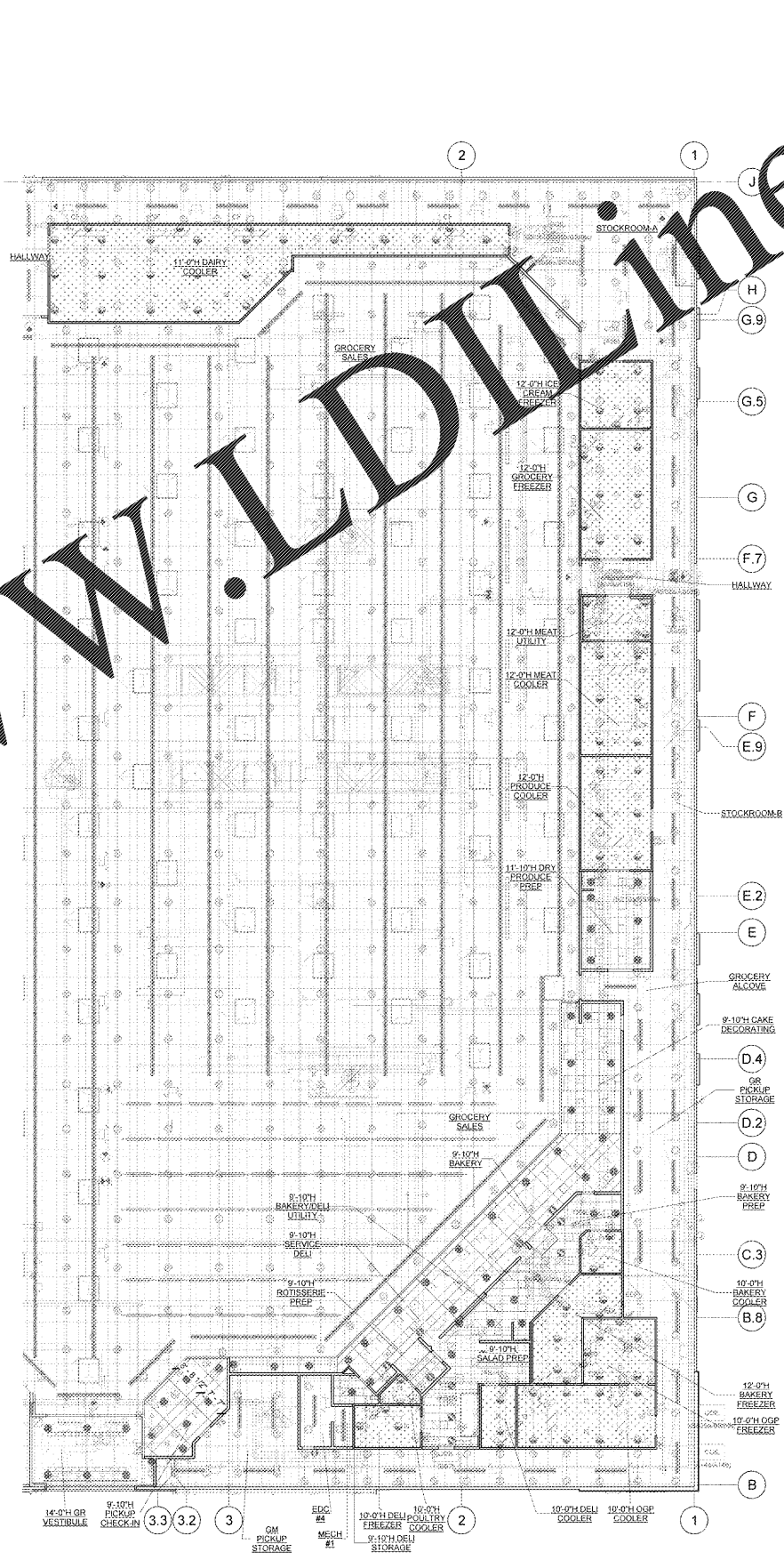

2 ENLARGED GROCERY REFLECTED CEILING PLAN
 1/16" = 1'-0"