

HEADER LENGTH	HEADER MEMBERS	MINIMUM EFFECTIVE PROPERTIES PER STUD
2'-10"	(2) 8" X 18 GAUGE	1x = 2,042 Sx = 0,670
6'	(2) 8" X 18 GAUGE	1x = 2,518 Sx = 0,839
8'	(2) 8" X 18 GAUGE	1x = 3,094 Sx = 1,031
10'	(2) 8" X 18 GAUGE	1x = 3,670 Sx = 1,223
12'	(2) 8" X 18 GAUGE	1x = 4,246 Sx = 1,415
14'	(2) 8" X 18 GAUGE	1x = 4,822 Sx = 1,607
16'	(2) 8" X 18 GAUGE	1x = 5,398 Sx = 1,799
18'	(2) 8" X 18 GAUGE	1x = 5,974 Sx = 1,991
20'	(2) 8" X 18 GAUGE	1x = 6,550 Sx = 2,183

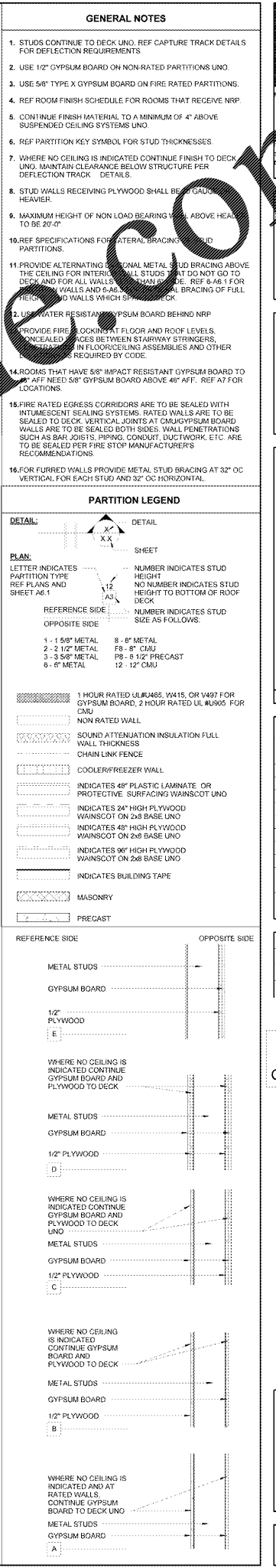
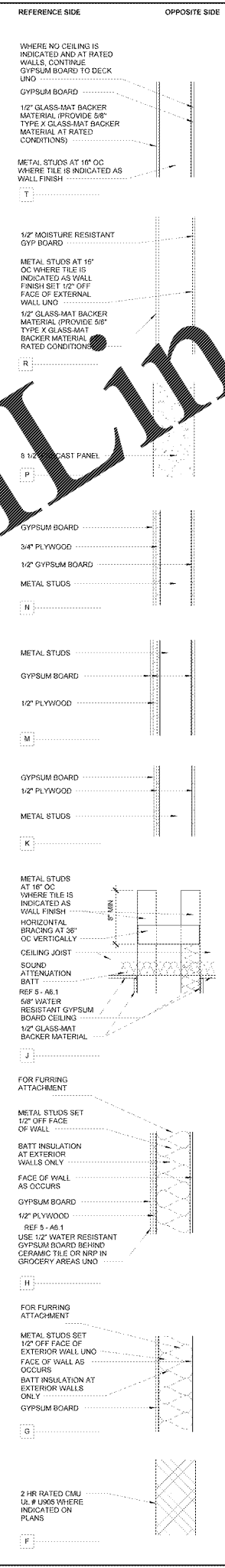
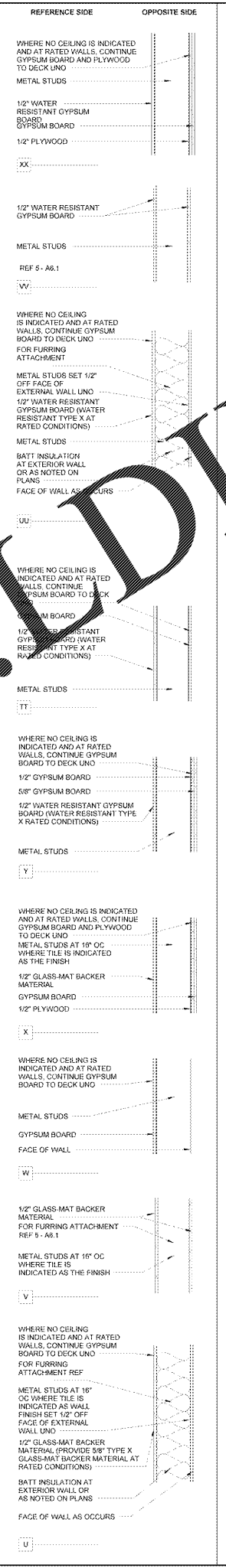

Walmart
LEESBURG, VIRGINIA

ISSUE BLOCK
OTB 11/30/17

CHECKED BY: RW
DRAWN BY: EH
PROTO CYCLE: 04/28/17
DOCUMENT DATE: 09/13/17

BID SET NOT FOR CONSTRUCTION

PARTITION TYPES AND DETAILS

SHEET: A6.1