

SHEET NOTES		KEYNOTE LEGEND	
1.	REF SHEET A7 FOR SCHEDULE FINISH KEY	3.01	CONCRETE STOOP REF STRUC
		3.02	CONCRETE PAVING REF STRUC
		3.07	PATTERNED CONCRETE AREA
		3.20	4" PRECAST CONCRETE CAP
		4.04	CONTROL JOINT TYP. REF STRUCTURAL
		4.28	12" D x 8" X 18" W SPLIT FACE CMU INTEGRALLY COLORED
		5.01	6" PIPE BOLLARD WITH GRAY PLASTIC SLEEVE (HEIGHT OF SLEEVE NOTED ADJACENT TO KEYNOTE)
		5.02	PAINTED 6" PIPE BOLLARD
		7.00	METAL DOWNPOUT, PREFINISHED, UNLESS NOTED OTHERWISE

RET DES
 RETAIL DESIGN COLLABORATIVE
 11/13/2019
 rdcollab.com

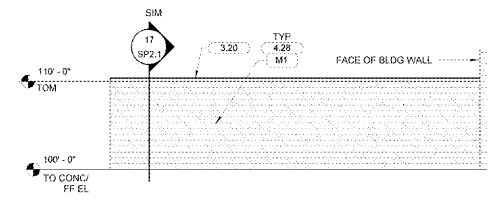

10 COMPACTOR ELEVATION
 1/8" = 1'-0"

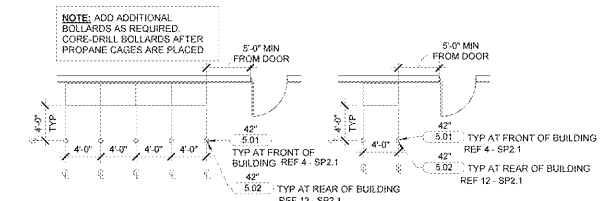

9 BOLLARDS AT PROPANE STORAGE
 1/8" = 1'-0"

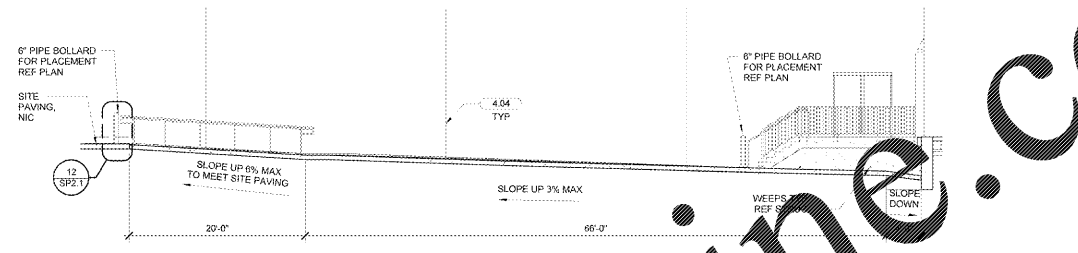

8A GR TRUCKWELL SECTION
 1/8" = 1'-0"

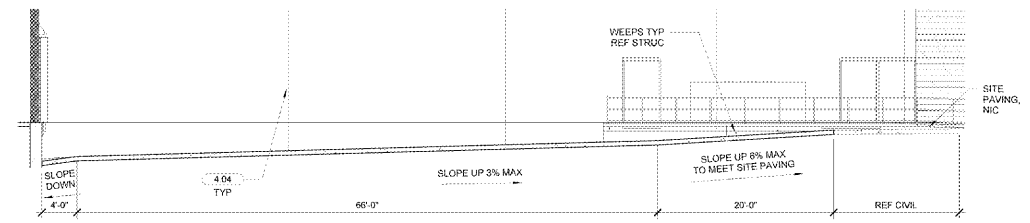

8 TRUCKWELL SECTION
 1/8" = 1'-0"

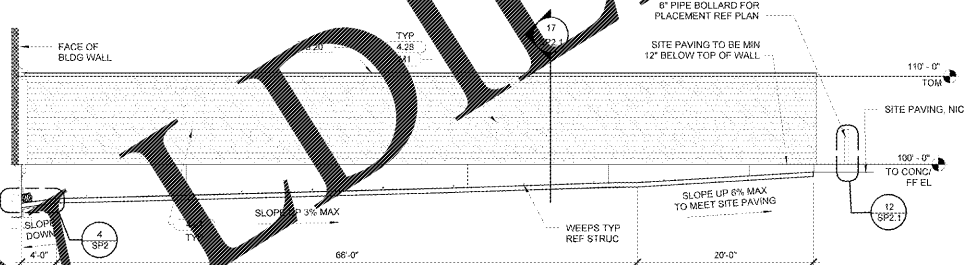

8A TRUCKWELL SECTION
 1/8" = 1'-0"

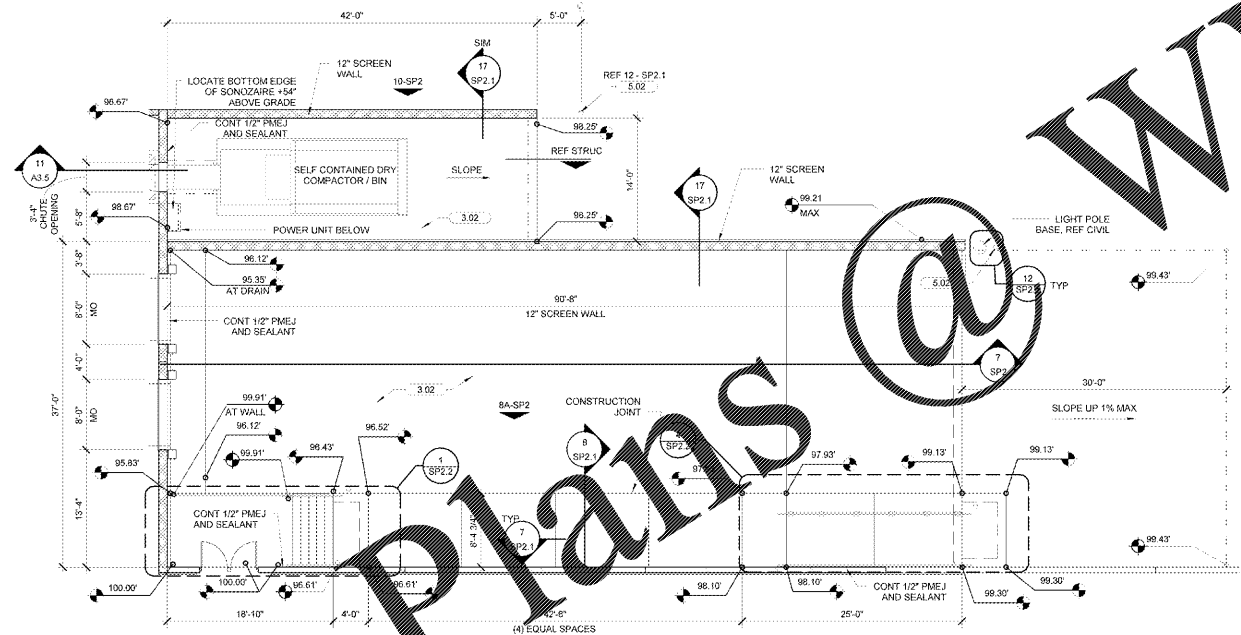

6 GR TRUCKWELL PLAN
 1/8" = 1'-0"

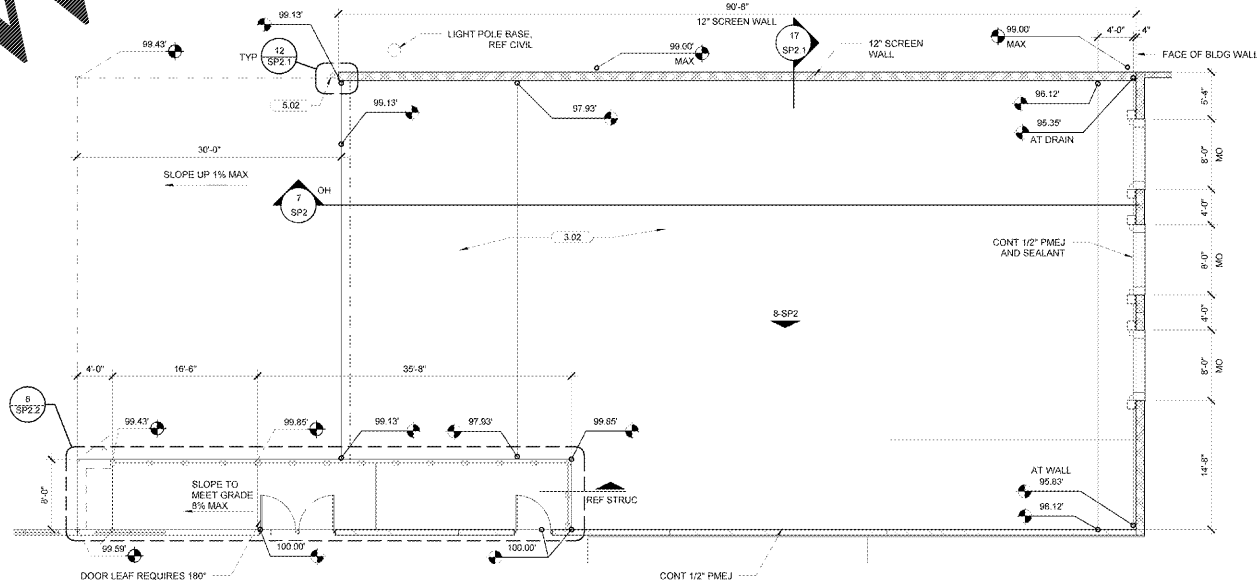

5 GM TRUCKWELL PLAN
 1/8" = 1'-0"

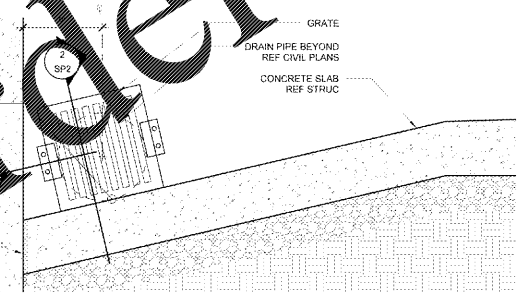

4 DRAIN
 1 1/2" = 1'-0"

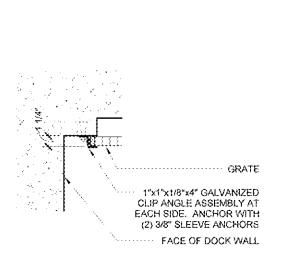

3 TRUCKWELL DRAIN
 1 1/2" = 1'-0"

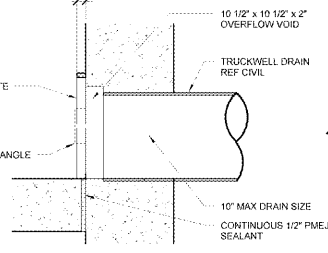

2 TRUCKWELL DRAIN
 1 1/2" = 1'-0"

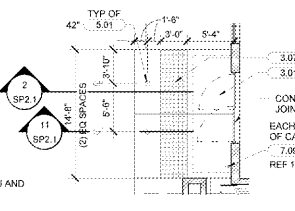

1C ENTRY PLAN
 1/8" = 1'-0"

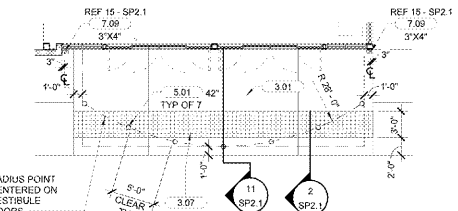

1B GM ENTRY PLAN
 1/8" = 1'-0"

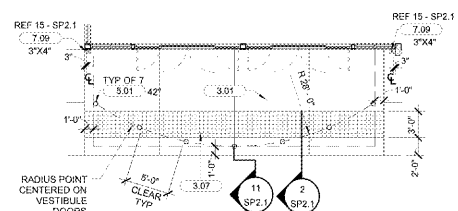

1A GR ENTRY PLAN
 1/8" = 1'-0"

STIPULATION FOR RETIRE...
 THE DRAWING AND INFORMATION CONTAINED HEREIN ARE THE PROPERTY OF RETAIL DESIGN COLLABORATIVE, INC. AND ARE NOT TO BE REPRODUCED, COPIED, OR TRANSMITTED IN ANY FORM OR BY ANY MEANS, ELECTRONIC OR MECHANICAL, WITHOUT THE WRITTEN PERMISSION OF RETAIL DESIGN COLLABORATIVE, INC. ANY UNAUTHORIZED USE OF THIS DRAWING IS PROHIBITED AND WILL BE PROSECUTED TO THE FULL EXTENT OF THE LAW.

CONSULTANTS

Walmart
 LEESBURG, VIRGINIA
 STORE NO. 1904-05
 11/08/2019 | PROJECT: C-190-SS01-CL

ISSUE BLOCK	
OTB	11/30/17

CHECKED BY: RW
 DRAWN BY: EH
 PROTO CYCLE: 04/28/17
 DOCUMENT DATE: 09/13/17

BID SET NOT FOR CONSTRUCTION

SITE DETAILS

SHEET: **SP2**

Order Plans @ www.LDOnline.com