

SITE AMENITIES			
SYMBOL	QTY	DESCRIPTION	SUPPLIES INSTALL
1	24	SLEEVED PIPE BOLLARD REF SPECS	VM GC
2	2	BICYCLE RACK REF SPECS	VM GC

- SHEET NOTES**
- ALL CONCRETE STOOD'S SLOPE 1:48 (2%) MAX AWAY FROM BUILDING. SLOPE SURROUNDING GRADE 1:20 (5.0%) MAXIMUM TO MEET FLUSH WITH FRONT AND SIDE EDGES OF EACH CONCRETE STOOD.
  - ALL EXTERIOR SIDEWALK JOINTS TO BE FILLED WITH SEALANT. REF SPECS
  - REF SHEET A7 FOR SCHEDULE FINISH KEY
  - REF CIVIL AND MEP FOR LOCATION OF GREASE
  - ANCHOR WATER RETURN BIN AND PROPANE STORAGE IN PLACE PER MFR RECOMMENDATIONS

**KEYNOTE LEGEND**

2.04	ORNAMENTAL METAL FENCING
3.01	CONCRETE STOOD REF STRUC
3.05	CONCRETE CURB
3.06	CONCRETE TRANSFORMER PAD. REF CIVILS FOR LOCATION. COORDINATE SIZE, REINFORCING, AND THICKNESS WITH LOCAL UTILITY
3.16	CONCRETE CURB - PAINT ON FACE AND 0" ON TOP
5.01	6" PIPE BOLLARD WITH GRAY PLASTIC SLEEVE (HEIGHT OF SLEEVE NOTED ADJACENT TO KEYNOTE)
10.01	FLAGPOLE

**RETAIL DESIGN COLLABORATIVE**

11/20/17

rdcollab.com

STIPULATION FOR RETAIL DESIGN COLLABORATIVE: THIS DRAWING AND ANY INFORMATION CONTAINED HEREIN IS THE PROPERTY OF RETAIL DESIGN COLLABORATIVE. IT IS TO BE USED ONLY FOR THE PROJECT AND SITE SPECIFICALLY IDENTIFIED HEREIN. NO PART OF THIS DRAWING IS TO BE REPRODUCED, COPIED, OR TRANSMITTED IN ANY FORM OR BY ANY MEANS, WITHOUT THE WRITTEN PERMISSION OF RETAIL DESIGN COLLABORATIVE. ANY REUSE OF THIS DRAWING FOR ANY OTHER PROJECT WITHOUT THE WRITTEN PERMISSION OF RETAIL DESIGN COLLABORATIVE IS STRICTLY PROHIBITED. RETAIL DESIGN COLLABORATIVE SHALL NOT BE RESPONSIBLE FOR ANY ERRORS OR OMISSIONS IN THIS DRAWING.

CONSULTANTS

**Walmart**

LEESBURG, VIRGINIA

STORE NO: 1904-05

11/04/2017

11/04/2017

C-190-504-01

**ISSUE BLOCK**

OTB	DATE
11/30/17	

CHECKED BY: RW

DRAWN BY: EH

PROTO CYCLE: 04/28/17

DOCUMENT DATE: 09/13/17

**BID SET NOT FOR CONSTRUCTION**

**SITE PLAN**

1 SITE PLAN

1" = 20'-0"

SP1

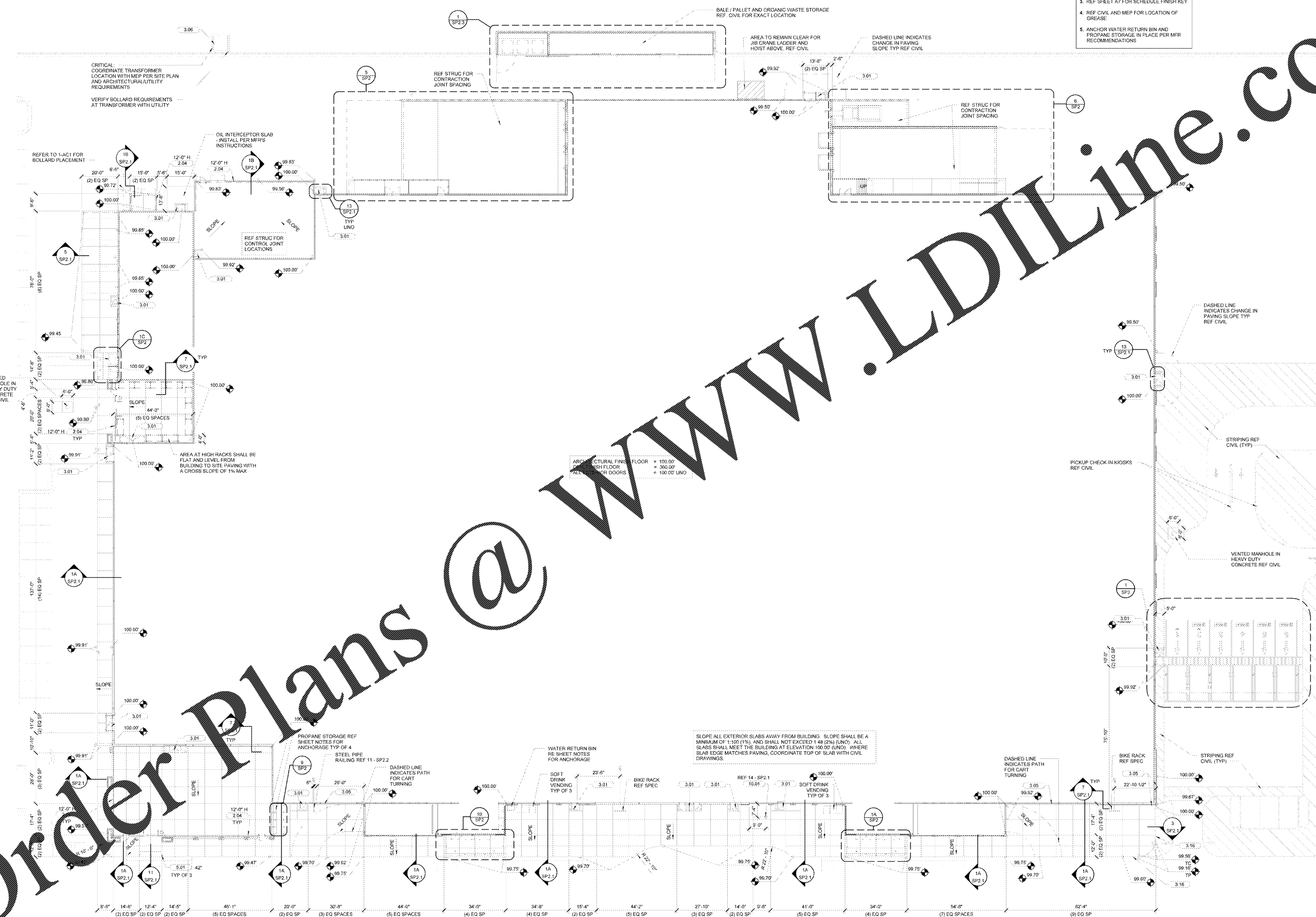

Order Plans @

© 2017 Retail Design Collaborative. All rights reserved.