

GRAPHIC LEGEND

- EXISTING WALLS, PARTITIONS, COLUMNS, FIXTURES, EQUIPMENT, ETC. TO REMAIN
- NEW WALLS, PARTITIONS, COLUMNS, FIXTURES, EQUIPMENT, ETC.
- EXISTING WALLS, PARTITIONS, COLUMNS, FIXTURES, EQUIPMENT, ETC. TO BE REMOVED
- EXISTING 1 HOUR FIRE RATED PARTITION

DEMOLITION NOTES

1. COORDINATE ALL NEW UTILITIES AND SITE WORK WITH OTHER DISCIPLINES
2. PREPARE SITES AS REQUIRED FOR CONSTRUCTION. ALL TREE WORK MAY NOT BE INDICATED ON THIS SHEET. CONTRACTOR IS RESPONSIBLE FOR PREPARATION.
3. REMOVE ALL MATERIALS AND LABOR REQUIRED FOR NEW WORK. COORDINATE ALL CONSTRUCTION INCLUDING UTILITY WORK WITH OWNER TO MINIMIZE DISRUPTION TO NORMAL BUSINESS OPERATIONS WITHIN BUILDING. CONTRACTOR SHALL PROTECT ALL AREAS NOT IN SCOPE OF WORK FROM DUST AND DEBRIS. EFFORT SHALL BE MADE TO MINIMIZE CONSTRUCTION NOISE. MINIMUM 8 HOURS DEMOLITION WORK SHOWS MINIMUM DURATION. WORK TO BE PERFORMED TO ACCOMMODATE SCHEDULED CONSTRUCTION. COORDINATE LIMITS OF DEMOLITION WORK WITH SCOPE OF SCHEDULED CONSTRUCTION.
4. COORDINATE WITH OWNER FOR TEMPORARY STORAGE OF ITEMS INDICATED TO BE "REUSED," "RELOCATED," "SALVAGED," OR OTHERWISE MODIFIED AND REINSTALLED.
5. COORDINATE WITH OWNER FOR PERMANENT STORAGE OF ITEMS INDICATED TO BE "RETURNED TO OWNER" OR OTHERWISE SAVED OR PRESERVED.
6. COORDINATE WITH OWNER FOR OWNER'S REMOVAL OF MISCELLANEOUS EQUIPMENT AND OTHER ITEMS NOT SPECIFICALLY NOTED HEREIN DEMOLITION NOTES.
7. COORDINATE WITH OWNER FOR TIMELY REMOVAL OF ITEMS INDICATED TO BE "REMOVED BY OWNER," "REMOVED BY OTHERS," OR OTHERWISE NOT REMOVED OR DEMOLISHED BY GENERAL CONTRACTOR.
8. PROTECT AND PRESERVE ALL EXISTING ITEMS AND ADJACENT AREAS AROUND AREAS OF DEMOLITION.
9. OWNER TO REMOVE ALL ELECTRICAL EQUIPMENT, STORAGE AND SHELVING. SEE NOTE 11 FOR ALL REMAINING ITEMS.
10. OWNER TO REMOVE EXISTING SHELVING AND STORED MATERIALS. ANY ITEMS NOT SALVAGED BY THE OWNER SHALL BE REMOVED BY THE CONTRACTOR PRIOR TO THE START OF WORK.
11. NEW OPENING LOCATIONS SHALL BE COORDINATED WITH NEW WORK. REMOVE AND STORE ALL DOORS, WINDOWS AND MILL WORK FOR RE-USE.
12. CONTRACTOR TO VISIT THE SITE TO BECOME FAMILIAR WITH ALL CONDITIONS AND SERVICES. PRIOR TO BIDDING CONTRACTOR SHALL INCLUDE RESPONSIBLE CONTINGENCIES IN ITS BID FOR OBSERVABLE CONDITIONS.
13. REMOVE ALL EXISTING Piping, CONDUIT, ELECTRICAL WIRES, CONSTRUCTION DEBRIS, AND MISCELLANEOUS MECHANICAL EQUIPMENT NOT NEEDED TO REMAIN FROM BUILDING. SEE MEP DRAWINGS FOR SPECIFICATIONS.
14. ALL EXISTING DIMENSIONS ARE APPROXIMATE AND SHALL BE VERIFIED IN FIELD AND COORDINATED WITH NEW WORK. NO ADDITIONAL COMPENSATION SHALL BE CONSIDERED FOR VARIATIONS OF ACTUAL DIMENSIONS.
15. REFER TO MECHANICAL DRAWINGS FOR REQUIRED ROOF OPENING DEMOLITION AREA(S) FOR NEW ROOFTOP HVAC INTAKE DUCT.

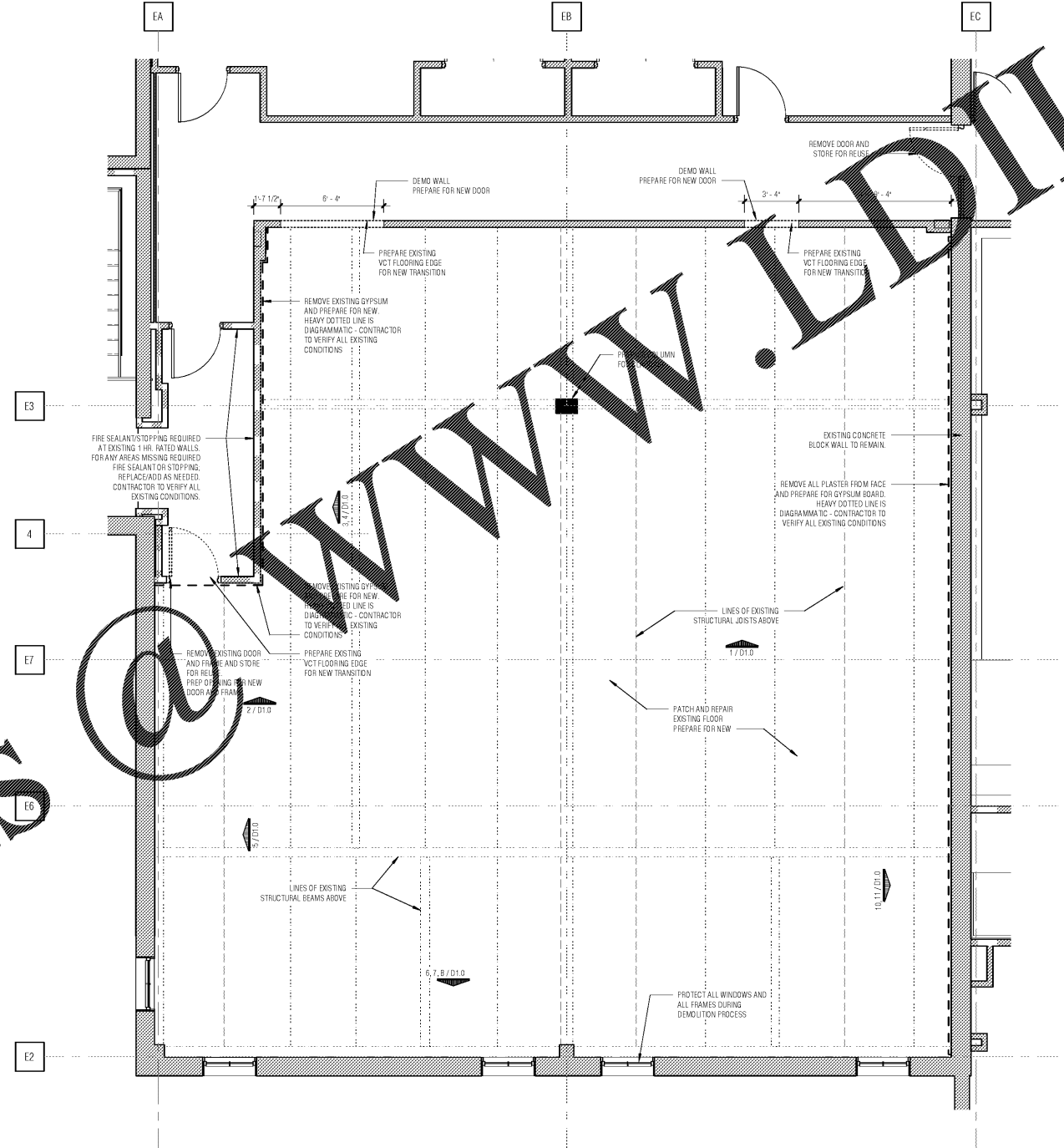

NANO ARCHITECTURE
RESARCH ARCHITECTS FURNITURE

REV	DATE	DESCRIPTION	BY

SEWERAGE AND WATER BOARD
OF NEW ORLEANS

CONTRACT 8155
ELECTRICAL STORAGE ROOM OFFICE RENOVATION

DEMOLITION PLAN **D2.0**

DR	SJ
INC	
SK	KK
AP	TD
SCALE	1/4" = 1'-0"
DATE	15 NOVEMBER 2017
SETNO	BID DOCUMENTS
SHEETNO	

DWG. No. 12148-W-60

1 | D2.0 | DEMOLITION PLAN
1/4" = 1'-0"

Order Plans