

Order Plans @

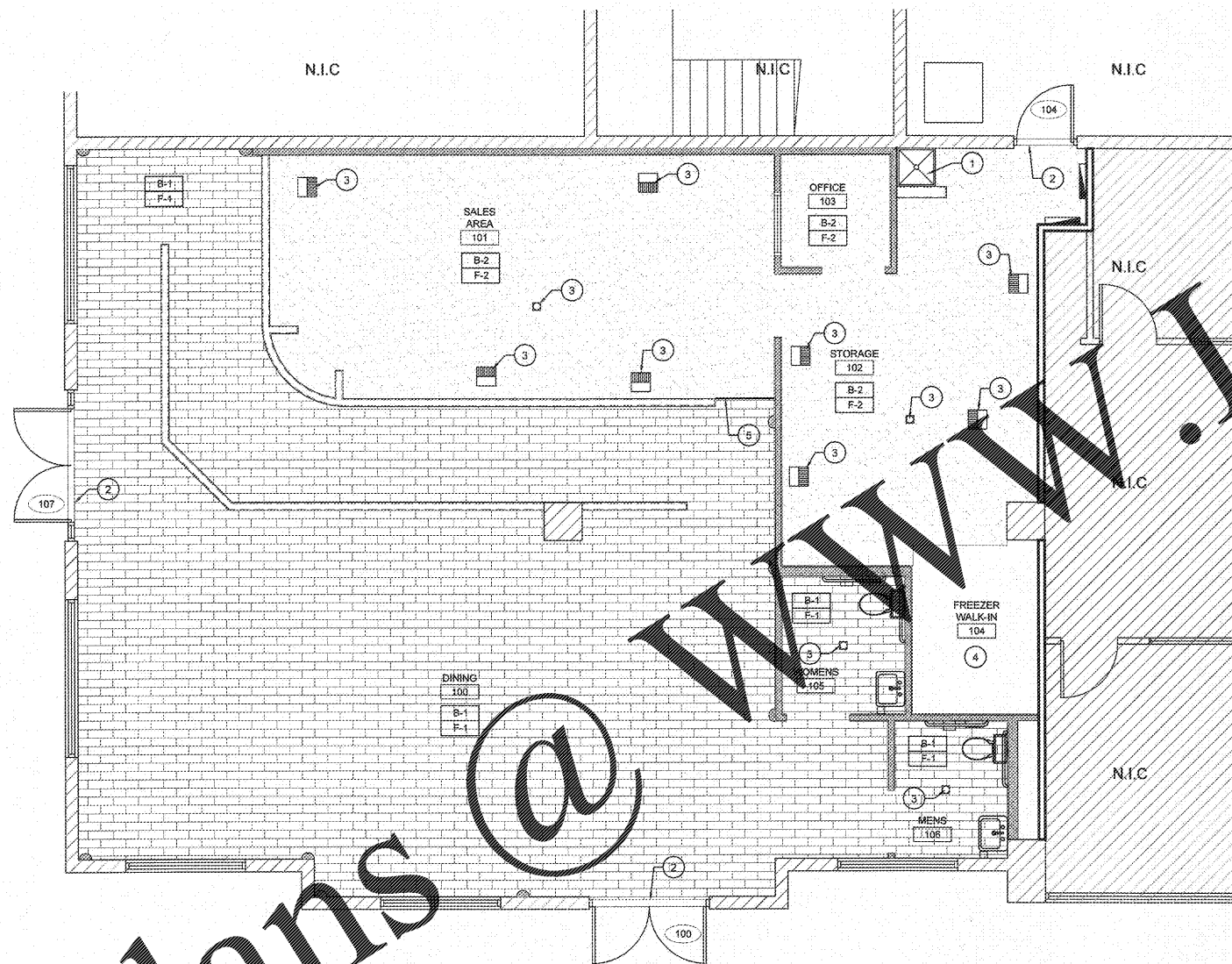

GENERAL NOTES

1. ALL CONTRACTORS SHALL VERIFY EXISTING CONDITIONS PRIOR TO BID.
2. ALL CONTRACTORS SHALL COORDINATE WORK WITH OTHER TRADES PRIOR TO ROUGH-IN OF FIXTURES AND UTILITIES.
3. REFER TO KITCHEN PLANS FOR KITCHEN AND SEATING EQUIPMENT.
4. ALL NOTES AND MATERIAL INDICATIONS ARE TYPICAL AND TO SIMILAR CONDITIONS, UNLESS NOTED OTHERWISE.
5. CONTRACTOR SHALL NOT ALLOW DEBRIS/TRASH TO ACCUMULATE ON SITE.
6. REFER TO PLUMBING DRAWINGS FOR LOCATIONS OF FLOOR DRAINS. REFER TO EQUIPMENT DRAWINGS FOR LOCATION OF FLOOR SINKS AND HUB DRAINS.
7. PROVIDE WATER RESISTANT GYPSUM BOARD AT KITCHEN AND RESTROOM.
8. REFER TO SHEETS AR.1 & AR.2 FOR ACCESSIBILITY REQUIREMENTS.

KEYED NOTES

- 1 MOP SINK; RE: PLUMBING
- 2 ALUMINUM THRESHOLD IF REQUIRED; RE: 1/A4.0
- 3 FLOOR DRAIN FIXTURE; RE: PLUMBING
- 4 NO FLOORING UNDER FREEZER
- 5 PLUTER TRANSITION STRIP, ALIGN WITH SERVICE SIDE OF WALL

FINISH SCHEDULE

FLOORING	
F-1	PORCELAIN TILE
F-2	EPOXY
BASE	
B-1	PORCELAIN TILE BASE
B-2	EPOXY BASE

FLOOR FINISH PLAN
1/4"=1'-0"



1

Original Shared for Compliance

DIMENSION GROUP

1935 W. HIGHWAY 1, SUITE 100, JUPITER, FL 33457-1100
 TEL: 561.744.1111 FAX: 561.744.1112
 WWW.DIMENSIONGROUP.COM

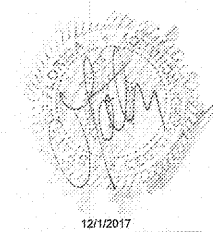

12/1/2017

ABACOA TOWN CENTER
1208 MAIN STREET
UNIT 116
JUPITER, FLORIDA

REVISIONS:

Δ	
Δ	
Δ	
Δ	
Δ	

PROJECT NUMBER: 17-598

DATE: 10-24-2017

FINISH FLOOR PLAN

A1.3