

**ALL FIRE ALARM WORK SHALL BE BY LANDLORD APPROVED CONTRACTOR.
 SCALE: 1/4" = 1'-0"

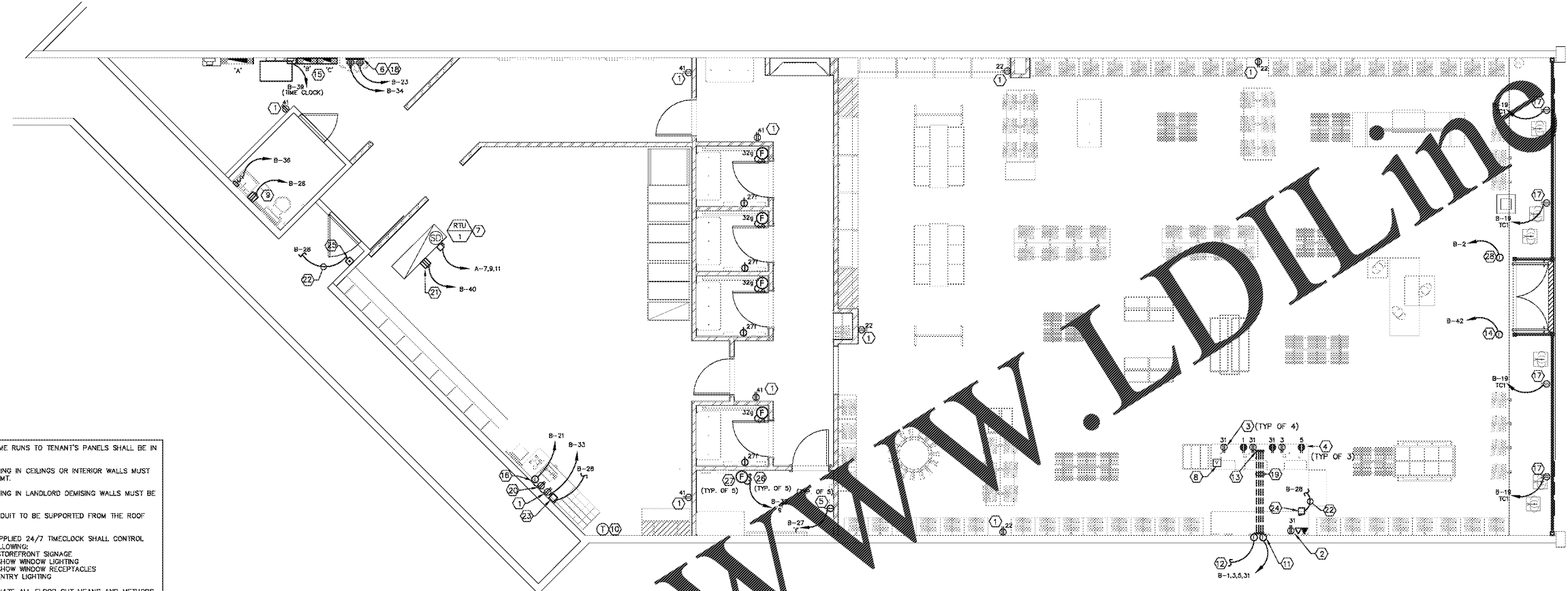

ALL HOME RUNS TO TENANT'S PANELS SHALL BE IN EMT
 ALL WIRING IN CEILINGS OR INTERIOR WALLS MUST BE IN EMT
 ALL WIRING IN LANDLORD DEMISING WALLS MUST BE IN EMT
 NO CONDUIT TO BE SUPPORTED FROM THE ROOF DECK.
 E.G. SUPPLIED 24/7 TIMECLOCK SHALL CONTROL THE FOLLOWING:
 -STOREFRONT SIGNAGE
 -SHOW WINDOW LIGHTING
 -SHOW WINDOW RECEPTACLES
 -ENTRY LIGHTING
 COORDINATE ALL FLOOR CUT MEANS AND METHODS OF ROUTING CONDUIT THROUGH THE FLOOR WITH WALL OPERATIONS.
 VERIFY ALL FIELD CONDITION PRIOR TO BID.

- 1 ELECTRICAL POWER PLAN**
- 1 CONVENIENCE OUTLET MOUNTED IN WALL AT +18" A.F.F. (J.N.O.) COVER PLATE TO MATCH ADJACENT WALL COLOR, TYP.
 - 2 PROVIDE (1) DATA AND (1) DUPLEX CONVENIENCE RECEPTACLE. COORDINATE LOCATION OF OUTLETS WITH CUTOUT IN BACKWRAP CABINET. SEE DETAIL 13/A7 AND BACKWRAP CUTSHEET ON TORRID FTP SITE.
 - 3 DUPLEX CONVENIENCE RECEPTACLE, MOUNTED 2" ABOVE BOTTOM SHELF ON BACK CASHWRAP.
 - 4 ISOLATED DUPLEX RECEPTACLE (HUBBELL OR EQUAL) WITH DEDICATED CIRCUIT. MOUNTED 2" ABOVE BOTTOM SHELF ON BACK WALL OF CASHWRAP. PROVIDE GROUNDING BAR IN PANEL AS REQUIRED.
 - 5 RECESSED CLOCK RECEPTACLE FOR FITTING ROOM MIRROR TO BE SWITCHED BY CIRCUIT SHOWN ON PLAN. MOUNT AT +70" AFF. EG TO PROVIDE NEW SINGLE-POLE SWITCH FOR CONNECTION TO MIRROR OUTLETS AT +42". ALL SWITCHES SHALL BE TIED TO SWITCHBANK AT SWITCH 'Y'.
 - 6 TELEPHONE TERMINAL BOARD (T.T.B.).
 - 7 EXISTING RTU. COORDINATE WITH M.C.
 - 8 LOCATION OF VOLUME CONTROL FOR MUSIC SYSTEM. G.C. COORDINATE WITH VENDOR.
 - 9 G.F.C.I. PROTECTED CONVENIENCE OUTLETS MOUNTED AT 18" AFF. IN TOILET ROOM.
 - 10 PROVIDE J-BOX AT +48" AFF. CONDUIT W/PULL STRING TO CEILING SPACE FOR THERMOSTAT. VERIFY LOCATION WITH M.C. PRIOR TO ROUGH-IN.
 - 11 PULL BOXES ABOVE CEILING LINE. CONDUIT TO CASHWRAP STUB-UPS.
 - 12 PROVIDE CONDUIT BETWEEN T.T.B. AND BACKWRAP. TORRID VENDOR TO RUN (1) CAT-5E CABLE LABELED "T-1", (1) CAT-5E CABLE LABELED "STOCK ROOM" AND (1) CAT-5E CABLE LABELED "SALES AREA". EACH CABLE SHALL BE LABELED AS SUCH AT EACH END AND HAVE A MINIMUM 10 FOOT WHIP FROM THE END OF THE CONDUIT/BOX.
 - 13 STUB-UPS BELOW ACCESS PANEL LOCATION FOR ALL CASHWRAP SYSTEMS (ELECTRICAL, DATA, PHONES AND LOW VOLTAGE). EXTEND TO THE DEVICES AS REQUIRED. GATHER ALL CONDUITS TOGETHER AND RUN TO DEVICES IN MOST APPROPRIATE MANNER POSSIBLE.
 - 14 PROVIDE J-BOX WITH CONDUIT AND PULL WIRE FOR SHOPPERTRAK AT STOREFRONT BACK TO DATA BOX. COORDINATE WITH OWNER AND ARCHITECT.
 - 15 ELECTRICAL SERVICE. SEE ONE-LINE DIAGRAM ON SHEET E3.
 - 16 TENANT GENERAL CONTRACTOR TO PROVIDE 4S BOX FOR SPEAKER WIRES IN WALL AT 72" A.F.F. RUN CONDUITS WITH PULL STRINGS TO SPEAKER LOCATIONS AS DIRECTED BY THE TENANT'S MUSIC PROVIDER.
 - 17 DUPLEX RECEPTACLE, MOUNTED IN SOCKET PER NEC 210.62, WHITE W/COVER PLATE TO MATCH ADJACENT WALL COLOR OR IN SAME AREA. POSITION BETWEEN LIGHT FIXTURES EQUALLY. COORDINATE WITH SHEET E2.
 - 18 PROVIDE NEW FOUR-POLE OUTLET ONLY IF NOT EXISTING MOUNTED IN WALL AT +84" A.F.F. ON OR NEAR RTU. OR PROVIDE STAINLESS COVER PLATE FOR PHONE SYSTEM, ALARM, OR OTHER SLAB PENETRATION.
 - 19 PROVIDE (4) CONDUITS TO CASHWRAP. ASSIGN (1) ELECTRICAL, (2) DATA, (1) PHONES AND LOW VOLTAGE SYSTEMS FROM ABOVE CEILING, UNDER SLAB, TO STUB-UPS IN CASHWRAP BASE. VERIFY METHOD OF SLAB PENETRATION (USUALLY CORING OR SAW CUTTING). COORDINATE WITH ALL AUTHORITIES PRIOR TO COMMENCEMENT OF THIS WORK. PATH AND REPAIR SLAB AS REQUIRED. COMPLY WITH WALL REGULATIONS.
 - 20 PROVIDE DUPLEX OUTLET MOUNTED IN WALL AT 78" A.F.F. FOR STEREO SYSTEM, CD PLAYER, ETC.
 - 21 PROVIDE WP GFCI DUPLEX RECEPTACLE AT RTU UNIT IF NOT EXISTING.
 - 22 LOW VOLTAGE BELL WIRE IN CONDUIT BETWEEN TRANSFORMER AT REAR ENTRANCE DOOR AND ELECTRIC BUZZER ABOVE CASHWRAP COUNTER.
 - 23 PROVIDE NEW DOORBELL/BUZZER AND TRANSFORMER ABOVE MANAGER'S DESK ROUTE BELOW CEILING FOR SERVICE DOOR BUZZER TRANSFORMER. LOW VOLTAGE TRANSFORMER SHALL BE EDWARDS #959 OR EQUAL. ALL BUZZERS SHALL BE EDWARDS #338-05 OR EQUAL.
 - 24 PROVIDE NEW SALES AREA ELECTRIC BUZZER MOUNTED ABOVE THE CASHWRAP. PROVIDE WHITE METAL PERFORATED SPEAKER AT BUZZER. SEE REFLECTED CEILING PLAN FOR EXACT LOCATION.
 - 25 PROVIDE NEW PUSH-BUTTON FOR ELECTRIC BUZZER SYSTEM AT +48". DEVICE SHALL BE EDWARDS #632L OR EQUAL.
 - 26 INSTALL FAN CONTROLLER (FURNISHED W/FAN) WITH COVER PLATE AT +48". PROVIDE 4-WIRE CABLE FROM CONTROLLER TO FAN. FAN IS TO OSCILLATE. CONNECT ALL CONTROLLERS TO NEW CONTRACTOR AT SWITCHBANK, TO BE CONTROLLED BY SWITCH 'J'.
 - 27 PROVIDE JUNCTION BOX IN CEILING @ MAX HEIGHT AND INSTALL OWNER-FURNISHED OSCILLATING FAN. SEE ELEVATIONS AND SHEET A2 ROP AND SCHEDULE FOR MORE INFORMATION.
 - 28 PROVIDE 120V CONNECTION FOR DOOR MAX PIN SECURITY SYSTEM. COORDINATE EXACT LOCATION WITH SYSTEM INSTALLER. PROVIDE DEDICATED CIRCUIT AT 12" BELOW FINISHED CEILING OR AS DIRECTED BY G.C. VERIFY CONNECTION REQUIREMENTS PRIOR TO ANY WORK.
 - 29 EXISTING TO REMAIN FIRE ALARM STROBE.
 - 30 PROVIDE NEW CONNECT TO EXISTING LANDLORD SYSTEM.

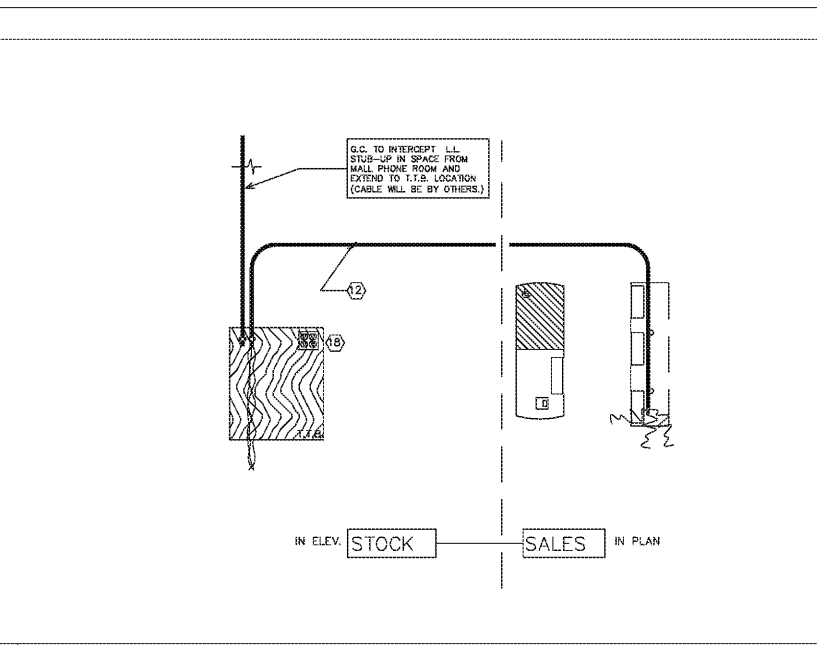

- 4 GENERAL NOTES**
- A. G.C. TO COORDINATE CONDUIT STUB-UPS FOR CASHWRAP WITH VENDOR SHOP DRAWINGS TO ENSURE AN ACCURATE AND CLEAN INSTALLATION IS ACCOMPLISHED. STUB-UPS ARE TO BE CLEAN HOLES USING A DRILL BIT ONE SIZE LARGER THAN THE CONDUIT. USING A SAWS-ALL IS NOT AN APPROVED METHOD.
 - B. CABLE TYPES AC AND NMC ARE NOT ACCEPTABLE.
 - C. ALL WIRE SHALL BE COPPER.
 - D. GROUND SEPARATELY DERIVED SERVICE. INCLUDE BUILDING STEEL IN THE GROUND IF POSSIBLE.
 - E. CIRCUIT BREAKERS SHALL BE BOLT ON TYPE.
 - F. STOREFRONT SIGN AND LIGHTING SHALL BE ON A SEVEN DAY, TWENTY FOUR HOUR TIME CLOCK.
 - G. THE TENANT IS RESPONSIBLE TO FIELD VERIFY THE EXISTING ELECTRICAL SERVICE, TO INSURE THAT THE TOTAL CONNECTED LOAD DOES NOT EXCEED THE ELECTRICAL SERVICE. ANY NECESSARY MODIFICATIONS ARE THE RESPONSIBILITY OF THE TENANT, AT TENANT EXPENSE.
 - H. VERIFY ALL DEVICE LOCATIONS PRIOR TO ROUGH-IN WITH OWNER'S FIELD REPRESENTATIVE.
 - I. FOR ALL SLAB PENETRATIONS: THE METHOD, DEPTHS, AND LOCATIONS SHALL BE PRE-APPROVED BY MALL FIELD REP. PRIOR TO WORK START.
 - J. IT IS THE RESPONSIBILITY OF THE TENANT CONTRACTOR TO ASSURE THAT UNDER FLOOR UTILITIES ARE NOT HARMED DURING THE FLOOR CUTTING/DRILLING OPERATION.
 - K. ALL DATA AND POWER RECEPTACLES TO HAVE WHITE FACE PLATES
 - L. ALL LOW VOLTAGE WIRING TO BE IN CONDUIT (PLENUM RATED) UNLESS OTHERWISE APPROVED BY AUTHORITY HAVING JURISDICTION