

CONSULTANTS:
 MEP ENGINEER:
 AEDIFICA CASE
 796 MERUS COURT
 ST. LOUIS, MO 63026
 PH: (636) 349-1600

SEAL:
 PATRICK G. BLEES, ARCHITECT
 SIGNATURE _____
 DATE ISSUED 11.2.17
 REG. NO. 6140

TORRID
 ACADIANA MALL
 5725 JOHNSTON STREET
 LAFAYETTE, LA
 70503
 SPACE #B-115
 NEW MALL A

SHEET TITLE:
 FIXTURE PLAN AND
 SCHEDULE

REVISIONS:
 NO. DATE BY:

PROJECT NO: 17127.044
 DRAWN BY: SLB

A4

G:\TORRID\17127.044\Drawings\Work in Progress\17127.044_A4_FIX.dwg
 11/2/2017 10:46:30 AM
 c:\users\kell\appdata\local\temp\17127.044\17127.044_A4_FIX.dwg
 11/2/2017 10:46:30 AM

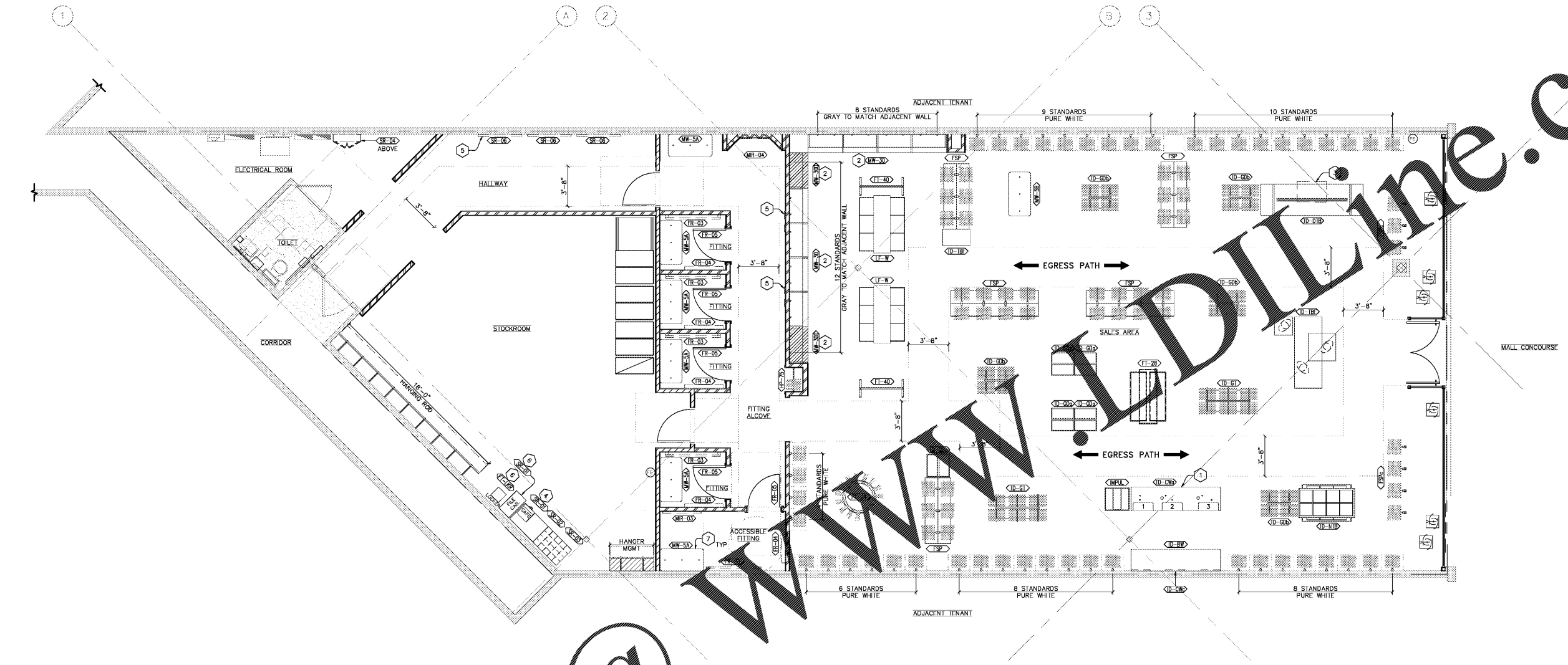

1 FIXTURE PLAN
 A4 SCALE 1/4" = 1'-0"

FIXTURE PLAN KEY NOTES

- CASHWRAP WITH PULL OUT SHELF. SEE AB FOR OUT SHELF.
- INSTALL GRAY STANDARDS AT 18" O.C. AFTER INTIMATE CABINET IS INSTALLED, CUT TO SIZE AS REQ IN FIELD.
- INSTALL PULLOUT DRAWER ON BACKSIDE OF CASHWRAP TO WALL.
- SAFE TO BE BOLTED TO FLOOR PER MANUFACTURER'S DIRECTIONS.
- 22"x30" FRAMED MIRROR TO BE PLACED AS SHOWN.
- SECURE LOCKER HANGING SYSTEM TO WALL.
- SECURE BENCHES TO WALL PER MANUFACTURER'S INSTRUCTIONS ON A5.

NOTE:
 GC TO VERIFY FINAL FIXTURE LAYOUT AS WELL AS FINAL STANDARD LAYOUT WITH TORRID'S PM PRIOR TO INSTALLATION.

GC MISCELLANEOUS DUTIES

- PLACE PLASTIC PIECES FOR ROSE DISPLAY SPIDER TRACK IN CASHWRAP DRAWER FOR TURNOVER.
- ALL SHELVES TO BE INSTALLED IN CASHWRAP FOR TURNOVER (SEE FIP SITE).
- SENSOR DETAGGERS TO BE INSTALLED ON CASHWRAP. NOT BACKWRAP (CONFIRM PLACEMENT WITH TORRID PM).
- NOT USED.
- IF TWO INTIMATES CABINETS ARE RECEIVED AT THE UNIT WITH ALL DRAWERS SHOULD BE INSTALLED AT THE UNIT SEE FIP SITE FOR ASSEMBLY INSTRUCTIONS.
- ALL HARDWARE BOXES TO BE STACKED FOR TURNOVER UNDER CORRIDOR. PLACED BOXES MUST BE FREE AND STACKED BY WALKER.
- ROSE DISPLAY FITTING HOOKS TO BE INSTALLED PER MANUFACTURER'S DIRECTIONS.
- MANAGER'S DESK AND MARKETING UNIT TO BE SUPPLIED AND INSTALLED BY TENANT PER THE LAYOUT ON THE FIP SITE, NO CHANGES ALLOWED WITHOUT RD APPROVAL.
- ROSE RACKING TO BE SUPPLIED AND INSTALLED BY TENANT PER THE SUPPLIED INSTRUCTIONS, NO CHANGES ALLOWED WITHOUT RD APPROVAL.
- PALETTES OF OFFICE SUPPLIES RECEIVED FROM DDS TO BE STACKED BACK TO BACK STARTING AT THE CENTER FLOOR-TO-CEILING POSTS. BOX NUMBERS FACING FORWARD. MUST CONFIRM ALL BOXES RECEIVED AND WITHOUT DAMAGE BEFORE THE DRIVER LEAVES THE SITE. IF ANYTHING IS MISSING OR DAMAGED IT MUST BE INDICATED ON BOL AND TORRID PM NEEDS TO BE NOTIFIED RIGHT AWAY.
- FIXTURE ASSEMBLY REQUIRED UPON DELIVERY OF THE FOLLOWING:
 A. ALL SALES FLOOR TABLES
 B. ALL GONDOLAS AND ACCESSORY FIXTURES
 C. ALL FLOOR-TO-CEILING POSTS
 D. ALL INTIMATE CABINETS
- INSTALL BULLETIN BOARDS AND OTHER MISCELLANEOUS OWNER SUPPLIED ITEMS PER PM/DM DIRECTION.
- SUPPLY FITTING ROOM DOOR FRAMES. FITTING ROOM DOORS TO BE MORTISED BY GC.
- UNBOX ALL SHELVES AND SPREAD EVENLY AROUND PERIMETER OF SALES FOR TURNOVER. BROWN SHELVES BY DENIM TABLE. ALL PALETTES AND BOXES ARE TO BE DISCARDED.
- LEAVE ALL HARDWARE IN BOXES AND PLACE ON EACH SIDE OF THE CENTER POST FIXTURE AND STACKED BY LIKENESS.
- PROVIDE A FORKLIFT WITH EXTENSION AND PALLET JACK -REQUIRED TO UNLOAD TWO DELIVERIES OF FIXTURES.

FIXTURE SCHEDULE														
SYMBOL	DESCRIPTION	SUPPLIED BY	INSTALLED BY	QUANTITY	SYMBOL	DESCRIPTION	SUPPLIED BY	INSTALLED BY	QUANTITY	SYMBOL	DESCRIPTION	SUPPLIED BY	INSTALLED BY	QUANTITY
(TSP)	FREE-STANDING POST, 2-SIDED, SLOTS TO BEGIN AT 6" AFF-ALL OTHER POSTS	TENANT	G.C.	7	(DDB)	DENIM TABLE	TENANT	G.C.	1	(FR-BNCH)	(FR-BNCH) FITTING ROOM BENCH	TENANT	G.C.	1
(FR-04)	36" ROUND W/ GLASS TOP	TENANT	G.C.	1	(DDBL)	(TD-GDBL) H RACK - ACCESSORY	TENANT	G.C.	5	(FR-BNCH-ADA)	(FR-BNCH-ADA) ADA FITTING ROOM BENCH, 24"x48"	TENANT	G.C.	1
(FR-05)	JEWELRY TABLE	TENANT	G.C.	1	(DDBL)	(TD-GDBL) DOUBLE GONDOLA	TENANT	G.C.	5	(FR-WG)	(FR-WG) FITTING ROOM GRID	TENANT	G.C.	5
(FR-06)	ROLLING RACK	TENANT	G.C.	2	(DDBL)	(TD-GTPL) TRIPLE GONDOLA	TENANT	G.C.	2	(FR-MIR)	(FR-MIR) FITTING ROOM MIRROR - CUSTOM FRAMED, BACKLIT	TENANT	G.C.	5
(FR-07)	GO-BACK BAR	TENANT	G.C.	1	(DDBL)	NESTING TABLE	TENANT	G.C.	1	(FR-DOOR)	(FR-DOOR) FITTING ROOM DOOR	TENANT	G.C.	5
(FR-08)	(TRD-MW-SA-04) FR SOFA	TENANT	G.C.	6	(DDBL)	(TD-IBETR) ENTRY TABLE	TENANT	G.C.	1	(DDBL)	(TD-IBETR) SHOE SOFA	TENANT	G.C.	1
(FR-09)	(TRD-MW-SB-03) SHOE SOFA	TENANT	G.C.	1	(DDBL)	MIRROR - CUSTOM FRAMED	G.C.	G.C.	1	(SR-01)	SAFE/FILE CABINET	TENANT	G.C.	1
(FR-10)	PERIMETER WALL FRAME	TENANT	G.C.	1	(DDBL)	MIRROR - CUSTOM FRAMED	G.C.	G.C.	1	(SR-02)	MANAGER'S DESK	TENANT	TENANT'S VENDOR	1
(FR-11)	INTIMATES BACK WALL CABINET	TENANT	G.C.	2	(DDBL)	FITTING ROOM MIRROR - CUSTOM FRAMED, NON BACKLIT	G.C.	G.C.	1	(SR-03)	TUBE STORAGE	TENANT	TENANT'S VENDOR	1
(FR-12)	(TRD-MW30-01-01) INTIMATES BACK WALL SINGLE CABINET	TENANT	G.C.	2	(DDBL)	3-WAY MIRROR	G.C.	G.C.	1	(SR-04)	IT CABINET @ 7"-6" AFF	TENANT	G.C.	1
(FR-13)	PANTY TABLE	TENANT	G.C.	2	(DDBL)	BACK WRAP	TENANT	G.C.	1	(SR-05)	HANGER MANAGEMENT SYSTEM	TENANT	G.C.	1
(FR-14)	BACK WRAP	TENANT	G.C.	1	(DDBL)	CASH WRAP	TENANT	G.C.	1	(SR-06)	BULLETIN BOARD	TENANT	G.C.	3
(FR-15)	(TD-CWSIDE) CASH WRAP SIDE - ADA PORTION	TENANT	G.C.	1	(DDBL)	(TD-CWIR) CASH WRAP MIRRORS	TENANT	G.C.	9	(SR-07)	LOCKER	TENANT	G.C.	1
(FR-16)	(TD-CWIR) CASH WRAP MIRRORS	TENANT	G.C.	9	(DDBL)	(DDBL) SURFACE MOUNTED STANDARDS - SALES AREA, POWDER COATED PURE WHITE	TENANT	G.C.	45	(SR-08)	DETAGGER	TENANT	G.C.	1
(FR-17)	(TD-CWIR) CASH WRAP MIRRORS	TENANT	G.C.	9	(DDBL)	(DDBL) SURFACE MOUNTED STANDARDS - SALES AREA, POWDER COATED GRAY TO MATCH ADJ WALL	TENANT	G.C.	20	(SR-09)	MOBILE SHELVING UNITS	TENANT	TENANT	6
(FR-18)	(TD-CWIR) CASH WRAP MIRRORS	TENANT	G.C.	9	(DDBL)	(DDBL) SURFACE MOUNTED STANDARDS - SALES AREA, POWDER COATED GRAY TO MATCH ADJ WALL	TENANT	G.C.	20	(SR-10)	FIXED SHELVING UNITS	TENANT	TENANT	1
(FR-19)	(TD-CWIR) CASH WRAP MIRRORS	TENANT	G.C.	9	(DDBL)	(DDBL) SURFACE MOUNTED STANDARDS - SALES AREA, POWDER COATED GRAY TO MATCH ADJ WALL	TENANT	G.C.	20	(SR-11)	HANGING ROD - SIZE PER PLAN	TENANT	G.C.	1
(FR-20)	(TD-CWIR) CASH WRAP MIRRORS	TENANT	G.C.	9	(DDBL)	(DDBL) SURFACE MOUNTED STANDARDS - SALES AREA, POWDER COATED GRAY TO MATCH ADJ WALL	TENANT	G.C.	20	(SR-12)	HANGING ROD - HANGER MGMT	TENANT	G.C.	1

NOTE: STANDARDS FOR HANGING RODS FURNISHED BY TENANT. WOOD MOUNTING STRIPS, HANGROD, FASTENERS, AND INSTALLATION BY G.C.