

11/27/2017 10:49:19 AM

**CONSULTANTS:**  
 MEP ENGINEER:  
 AFDICA CASE  
 796 MERUS COURT  
 ST. LOUIS, MO 63028  
 PH: (636) 549-1600

**SEAL:**  
 PATRICK G. BLEES, ARCHITECT  
 SIGNATURE \_\_\_\_\_  
 DATE ISSUED 11.2.17  
 REG. NO. 6140

**TORRID**  
 ACADIANA MALL  
 5725 JOHNSTON STREET  
 LAFAYETTE, LA  
 70503  
 SPACE #B-115  
 NEW MALL A

**SHEET TITLE:**  
 FINISH PLAN AND  
 SCHEDULE

**REVISIONS:**  
 NO. DATE BY:

PROJECT NO: 17127.044  
 DRAWN BY: SLB

**A3**

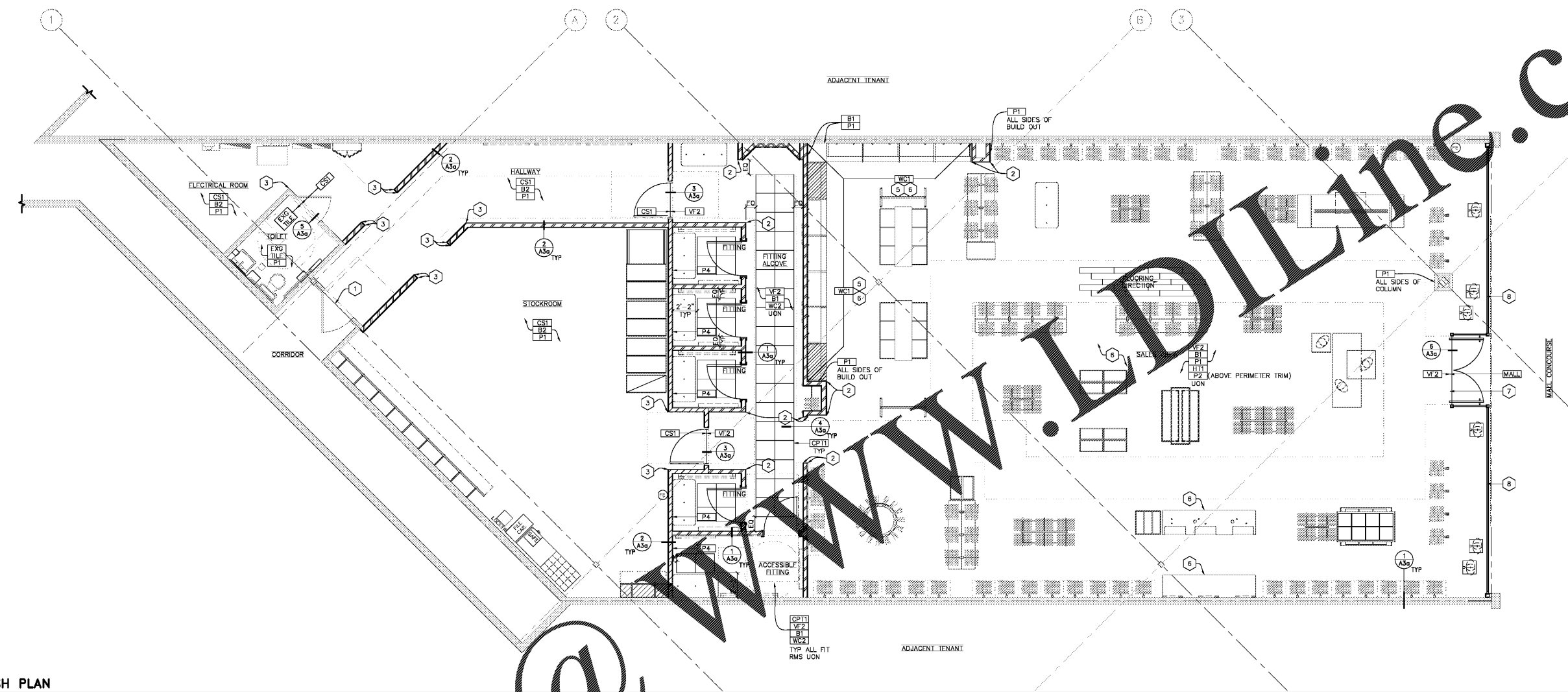

**1 FINISH PLAN**  
**A3 SCALE 1/4" = 1'-0"**

**FINISH PLAN KEY NOTES**

- 1 EXG THRESHOLD TO REMAIN UON ON DOOR/HARDWARE SCHEDULE.
- 2 PROVIDE CORNER GUARDS AT ALL OUTSIDE CORNERS IN SALES TO CEILING/SOFFIT/BULKHEAD ABOVE. SEE ELEVATIONS AND A7 FOR ADDITIONAL INFORMATION. GUARD TO RUN FULL HEIGHT W/O SEAM.
- 3 PROVIDE CORNER GUARDS AT ALL OUTSIDE CORNERS IN STOCKROOM TO 4'-0" AFF. SEE ELEVATIONS AND A7.
- 4 NOT USED.
- 5 NO BASE OR SHOE BASE ON WALL BEHIND INTIMATES CABINET. INSTALL SHOE BASE AROUND CABINET AFTER CABINET HAS BEEN INSTALLED. PAINT TO MATCH.
- 6 PROVIDE SHOE BASE AROUND CASHWRAP, BACKWRAP, SALES AREA WALLS, AND INTIMATE CABINETS. PAINT TO MATCH.
- 7 MALL FINISH TO CLOSURE LINE. COORDINATE WITH MALL OPERATIONS.
- 8 REFER TO SHEET A6 & A6a FOR STOREFRONT FINISHES.

**FINISH SCHEDULE**

SYMBOL	DESCRIPTION (SPECIFIED VENDOR, IF APPLICABLE, IN PARENTHESES)
<b>BASE</b>	
[B1]	HARDWOOD BASE - 6" HIGH, PAINTED [P2] AT SALES AREA UON AND [P1] AT FITTING ROOMS AND ALCOVE. SEE DETAIL ON A3a. HIGH GLOSS.
[B2]	"JOHNSONITE" - "BLACK" #40, 4" HIGH RUBBER COVERED BASE. PROVIDE 90 DEGREE CORNERS WHERE REQ. SEE DETAIL ON A3a.
<b>CEILING</b>	
[ACT1]	"ARMSTRONG" - 24"x48"x3/4" WHITE "CORTEGA" SECOND LOOK II # 2767 REGULAR ANGLED TILE IN 15/16" WHITE PRELUDE GRID. SALES AREA PAINTED [P2].
<b>FLOORING</b>	
[CS1]	"SURTIC" - #CS-672 W/ #975 CONCRETE SEALER APPLICATION. GRIND FLOOR W/ 80 GRIT DIAMOND PAD, FILL JOINTS AND CRACKS W/ URETHANE BASED CAULK. PATCH AREAS OF DAMAGED SLAB W/ "CGM BUILDING PRODUCTS" - LEV-L-ASTIC COMPOUND. SAND SMOOTH ANY AREAS THAT WERE PATCHED AND REMOVE DUST. APPLY TWO (2) COATS PRIMER AND THREE (3) COATS SEALANT.
[CPT1]	CARPET TILE, 20"x20". FURNISHED BY TENANT, INSTALLED BY GC WITH GRID-SET GREEN GLUE 2000.
[CPT2]	"CONCEPT SURFACE" - 100% "DOME GREY" 12"x24" SATIN FINISH. INSTALL IN RUNNING BOND PATTERN. GROUT JOINTS TO BE 1/16" MAX.
[VF1]	"ARMSTRONG" - CONNECTION CORLON #88712 "LIMESTONE" SHEET GOOD OR APPROVED EQUAL. SEE DETAIL ON A3a.
[VF2]	"MATS INC" - PLANK COLLECTION, ASI #W7550 GRAY ASI, 6"x36" PLANK. SEE DETAIL ON A3a. FURNISHED BY TENANT, INSTALLED BY GC.
<b>WALL FINISHES</b>	
[FRP]	FIBERGLASS REINFORCED PANEL - WHITE W/ SMOOTH FINISH, W/ ALL REQ. TRIM/CAPS.
[H11]	1x3 HARDWOOD PERIMETER TRIM. PAINT [P1]. SEE ELEVATIONS ON SHEET A5 AND DETAIL ON 10/A7.
[M1L]	BRAKE METAL PANEL. MINIMUM 18 GAUGE, POWDER COATED WHITE, RAL #9003, GLOSS FINISH.
[P1]	"SHERWIN WILLIAMS" - "PURE WHITE" #7005. WALLS: EGGSHELL; CEILING/DECK: FLAT LATEX. FITTING ROOM DOOR FRAMES AND WALL BASE: HIGH GLOSS. CUSTOM MIRROR FRAME: HIGH GLOSS. NON-FITTING ROOM DOORS AND FRAMES: SEMI-GLOSS.
[P2]	"BENJAMIN MOORE" - "GRAY DEL RAY" #1614. WALLS: EGGSHELL; CEILING/DECK: FLAT LATEX. WALL BASE: HIGH GLOSS. CUSTOM MIRROR FRAME: HIGH GLOSS.
[P3]	"BENJAMIN MOORE" - "OVERDOSE" #CC-544. OUTLET ONLY. WALLS: EGGSHELL. DOORS: SEMI-GLOSS; DOOR FRAMES: HIGH GLOSS.
[P4]	"GLIDDEN" - "PEACOCK PINK" #30YR 38/337. WALLS: EGGSHELL.
[WC1]	"DENVOVO WALL" - POPOLO "STEEL BEAM" #DN2-POP-06. FURNISHED BY TENANT, INSTALLED BY GC.
[WC2]	"DENVOVO WALL" - POPOLO "VANILLA ICE" #DN2-POP-01. FURNISHED BY TENANT, INSTALLED BY GC.
<b>NOTES:</b>	
1. INTERIOR FINISHES TO HAVE A MINIMUM FLAME SPREAD AND SMOKE DEVELOPED INDEX OF CLASS C.	
2. ALL DOORS, DOOR FRAMES, AND DOOR TRIM TO BE HIGH GLOSS PAINT FINISH.	
3. G.C. TO DO "TOUCH-UP" PAINTING AT DAY OF STORE OPENING.	

**GC MISCELLANEOUS AND TURNOVER DUTIES**

1. MEET PHONE COMPANY FOR PHONE LINES AND JACK INSTALLATION:  
 A. CALL IN ADVANCE TO FIND OUT EXPECTED TIME OF ARRIVAL.  
 B. INSTRUCT PHONE TECH TO INSTALL (1) JACK AT #1 CASH REGISTER LOCATION.  
 C. EVERY JACK SHOULD BE CLEARLY LABELED WITH PHONE NUMBER.  
 D. CALL NANCY BENNETT AT (626) 839-4681 TO VERIFY INSTALLATION IS COMPLETE.
2. INSTALL LADDER HOOKS TO HOLD LADDERS OFF THE FLOOR - COORDINATE WITH DISTRICT MANAGER (DM) FOR LOCATION.
3. CONDUCT FINAL WALK THROUGH WITH DM:  
 A. BE SURE THEY HAVE ALL KEYS TO THE STORE.  
 B. WRITE DOWN ANY EXTRA REQUESTS FROM DM ON STORE INSPECTION SHEET.  
 C. VERIFY THE LIST IS COMPLETED BEFORE YOU LEAVE THE JOB SITE.  
 D. DM MUST SIGN OFF ON THIS PORTION OF GC'S DUTIES FOR COMPLETION OF PUNCH LIST.
4. TRUCK ARRIVAL:  
 A. TRUCK WILL ARRIVE ON FRIDAY AT 7:00 AM.
5. BE PRESENT TO CORRECT ANY PROBLEMS THAT MAY ARISE DURING CONNECTIVITY TEST TO CAT 5 WIRING CONDUCTED BY TORRID PROJECT MANAGER.
6. COVER AND PROTECT CARPET TILES AFTER INSTALLATION.
7. PROVIDE SECOND DUMPSTER AT TURNOVER FOR TENANT REFUSE.

**GC FINAL CLEANING DUTIES**

CONTRACTOR TO MAKE SURE THAT THE CLEANING CREW BRINGS THE NECESSARY CLEANING PRODUCTS TO PERFORM THE CONTRACTED WORK. THOSE INCLUDE, BUT ARE NOT LIMITED TO GLASS CLEANERS, MOPS, BUCKETS, RAGS, SOAP, TOWELS, ETC. CLEAN AREAS AS FOLLOWS:

1. STOREFRONT: GLASS WIPED DOWN AND CLEANED WITH APPROVED CLEANER, SIGN DUSTED AND CLEANED, GLASS FRAMING WIPED DOWN, TAPE AND STICKER WASTE CLEANED OFF OF ALL SURFACES.
2. SALES AREA: FLOORS SWEEP AND WET MOPPED, HVAC DIFFUSERS WIPED FREE OF DUST, LIGHTS WIPED FREE OF DUST, SLATWALL WIPED FREE OF DUST AND TAPE.
3. CASHWRAP: COUNTERTOPS CLEANED WITH APPROVED CLEANER, SHELVES AND DRAWERS WIPED FREE OF DUST. COLUMNS AND SLATWALL WIPED FREE OF DUST AND DEBRIS. BASE BOARDS WIPED AND CLEANED.
4. FITTING ROOM(S): DOORS, FRAMES AND MIRRORS CLEANED, FLOORS MOPPED AND BASE BOARDS WIPED CLEAN.
5. STOCKROOM: FLOORS AND SHELVES CLEANED TO BE WIPED FREE OF DUST, ETC.
6. RESTROOM: FLOOR MOPPED, SINK AND TOILET CLEANED WITH APPROVED CLEANING AGENT, MIRRORS AND HARDWARE WIPED CLEAN.
7. MISC: ALL CONSTRUCTION DEBRIS SHALL BE REMOVED FROM STORE, TRASH TAKEN TO DUMPSTER.

C:\TORRID\17127.044\Drawings\Work in Progress\17127.044\_A3\_FINISH.dwg  
 Torrid - 11/27/2017 10:49:19 AM  
 Order Plans @