

CONSULTANTS:
 MEP ENGINEER:
 AEDIFICA CASI
 796 MERUS COURT
 ST. LOUIS, MO 63026
 PH: (636) 349-1600

SEAL:
 PATRICK G. BLEES, ARCHITECT
 SIGNATURE _____
 DATE ISSUED 11.2.17
 REG. NO. 6140

TORRID
 ACADIANA MALL
 5725 JOHNSTON STREET
 LAFAYETTE, LA
 70503
 SPACE #B-115
 NEW MALL A

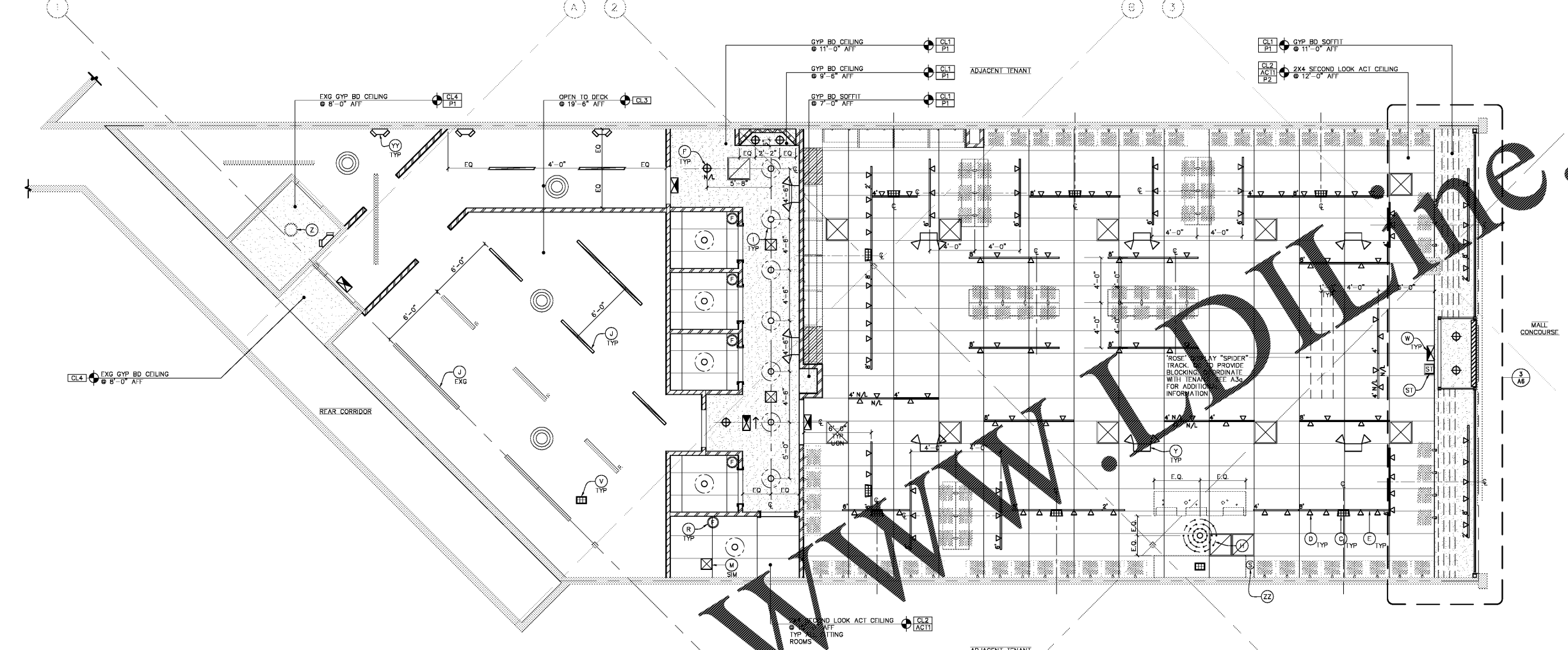

1 REFLECTED CEILING PLAN
 A2 SCALE 1/4" = 1'-0"

SYMBOL	DESCRIPTION
CL1	5/8" GYP BD OVER 3-5/8" X 18 GA MTL STUDS (3825162-43) @ 16" O.C. PREPARE FOR PAINT OR OTHER FINISHES AS NOTED. HEIGHT PER PLAN.
CL2	ACoustICAL CEILING SYSTEM. ENSURE GRID AND TILES ARE COMPATIBLE PRIOR TO ORDERING. ALL PIPES/CONDUIT/DUCTWORK ETC. TO BE ABOVE CEILING IF POSSIBLE. ANY COMPONENTS THAT ARE TO BE BELOW CEILING ARE TO BE GANGED, PARALLEL AND PERPENDICULAR TO LEASE LINES.
CL3	TO REMAIN OPEN TO DECK ABOVE. ALL CONDUITS SHALL BE GANGED, PARALLEL, & PERPENDICULAR TO LEASE LINES. ALL PIPES, DUCTS, & FIXTURES SHALL BE SUPPORTED FROM HANGRODS, NOT WIRE. REMOVE ANY UNUSED ITEMS. VERIFY HEIGHT IN FIELD.
CL4	EXG GYP BD SOFFIT/CEILING. PATCH/REPAIR/REPLACE AS REQ FOR NEW FINISHES.
CL5	EXG ACoustICAL CEILING SYSTEM. PATCH/REPAIR/REPLACE AS REQ TO MATCH EXG.

TAG	SYMBOL	DESCRIPTION	BULB	MOUNT	WATT	EXG	RELO	NEW
A		NOT USED						
B		"JUNO" TRAC-MASTER LED WALL WASH/FLOOD 1259L-3K-WH		TRACK	59			8
D		"JUNO" TRAC-MASTER SPOTLIGHT 1689-WH W/ LED PAR30 LAMP		TRACK	15			111
E		2'-0" SINGLE CIRCUIT TRACK - WHITE FINISH						4
F		4'-0" SINGLE CIRCUIT TRACK - WHITE FINISH		SUSPEND AT 12'-0" AFF				10
G		6'-0" SINGLE CIRCUIT TRACK - WHITE FINISH						9
H		8'-0" SINGLE CIRCUIT TRACK - WHITE FINISH						15
I		"JUNO" 8" VERTICAL CFL DOWNLIGHT		RECESSED	42			6
J		CV8-126/32/42/1-820C-WH						
K		"ACCESS LIGHTING" PEARL WALL SCONCE #23970-BS/WH	F-28	GENEALINE OF J-BOX @ 5'-8"	80			
L		"TROY LIGHTING" CEILING PENDANT, MODEL# KF17414-20-1, POLISHED STAINLESS STEEL FINISH LED4E12B-1127K CANDELABRA (*BASED ON 15 WATT SOCKETS)	(30)4W LED TORPEDO	SUSPENDED, BOT @ 7'-9"	450			1
M		"TROY LIGHTING" CEILING PENDANT, MODEL# KF17414-20-1, POLISHED STAINLESS STEEL FINISH LED4E12B-1127K CANDELABRA (*BASED ON 15 WATT SOCKETS)	(6)15W E14 CLEAR BALL INCAN	SUSPENDED, BOT @ 7'-9" IN FIT RMS AND 8'-6" IN FIT ALCOVE	120			12
N		TOILET: 48" "LITHONIA" ZLN L48 3000LM FST MVOLT 30K 80CRI WH/ LED		SURFACE	64			
O		STOCK/HALL: 48" "LITHONIA" ZLN L48 3000LM FST MVOLT 30K 80CRI WH/ LED		BOT @ 13'-0"	64	8	3	7
P		SALES: 48" 2-TUBE STRIP FLUORESCENT		BOT @ 14'-0"	64			
Q		MECHANICAL SUPPLY - SEE MECHANICAL SHEET		RECESSED/SURFACE				
R		ROUND MECHANICAL SUPPLY DIFFUSER - SEE MECHANICAL SHEET		SURFACE				
S		MECHANICAL RETURN - SEE MECHANICAL SHEET		RECESSED/SURFACE				
T		BACKLIT MIRROR FIXTURES	(2) 08" SLIMITE XL 15	PREMOUNTED ON FIXTURE.	35			5
U		FITTING ROOM FAN - SEE ELECTRICAL SHEETS		SEE NOTE 7				5
V		SHOPPERTRAK - SEE ELECTRICAL SHEETS		SEE ELFC				1
W		DOOR BUZZER IN CLG		RECESSED/SUSPENDED DIRECTLY BELOW CLG OR 80T @ 12'-0" DIRECTLY BELOW CLG OR 80T @ 12'-0"				2
X		EXIT SIGN W/ REQ LETTERS		BELOW CLG OR 80T @ 12'-0" DIRECTLY BELOW CLG OR 80T @ 12'-0"				5
Y		EXIT SIGN/EMERGENCY LIGHT COMBO W/ REQ LETTERS		BELOW CLG OR 80T @ 12'-0" DIRECTLY BELOW CLG OR 80T @ 12'-0"				8
Z		SALES/FITTING ALCOVE: "LITHONIA" ELM1-LPOVS W/90 BATTERY BACK UP		C.G MOUNTED OR BOTTOM @ 12'-0"				
AA		STOCK/HALL/TOILET: "MAXIMUM" ELM-LD-803 W/90 BATTERY BACK UP		WALL MOUNT @ 8'-0"				4
AB		EXG EXHAUST FAN/LIGHT COMBO - SEE MECHANICAL SHEET		RECESSED/SURFACE				1
AC		REMOTE TEMPERATURE SENSOR		SEE NOTE B				1

NOTES:
 1. ALL FIXTURES THAT ARE EXG TO REMAIN ARE TO BE CLEANED TO "LIKE-NEW" AND RELAMPED BY GC. GC TO REBALLAST FIXTURES ONLY AS REQ.
 2. ALL STOREFRONT LIGHTS AND SIGNAGE ARE TO BE ON A 24-HR TIMER SET BY GC. COORDINATE REQ HOURS WITH LANDLORD.
 3. LIGHTING VENDOR IS RESPONSIBLE FOR VERIFYING CORRECT NUMBER OF FIXTURES/LAMPS REQ.
 4. ALL NEW LIGHTING IS SUPPLIED BY TENANT'S VENDOR AND INSTALLED BY GC. UON.
 5. "N/L" INDICATES NIGHT LIGHT FIXTURES. COORDINATE WITH E2.
 6. "R" INDICATES EXG LIGHT FIXTURES TO BE RELOCATED. COORDINATE WITH E2.
 7. FAN IS TO BE CEILING MOUNTED AND ORIENTED SO THAT AIR FLOW IS DIRECTED TOWARD FITTING ROOM BENCH. PROVIDE BLOCKING IN CEILING FOR ADEQUATE SUPPORT OF FAN. REFER TO CUT SHEET ON TORRID FIP SITE AND ELECTRICAL SHEETS FOR ADDITIONAL INFORMATION.
 8. CEILING MOUNTED REMOTE THERMOSTAT SENSOR. SEE MECHANICAL SHEETS. CONFIRM THAT SENSOR IS COMPATIBLE WITH HORIZONTAL MOUNTING INSTALLATION.

PROJECT NO: 17127.044
 DRAWN BY: MMK
A2