

1. REMOVE WALL TO COMBINE BOTH JURY ROOMS
2. CREATE HALL FOR PRISONERS TO ENTER COURTROOM FROM EXISTING OFFICES
3. SHERIFF OFFICE ON THIRD FLOOR
4. CREATE TWO CONFERENCE ROOMS FOR LAWYER / CLIENTS

KEYED NOTES	
1	DEMO DOOR
2	NEW DOOR
3	DEMO WALL
4	NEW WALL
5	--
6	SECURE WINDOW
7	NEW CEILING GRID AND TILE

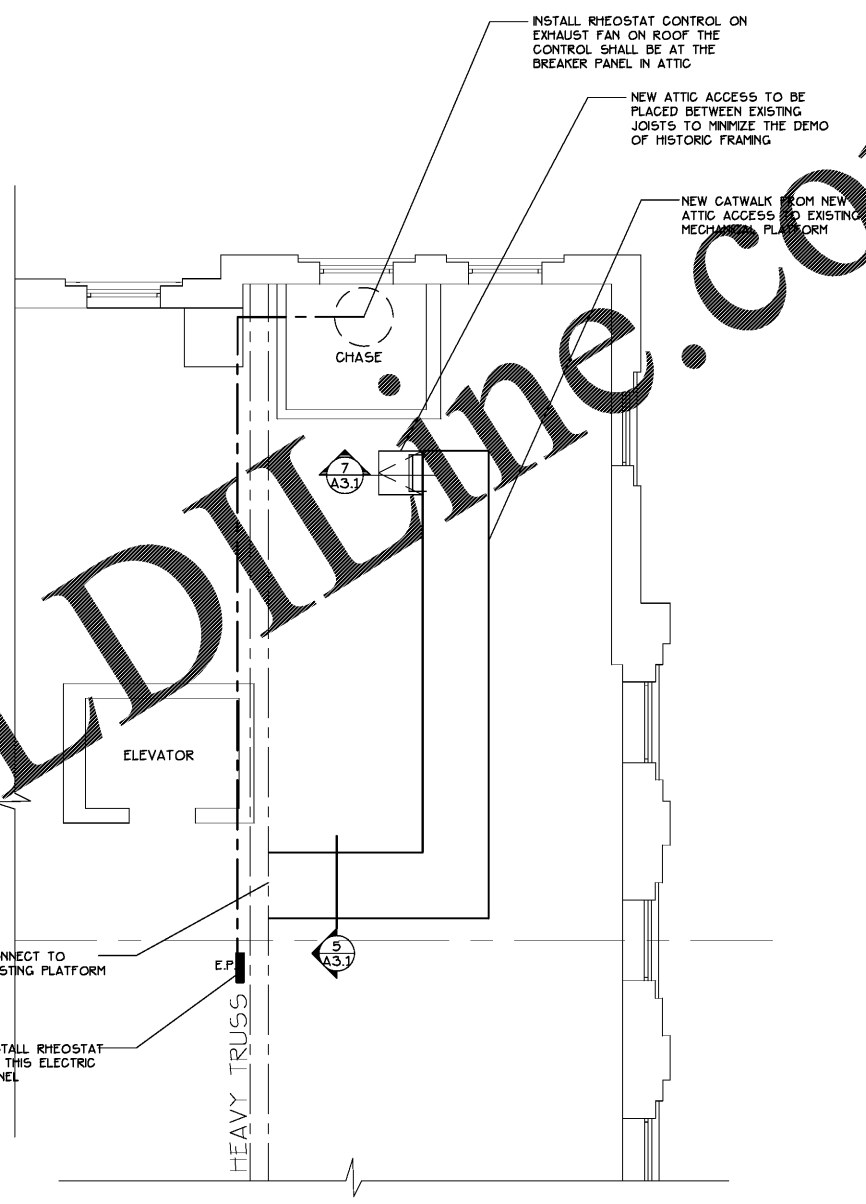

1 SECOND FLOOR RENOVATION PLAN
A2.1 1/4" = 1'-0"

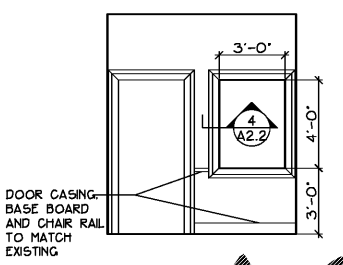

3 WINDOW ELEVATION
A2.1 1/4" = 1'-0"

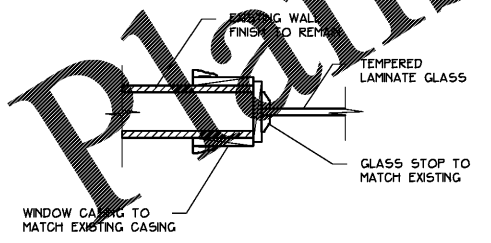

4 WINDOW TRIM DETAILS
A2.1 1/2" = 1'-0"

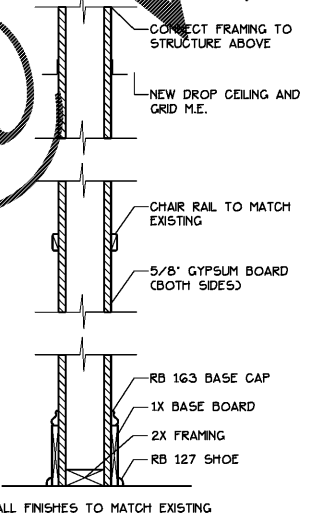

5 WALL DETAILS
A2.1 1/2" = 1'-0"

2 PARTIAL ATTIC PLAN
A2.1 1/4" = 1'-0"

SCHEDULE OF REVISIONS	
#	DATE

STATUS	
PROJECT NUMBER:	0841 C
PROJECT DATE:	1 NOV 2017
DRAWN BY:	FRD
APPROVED BY:	xxx

SHEET DESCRIPTION	
A2.1	

Order Plans

www.ldilvine.com