

KEYNOTES

- 1 EXISTING LIGHT FIXTURE SHALL BE DISCONNECTED, REMOVED AND TURNED OVER TO OWNER OR DISPOSED OF PROPERLY, AS DIRECTED. EXISTING LIGHTING CIRCUIT SHALL BE EXTENDED TO MAINTAIN ALL EXISTING LIGHT FIXTURES (TO REMAIN) IN OPERATION.
- 2 RELOCATE EXISTING LIGHT FIXTURE TO ACCOMMODATE NEW CONSTRUCTION. EXTEND EXISTING LIGHTING CIRCUIT TO NEW LOCATION, OR RE-WORK LIGHTING CIRCUIT(S), AND WIRE COMPLETELY. REFER TO 2/E4 FOR NEW LIGHT FIXTURE LOCATION.
- 3 ALL ELECTRICAL EQUIPMENT IN THIS AREA IS EXISTING TO REMAIN, UNLESS NOTED OTHERWISE.
- 4 ALL LIGHT FIXTURES IN THIS AREA ARE EXISTING TO REMAIN, UNLESS NOTED OTHERWISE.
- 5 EXISTING CHECKOUT/PHARMACY CASEWORK SECTION TO BE MODIFIED OR REPLACED WITH NEW ADA-COMPLIANT CASEWORK SECTION. CONTRACTOR SHALL DISCONNECT EXISTING POWER AND TELECOMMUNICATIONS CIRCUITS/CABLING SERVING EXISTING CASEWORK/EQUIPMENT, AS NEEDED, TO ALLOW FOR REMOVAL OF CASEWORK/EQUIPMENT, AND RE-CONNECT TO NEW CASEWORK/EQUIPMENT ONCE IT HAS BEEN INSTALLED.
- 6 PROVIDE AND INSTALL UNDERCARPET FLATWIRE FROM BASE OF EXISTING, NEAREST, POWER POLE, COLUMN OR WALL, UNDER CARPET AND OVER TO BASE OF STORE FIXTURE. EXTEND NEW POWER CIRCUIT INDICATED FROM PANEL, DOWN TO FLATWIRE AND OVER TO STORE FIXTURE. PROVIDE ALL NECESSARY PARTS FOR COMPLETE FLATWIRE INSTALLATION. FIELD VERIFY ELECTRICAL REQUIREMENTS AND ROUTING WITH OWNER PRIOR TO ORDERING MATERIALS.
- 7 VERIFY THAT EXISTING WALL-MOUNTED OCCUPANCY SENSOR LIGHT SWITCHES ARE FUNCTIONING PROPERLY. REPLACE ANY DAMAGED DEVICES. IF REQUIRED, RELOCATE EXISTING SWITCH TO NEW WALL TO ACCOMMODATE NEW CONSTRUCTION.
- 8 EXISTING FLM COOLER AND ATM ADJACENT TO THE MAIN ENTRY DOORS ARE TO BE SWAPPED. CONTRACTOR SHALL SWAP POWER CIRCUIT AND ASSOCIATED TELE/DATA OUTLET TO ACCOMMODATE RELOCATED EQUIPMENT. PROVIDE NEW DUPLEX RECEPTACLES AT NEW LOCATIONS, EXTEND EXISTING POWER CIRCUITS TO NEW RECEPTACLES AND WIRE COMPLETELY.
- 9 EXISTING PHOTO LAB EQUIPMENT/CASEWORK TO BE REMOVED OR RELOCATED. CONTRACTOR SHALL DISCONNECT POWER AND DATA CONNECTIONS TO EXISTING EQUIPMENT/CASEWORK, MAINTAIN EXISTING CIRCUITS IN THE SAME AREA AND USE EXISTING CIRCUITS TO SERVE NEW EQUIPMENT/CASEWORK AS SHOWN ON 1/E4.
- 10 EXISTING PHOTOLAB POS STATION TO BE RELOCATED TO MAIN CHECKOUT CASEWORK. DISCONNECT POWER AND TELECOM CONDUCTORS/CABLING AT EXISTING LOCATION, EXTEND CIRCUITS/CABLING TO NEW LOCATION AND WIRE COMPLETELY. PROVIDE NEW POWER AND TELECOM OUTLETS (MATCHING EXISTING) AT NEW LOCATION. FIELD COORDINATE INSTALLATION WITH OWNER PRIOR TO ROUGH-IN.
- 11 PROVIDE JUNCTION BOX FOR HAND DRYER AT +54" AFF. CONNECT TO 20A-1P BREAKER WITH 2 #10 & 1 #10(G) - 3/4"C.

GENERAL NOTES

1. ALL EMPTY CONDUITS MUST HAVE PULLWIRES AND BE TAGGED PROPERLY.
2. TIE BACK ALL LOOSE WIRING (INCLUDING LOW VOLTAGE) IN AN ORDERLY FASHION.
3. AVOID RUNNING LOW VOLTAGE WIRE OVER HIGH VOLTAGE WIRING OR LIGHT FIXTURES.
4. PROVIDE CONDUIT FOR ALL WIRING, INCLUDING BUT NOT LIMITED TO CONTROL, FIRE ALARM, POWER AND COMMUNICATIONS WIRING. COORDINATE INSTALLATION AND ROUTING REQUIREMENTS WITH APPROPRIATE INSTALLER(S).
5. UNDERFLOOR OR IN SLAB CONDUIT SHALL BE METAL WITH CONCRETE-TIGHT COMPRESSION FITTINGS WHERE PENETRATING FLOOR SLAB AND SHALL STUB UP VERTICALLY 90 DEGREES. WHERE CONDUITS COME IN DIRECT CONTACT WITH GROUND, METAL CONDUITS SHALL BE COATED WITH TWO COATS OF ASPHALTUM OR BITUMASTIC.
6. SUBSCRIPTS ARE AS FOLLOWS:
 EX - EXISTING TO REMAIN
 ER - EXISTING TO BE RELOCATED TO NEW LOCATION SHOWN
 ED - EXISTING TO BE DEMOLISHED
 NEW - NEW
7. CONTRACTOR SHALL FIELD COORDINATE ROUTING OF NEW CIRCUITS AND TELEPHONE/DATA CABLING. WHERE POSSIBLE, USE E.M.T. CONDUIT CONCEALED BEHIND FINISHED WALLS, CEILING, COLUMN COVERS, etc. IF NOT ABLE TO BE CONCEALED BEHIND FINISHED SURFACES, CONTRACTOR SHALL UTILIZE WIRING CHASES/POWER POLES OR WIREMOLD TYPE, SURFACE-MOUNTED, METAL RACEWAYS TO EXTEND POWER AND TELE/DATA CABLING FROM ABOVE FINISHED CEILING DOWN TO OUTLET LOCATIONS. THE USE OF WIRING CHASES/POWER POLES AND SURFACE-MOUNTED RACEWAYS SHALL BE APPROVED BY THE OWNER PRIOR TO ORDERING AND ROUGH-IN.
8. CONTRACTOR SHALL CLEAN EXISTING LIGHT FIXTURES THROUGHOUT RENOVATED SPACES AND REPLACE ALL BURNED-OUT LAMPS. FIELD VERIFY THAT ALL LAMPS IN RENOVATED AREAS MATCH IN COLOR TEMPERATURE (i.e. 4100K). REPLACE ALL LAMPS THAT DO NOT MATCH. REPLACE BALLASTS AS NEEDED. REPLACE DAMAGED OR YELLOWED ACRYLIC LENSES AS NEEDED.
9. CONTRACTOR SHALL TEST ALL EXISTING EMERGENCY LIGHT FIXTURES AND EXISTING SIGNS THROUGHOUT BUILDING. BATTERIES SHALL POWER LIGHT FIXTURE/SIGN FOR A MINIMUM OF 90-MINS. ANY LIGHT FIXTURE/SIGN THAT DOES NOT PASS TESTING SHALL BE REPLACED WITH A NEW LIGHT FIXTURE/SIGN MATCHING THE EXISTING BUILDING/OWNER STANDARD.
10. CONTRACTOR SHALL FIELD COORDINATE WITH OWNER WHETHER OR NOT EXISTING WALL WASH LIGHT FIXTURES ARE TO BE DEMOLISHED IN THIS STORE. IF TO BE DEMOLISHED, THEN CONTRACTOR SHALL DISCONNECT POWER TO FIXTURES, REMOVE FIXTURES AND TURN FIXTURES OVER TO OWNER OR PROPERLY DISPOSE OF FIXTURES AS DIRECTED. EXISTING CIRCUIT(S) SHALL BE DISCONNECTED FROM PANELBOARD AND REMOVED.

LIGHTING FIXTURE SCHEDULE

SYMBOL	DESCRIPTION	MOUNTING	VOLT	VA	LAMPS	BALLASTS	REMARKS/NOTES
T	NEW 2X4 RECESSED PARABOLIC LITHONIA/ZE88PHE 232 0510SXH S841HTB	RECESSED	120	61	2-F032/841/XPS/ECO	1-QHE3X32SHSC	LAMPS FACTORY INSTALLED.
T1	NEW 2X4 RECESSED EMERGENCY PARABOLIC LITHONIA/ZE88P 232 1/3 0510SX S841HTB-NACV-EL14	RECESSED	120	61	2-F032/841/XPS/ECO	1-QHE3X32SN-PS1400	LAMPS FACTORY INSTALLED PROVIDE WITH AN EMERGENCY BATTERY PACK (LITHONIA #PS1400)
EX	EXISTING 2X4 RECESSED PARABOLIC	RECESSED	120	61	2-F032TB-3500K		
EX	EXISTING 4' OR 2' RECESSED WALL WASHER	RECESSED	120	94/47	2-F47W - BIAx 1-F47W - BIAx		
EX	EXISTING RECESSED 1X4 WITH CLEAR ACRYLIC PRISMATIC LENS	RECESSED	120	48	2-F032TB-3500K		

CVS HAS DEVELOPED SPECIAL PRICING AND READILY AVAILABLE STOCK WITH THE NAI PREFERRED SUPPLIER.
 WIENBACH-BROWN CO., INC.
 PHONE: 888-230-1569
 EMAIL: CVSSUPPORT@WBBLIGHT.COM
 NESCO, INC.
 JEFF CHASE
 PHONE: 781-737-1084
 EMAIL: JCHASE@NESCOWEB.COM

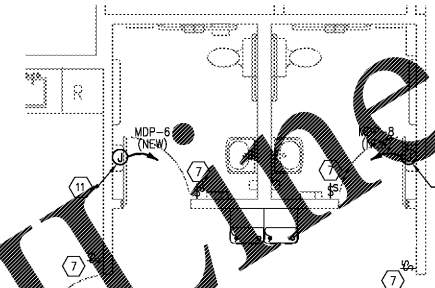

2 ELECTRICAL PLAN - RESTRMS

SCALE: 1/4" = 1'-0"
 POWER PLAN NOTES:
 1. PROVIDE AND INSTALL POWER TO A NEW HAND DRYER IN EACH RESTROOM.
 2. ALL ITEMS SHOWN ON THIS PLAN ARE NEW, UNLESS NOTED OTHERWISE BY SUBSCRIPT.

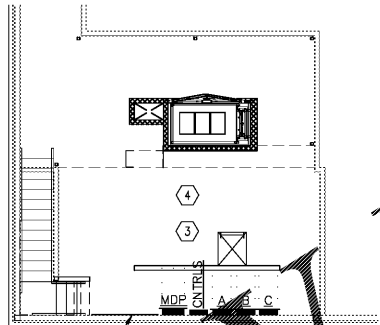

3 PARTIAL UPPER LEVEL PLAN ELECTRICAL EQUIPMENT

SCALE: 1/8" = 1'-0"

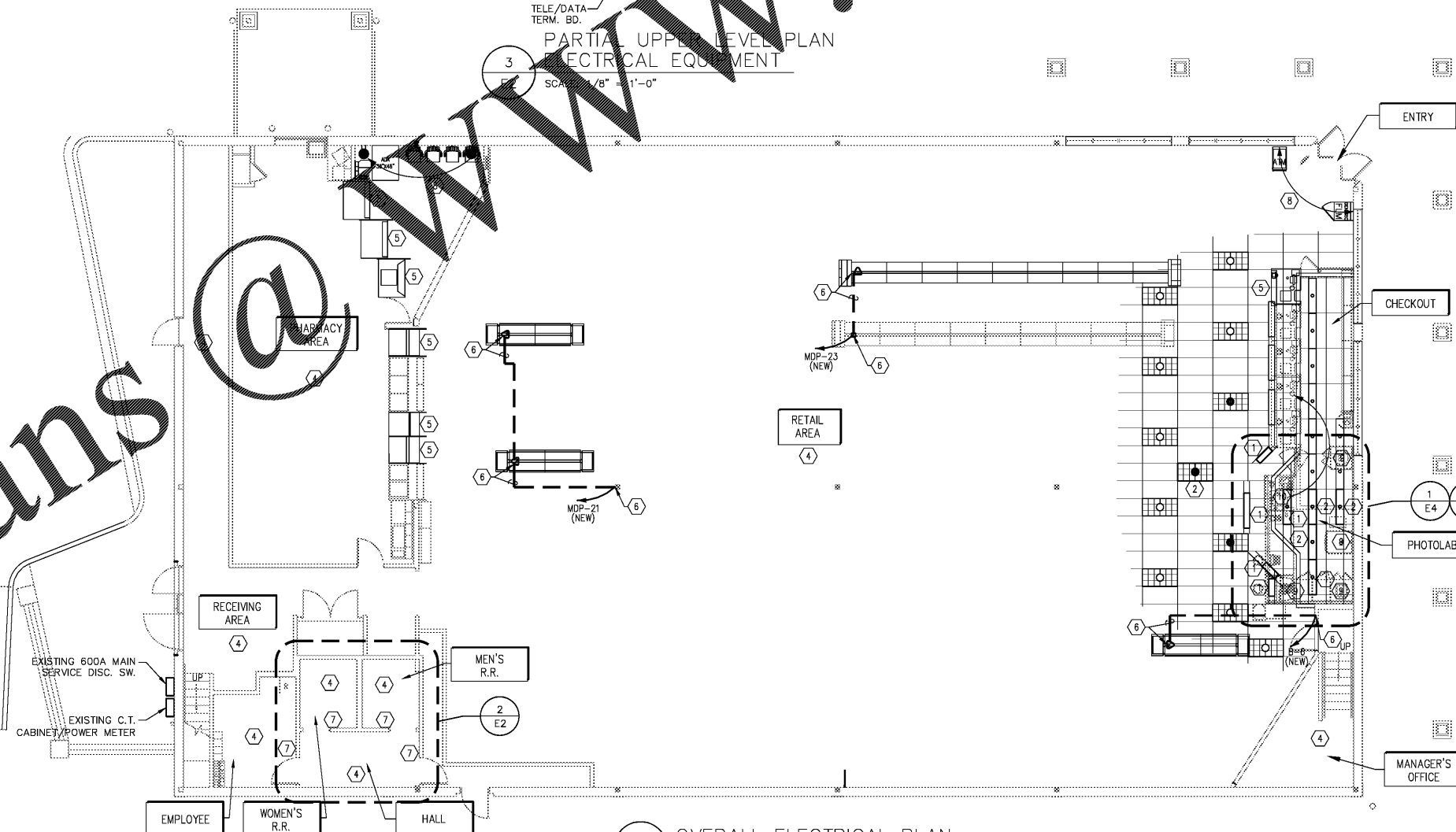

1 OVERALL ELECTRICAL PLAN
 E2 SCALE: 1/8" = 1'-0"



STORE NUMBER: 5553
 101 BEN SAWYER BOULEVARD
 MT. PLEASANT, SC 29464
 PROJECT TYPE ADA and THH
 DEAL TYPE
 CS PROJECT NUMBER: 106857

ARCHITECT OF RECORD
LITTLE
 ARCHITECTS
 1000 MARKET ST. SUITE 200
 CHARLOTTE, NC 28202
 www.littleonline.com
 This drawing and the design shown are the property of Little Architectural Consulting. The reproduction, copying or other use of this drawing without their written consent is prohibited and any infringement will be subject to legal action.

CONSULTANT:
SHULTZ ENGINEERING GROUP, PC
 2000 W. 10TH ST.
 CHARLOTTE, NC 28203
 www.shultzeng.com

DEVELOPER:
CVS pharmacy

SEAL:
 SOUTH CAROLINA PROFESSIONAL ENGINEER
 No. 24000
 SHULTZ ENGINEERING GROUP, PC
 No. 209
 5-5-2017

REVISIONS:

CVS PROJECT MANAGER: TS
 DRAWING BY: JAC
 DATE: 10-23-2017
 JOB NUMBER: 121-7815-08
 TITLE: OVERALL ELECTRICAL PLAN
 SHEET NUMBER:

E2
 COMMENTS:

Order Plans