

**E1 EIFS TYP BAND & BRACKET DETAIL**  
SCALE: 3"=1'-0"

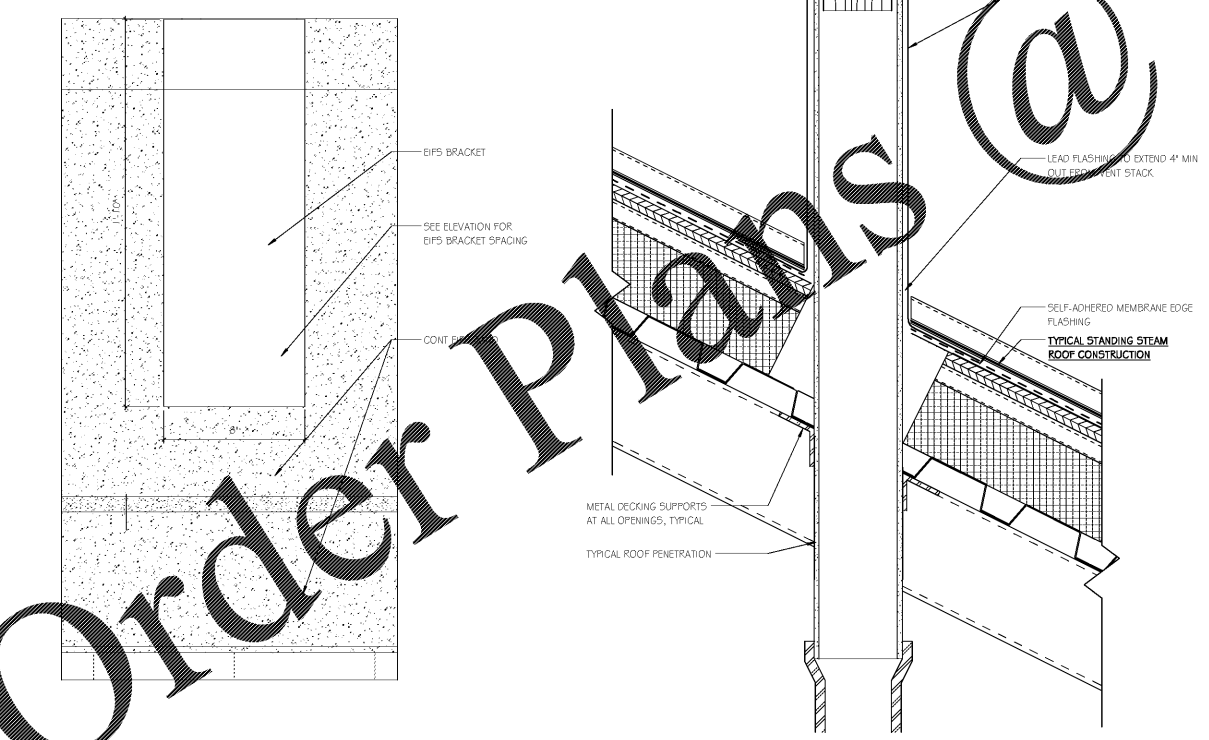

**A1 EIFS ELEVATION DETAIL**  
SCALE: 3"=1'-0"

**A3 TYP METAL ROOF PENETRATION**  
SCALE: 3"=1'-0"

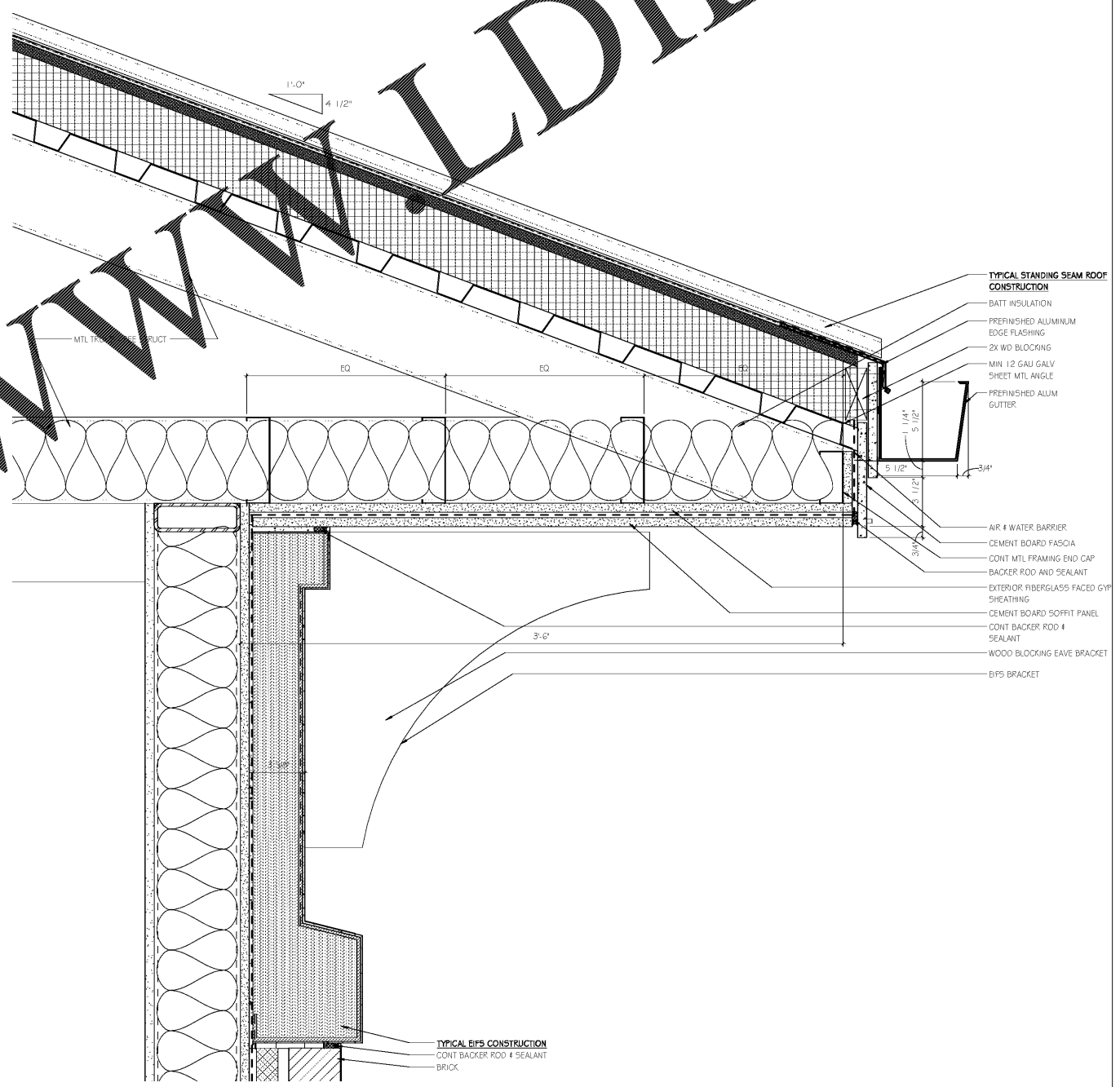

**A7 TYP EAVE**  
SCALE: 3"=1'-0"

TYPICAL CONSTRUCTION TYPES	
WALL CONSTRUCTION	ROOF CONSTRUCTION
<b>TYPICAL BRICK VENEER CONSTRUCTION</b> BRICK VENEER CONT BOARD INSULATION CONT AIR # WATER BARRIER	<b>TYPICAL STANDING SEAM ROOF CONSTRUCTION</b> STANDING SEAM ROOF SYSTEM SELF-ADHERED MEMBRANE FLASHING- HIGH TEMP 4" THICK RIGID INSUL NAIL BASE- R-20 MIN MTL DECK
<b>TYPICAL STACKED STONE WALL CONSTRUCTION</b> DRY STACKED STONE VENEER MORTAR-FILLED CAVITY 1" CONT CAVITY DRAINAGE NETTING 1" CONT BOARD INSULATION CONT AIR # WATER BARRIER	
<b>TYPICAL EIFS CONSTRUCTION</b> EIFS SYSTEM CONT AIR # WATER BARRIER	

ISSUE DATE
BID ISSUE 11/30/2017

Oneonta Community Development Center  
 100 1st Ave W.  
 Oneonta, AL 35121  
**GMC # ABHM170022**

**ROOF DETAILS**  
**A3.02**  
 sheet of

2701 1st Avenue S  
 Birmingham, AL 35233  
 T 205.879.4482  
**GMC**  
**ONCNETWORK.COM**

WWW.LDILine.com

11/30/2017 5:23:33 PM