

TECHNOLOGY LEGEND

SYMBOL	DESCRIPTION
	CEILING DATA OUTLET WAP = WIRELESS ACCESS POINT - 15" MAX - SEE KEYED NOTES
	WALL VOICE AND DATA OUTLET ACC = ADMINISTRATIVE CONTROL CONSOLE
	BURGLAR ALARM CONTROL PANEL - SEE TELE BOARD ELEVATION
	AUDIO SPEAKER - KLIPSCH CAS25T SURFACE SPEAKER 6" ABOVE LIGHTING FIXTURES
	2MP CEILING SECURITY CAMERA - NON-IR 4'-6" BELOW TRACK LIGHTING
	2MP CEILING SECURITY CAMERA - NON-IR 4'-6" BELOW TRACK LIGHTING
	WIRELESS MOTION DETECTOR (DEGREE RANGE LISTED BELOW) PENDANT MOUNTED IN AREAS WITHOUT CEILINGS - COORDINATE MOUNTING HEIGHT WITH TNF PM
	WIRELESS DOOR CONTACT TOP OF DOOR & CONNECTION TO FRAME
	ALARM KEYPAD (WIRED) - 42" AFF TO BOTTOM
	AUDIO SYSTEM HEADEND - SEE MGR DESK ELEVATION
	SECURITY SYSTEM HEADEND - SEE MGR DESK ELEVATION
	LOW VOLTAGE RACK - MOUNTED AT 6'-6" AFF ON TELE BOARD
	RDL LINE LEVEL VOLUME CONTROL MOUNTED IN WIREMOLD BOX SEE BACKWRAP ELEVATION
	SHOPPERTRAK 10" AFF TO BOTTOM OF DEVICE

RESPONSIBILITY MATRIX

ITEM	FURNISH	INSTALL
SHOPPERTRAK DEVICES	SHOPPERTRAK	SHOPPERTRAK
SHOPPERTRAK CABLING	SNIDER	SNIDER
SHOPPERTRAK ROUGH-IN	BY G.C. (IF APPLICABLE BY AHJ)	
SOUND SYSTEM DEVICES	MOOD MEDIA	MOOD MEDIA
SOUND SYSTEM CABLING	MOOD MEDIA	MOOD MEDIA
SOUND SYSTEM ROUGH-IN	BY G.C. (IF APPLICABLE BY AHJ)	
ALARM SYSTEM DEVICES	TYCO	TYCO
ALARM SYSTEM CABLING	TYCO	TYCO
ALARM SYSTEM ROUGH-IN	BY G.C. (IF APPLICABLE BY AHJ)	
SENSORMATIC DEVICES	TYCO	TYCO
SENSORMATIC CABLING	TYCO	TYCO
SENSORMATIC ROUGH-IN	BY G.C. (IF APPLICABLE BY AHJ)	
CAMERA DEVICES	TYCO	TYCO
CAMERA CABLING	TYCO	TYCO
CAMERA ROUGH-IN	BY G.C. (IF APPLICABLE BY AHJ)	
ALL OTHER MISCELLANEOUS	SNIDER	SNIDER
WAP	TNF	SNIDER
NETWORK CABINET	TNF	SNIDER
110 PHONE BLOCK	SNIDER	SNIDER
PATCH PANEL	SNIDER	SNIDER
UPS PANEL	SNIDER	SNIDER
ALL OTHER NETWORK CABINET EQUIPMENT	TNF	SNIDER
ALL OTHER LV CABLING NOT SPECIFICALLY LISTED	SNIDER	SNIDER
CASHWRAP/BACKWRAP EQUIPMENT	TNF	SNIDER
LOW-VOLTAGE, PHONE, DATA TESTING	SNIDER	SNIDER
BACK OF HOUSE COMPUTERS	TNF	SNIDER
ISP	TNF	SNIDER

KEYED NOTES

- T01 COORDINATE EXACT LOCATION OF IT/AV/SECURITY RACK WITH ARCHITECT/OWNER PRIOR TO BID TO ENSURE ACCURATE CABLING LENGTHS. RACK SHALL BE MOUNTED AT 6'-6" AFF TO THE BOTTOM.
- T02 CONTRACTOR TO INSTALL BOX AND CONDUIT (IF REQUIRED BY LOCAL AHJ), AND PULL STRING FROM SECURITY DEVICE LOCATION TO SECURITY HEADEND LOCATION. LABEL CONDUIT AT SECURITY HEADEND WITH CAMERA IDENTIFICATION NUMBER 02###. COORDINATE CAMERA IDENTIFICATION NUMBERS WITH SECURITY VENDOR. REFER TO GENERAL NOTES FOR ADDITIONAL INFORMATION. CAMERAS TO BE INSTALLED 4" TO 6" BELOW TRACK LIGHTING. COORDINATE MOUNTING HEIGHT WITH PROJECT MANAGER PRIOR TO ROUGH-IN. LOW VOLTAGE VENDOR TO LEAVE 20' OF UNTERMINATED CABLE LOOP AT EACH END.
- T03 CONTRACTOR TO INSTALL WIRELESS MOTION DETECTOR, COORDINATE MOUNTING HEIGHT TO BOTTOM OF DEVICE WITH PROJECT MANAGER. REFER TO GENERAL NOTES FOR ADDITIONAL INFORMATION.
- T04 WIRELESS ACCESS POINT INSTALLED BY OWNER'S VENDOR. CONTRACTOR TO PROVIDE (2) DATA STANDARD "B" JACKS, RUN CAT5E CABLES THROUGH CONDUIT BACK TO IT EQUIPMENT. TERMINATE CONNECTIONS AND TEST. WAP SHALL BE MOUNTED TO UNDERSIDE OF CEILING TRUSS IF TRUSS IS AT 15' AFF OR LOWER. IF TRUSSES ARE HIGHER THAN 15', PROVIDE MOUNTING HARDWARE FOR WAP INSTALLATION AT 15' AFF.
- T05 PROVIDE JUNCTION BOX AND PENDANT MOUNT WITHIN 24"-30" OF ENTRY AT 10'-0" AFF TO THE BOTTOM OF DEVICE, AND 3/4" CONDUIT (IF REQUIRED BY LOCAL AHJ) WITH PULL WIRE BACK TO TELEPHONE BOARD FOR SHOPPER TRACK. COORDINATE WITH VENDOR FOR EXACT CABLING REQUIREMENTS. SNIDER SERVICES TO LEAVE 15' OF UNTERMINATED CABLING AT EACH END.

LOW VOLTAGE GENERAL NOTES

- A. MUSIC SYSTEM TO BE PROVIDED BY MOOD MEDIA. PROVIDE CONDUIT AND J-BOXES FOR INSTALLATION (IF REQUIRED BY LOCAL AHJ). SPEAKER LOCATIONS ARE SHOWN FOR REFERENCE. COORDINATE EXACT LOCATIONS WITH ARCHITECTURAL SHEETS.
- B. PROVIDE 3/4" CONDUIT WITH PULL STRING (IF REQUIRED BY LOCAL AHJ) FROM ALL BOXES STUBBED UP WALL AND HOMERUN TO ACCESSIBLE CEILING LOCATION ABOVE AV/IT/SECURITY EQUIPMENT FOR ROUTING OF LOW VOLTAGE CABLES BY OTHERS.
- C. ALL LOW VOLTAGE CABLING SHALL BE IN CONDUIT WHERE REQUIRED BY LOCAL AHJ OR HIGHER AUTHORITY.
- D. EACH WIRING LOCATION REQUIRES THE CABLE TO BE SPECIFIED. ALL CABLE SHALL RUN FROM THE LOCATION TO THE AV/IT RACK UNLESS OTHERWISE DIRECTED. ALL CABLE SHALL BE CONTINUOUS, NO SPLICING ALLOWED.
- E. ALL WIRES SHALL BE LABELED AT BOTH ENDS. LABELS SHALL BE UNDERLINED TO AVOID CONFUSION.
- F. WIRES ARE NOT TO BE RUN WITHIN 6 FEET OF ANY NON-CAMERA WIRE OR LIGHT FIXTURE. WIRES ARE NOT TO BE FASTENED TO THREADED RODS OR ANYTHING THAT MAY PENETRATE THE JACKET OF THE WIRE. NO BENDS SHALL BE SMALLER THAN 10 TIMES THE DIAMETER OF THE WIRE.
- G. PROVIDE MINIMUM OF 3'-0" OF SLACK AT DEVICE END AND 10'-0" OF SLACK A TRACK/CONTROLLER END FOR ALL LOW VOLTAGE CABLES TO BE TERMINATED BY OWNER'S VENDOR.
- H. REFER TO LOW VOLTAGE DETAILS SHEET FOR MORE INFORMATION.
- I. ALL EXPOSED CABLING TO BE BLACK OR DARK GREEN OR INSTALLED BEFORE THE DECK IS PAINTED.
- J. ALL FACE PLATES TO BE OFF-WHITE PLASTIC.
- K. ALL LOW VOLTAGE BOXES TO BE SINGLE COLOR.
- L. ALL DATA JACKS SHALL BE BLUE IN COLOR. VOICE JACKS SHALL BE WHITE IN COLOR.
- M. ALL CABLING SHALL BE CAT5e.
- N. DEMARC EXTENSION BY LANDLORD UNLESS OTHERWISE LISTED BY TNF PROJECT MANAGER.
- O. COORDINATE SPEAKER AND CAMERA LAYOUT WITH MEP AND CEILING ITEMS EXISTING AND NEW.

KLH ENGINEERS
MECHANICAL/ELECTRICAL ENGINEERS
WWW.KLHENGRS.COM
1538 ALEXANDRIA PIKE, SUITE
11 FT. THOMAS, KENTUCKY
41075 800-354-9783
859-442-8050
859-442-8051

RGLA
rcla solutions, inc.
1255 W. River Road, Ste 125
Shelby Park, IL 60176
P: 847.671.7452
F: 847.671.4200
www.rgla.com

REVISIONS	DATE
ISSUE FOR DESIGN LANDLORD AND PERMIT	10/27/2017
ISSUE FOR PERMIT	11/17/2017

robert g. lyon + associates, inc.
ARCHITECTS
1618 W. ARCHITECTURE
9100 Elmwood Park, Suite 100
Schiller Park, IL 60176
P: 847.671.7452
F: 847.671.4200
www.rgla.com

THE ABOVE DRAWINGS AND SPECIFICATIONS AND DEED, DESIGN AND ARRANGEMENTS REPRESENTED THEREIN ARE AND SHALL REMAIN THE PROPERTY OF THIS OFFICE AND NO PART THEREOF SHALL BE COPIED, DISCLOSED TO OTHERS OR USED IN THE CONNECTION WITH ANY WORK OR PROJECT OTHER THAN THE SPECIFIC PROJECT FOR WHICH THEY HAVE BEEN PREPARED AND DEVELOPED WITHOUT THE WRITTEN CONSENT OF THIS OFFICE. VISUAL CONTACT WITH THESE DRAWINGS OR SPECIFICATIONS SHALL CONSTITUTE CONCLUSIVE EVIDENCE OF ACCEPTANCE OF THESE RESTRICTIONS.

WRITTEN DIMENSIONS ON THESE DRAWINGS SHALL HAVE PRECEDENCE OVER SCALED DIMENSIONS. CONTRACTOR SHALL VERIFY AND BE RESPONSIBLE FOR ALL DIMENSIONS AND CONDITIONS ON THE JOB AND THIS OFFICE MUST BE NOTIFIED OF ANY VIOLATIONS IMMEDIATELY. DIMENSIONS AND CONDITIONS SHOWN BY THESE DRAWINGS SHOULD ALSO BE SUBMITTED TO THIS OFFICE FOR APPROVAL BEFORE PROCEEDING WITH FABRICATION.

©2017 RGLA SOLUTIONS, INC.
©2017 ROBERT G. LYON & ASSOCIATES, INC.

THE NORTH FACE
AVENTURA MALL
19501 BISCAYNE BLVD
SPACE #327
AVENTURA, FL 33180

LOW VOLTAGE PLAN

DRAWN BY	LAH
CHECKED BY	LGJ
JOB NUMBER	19811
SHEET NAME	LV1.0

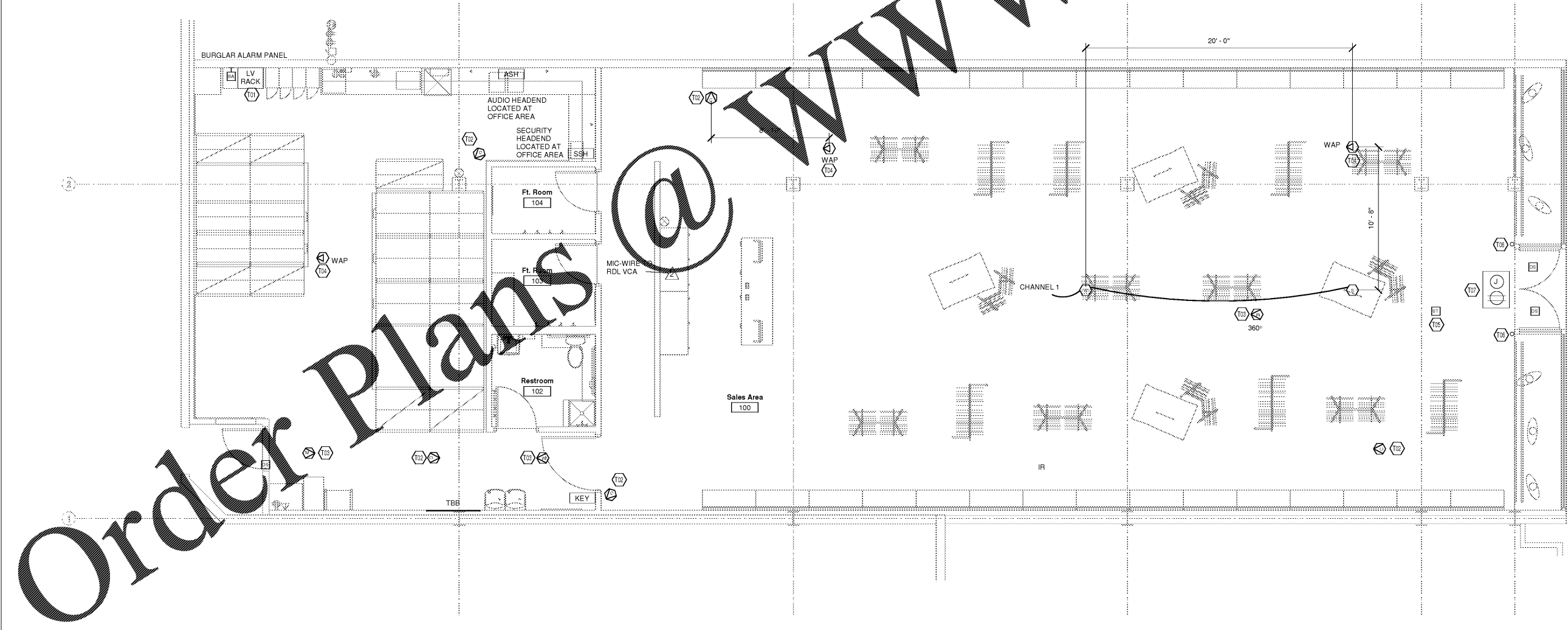

LOW VOLTAGE PLAN
1/4" = 1'-0"

OWNERSHIP OF INSTRUMENTS OF SERVICE
All reports, plans, specifications, computer files, field data, notes and other documents and instruments prepared by the Consultant as instruments of service shall remain the property of the Consultant. The Consultant shall retain all common law, statutory and other reserved rights, including, without limitation, the copyright therein.