

JEFFPAUR ARCHITECTURE
 ARCHITECTS
 1610 BOBBELL AVENUE, SUITE H1
 BATON ROUGE, LOUISIANA 70809
 TEL: 504.762.7405
 FAX: 504.762.7406
 WWW.JEFP.ARCHITECTS.COM

IMEG
 IMEG PROJECTS
 15215 RESEARCH BLVD
 SUITE 305
 AUSTIN, TX 78749
 TEL: 512.416.8642
 FAX: 512.416.8477
 WWW.IMEGPROJ.COM

Prairville General Hospital
 37358 Market Place Dr.
 Prairieville, LA 70769

Shawn Kuffen and Associates
 Robert C. Murray, AIA
 Architects & Construction Services
 11428 Bandera Rd., Ste. 202
 Houston, TX 77036
 Tel: 281.696.5716
 Email: rcm@shawnkuffen.com



Project No. 1607050

Drawn: AG

Checked: -

Date: November 22, 2017

No.	Description	Date

P101
 PLUMBING
 UNDERFLOOR

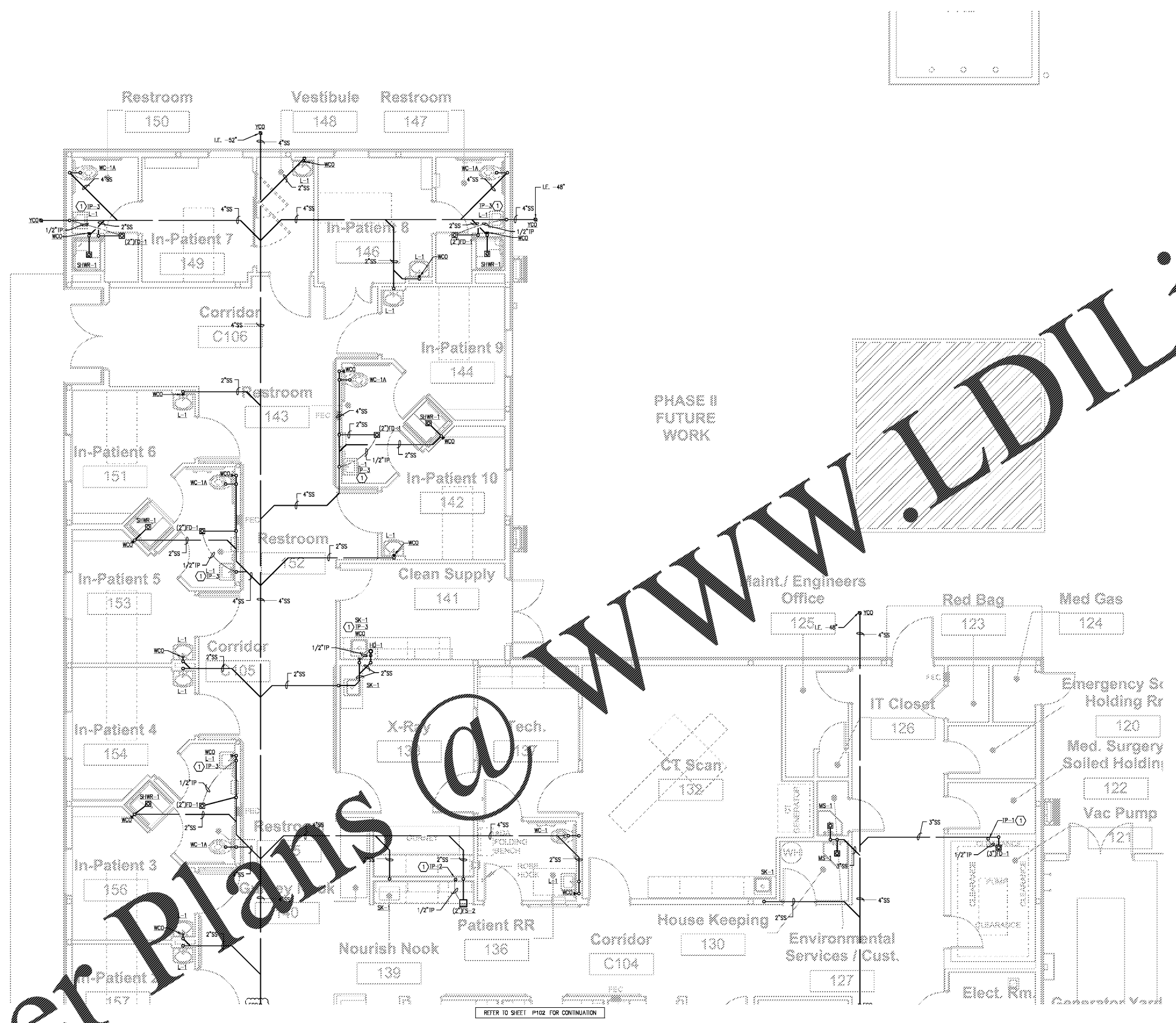

KEYED NOTES - PLUMBING:

① ROUTE 1/2" CONTINUOUS SOFT COPPER TRAP PRIME LINE FROM TRAP PRIMER TO BELOW FLOOR AND TO TAILPIECE OF FLOOR DRAIN OR SINK.

WWW.LDILine.com

Order Plans @

1 PLUMBING - UNDERFLOOR PLAN
 SCALE: 1/4" = 1'-0"

REFER TO SHEET P102 FOR CONTINUATION

PHASE II
 FUTURE
 WORK

CONSTRUCTION REISSUE SET