

Prairieville General Hospital
37358 Market Place Dr.
Prairieville, LA 70769

Shirley Kesterson and Associates
in association with
Robert C. Murray, P.E.
Architects & Construction Services
13418 Hunters Rd., Ste. 202
Houston, TX 77023
P: 281.665.5714
Email: SKA@skarch.com

CONSTRUCTION REISSUE SET

Project No. 1607050
Drawn: TB
Checked:
Date: November 22, 2017

No.	Description	Date

EP101
ELECTRICAL POWER PLAN



FIRE ALARM SYSTEM:

SCOPE OF FIRE ALARM WORK INCLUDES PROVIDING A NEW VENDOR DESIGNED FIRE ALARM SYSTEM. SYSTEM SHALL BE FULLY ADDRESSABLE, DIGITAL, SILENT KNIGHT OR EQUAL. CONNECTIONS SHALL BE PROVIDED TO INTERFACE DUCT MOUNTED SMOKE DETECTORS WITH THE HVAC SYSTEM TO SHUT DOWN ALL AIR HANDLERS IN THE EVENT OF AN ALARM. ALL WORK SHALL BE PERFORMED BY A LICENSED FIRE ALARM CONTRACTOR. FIRE ALARM CONTRACTOR SHALL PROVIDE ALL NECESSARY DOCUMENTATION IN COMPLIANCE WITH CITY OF PRAIRIEVILLE & FIRE MARSHAL REQUIREMENTS.

GENERAL NOTES:

- PROVIDE SEPARATE NEUTRAL AND GROUND ON ALL BRANCH CIRCUITS. MULTI-WIRE CIRCUITS SHALL NOT BE ACCEPTABLE.
- PVC CONDUIT SHALL NOT BE ACCEPTABLE FOR ANY ELECTRICAL WIRING.

- KEYED NOTES:**
- RECEIPLACES AT HEADWALL SET LOCATION SHALL BE HOSPITAL GRADE. IF MARKED WITH 'E', SHALL BE RED WITH 30% WHITE.
 - DU GROUND BAR FOR DATA/COMM EQUIPMENT. COORDINATE LOCATION WITH I.T. DEPT. REFER TO ELEC. RISER DIAGRAM, SHEET E301.
 - COORDINATE OUTLET HEIGHTS FOR TV MONITOR WITH ARCH. ELEVATIONS.
 - (2) 4" PVC CONDUIT FOR DATA/COMM CABLES. SHALL BE 10' MIN. REFER TO ELEC. SITE PLAN FOR CONTINUATION OF ROUTING.
 - 3 WALL MOUNTED L.T. ROOM WITH 3/4" FIRE RESISTANT PLATE. BOARDS AT 6". PAINT WITH FIRE RESISTANT GRAY. PAINT OVER FIRE RESISTANT RATING. REFER TO X-RAY VENDOR'S INSTRUCTIONS.
 - 30A/2P FLUSH MOUNTED ENCLOSED BREAKER WITH SHUNT TRIP FOR X-RAY EQUIPMENT. REFER TO X-RAY VENDOR'S INSTRUCTIONS.
 - 2P FLUSH MOUNTED ENCLOSED BREAKER WITH SHUNT TRIP FOR X-RAY EQUIPMENT. REFER TO ELEC. RISER DIAGRAM, SHEET E301 AND X-RAY VENDOR'S INSTRUCTIONS.
 - EMERG. POWER OFF BUTTON. CONNECT TO SHUNT TRIP BREAKERS SUPPLYING EQUIPMENT.
 - CI SCANNER SHUNT TRIP MAIN BREAKER. REFER TO ELECTRICAL RISER DIAGRAM.
 - CI SCANNER CONTACTOR BY CI VENDOR.
 - CI SCANNER POWER DISTRIBUTION UNIT.
 - 10" X 10" X 4" J-BOX FLUSH MOUNT IN WALL. LOCATE BOX CENTERLINE @ 12" AFF. PROVIDE (1) 1/2" AND (1) 2" DIA. SLEEVE WITH BUSHINGS AND LOCKNUTS CENTERED IN REMOVABLE COVER PLATE. PROVIDE A BARRIER IN BOX TO SEPARATE CONTROL & POWER WIRING.
 - FMT CONDUIT SHALL BE USED FOR EMERGENCY CIRCUITS.
 - MULTI-WIRE BRANCH CIRCUITS SHALL NOT BE USED FOR ANY EMERGENCY BRANCH CIRCUITS. PROVIDE DEDICATED NEUTRALS. REFER TO ELECTRICAL RISER DIAGRAM, SHEET E301 FOR SCANNER EQUIPMENT TRANSFORMER INFORMATION.
 - 30A/3P/30AF/ANR 250V RATED DISCONNECT. WIRE WITH 3-#10, #00, 3/4".
 - ENCLOSED CIRCUIT BREAKER FOR TRANSFORMER SECONDARY PROTECTION. REFER TO E301 ELECTRICAL RISER DIAGRAM.
 - SWITCHED J-BOX FOR REDUC PUMP. COORDINATE WITH PLUMBING.
 - 12" X 12" X 4" FLUSH MOUNTED J-BOX INSTALLED 18" AFF TO CENTER. PROVIDE COVER WITH (2) 2" GROMMET HOLES IN CENTER.
 - SWITCHED J-BOX FOR ELECTRIC DOOR OPENER. COORDINATE WITH VENDOR.
 - INTERLOCK CI ROOM EMF FAN OPERATION WITH ROOF TOP UNIT SERVING ROOM. PROVIDE SWITCHED J-BOX DISCONNECT.
 - 'X-RAY IN USE' SIGN INSTALLED CENTERED ABOVE DOOR.
 - REFER TO SHEET E301 ELEC. RISER DIAGRAM FOR ELEC. WATER HEATER DISCONNECT & WIRE INFORMATION. COORDINATE WITH PLUMBING.
 - PROVIDE 120V POWER ON LIFE SAFETY BRANCH FOR MED GAS MANIFOLDS.
 - 2" RIGID CONDUIT BETWEEN J-BOXES. RUN SHORTEST DISTANCE AS POSSIBLE. PROVIDE FULL STRING.
 - 1" RIGID CONDUIT BETWEEN J-BOXES. RUN SHORTEST DISTANCE AS POSSIBLE. PROVIDE FULL STRING.
 - MASTER ALARM PANEL FOR MED GAS SYSTEM. PROVIDE 120V POWER ON LIFE SAFETY BRANCH.
 - DEDICATED RECIPLACED PROTECTED BY GFCI BREAKER.

DO NOT ROUTE UNDERGROUND CONDUITS IN THE FUTURE EXPANSION AREA.

PHASE II FUTURE WORK

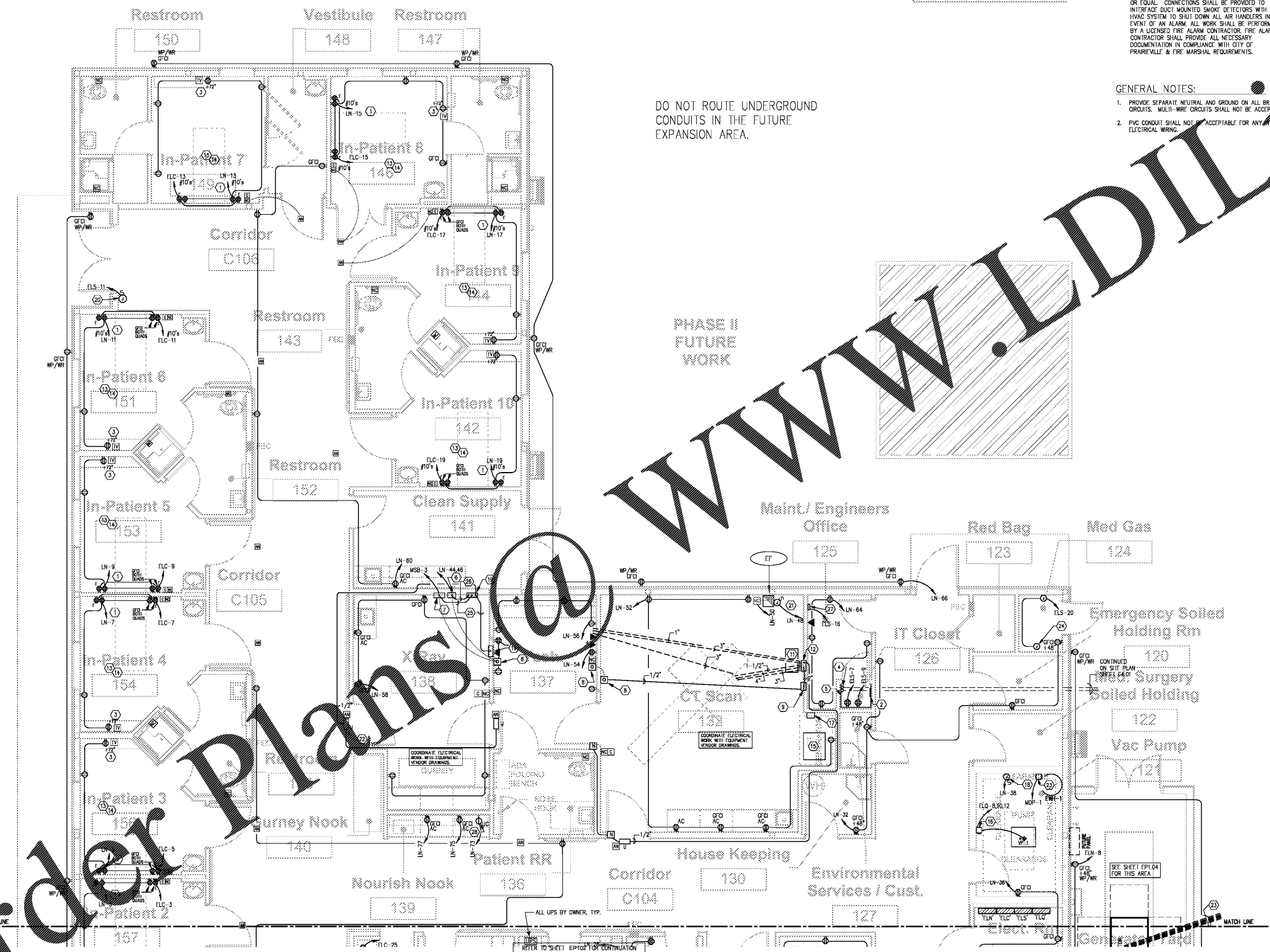

1 ELECTRICAL POWER PLAN - NORTH
SCALE: 1/4" = 1'-0"

Order Plans @ WWW.LDLINE.COM