

FFPAIR STUDIO
JEFFREY A. COBBELL ARCHITECTS
1100 ROUSSIERE BLVD SUITE H1
BAYON ROUGE, LA 70069



Prairieville General Hospital
37358 Market Place Dr.
Prairieville, LA 70769

Shawn Kesteron and Associates
Robert C. Murray, AIA
Architecture & Construction Services
13430 Brandeis Blvd., Suite 202
Metairie, LA 70001
Ph: 214.945.5716
Fax: 214.945.5716
Email: SCA@shawnkesteron.com



Project No.	1607050	
Drawn:	KRF	
Checked:	SK	
Date:	11.22.17	
No.	Description	Date

A302
Enlarged RCP -
Area 'A'

CONSTRUCTION REISSUE SET

Order Plans

@LAWN

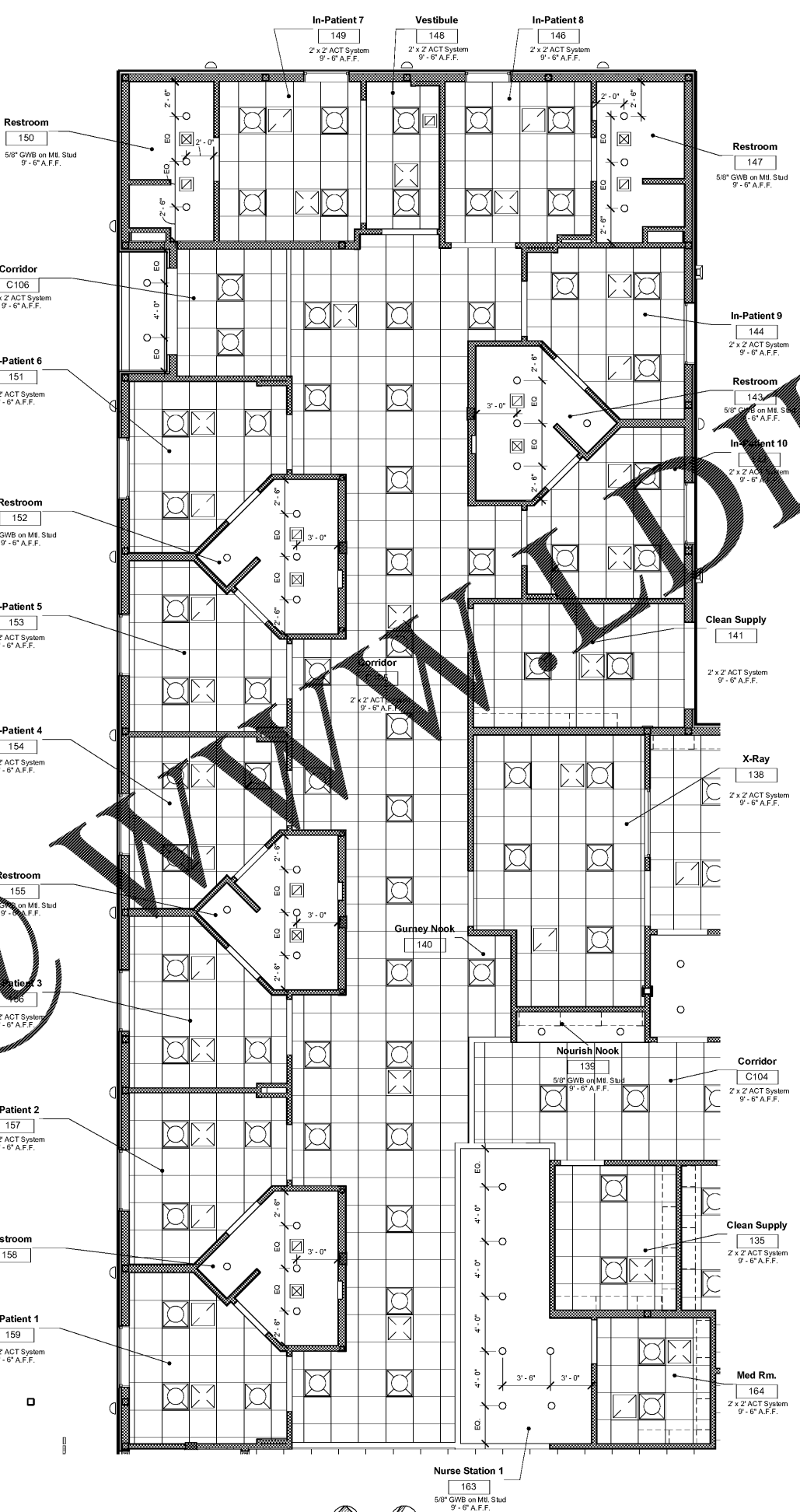

- Reflected Ceiling Plan Legend**
- ⊙ 6" RECESSED CAN LIGHT
 - ▭ 24" LINEAR PENDANT LIGHT 10'-0" A.F.F.
 - ▭ 48" LINEAR PENDANT LIGHT 10'-0" A.F.F.
 - ⊠ Z x Z PARABOLIC LIGHTING
 - ⊙ COOPER SERIES LIGHT 142-24 P15 10'-0" A.F.F.
 - ▭ EXTERIOR WALL WASHER SCONCE 8'-0" A.F.F.
 - ⊠ 12" RETURN EXHAUST GRILLE REF. MECHANICAL
 - ⊠ 24" RETURN EXHAUST GRILLE REF. MECHANICAL
 - ⊠ 12" SUPPLY GRILLE REF. MECHANICAL
 - ⊠ 24" SUPPLY GRILLE REF. MECHANICAL

- Note:**
1. If dimension for light is not given center light in room.
 2. Recessed can lights in waiting area to be aligned with pendant lights if no dimension is given.
 3. Vertical dimensions for lights above finish floor are to the bottom of the light fixture.
 4. Exterior sconce lights to be centered on wall between windows and evenly spaced.

1 Enlarged Reflected Ceiling Plan - Area 'A'
SCALE: 1/4" = 1'-0"

