

NOTE:

- ALL WORK SHALL CONFORM TO LATEST SPECIFICATIONS OF THE EAST BATON ROUGE PARISH, DEPARTMENT OF PUBLIC WORKS, UNLESS OTHERWISE SPECIFIED.
- SANITARY SEWER FACILITIES SHALL BE CONSTRUCTED, INSTALLED, AND TESTED IN ACCORDANCE WITH EAST BATON ROUGE SPECIFICATIONS AND AS SHOWN ON THE LATEST EBR DPW STANDARD SANITARY SEWER MISCELLANEOUS DETAILS (CPS 640-01), UNLESS OTHERWISE SPECIFIED HEREIN.
- ALL SEWER PIPE AND FITTINGS SHALL MEET THE REQUIREMENTS OF ASTM D3034. THE STANDARD DIMENSION RATIO (SDR) OF ALL PIPE AND FITTINGS SHALL NOT EXCEED 35.
- ALL SANITARY SEWER CLEANOUT TOPS SHALL MATCH FINISHED GRADE.
- ALL CONDUIT SHALL BE SCHEDULE 40 PVC AS MANUFACTURED BY CARLON, SEDCO OR CANTEX. ALL CONDUIT SHALL BE NEW AND SHALL BEAR THE INSPECTION LABEL OF THE UNDERWRITERS LABORATORIES, INC. CONDUIT SHALL HAVE A MINIMUM FINISHED GRADE COVER OF 24" OR MINIMUM CODE REQUIREMENT, WHICHEVER IS GREATER.
- ALL 1" AND 2" WATER SERVICES SHALL BE SCHEDULE 40 PVC AS MANUFACTURED BY CERTAINTED, IPEX, OR OTHER NSF STANDARD 61 LISTED COMPANY. ALL SERVICES SHALL BE NEW AND SHALL BEAR THE INSPECTION LABEL OF THE UNDERWRITERS LABORATORIES, INC.
- WATER MAINS SHALL BE INSTALLED AT A MINIMUM DEPTH OF 36".
- CONTRACTOR SHALL PRESSURE TEST WATER MAIN.
- CONTRACTOR SHALL CHLORINATE MAIN AND HAVE SATISFACTORY SAMPLE BEFORE MAIN IS PUT IN SERVICE.
- WATER MAINS SHALL BE RATED 160 PSI OR GREATER AND SHALL BE INSTALLED AS PER MANUFACTURER'S RECOMMENDATIONS.
- A 14 GAGE GALVANIZED STEEL WIRE AND APPROVED DEFECTABLE TAPE SHALL BE LAID IN THE TRENCH ON TOP OF ALL UNDERGROUND NON-METALLIC PIPE AS A TRACER. SEWER, WATER, AND FIRELINE SHALL BE READILY IDENTIFIABLE.
- ALL WATER VALVES SHALL HAVE A CONCRETE PAD POURED AROUND VALVE BOX COVERS AND HAVE A GROUND ROD LEADING TO TRACER WIRE CLAMPING IT TO THE BOTTOM OF THE VALVE BOX AND CONFORM TO AWWA C-509 B7.
- USE RETAINER GLANDS WHERE CONDITIONS WILL NOT PERMIT USE OF CONCRETE THRUST BLOCK. INSTALL M.J. GLANDS WITH TORQUE WRENCH TO 90 FT./LBS.
- THERE SHALL BE A MINIMUM 6" HORIZONTAL AND 18" VERTICAL SEPARATION BETWEEN ALL SANITARY SEWER AND WATER FACILITIES.
- JOINT RESTRAINTS SHALL BE PLACED AT ALL BENDS IN WATER MAIN. CONCRETE THRUST BLOCKS WILL NOT BE ALLOWED.
- CONTRACTOR IS RESPONSIBLE FOR COMPLYING WITH REQUIREMENTS OF NPDES PERMIT INCLUDING BUT NOT LIMITED TO NOTIFYING E.P.A. OF THE DATE CONSTRUCTION IS TO BEGIN.
- CONTRACTOR SHALL INSTALL REFLECTORIZED BLUE HYDRANT MARKERS IN MIDDLE OF LANE NEAREST EACH HYDRANT.
- ALL 3" AND 8" WATER LINES SHALL CONFORM TO AWWA C-900 DR18. FIRE HYDRANTS SHALL CONFORM TO AWWA C-502 B3.
- ALL ABOVE GROUND FIRE LINE FACILITIES SHALL BE ADEQUATELY AND DURABLY IDENTIFIED BY A DISTINCTIVE YELLOW COLORED PAINT.
- CONTRACTOR SHALL VERIFY THAT THREADS ON PROPOSED HYDRANTS MATCH THREADS ON HOSES FOR LOCAL FIRE DEPARTMENT.
- FIRE LINE AND DOMESTIC WATER LINE MAY BE CONSTRUCTED WITHIN THE SAME TRENCH.
- CONTRACTOR SHALL COORDINATE THE LOCATION OF THE WATER LINE TIE-INS WITH THE ARCHITECT.
- PRIOR TO UNDERGROUND CONSTRUCTION, ALL UTILITIES SHALL BE "POTHOLED" AND ALL CONFLICTS RESOLVED.
- ALL ABOVE GROUND WATER FACILITIES SHALL BE INSULATED OR PROTECTED AGAINST FREEZING IN ACCORDANCE WITH THE STATE FIRE MARSHALL'S REQUIREMENTS.
- DOUBLE BACKFLOW PREVENTER SHALL BE SUBMITTED TO THE MECHANICAL ENGINEER AND SPRINKLER SUBCONTRACTOR FOR APPROVAL.

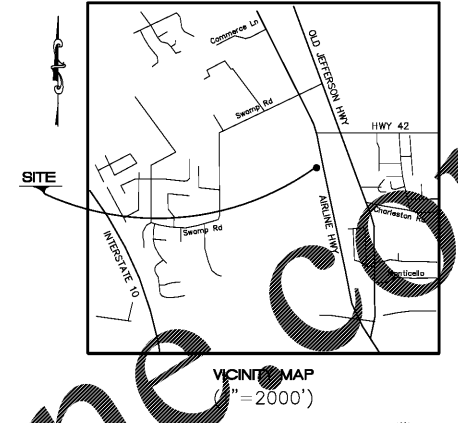
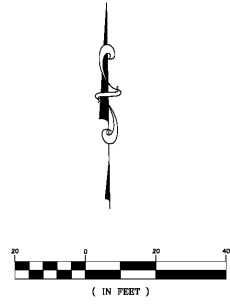

GENERAL NOTES:
 COMMERCE CENTRE - LOT 6
 ZONING: MU (MIXED USE CORRIDORS)
 SETBACKS:
 FRONT: 25'
 SIDE: 10'
 REAR: 15'
 100 YEAR FLOOD - 14'
 EXISTING LAND USE: VACANT
 FLOOD ZONE: A & X
 TOTAL ACRES: 1.076 AC.

LOT 6 & 15
 COMMERCE CENTRE
 LOCATED IN SECTION 26, T8S-R2E, G.L.D.
 ASCENSION PARISH, LA.

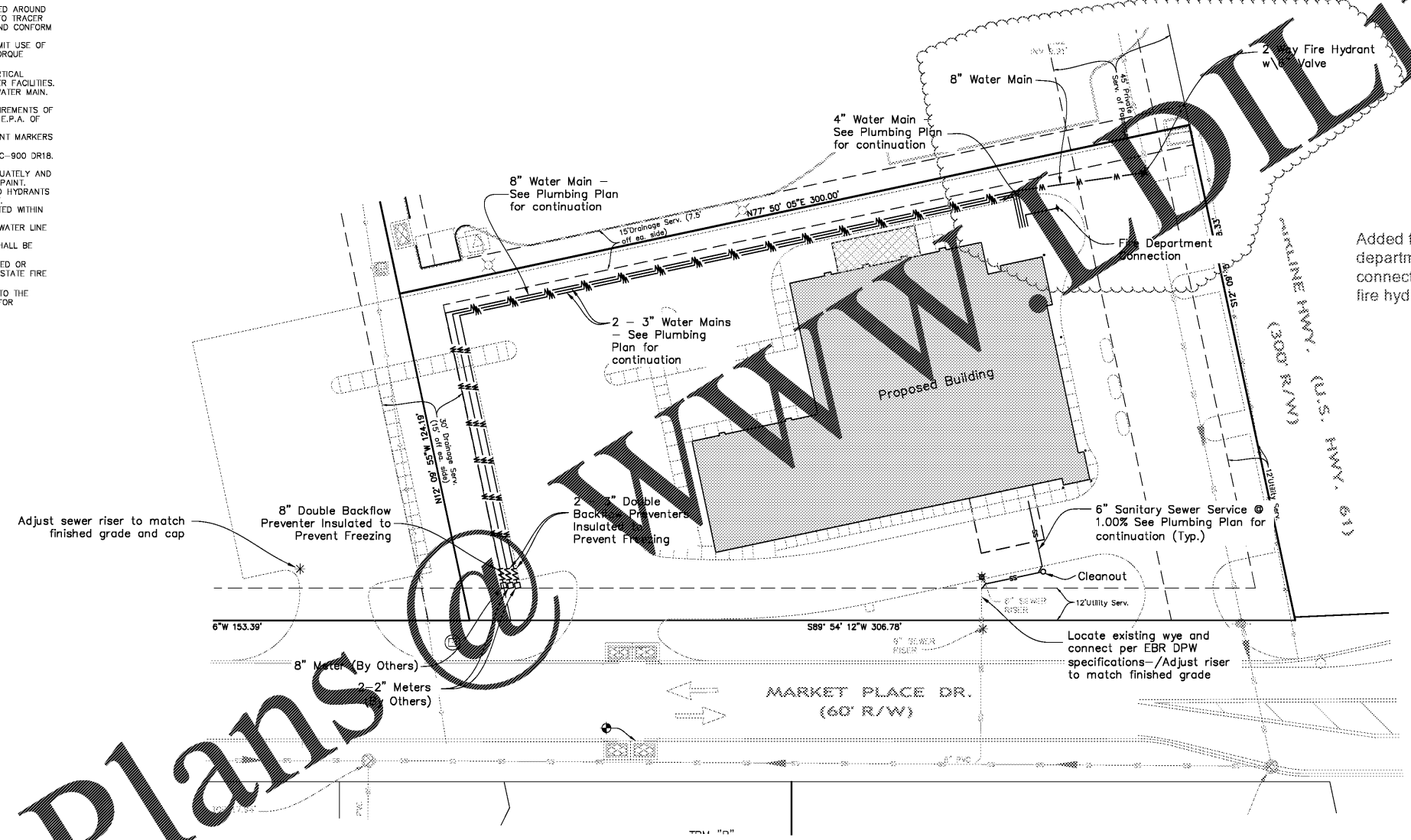

OFFPAIR
 OFFICE: SUITE H1
 1601 W. MONROE
 BATON ROUGE, LA 70809
 (504) 285-7405

LOUISIANA LAND ENGINEERING LLC
 1000 Poydras Street, Suite 2000
 New Orleans, Louisiana 70112
 (504) 581-1111
 www.louisianalandle.com

Prairieville General Hospital
 37358 Market Place Drive
 Prairieville, LA 70769

Shawn Kesterson and Associates
 Robert C. Murray, P.E.
 Architecture & Construction Services
 13400 Manders Rd., Suite 202
 Baton Rouge, LA 70809
 PH: 218.696.5716
 F: 218.696.5714
 Email: shawn@shawnkesterson.com

Project No. 1607050		
Drawn:	JKC	
Checked:	JKC	
Date:	November 22, 2017	
No.	Description	Date

CONSTRUCTION DOCUMENTS

C-5
 UTILITY LAYOUT

Order Plans

NOTE:
 ALL UTILITY SPACES SHALL BE CLEARLY MARKED OR DESIGNATED.

NOTE:
 THE BUILDING INFORMATION SHOWN WAS PROVIDED BY S K & A, INC AND SHOULD BE VERIFIED PRIOR TO COMMENCEMENT OF CONSTRUCTION.

NOTE:
 THE CONTRACTOR SHALL BE RESPONSIBLE FOR DETERMINING THE EXACT LOCATION, DEPTH, AND SIZE OF ALL UNDERGROUND UTILITIES AND STRUCTURES AND SHALL BE LIABLE FOR ANY DAMAGE CAUSED BY FAILURE TO COMPLY WITH THESE INSTRUCTIONS.

THE BOUNDARY SHOWN IN NO WAY REPRESENTS A SURVEY OF THE PROPERTY. THE DIMENSIONS SHOWN REPRESENT THE MAP OF RECORD.

CONTRACTOR IS RESPONSIBLE FOR COMPLYING WITH REQUIREMENTS OF NPDES PERMIT INCLUDING BUT NOT LIMITED TO NOTIFYING E.P.A. OF THE DATE CONSTRUCTION IS TO BEGIN.

Louisiana
one
 Call before
 you dig.
 1-800-272-3020

SITE TBM: ELEV. 17.26'
 BEING THE TOP OF THE BOLT ON THE DOUBLE CATCH BASIN ON THE SOUTH SIDE OF MARKETPLACE DRIVE AS SHOWN.