

PIPE CHART				
FROM	TO	LENGTH	SIZE	SLOPE
A-1	A-2	50'	15" SDP	1.00%

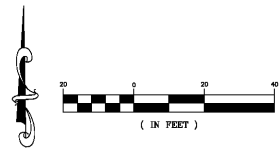

LEGEND:

	PROPOSED DRAIN PIPE
	EXISTING DRAIN PIPE
	PROP. GRATE INLET
	PROP. CATCH BASIN
	EXIST. CATCH BASIN
	EXIST. GROUND CONTOUR
	DRAINAGE FLOW ARROWS

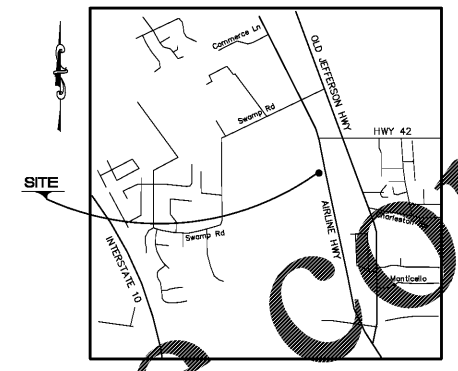

GENERAL NOTES:
 COMMERCE CENTRE - LOT 6
 ZONING: MU (MIXED USE CORRIDORS)
 SETBACKS:
 FRONT: 25'
 SIDE: 10'
 REAR: 15'
 100 YEAR FLOOD - 14'
 EXISTING LAND USE: VACANT
 FLOOD ZONE: A & X
 TOTAL ACRES: 1.076 AC.

LOT 6 & 15
 COMMERCE CENTRE
 LOCATED IN SECTION 26, 18S-R2E, G.L.D.
 ASCENSION PARISH, LA.



FFPA AIR
 SHAWN KESTERSON
 PROFESSIONAL ENGINEER
 1801 GULF BLVD SUITE H1
 BATON ROUGE, LOUISIANA 70809
 TEL: 225-7405

LOUISIANA LAND ENGINEERING LLC
 1801 GULF BLVD SUITE H1
 BATON ROUGE, LA 70809
 TEL: 225-7405

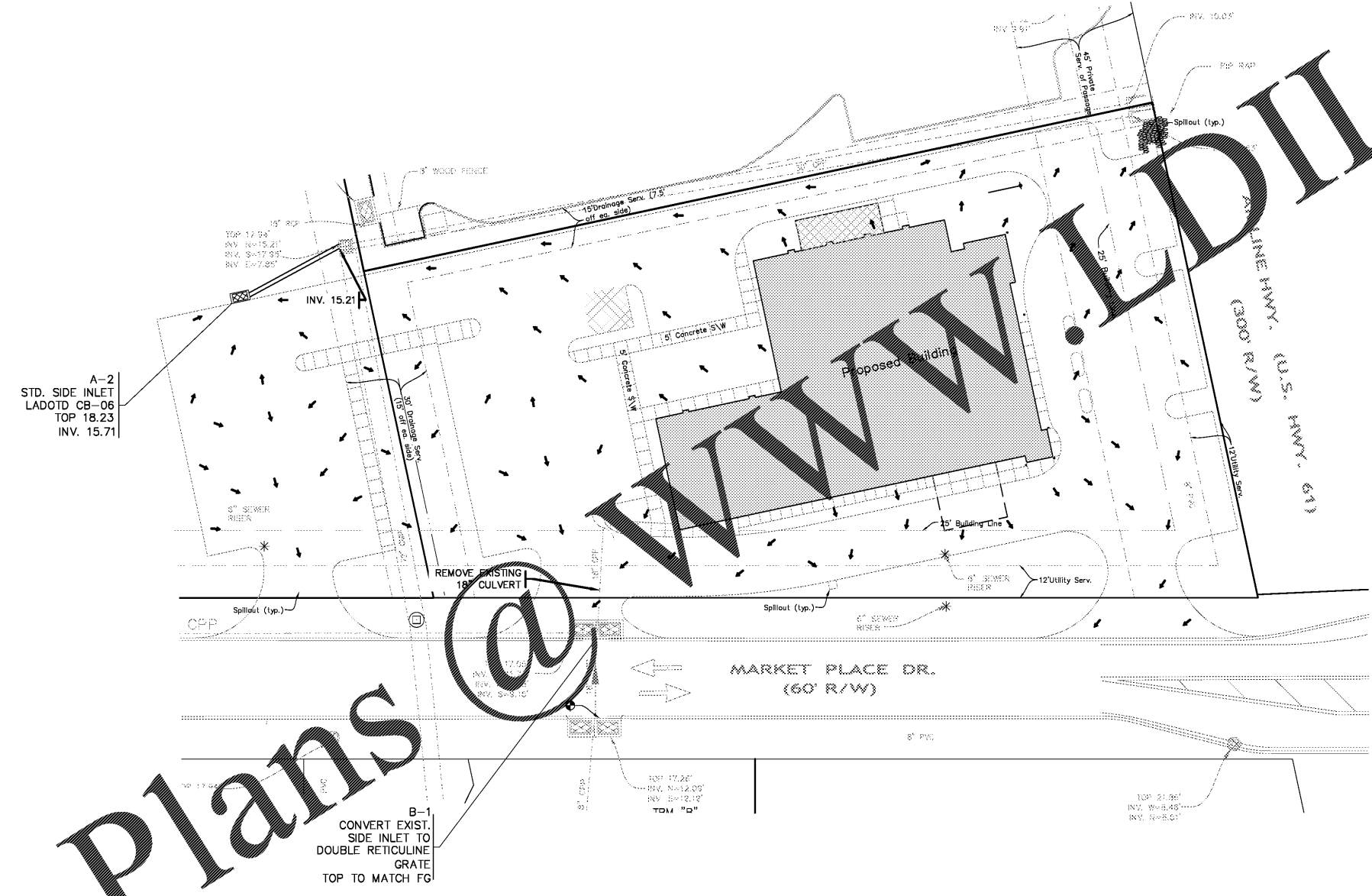

- NOTE:**
1. ALL WORK SHALL CONFORM TO LATEST SPECIFICATIONS OF THE STATE OF LOUISIANA FOR ROADS AND BRIDGES, UNLESS OTHERWISE SPECIFIED HEREIN.
 2. ALL DRAIN PIPE SHALL CONFORM TO THE LATEST SPECIFICATIONS OF THE STATE OF LOUISIANA FOR ROADS AND BRIDGES ACCEPTABLE UNLESS OTHERWISE APPROVED. POSITIVE SITE SURFACE DRAINAGE SHALL BE PROVIDED TO REDUCE INFILTRATION OR SURFACE WATER AROUND THE PERIMETER OF THE BUILDING AND BENEATH FLOOR SLABS.
 3. PRIOR TO UNDERGROUND CONSTRUCTION ALL UTILITIES SHALL BE "POTHOLED" AND ALL CONFLICTS RESOLVED.
 4. ALL STRUCTURES WITHIN LIMITS OF PAVEMENT SHALL HAVE EXPANSION MATERIAL ADJACENT TO EDGE.
 5. CONTRACTOR SHALL REMOVE ALL TREES AND OTHER OBSTRUCTIONS NECESSARY TO FACILITATE HIS WORK. ANY TREE LOCATED IN A STATE RIGHT OF WAY WILL REQUIRE A LADDDO PERMIT TO BE REMOVED.
 6. ROOF DRAINS SHALL BE CONNECTED TO EXISTING DRAINS OR PROPOSED DRAIN LINES. SEE MECHANICAL PLANS FOR ROOF DRAIN LOCATIONS.

Prairieville General Hospital
 37358 Market Place Drive
 Prairieville, LA 70769

Shawn Kesterson and Associates
 Robert C. Murray AIA
 Architecture & Construction Services
 11419 Sanders Rd., Ste. 202
 Baton Rouge, LA 70814
 PH: 225-985-5716
 F: 225-985-5714
 Email: S.Kesterson@skacorp.com

Project No. 1607050		
Drawn:	JKC	
Checked:	JKC	
Date:	November 22, 2017	
No.	Description	Date

CONSTRUCTION DOCUMENTS

C-4
 DRAINAGE LAYOUT

Louisiana
 Call before you dig.
 1-800-272-3020

SITE TBM: ELEV. 17.26'
 BEING THE TOP OF THE BOLT ON THE DOUBLE CATCH BASIN ON THE SOUTH SIDE OF MARKETPLACE DRIVE AS SHOWN.

Order Plans @

NOTE:
 ALL EXISTING STRUCTURES SHALL BE CLEARLY MARKED OR DESIGNATED.

NOTE:
 THE BUILDING INFORMATION SHOWN WAS PROVIDED BY S K & A, INC AND SHOULD BE VERIFIED PRIOR TO COMMENCEMENT OF CONSTRUCTION.

NOTE:
 THE CONTRACTOR SHALL BE RESPONSIBLE FOR DETERMINING THE EXACT LOCATION, DEPTH, AND SIZE OF ALL UNDERGROUND UTILITIES AND STRUCTURES AND SHALL BE LIABLE FOR ANY DAMAGE CAUSED BY FAILURE TO COMPLY WITH THESE INSTRUCTIONS.

THE BOUNDARY SHOWN IN NO WAY REPRESENTS A SURVEY OF THE PROPERTY. THE DIMENSIONS SHOWN REPRESENT THE MAP OF RECORD.

CONTRACTOR IS RESPONSIBLE FOR COMPLYING WITH REQUIREMENTS OF NPDES PERMIT INCLUDING BUT NOT LIMITED TO NOTIFYING E.P.A. OF THE DATE CONSTRUCTION IS TO BEGIN.