

EQUIPMENT LIST AND SCHEDULE OF CONNECTIONS

ITEM NUMBER	QUANTITY	BY F.S.E.C.	BY OWNER	BY GENERAL CONTRACTOR	BY VENDOR	DESCRIPTION	ELECTRICAL				GAS		WATER		HABITE		REMARKS		
							VOLTAGE	PHASE	AMPS	KVA/HP	INLET SIZE	BTU/H. (X 1000)	COLD	HOT	DIRECT	INDIRECT			
1	1					THREE COMPARTMENT SINK											FS	ADVANCE TABCO # FC-3-1024-BRL	
2	1					PRE-RINSE 1/4" FILL FAUCET						1/2"	1/2"					FISHER # 343B	
3	2					HAND SINK						1/2"	1/2"	1-1/2"				ADVANCE TABCO # 7-PS-40	
4	3					CUSTOMER SERVICE COUNTER												ADVANCE TABCO # 1S-247	
5	1					SOFT DRINK DISPENSER W/ ICE BIN	120	1	10				1/2"					FS	SUPPLIED BY VENDOR
5A	LOT					BAG-IN-BOX SYSTEM	120	1	10										SUPPLIED BY VENDOR
5B	1					CO2 TANK												SUPPLIED BY VENDOR	
6	1					POS	120	1	10									SUPPLIED BY OWNER	
7						SPARE NUMBER													
8						SPARE NUMBER													
9	1					FILL FAUCET						1/2"	1/2"					FISHER # 305	
10						COFFEE BREWER	120	1	11.3				1/4"					SUPPLIED BY VENDOR	
11	1					TEA BREWER W/ DISPENSER	120	1	14				1/4"					SUPPLIED BY VENDOR	
12	1					AIR CURTAIN	120	1	9									PARIS # 1072-1A-TS	
13	1					SERVICE FAUCET	120	1	9				1/2"	1/2"				FISHER # 244	
14	1					ICE MAKER W/ BIN	120	1	8.2				1/2"	1/2"				HUB	
15	1					ICE CREAM FREEZER	120	1		1/3								MANTONCO # RNS-0626A W/ B-570	
16						SPARE NUMBER												SUPPLIED BY VENDOR	
17	2					TEA DISPENSER												SUPPLIED BY VENDOR	
18						SPARE NUMBER													
19						SPARE NUMBER													
20						SPARE NUMBER													
21	1					SANDWICH PREP REFER	120	1	5.6	1/3								TRUE # T55U-65-12-ADA-HC	
22	1					HEATED SHELF MERCHANDISER	120	1	1.26									HATCO # GR38DS-33	
23	1					HEATED DISPLAY CASE, COUNTER TOP	120	1	12									HATCO # FSD-2K	
24						SPARE NUMBER													
25	1					WORK TABLE												ADVANCE TABCO # 55-308	
26	1					REACH-IN REFER	120	1	5.4	1/2								TRUE # T-4R-HC	
27	1					WORK TABLE												ADVANCE TABCO # 1FF99U-100	
28	1					GRIDDLE W/ REFER BASE	120	1	2.9				3/4"	120				VULCAN # VCG48-AC	
29	1					REFER BASE	120	1	4.7	1/3								VULCAN # JRS48	
29A	1					FRYER W/ FILTER	120	1	9				1"	220				FRYMASTER # FPL240	
29B	1					FRYER W/ HEAT LAMP	120	1	6.3										
30	1					REACH-IN FREEZER	120	1	7	3/4								TRUE # STHF-15-HC	
31	1					EXHAUST HOOD	120	1	10									CAPTIVE AIRE # 5424 ND-2-PPF-F	
32	1					WORK TABLE W/ SINK												ADVANCE TABCO # K55-308	
33	LOT					STORAGE SHELVING												METRO	

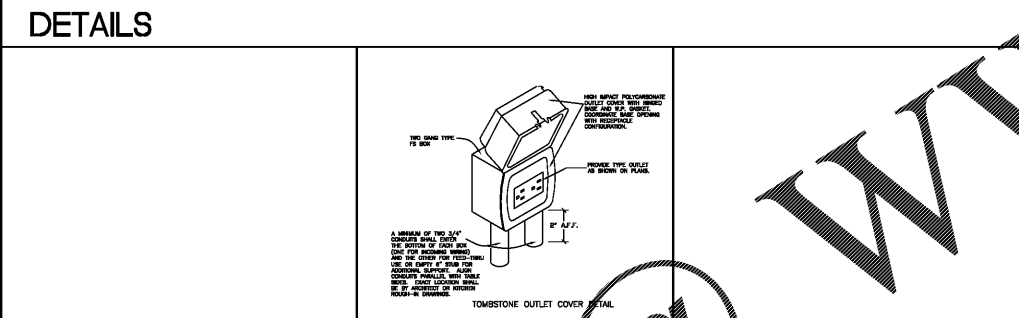

CODE	DEFINITION	SYMBOL	EXPLANATION
ESC	ELECTRICAL SUPPLY CABINET		
JB	JUNCTION BOX		
PC	PLUG-IN CONNECTION		
CB	CIRCUIT BREAKER PANEL		
V	VOLTS		
A	AMPS		
HP	HORSEPOWER		
CH	COLD WATER		
HW	HOT WATER		
H	HABITE		
G	GAS		
FD	FLOOR DRAIN		
FR	FLOOR SINK		
FD	FLOOR DRAIN		
HD	HAB DRAIN		
AF	Above Finished Floor		
E.C.	OTHER EQUIPMENT CONNECTION		

GENERAL NOTES
1. F.S.E.C. WILL PROVIDE ALL ITEMS AS NOTED ON EQUIPMENT LIST. G.C. TO PROVIDE ALL ROUGH-IN AND FINAL CONNECTIONS OF ELECTRICAL, PLUMBING AND MECHANICAL SERVICES TO EQUIPMENT.
2. CONNECTIONS SHOWN ON ROUGH-IN SCHEDULE ARE FOR ONE UNIT ONLY; TO OBTAIN TOTAL, MULTIPLY BY NUMBER INDICATED IN QUANTITY COLUMN.
3. DIMENSIONS SHOWN ON ROUGH-IN PLANS ARE TAKEN FROM FINISHED WALLS AND FLOORS TO CENTER LINE OF ROUGH-IN.
4. ROUGH-INS SHOWN ARE FOR FOOD SERVICE EQUIPMENT ONLY; SEE ARCHITECTURAL DRAWINGS FOR ADDITIONAL INFORMATION.
5. ALL ROUGH-INS LOCATED OUTSIDE WALLS TO BE STUBBED UP NOT MORE THAN 3" AFF (UNTIL EQUIPMENT IS SET IN PLACE). ALLOW FOR CONCRETE PADS WHERE REQUIRED. ALL ROUGH-INS LOCATED AT WALLS SHALL BE CONCEALED WITHIN WALLS AND LABELLED AT HEIGHT INDICATED.
6. WHERE EXISTING EQUIPMENT, MATCH EXISTING UTILITY REQUIREMENTS OR PROVIDE UTILITIES AS INDICATED ON MANUFACTURER'S DATA PLATE.
7. WHERE CB IS INDICATED, F.S.E.C. WILL PROVIDE A SUITABLY SIZED PANEL MOUNTED WITHIN EQUIPMENT; ELECTRICAL SERVICE TO BE STUBBED TO PANEL AS REQUIRED.
8. WHEN EQUIPMENT CONNECTION IS SHOWN AS JB, ELECTRICAL CONTRACTOR SHALL CONNECT TO JB FURNISHED ON EQUIPMENT.
9. ELECTRICAL CONTRACTOR TO PROVIDE THERMAL OVERLOAD DISCONNECT SWITCH FOR ROOF MOUNTED KITCHEN EXHAUST AND MAKE-UP AIR FANS.
10. ELECTRICAL CONTRACTOR TO PROVIDE WIRING TO COMPRESSORS, COILS, THERMOSTATS, SOLENOID, LIGHTS TO SWITCHES, DOOR HEATERS, AND DRAIN DEFROST CABLE AT WALK-IN.
11. SELF-CONTAINED REFRIGERATION UNITS FURNISHED WITH MORE THAN ONE COMPRESSOR MAY REQUIRE A SEPARATE CIRCUIT FOR EACH COMPRESSOR.
12. MECHANICAL CONTRACTOR TO PROVIDE SHUT-OFF VALVES AT ALL GAS LINES AND HOT AND COLD WATER LINES AHEAD OF ANY FLEX-CONNECTIONS FOR REPLACEMENT WITHOUT INTERRUPTION TO BUILDING SYSTEM.
13. GAS LINES TO COOKING EQUIPMENT SHALL BE FITTED WITH A SOLENOID VALVE, FURNISHED WITH FIRE SUPPRESSION SYSTEM, AND INSTALLED BY MECHANICAL AND/OR ELECTRICAL CONTRACTOR, UNLESS OTHERWISE SPECIFIED.
14. MECHANICAL CONTRACTOR TO CONNECT DISHWASHER AND POT SINKS TO GREASE TRAP IF REQUIRED BY LOCAL CODE (VERIFY LOCATION WITH ARCHITECT).
15. CAMACHO DESIGN SERVICE, INC. HAS PROVIDED THESE DRAWINGS AS A PROFESSIONAL SERVICE. ALL ELECTRICAL, PLUMBING AND MECHANICAL CONNECTIONS SHOWN ARE SIZED AS THEY OCCUR ON EQUIPMENT SPECIFIED. CHANGES IN EQUIPMENT OR FAILURE TO MEET APPLICABLE CODES IN PROVIDING SERVICES TO CONNECTIONS SHOWN WILL NOT BE THE RESPONSIBILITY OF THE DESIGNERS.

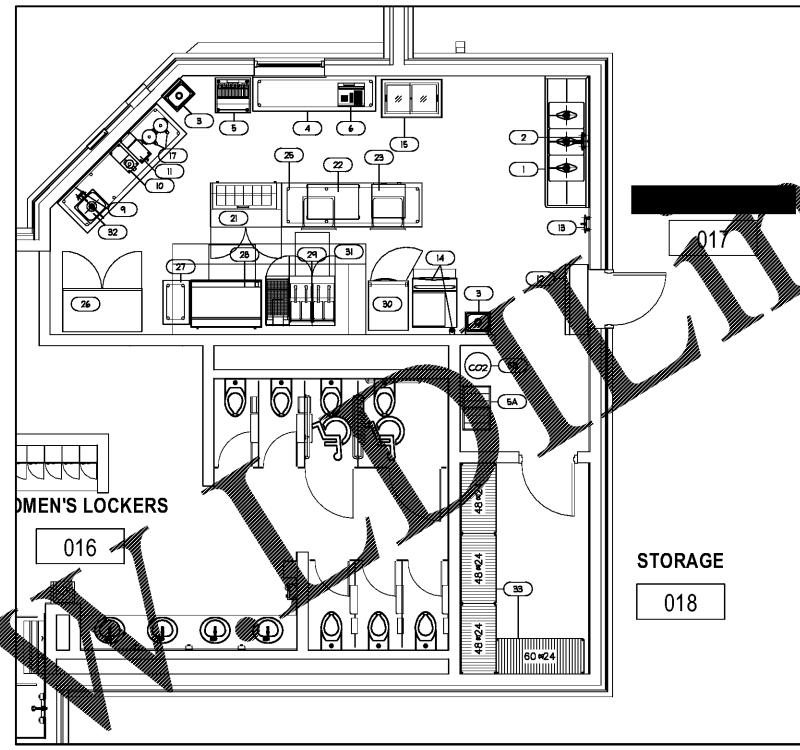

POOL CONCESSION FLOOR PLAN

1/4" = 1'-0"



HOMWOOD PATRICK PARK POOL



HOMWOOD PARKS AND RECREATION, HOMEWOOD, AL

DAVIS ARCHITECTS

OWNER: HOMWOOD PARKS AND RECREATION
 1632 OMOOR ROAD
 HOMEWOOD, AL 35209
 205-322-6704
 ATTN: SERLEK SQUIRES

ARCHITECT: DAVIS ARCHITECTS, INC.
 120 28ND STREET SOUTH
 BIRMINGHAM, AL 35233
 205-322-7482
 ATTN: JIM HARTESELL

LANDSCAPE ARCHITECT: HNP
 1914 28TH AVE S.
 BIRMINGHAM, AL 35209
 205-324-4447
 ATTN: TOMMY HOLCOMBE / ED NORTON

CONSTRUCTION MANAGER: BL HARBERT
 820 SHADES CREEK PARKWAY, SUITE 3000
 BIRMINGHAM, AL 35209
 205-802-2900
 ATTN: JOHN HANSON

STRUCTURAL ENGINEER: LBVD INC.
 715 SOUTH 30TH STREET
 BIRMINGHAM, AL 35233
 205-251-4500
 ATTN: VIK BISHOP / BRAD CHRISTOPHER

MECHANICAL ENGINEER: WHITAKER & RAWSON
 3332 OLD MONTGOMERY HIGHWAY
 SUITE 103
 BIRMINGHAM, AL 35209
 205-949-5128
 ATTN: MARK D'ANDREA AND DAN WHITAKER

CIVIL ENGINEER: LBVD INC.
 715 SOUTH 30TH STREET
 BIRMINGHAM, AL 35233
 205-251-4500
 ATTN: CURTIS EATMAN AND BRAIN HATCHER

ELECTRICAL ENGINEER: FISHER ARNOLD
 1507 ALEX DR.
 SUITE 101
 BIRMINGHAM, AL 35210
 205-832-7023
 ATTN: JOSEPH KUMU AND NICHOLAS BROWN

PLUMBING / FIRE PROTECTION ENGINEER: WHITAKER & RAWSON
 3332 OLD MONTGOMERY HIGHWAY
 SUITE 103
 BIRMINGHAM, AL 35209
 205-949-5107
 ATTN: ERIC HARTWIG

POOL CONSULTANT: COUNSLMAN HUNSAKE
 10733 SUNSET OFFICE DRIVE
 SUITE 400
 ST. LOUIS, MO 63127
 314-894-1246
 ATTN: JEFF NODORFT

REV	DATE	DESCRIPTION

DATE: OCTOBER 6, 2017

PROJECT: 100% CONSTRUCTION DOCUMENTS

DRAWING NO.: DAVIS ARCHITECTS PROJECT NO: 3822

SHEET TITLE: POOL CONCESSION ENLARGED FLOOR PLAN AND EQUIPMENT LIST & SCHEDULE OF CONNECTIONS

camacho 202 1/2 E Broad St., Suite A
 Edulaba, AL 36027
 334/616-7192

THESE DRAWINGS ARE THE PROPERTY OF CAMACHO FOODSERVICE DESIGN. ANY REUSE OF THIS DESIGN, IN PART OR WHOLE, IS PROHIBITED.

FS1