



HOMWOOD PATRIOT PARK POOL



HOMWOOD PARKS AND RECREATION; HOMWOOD, AL

DAVIS ARCHITECTS

OWNER:
HOMWOOD PARKS AND RECREATION
1632 OXMOOR ROAD
HOMWOOD, AL 35209
205-322-6704
ATTN: BENJELYN SQUIRES

ARCHITECT:
DAVIS ARCHITECTS, INC.
120 23RD STREET SOUTH
BIRMINGHAM, AL 35233
205-322-7482
ATTN: JIM HARTSELL

LANDSCAPE ARCHITECT:
HNP
1914 26TH AVE S
BIRMINGHAM, AL 35209
205-324-4447
ATTN: TOMMY HOLCOMBE / ED NORTON

CONSTRUCTION MANAGER:
BL HARBERT
820 SHADES CREEK PARKWAY, SUITE 3000
BIRMINGHAM, AL 35209
205-982-2900
ATTN: JOHN HANSON

STRUCTURAL ENGINEER:
LEYD INC.
716 SOUTH 30TH STREET
BIRMINGHAM, AL 35233
205-251-4500
ATTN: WIM BISHOP / BRAD CHRISTOPHER

MECHANICAL ENGINEER:
WHITAKER & RAWSON
3332 OLD MONTGOMERY HIGHWAY
SUITE 103
BIRMINGHAM, AL 35209
205-949-5128
ATTN: MARK D'ANDREA AND DAN WHITAKER

CIVIL ENGINEER:
LEYD INC.
716 SOUTH 30TH STREET
BIRMINGHAM, AL 35233
205-251-4500
ATTN: CURTIS EATMAN AND BRIAN HATCHER

ELECTRICAL ENGINEER:
FISHER ARNOLD
1507 ALEX DR.
SUITE 101
BIRMINGHAM, AL 35210
205-833-7033
ATTN: JOSEPH KUMU AND NICHOLAS BROWN

PLUMBING / FIRE PROTECTION ENGINEER:
WHITAKER & RAWSON
3332 OLD MONTGOMERY HIGHWAY
SUITE 103
BIRMINGHAM, AL 35209
205-949-5107
ATTN: ERIC HARTWIG

POOL CONSULTANT:
COUNSLMAN HUNSAKE
10733 SUNSET OFFICE DRIVE
SUITE 400
ST. LOUIS, MO 63127
314-894-1245
ATTN: JEFF NODORFT

REV	DATE	DESCRIPTION

DATE: OCTOBER 6, 2017

PROJECT: 100% CONSTRUCTION SET

OWNER: DAVIS ARCHITECTS PROJECT NO: 3822

SHEET TITLE: FLOOR PLAN & DIMENSION PLAN

DRAWING NO:

A2.01

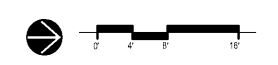
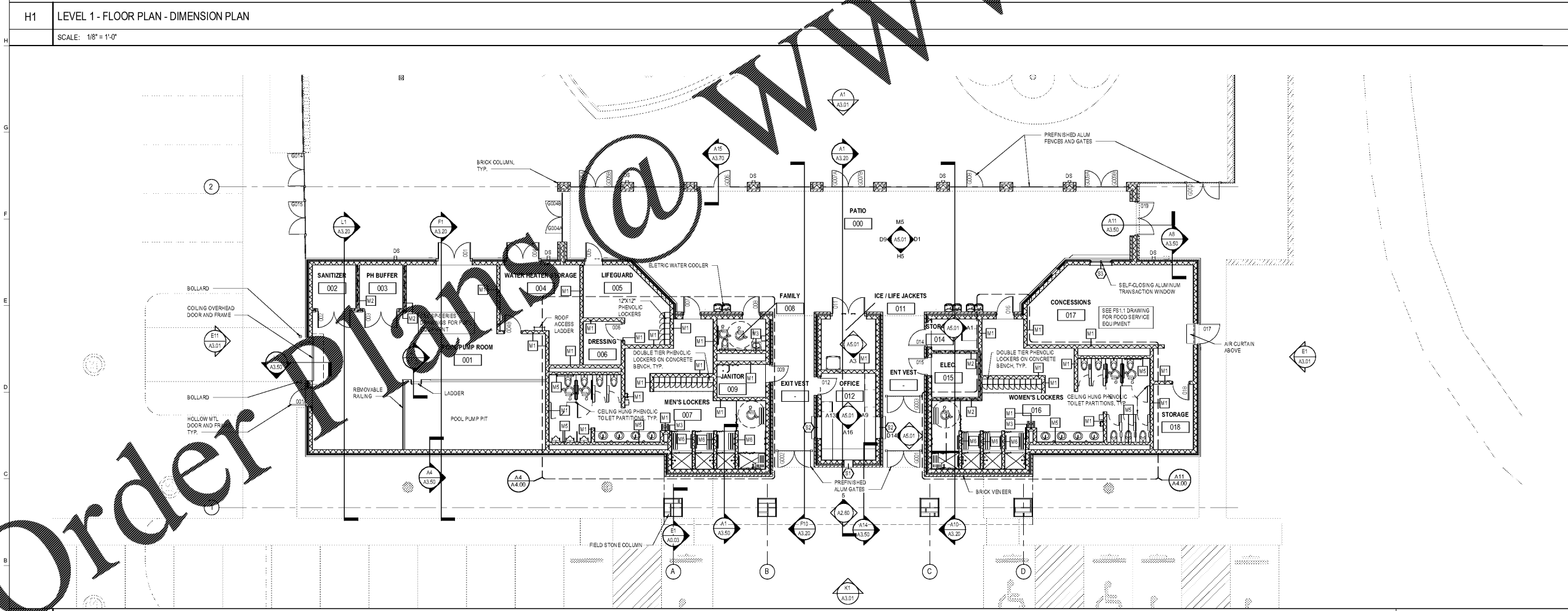
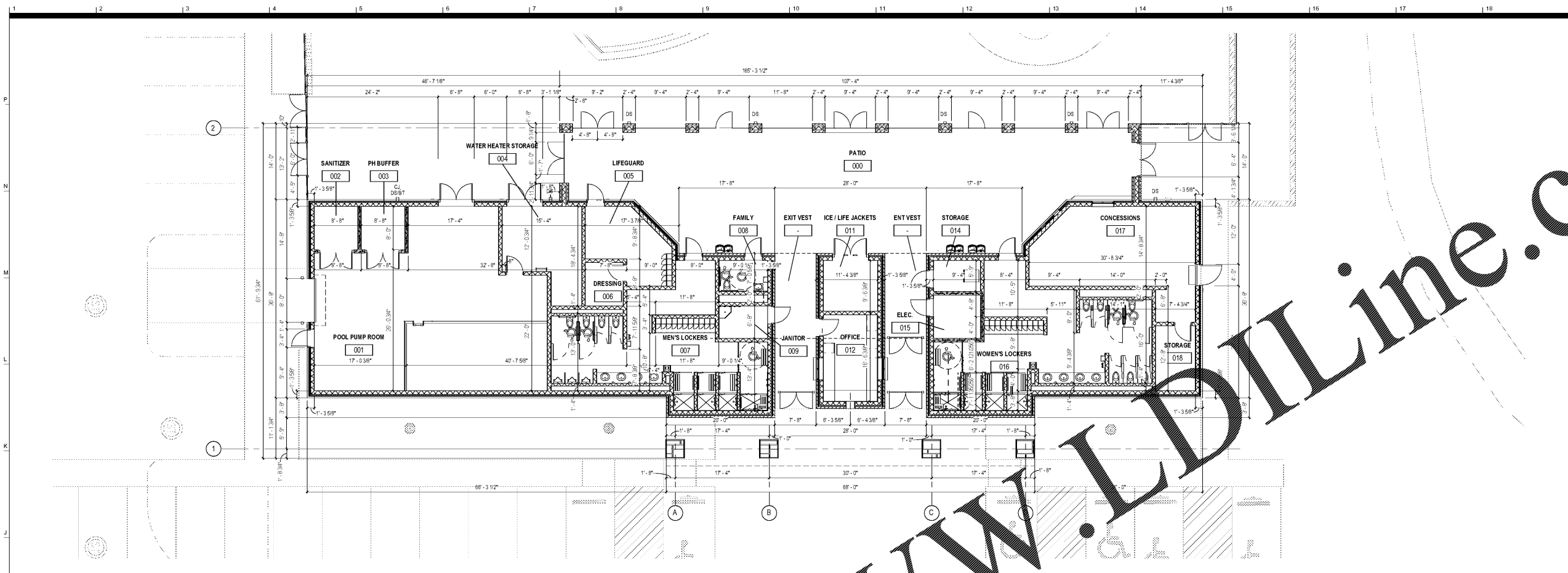

Order Plans @ www.LDLine.com