

3 CONTAINER SHRUB PLANTING DETAIL  
NOT TO SCALE

PLANTING SCHEDULE						
Quantity	Botanical Name	Common Name	Root	Scheduled Size	Spacing	Comments
2	Ilex x attenuata 'Foster's #2'	FOSTER HOLLY	B&B	8'-10" HL	10'0" o.c.	Matched, Standard Tree-Form
4	Quercus phellos	WILLOW OAK	B&B	2 1/2 - 3' cal.	30'0" o.c.	Matched
5	Quercus shumardi	SHUMARD OAK	B&B	2 1/2 - 3' cal.	30'0" o.c.	Matched
Quantity	Botanical Name	Common Name	Root	Scheduled Size	Spacing	Comments
22	Cephalotaxus harringtonia 'Prostrata'	SPREADING PLUM YEW	Cont.	15'-18" spread	3'0" o.c.	
39	Ilex cornuta 'Needlepoint'	NEEDLEPOINT HOLLY	Cont.	30"-36" HL	4'0" o.c.	
3	Ilex hybrid 'Emily Brunner'	EMILY BRUNNER HOLLY	B&B	8'-10" HL	7'0" o.c.	Matched
19	Loropetalum chinense 'Shang-white'	EMERALD SNOW LOROPETALUM	Cont.	18'-24" spread	3'0" o.c.	
Quantity	Botanical Name	Common Name	Root	Scheduled Size	Spacing	Comments
	Cynodon dactylon	Bermuda Grass	SOD			Seed all disturbed areas not otherwise noted
Quantity	Botanical Name	Common Name	Root	Scheduled Size	Spacing	Comments

3 B&B TREE PLANTING DETAIL  
NOT TO SCALE

**PLANTING NOTES:**

- CONTRACTOR TO VERIFY ALL PLANT MATERIAL QUANTITIES AND PLANTING AREA DIMENSIONS PRIOR TO BEGINNING PLANTING. PROVIDE QUANTITIES AS REQUIRED TO MEET DESIGN INTENT.
- GRAFTED PLANT MATERIAL IS NOT ACCEPTABLE.
- DUE TO MODIFICATIONS MADE DURING CONSTRUCTION, SITE CONDITIONS MAY VARY FROM THOSE SHOWN. CONTRACTOR TO VERIFY ALL SUCH CONDITIONS TO HIS SATISFACTION. NO CHANGE IN CONTRACT PRICE WILL BE GRANTED FOR FAILURE TO OBSERVE THIS REQUIREMENT.
- THE CONTRACTOR SHALL, FOR HIS OWN PROTECTION, VERIFY THE PRESENCE AND LOCATION OF ALL UTILITIES PRIOR TO COMMENCING ANY CONSTRUCTION.
- FLAG ALL TREE LOCATIONS AND PAINT ALL BEDLINES FOR LANDSCAPE ARCHITECTS ON-SITE REVIEW AND APPROVAL PRIOR TO BEGINNING PLANTING OPERATIONS.
- ALL PLANTED AREAS SHALL RECEIVE SHREDDED PINE BARK MULCH TO A DEPTH OF 3" AFTER SETTLEMENT.
- PLANTED SLOPES GREATER THAN 3:1 TO RECEIVE PINE STRAW MULCH TO 3" DEPTH AFTER SETTLEMENT.
- ALL SHRUB AREAS SHALL RECEIVE TOPSOIL TO A MINIMUM DEPTH OF 6". ALL SODDED AREAS SHALL RECEIVE TOPSOIL TO A MINIMUM DEPTH OF 4", UNLESS DIRECTED OTHERWISE.
- FERTILIZATION SCHEDULE: AMEND PLANTING MIX OF EACH PLANT WITH FERTILIZER AS FOLLOWS:
 

PLANTING	AMOUNT/PLANT	TYPE
#1 POT	1/4 CUP	6-12-12 OR 5-10-10
#2 POT	1/2 CUP	6-12-12 OR 5-10-10
#3 POT	1/4 CUP	6-12-12 OR 5-10-10
FLWRNG/ SHD. TREE 1 CUP/ 1/2" CAL.		6-12-12 OR 5-10-10
- REMOVE BASE MATERIAL FROM PLANTING AREAS BEFORE PLANTING OPERATIONS BEGIN.
- COORDINATE PLANTING INSTALLATION AROUND LIGHTING FIXTURES.
- NO PLANT MATERIAL WILL BE SET WITH ROOT CROWN LOWER THAN SURROUNDING GRADE. SET TREES WITH ROOT CROWN 2" TO 4" ABOVE SURROUNDING GRADE; SET SHRUBS WITH ROOT CROWN 1"-2" ABOVE SURROUNDING GRADE.
- COMPACTION OF SUBGRADE NOT TO EXCEED 95% STANDARD PROCTOR DENSITY EXCEPT WHERE STRUCTURAL CONSIDERATIONS EXIST AND EXISTING UTILITIES ARE OF CONCERN. CONTRACTOR TO REDUCE SUBGRADE COMPACTION BELOW 95% AS REQUIRED IN ALL OTHER AREAS.
- APPLY PRE-EMERGENT HERBICIDE TO ALL SHRUB BEDS, FOLLOWING MANUFACTURER'S PROCEDURES.
- USE ALL MEANS NECESSARY TO CONTROL DUST ON AND NEAR ALL OF THE AREAS.
- CLEAN ALL PAVED SURFACES OF DEBRIS, MUD, DUST, MULCH, ETC. INCURRED DURING INSTALLATION.
- PLACE TOPSOIL TO MINIMUM DEPTH OF 4" IN ALL SODDED AREAS AND IN ALL PLANTING AREAS.
- ALL SOD AND PLANTING AREAS TO BE IRRIGATED.

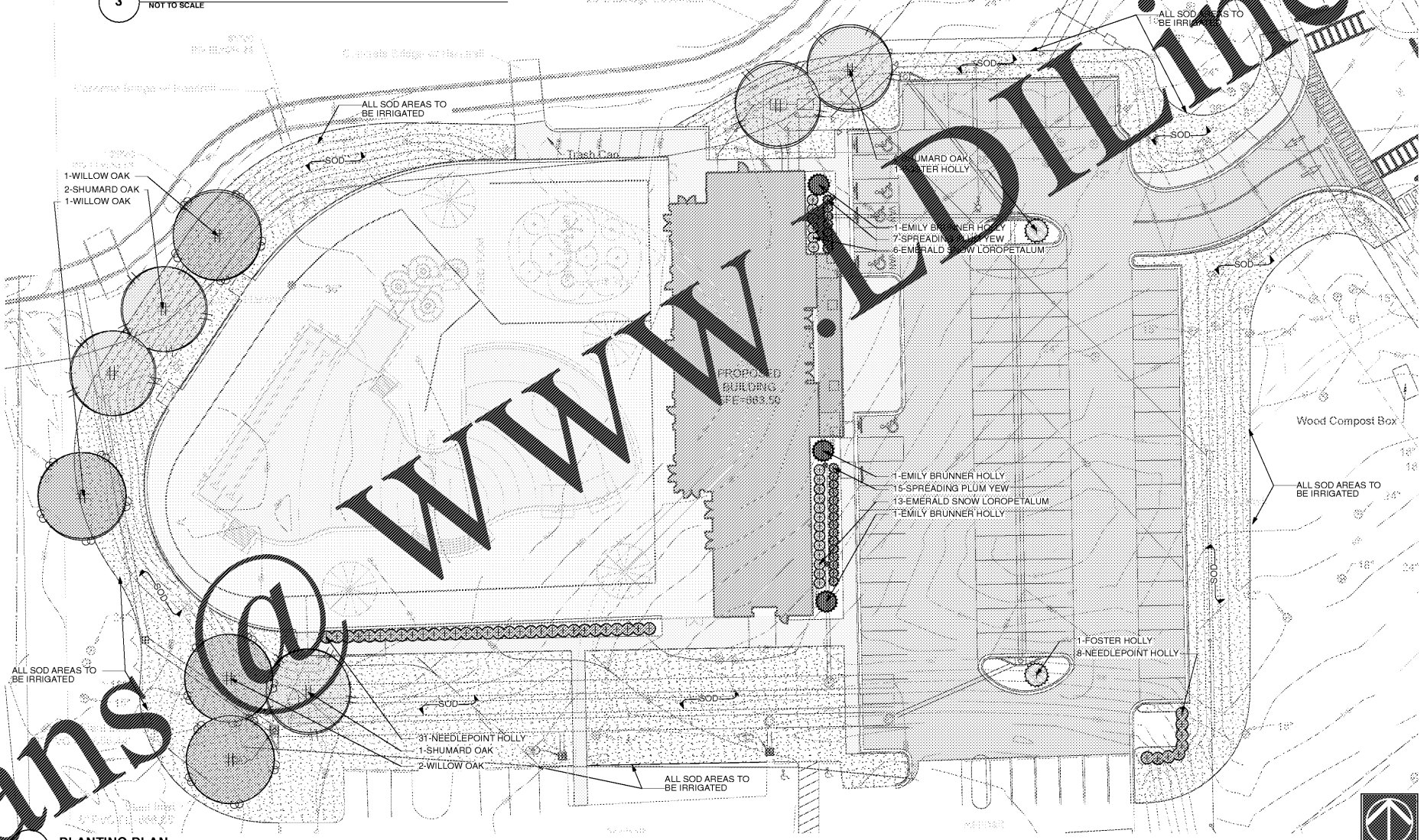

1 PLANTING PLAN  
Scale: 1" = 20 ft

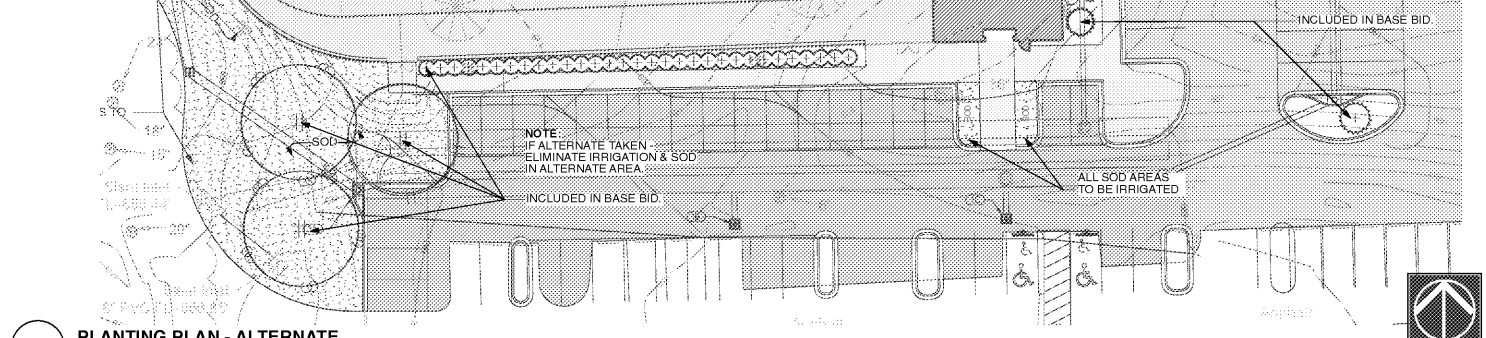

2 PLANTING PLAN - ALTERNATE  
Scale: 1" = 20 ft



HOMWOOD PATRIOT PARK POOL  
HOMWOOD PARKS & RECREATION

HOMWOOD PARKS AND RECREATION; HOMWOOD, AL



OWNER  
HOMWOOD PARKS AND RECREATION  
1637 OXMOOR ROAD  
HOMWOOD, AL 35209  
205-322-6704  
ATTN: BERKELEY SQUIRES

ARCHITECT  
DAVIS ARCHITECTS, INC.  
125 23RD STREET SOUTH  
BRIMMINGHAM, AL 35233  
205-322-7482  
ATTN: JIM HARTSELL

LANDSCAPE ARCHITECT  
HNP  
1914 28TH AVE S  
BRIMMINGHAM, AL 35209  
205-324-4447  
ATTN: TOMMY HOLCOMBE / ED NORTON

CONSTRUCTION MANAGER  
BL HARBERT  
820 SHADES CREEK PARKWAY, SUITE 3000  
BRIMMINGHAM, AL 35209  
205-802-2800  
ATTN: JOHN HANSON

STRUCTURAL ENGINEER  
LEYD INC.  
716 SOUTH 30TH STREET  
BRIMMINGHAM, AL 35233  
205-251-4500  
ATTN: WIM BISHOP / BRAD CHRISTOPHER

MECHANICAL ENGINEER  
WHITAKER & RAWSON  
3332 OLD MONTGOMERY HIGHWAY  
SUITE 103  
BRIMMINGHAM, AL 35209  
205-949-5128  
ATTN: MARK D'ANDREA AND DAN WHITAKER

CIVIL ENGINEER  
LEYD INC.  
716 SOUTH 30TH STREET  
BRIMMINGHAM, AL 35233  
205-251-4500  
ATTN: CURTIS EATMAN AND BRIAN HATCHER

ELECTRICAL ENGINEER  
FISHER ARNOLD  
1507 ALEX DR  
SUITE 101  
BRIMMINGHAM, AL 35210  
205-833-7033  
ATTN: JOSEPH KUMU AND NICHOLAS BROWN

PLUMBING / FIRE PROTECTION ENGINEER  
WHITAKER & RAWSON  
3332 OLD MONTGOMERY HIGHWAY  
SUITE 103  
BRIMMINGHAM, AL 35209  
205-949-5107  
ATTN: ERIC HARTWIG

POOL CONSULTANT  
COUNSILMAN HUNSAKE  
10733 SUNSET OFFICE DRIVE  
SUITE 400  
ST. LOUIS, MO 63127  
314-894-1245  
ATTN: JEFF NODORFT

REV	DATE	DESCRIPTION

DATE: OCTOBER 6, 2017

PROJECT: 100% CONSTRUCTION DOCUMENTS

DRAWN BY: DAVIS ARCHITECTS PROJECT NO: 3822

SHEET TITLE: PLANTING PLAN AND DETAILS

DRAWING NO.:

L1.00

Order Plans @ [www.dilline.com](http://www.dilline.com)