

Lot 1
Zoned: I-2
Land Use: Community Center
Map Book 235, Page 60

LBVD, Inc.
Civil and Structural Engineer
716 South 30th Street
Birmingham, AL 35233
Phone: (205) 251-4500
PROJECT NO. 102-17-062
© Copyright 2017
These drawings and design are the property of LBVD, Inc. and shall not be reproduced without written permission.



HOMWOOD PATRIOT PARK POOL
HOMWOOD PARKS AND RECREATION
HOMWOOD, AL
DAVIS ARCHITECTS

EROSION CONTROL LEGEND	
SB	SILT FENCING
WP	WATTLE INLET PROTECTION
WD	WATTLE CHECK DAM
CR	RIP RAP CHECK DAM
G	GRAVEL SOCK
CEP	CONSTRUCTION EXIT PAD
OP	OUTLET PROTECTION
SW	SLOPE STABILIZATION
P1	PERMANENT PROTECTION (SEE DETAIL)
TSO	TOPSOIL
ECB	EROSION CONTROL BLANKET
DB	DIVERSION BERM
PS	PERMANENT SEEDING
TS	TEMPORARY SEEDING
MP	MULCHING
SP	SURFACE PROTECTION (SEE DETAIL)
IP	INLET PROTECTION (SEE DETAIL)
PC	PILE PROTECTION (SEE DETAIL)

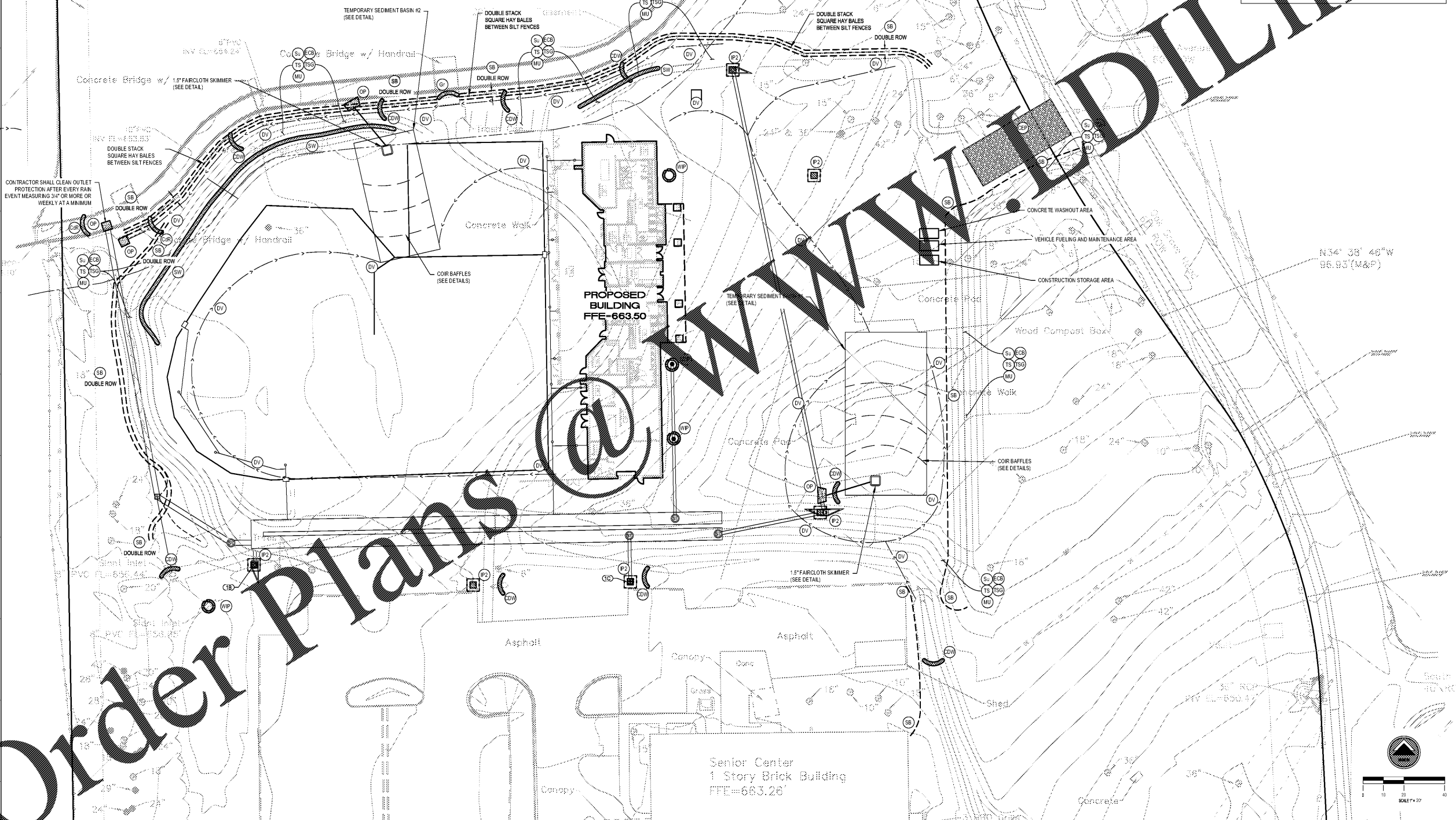

Order Plans @ www.dilme.com

- OWNER
HOMWOOD PARKS AND RECREATION
1632 OXNOR ROAD
HOMWOOD, AL 35209
205-322-6704
ATTN: BERLEY SQUIRES
- ARCHITECT
DAVIS ARCHITECTS, INC.
129 2ND STREET SOUTH
BIRMINGHAM, AL 35233
205-322-7482
ATTN: JIM HARTSELL
- LANDSCAPE ARCHITECT
HNP
1914 28TH AVE S
BIRMINGHAM, AL 35209
205-324-4447
ATTN: TOMMY HOLCOMBE / ED NORTON
- CONSTRUCTION MANAGER
BL HARBERT
820 SHADES CREEK PARKWAY, SUITE 3000
BIRMINGHAM, AL 35209
205-802-2600
ATTN: JOHN HANSON
- STRUCTURAL ENGINEER
LBVD INC.
716 SOUTH 30TH STREET
BIRMINGHAM, AL 35233
205-251-4500
ATTN: WIN BISHOP / BRAD CHRISTOPHER
- MECHANICAL ENGINEER
WHITAKER & RAWSON
3332 OLD MONTGOMERY HIGHWAY
SUITE 103
BIRMINGHAM, AL 35209
205-470-6001
ATTN: DAN WHITAKER, ERIC HARTWIG, AND MARK D'ANDREA
- CIVIL ENGINEER
LBVD INC.
716 SOUTH 30TH STREET
BIRMINGHAM, AL 35233
205-251-4500
ATTN: CURTIS EATMAN AND BRIAN HATCHER
- ELECTRICAL ENGINEER
FISHER ARNOLD
1507 ALEX DR.
SUITE 101
BIRMINGHAM, AL 35210
205-853-7033
ATTN: JOSEPH KUMU AND NICHOLAS BROWN
- PLUMBING / FIRE PROTECTION ENGINEER
EDMONDS ENGINEERING
2 RIVERCHASE OFFICE PLAZA
SUITE 205
BIRMINGHAM, AL 35244
205-968-2066
ATTN: CAROL JOHNSON
- POOL CONSULTANT
COUNSILMAN HUNSAKE
10733 SUNSET OFFICE DRIVE
SUITE 400
ST. LOUIS, MO 63127
314-894-1245
ATTN: JEFF WOODRFT

REV	DATE	DESCRIPTION

DATE	OCTOBER 08, 2017
SCALE	100% CONSTRUCTION DOCUMENTS
DRAWN BY	
CHECKED BY	
DESIGNED BY	
PROJECT NO.	3822
SHEET TITLE	

EROSION CONTROL PLAN
(INTERMEDIATE PHASE)

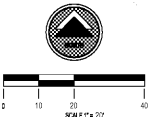

A1 EROSION CONTROL PLAN (INTERMEDIATE PHASE)

1 / #01 SCALE: 1" = 20'

C3.1