

1. ALL SHEET METAL FLASHING TO BE 22 GA. MIN. U.O.N.
2. ROOF PENETRATIONS CLOSER THAN 12" FROM ANOTHER WILL NOT BE PERMITTED.
3. NEW ROOFING IN AREAS OF NEW AND DISTURBED AREAS OF CONSTRUCTION TO MATCH EXISTING ROOFING SYSTEM.
4. G.C. SHALL COORDINATE ALL INSTALLATION REQUIREMENTS FOR MECHANICAL EQUIPMENT REFER TO MECHANICAL DRAWINGS
5. REFER TO MANUFACTURER'S STANDARD DETAILS AT MEMBRANE PENETRATIONS
6. COORDINATE NEW RTU ROOF PENETRATIONS WITH ROOF MANUFACTURER SO AS NOT TO VOID WARRANTY.
7. REMOVE PORTION OF EXISTING DOWNSPOUTS, GUTTERS, & FASCIA BOARD AS REQUIRED FOR NEW CONSTRUCTION; PROVIDE SNOW GUARDS WHERE THE SIDEWALK IS WITHIN 3'-0" OF THE ROOF OVERHANG (NEW ADDITION ONLY).
8. PROVIDE SNOW GUARDS WHERE THE SIDEWALK IS WITHIN 3'-0" OF THE ROOF OVERHANG (NEW ADDITION ONLY).

(B) ROOF PLAN GENERAL NOTES  
1" = 1'-0"

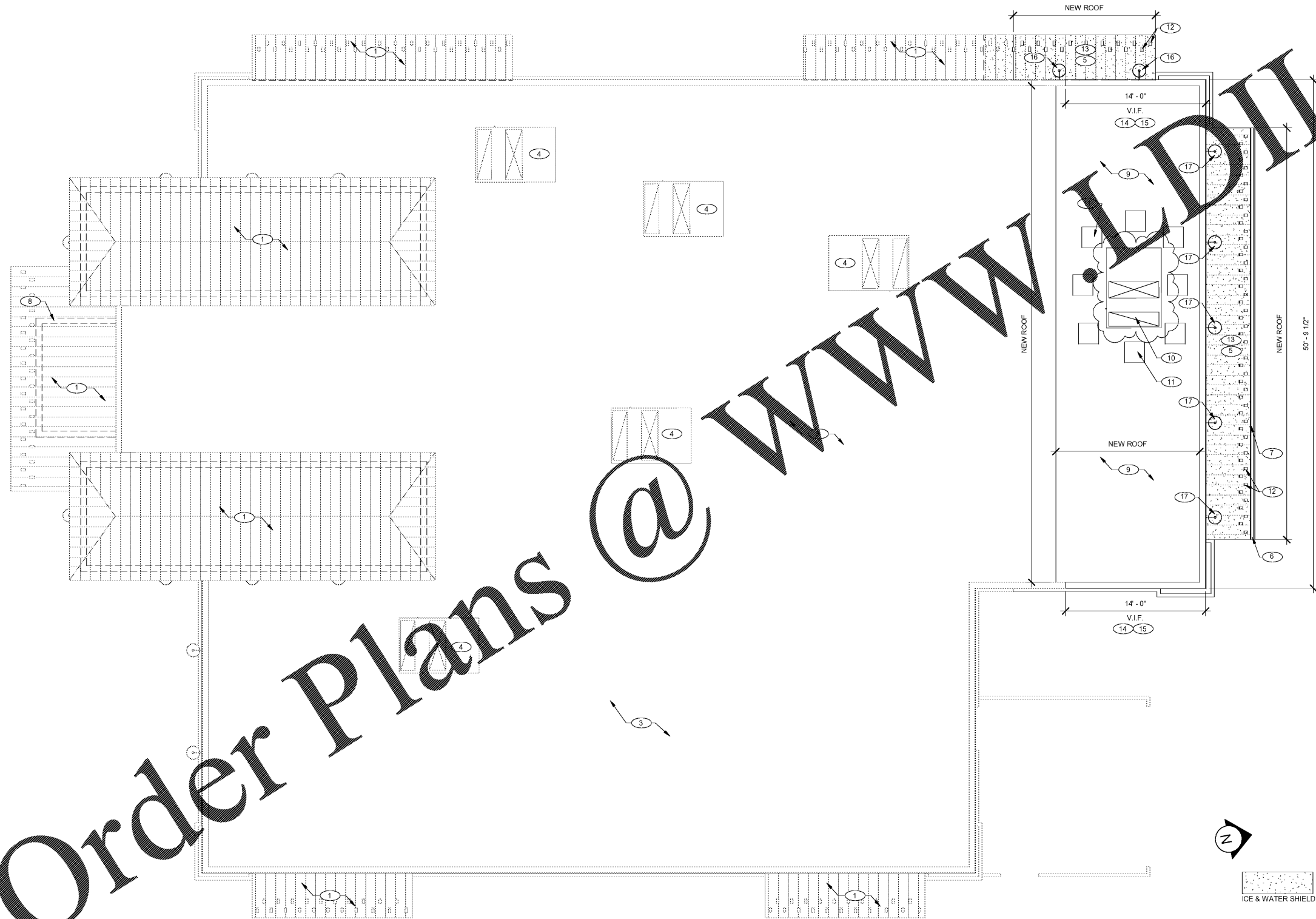

- 1 EXISTING 5 RIB V-GROOVE METAL ROOFING TO REMAIN.
- 2 NOT USED.
- 3 EXISTING SINGLE-PLY ROOFING TO REMAIN.
- 4 EXISTING MECHANICAL ROOF TOP EQUIPMENT TO REMAIN.
- 5 NEW 5 RIB V-GROOVE METAL ROOF TO MATCH EXISTING.
- 6 NEW 4" DOWNSPOUT COLOR TO MATCH WOOD TRIM - TIE INTO EXISTING DRAIN LINES.
- 7 NEW 5" METAL GUTTER - COLOR TO MATCH WOOD TRIM. TIE NEW GUTTER INTO EXISTING GUTTER - PITCH GUTTER TO ENSURE POSITIVE FLOW OF WATER TO UNDER EXISTING METAL ROOFING.
- 8 LINE OF WALL CONSTRUCTION BELOW ROOF.
- 9 NEW SINGLE-PLY ROOFING TO REMAIN.
- 10 NEW ROOF TOP HVAC UNIT - SEE MECHANICAL SHEETS FOR ADDITIONAL INFORMATION. G.C. TO PROVIDE CURB CANT STRIP AND/OR CRICKET AROUND CURB TO ENSURE POSITIVE DRAINAGE.
- 11 G.C. TO PROVIDE WALK PADS AROUND ALL NEW HVAC UNITS AND EQUIPMENT - PADS TO MATCH EXISTING AND CONFORM TO ROOF MANUFACTURERS REQUIREMENTS.
- 12 SNOW GUARDS - ALL SNOW GUARDS TO BE SCREWED, GLUED AND SEALED - SPACE GUARDS AS RECOMMENDED BY MANUFACTURER. COLOR TO MATCH ROOF.
- 13 INSTALL ICE & WATER SHIELD UNDER NEW ROOF AND EXTEND 36" EACH WAY IN ALL DIRECTIONS UNDER EXISTING METAL ROOFING.
- 14 NEW NOM. 2X6" STUD FRAMING 16" O.C.
- 15 NEW PARAPET WALL WITH CEDAR SIDING AND TRIM TO MATCH EXISTING.
- 16 NEW EXTERIOR LIGHTING TO MATCH EXISTING.
- 17 NEW LOCATION FOR RE-USED EXTERIOR LIGHTING.

(C) ROOF PLAN KEYNOTES  
1" = 1'-0"

(A) ROOF PLAN  
3/16" = 1'-0"

Order Plans

WWW.LDILine.com

@

snideman

ARCHITECTS

Design +,  
INC.  
Bardonia-Eastern Building  
140 Bardonia Rd., Suite 200  
Louisville, KY 40204  
(502) 454-0011

TEXAS road house

1570 W. KOGER CENTER  
DRIVE RICHMOND, VA 23235

| PERMIT SET |             |
|------------|-------------|
| DRAWN BY   | LJL         |
| CHECKED BY | KRB         |
| DATE       | 6/22/2017   |
| REV. DATE  | DESCRIPTION |

1 OWNER COMMENTS  
7/26/17

The Construction Documents shall consist of all drawings, specifications, surveys, soils reports, addenda and other information. It is the responsibility of the contractor to be held separately or "stand alone" from the remainder of the documents. The contractor shall be responsible to determine their particular scope of work. Any Documents to be submitted to the Architect for review shall be interpreted at the sole discretion of the Architect.

SHEET TITLE  
NEW ROOF PLAN

A3.0

QUALITY CONTROL CHECK: ADA SNOW GUARDS SLAB THICKNESS EGRESS BLDG CODES