

Project

Sam's Xpress Car Wash
4965 University Parkway
Winston-Salem, NC 27106

Owner

Sam's Main
935 Fountain Place
Suite 200
Matthews, NC 28105

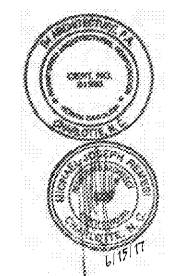

124 Floyd Smith Dr
Suite 375
Charlotte, NC 28262
Tel - 704 - 688-7500

2000 Sam Rittenberg Blvd.
Suite 116
Charleston, SC 29407
Tel - 843 - 531-6848

www.R4architecture.com

Revision	Date

Drawn By TRB
Checked By MJR
Issue Date 06.15.17
Project No 170382

Sheet Title
CASEWORK SECTIONS

Sheet Number
A502

CASEWORK NOTES:
CASEWORK DESIGN,
CONSTRUCTION AND
INSTALLATION BY 809
DESIGN, GC SHALL
COORDINATE.

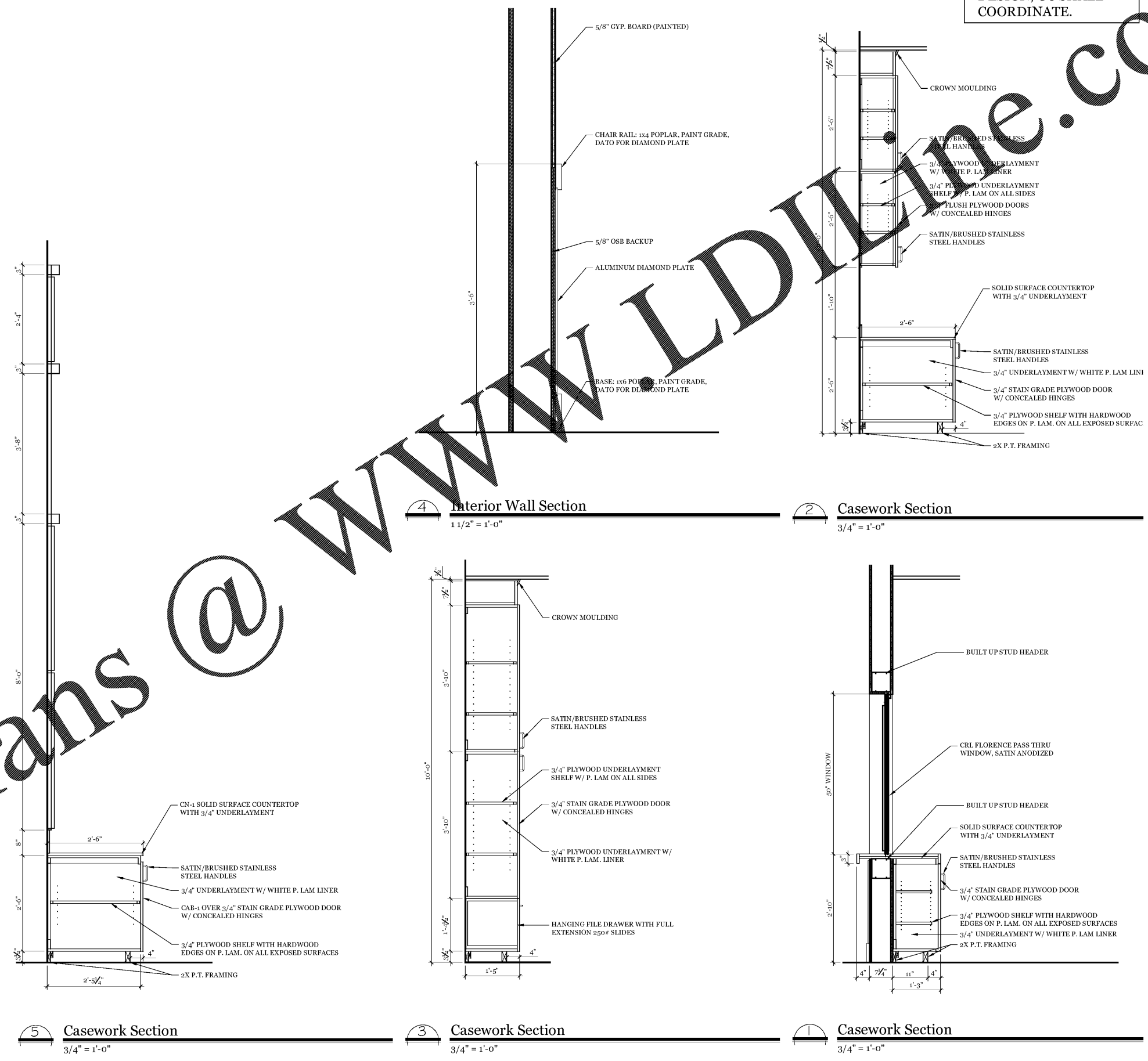

Order Plans @ WWW.LDINLINE.COM

ALL RIGHTS RESERVED BY THE ARCHITECT. THIS SET OF PLANS IS THE PROPERTY OF R4 ARCHITECTURE, INC. AND SHALL REMAIN THE PROPERTY OF R4 ARCHITECTURE, INC. ANY REPRODUCTION OR DISTRIBUTION OF THESE PLANS WITHOUT THE WRITTEN PERMISSION OF R4 ARCHITECTURE, INC. IS STRICTLY PROHIBITED.