

PLUMBING CALCULATION
LOUNGE A-3: 21.8 PEOPLE: (LOUNGE) MALE W.C. = 1 PER 125 PEOPLE / LAV. = 1 PER 200 PEOPLE = 21.8 / 125 = 0.17 W.C. & 21.8 / 200 = 0.11 LAV.
FEMALE W.C. = 1 PER 65 PEOPLE / LAV. = 1 PER 200 PEOPLE = 21.8 / 65 = 0.34 W.C. & 21.8 / 200 = 0.11 LAV.
DRINKING FOUNTAIN = 1 PER 500 OR 0.04
BUSINESS: 6.47 PEOPLE (OFFICE, CORRIDOR, TOILET ROOMS) MALE/FEMALE W.C. = 1 PER 25 FOR FIRST 50/ LAV. = 1 PER 40 = 3.24/25 = 0.13 W.C. & 3.24/40 = 0.08 LAV
DRINKING FOUNTAIN = 1 PER 100 OR 0.06
STORAGE/MECHANICAL: 2.55 PEOPLE (EQUIPMENT AND ELECTRICAL ROOMS) MALE/FEMALE W.C. = 1 PER 100 / LAV. = 1 PER 100 = 2.55/100 = 0.02 W.C. & 2.55/40 = 0.02 LAV
DRINKING FOUNTAIN = 0 REQUIRED
TOTAL REQUIRED FOR THE ABOVE AREAS: FEMALE = 0.49 W.C. & 0.21 LAV MALE = 0.32 W.C. & 0.21 LAV COMBINED DRINKING FOUNTAIN = 0.10
TOTAL PROVIDED FOR THE ABOVE AREAS: FEMALE = 1 W.C. & 1 LAV. MALE = 1 W.C. & 1 LAV. COMBINED DRINKING FOUNTAIN = 2

**CONTRACTOR'S NOTES:**  
1. THIS PLAN IS AN ILLUSTRATIVE LIFE SAFETY PLAN ONLY. SEE SHEET 3-101 FOR ACTUAL FLOOR PLAN FOR DIMENSIONED AND NOTED PLAN FOR CONSTRUCTION PURPOSES- TYP.

**DEDICATED MEANS OF EGRESS:**  
1. SEE ALSO CIVIL DRAWINGS FOR ADDITIONAL SITE IMPROVEMENTS RELATED TO ACCESSIBLE ACCESS AND EGRESS, AS WELL AS ACCESS TO "PUBLIC WAY"

**WALL RATINGS:**

---	DRAFTSTOPPING
-----	---------------

**DEVICE LEGEND AND NOTES**

**CR** CARD READER  
**EL** ELECTRIFIED LOCKING HARDWARE  
**PD** PANIC DEVICE

**DEVICE GENERAL NOTES:**  
1. DEVICES SHOWN FOR LIFE SAFETY PLAN AND INSTALLATION COORDINATION PURPOSES.  
2. CONTRACTOR COORDINATE PERMIT APPLICATION AND INSPECTION REQUIREMENTS FOR LIFE SAFETY DEVICES WITH LOCAL AUTHORITY HAVING JURISDICTION.  
3. DEVICES SHOWN INDICATE OPERATIONAL INTENT OF OPENING. COORDINATE FUNCTIONS WITH HARDWARE SETS ON DOOR OPENING AND HARDWARE SCHEDULE.  
4. COORDINATE HARDWARE, DEVICES AND OPENINGS WITH OWNER, OWNER VENDOR, AND CONTRACTORS AS REQUIRED.  
5. COORDINATE CONNECTIONS AND OPERATIONAL TIE-IN TO BUILDING SERVICES AS REQUIRED.

**DOOR OPERATION NOTES**

1. OFFICE DOOR:  
• CARD READER RELEASES ELECTRIC STRIKE  
• UPON LOSS OF POWER STRIKE FAILS TO ALLOW FREE INGRESS/EGRESS.

2. EQUIPMENT ROOM DOOR:  
• ACTIVE LEAF HAS ELECTROMECHANICAL LOCKSET RELEASED BY CARD READER ON EXTERIOR SIDE  
• INTERIOR LEVER ALLOWS FREE PASSAGE AT ALL TIMES  
• UPON LOSS OF POWER STRIKE FAILS TO MANUAL MECHANICAL OPERATION WITH KEY FROM EXTERIOR

3. ELECTRICAL ROOM DOOR:  
• CARD READER RELEASES ELECTRIC STRIKE  
• PANIC DEVICE ALLOWS FREE PASSAGE AT ALL TIMES  
• UPON LOSS OF POWER STRIKE FAILS TO ALLOW FREE INGRESS/EGRESS.

**LIFE SAFETY LEGEND:**

OCCUPANCY  
ROOM# — OCCUPANCY USE TYPE  
# SF — AREA SQUARE FEET (SF)  
## SF/OCCUPANT — SF/PERSON BY OCCUPANT TYPE  
## PERSONS — LOAD = [AREA/(SF/PERSON)]  
# — PLANNED EGRESS OCCUPANT LOAD

OCC. — OCCUPANCY COUNT  
## OCC. (# #) — EGRESS CAPACITY (CLEAR WIDTH)

— — OVERALL DIAGONAL OF THE 1/2 DIMENSION FOR MIN. EGRESS SEPARATION.  
— — ACTUAL DISTANCE BETWEEN EGRESS  
— — MAXIMUM TRAVEL DISTANCE  
— — DEAD END CORRIDOR DISTANCE

— — FIRE EXTINGUISHER ON WALL BRACKET  
— — FIRE EXTINGUISHER AND CABINET

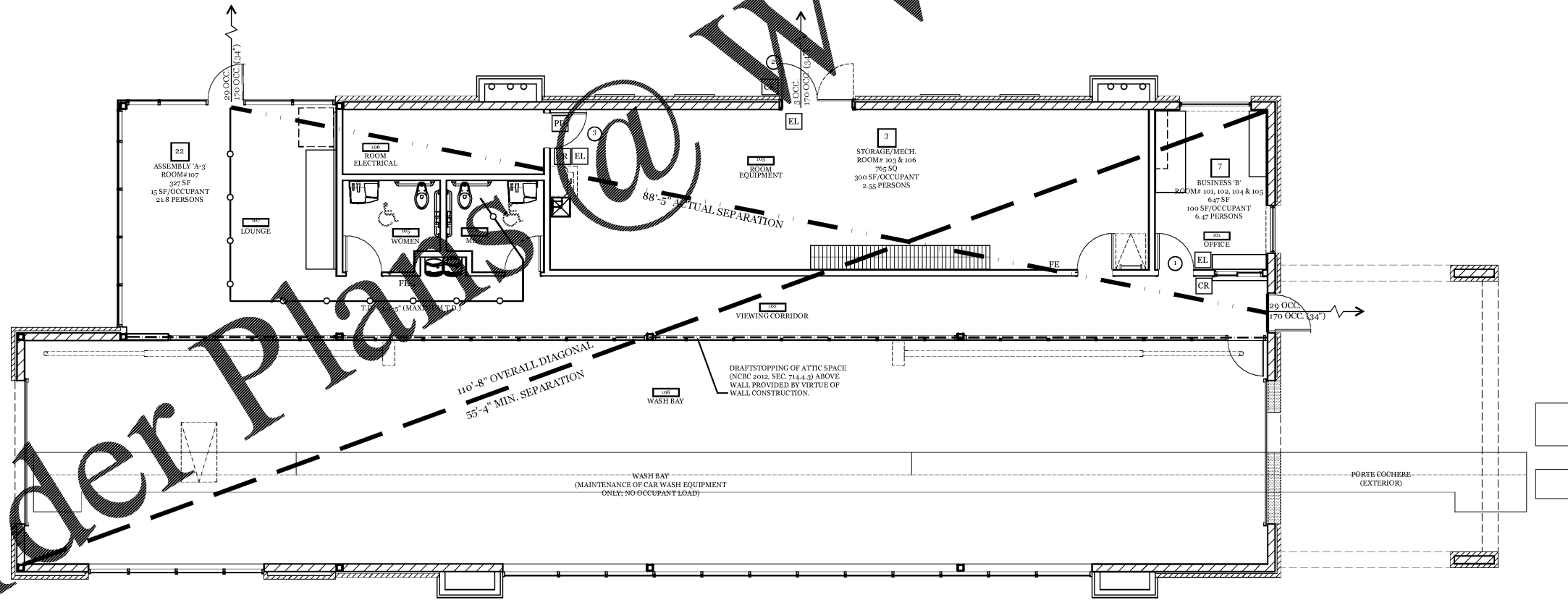

Life Safety Plan  
3/16" = 1'-0"

**Project**  
Sam's Xpress Car Wash  
4965 University Parkway  
Winston-Salem, NC 27106

**Owner**  
Sam's Maintenance  
7935 Council Place  
Suite 200  
Matthews, NC 28105

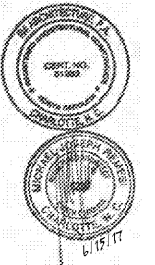

124 Floyd Smith Dr  
Suite 375  
Charlotte, NC 28262  
Tel - 704 - 688-7500

2000 Sam Rittenberg Blvd.  
Suite 116  
Charleston, SC 29407  
Tel - 843 - 531-6848

www.R4architecture.com

Revision Date

Drawn By TRB  
Checked By MJR  
Issue Date 06.15.17  
Project No 170382

Sheet Title  
LIFE SAFETY  
PLAN

Sheet Number  
**A001**