

Order Plans @

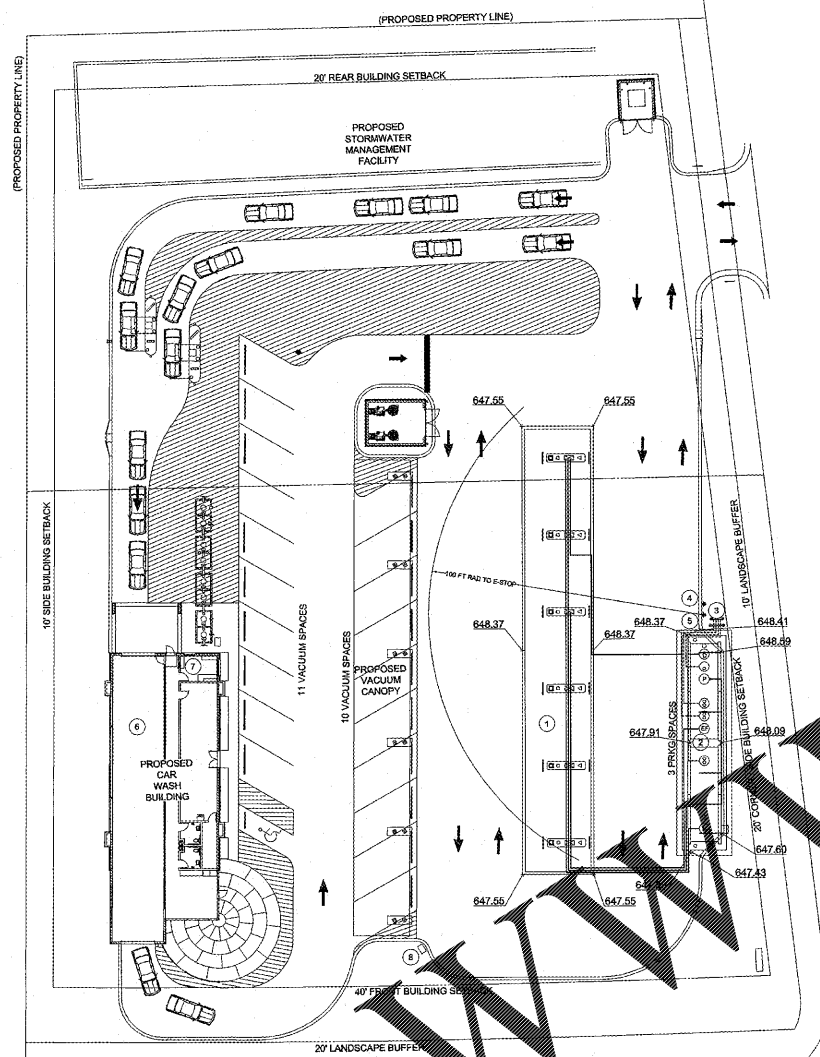

1 ARCHITECTURAL SITE PLAN  
SC 1/32" = 1'-0"

- DEFINING LINE BETWEEN CAR WASH GC AND FUEL GC**
- FUEL CONTRACTOR**
- FUEL GC TO WORK WITH CAR WASH GC ON SCHEDULING.
  - FUEL GC IS RESPONSIBLE FOR ALL CONCRETE OVER THE UNDERGROUND FUEL STORAGE TANKS AND CANOPY SLAB.
  - FUEL GC RESPONSIBLE FOR CANOPY FOOTINGS.
  - FUEL GC TO INSTALL CANOPY DRAINS (WHERE APPLICABLE) TO POINT OF CONNECTION WITHIN (10) FT OF DRIVE SLAB(S).
  - FUEL GC TO INSTALL ALL FUEL RELATED ELECTRONICS (I.E. DATA LOGS, CONTROL UNIT, TURBINE RELAYS, ISOLATION RELAYS, ETC) IN THE UTILITY BUILDING.
  - FUEL GC RESPONSIBLE FOR ALL ELECTRICAL CONDUITS, TIE-OFFS, ELECTRICAL J-BOXES PER STATE, LOCAL CODES AND MANUFACTURER'S INSTALLATION INSTRUCTIONS.
  - FUEL GC TO PULL WIRE FOR CANOPY LIGHTS, DISPENSERS, TURBINES AND MONITORING SYSTEM DEVICES.
  - FUEL GC TO MAKE ALL FIELD CONNECTIONS TO FUELING EQUIPMENT AND ELECTRONICS.
  - FUEL GC TO PULL AND MAKE PERMITS FOR ALL FIELD WORK (AS REQUIRED).
  - FUEL GC TO CALL, POST AND BE PRESENT FOR ALL LOCAL REGULATOR INSPECTIONS AND BE RESPONSIBLE FOR SCHEDULING ON-SITE INSPECTIONS WITH AN APPROPRIATE OWNER'S REPRESENTATIVE RELATED TO FUELING.
  - FUEL GC TO COORDINATE WITH TANKLOGS AND THE OWNER'S CONSTRUCTION MANAGER FOR TESTING OF FUELING SYSTEM.
  - FUEL GC TO HAVE PERSONNEL ON SITE FOR TESTING.

**STRUCTURE INDEX**

1	FUELING CANOPY FOR (6) DISPENSERS
2	UNDERGROUND FUEL STORAGE TANKS AND SLAB
3	REMOTE VENT RISERS AND 5 FT WD HOOP BOLLARD
4	911 EMERGENCY PHONE
5	EMERGENCY SHUT OFF SWITCH
6	CAR WASH BY OTHERS - SHOWN FOR REFERENCE
7	FUEL SITE MONITOR TLS 450R IN THE OFFICE OF CAR WASH
8	AIR MACHINE

PER UNION COUNTY ENVIRONMENTAL HEALTH, THERE ARE NO WATER WELLS WITHIN 500 FT OF THE UNDERGROUND STORAGE TANKS AT THIS SITE.

**TANK BURIAL CHART - INDIAN TRAIL, NC**

COMPONENT	PREMIUM	DIESEL	VENT
A. FINISH GRADE ELEV. AT BEGINNING OF RUN (FT):	648.43	648.43	648.5
B. PIPE BURY (FT):	3.25	3.25	2
C. ELEVATION OF PIPE AT BEGINNING OF RUN (A-B):	645.18	645.18	646.5
D. PIPE LENGTH (LONGEST RUN) (FT):	251	93	69
E. PIPING RUN FALL (FT) (D"1/8" PER FT):	2.61	0.97	0.72
F. TOTAL CROSSOVERS/SWING JOINTS:	0	0	0
G. CROSSOVER/SWING JOINT DEPTH (FT):	0	0	0
H. ELEVATION AT END OF PIPE (FT) (C-E-G):	642.57	644.21	645.78
I. ADD FOR EXTRACTOR TEE AT SUMP:	1	1	1.5
J. TOP TANK ELEVATION (FT) (H-I):	641.57	643.21	644.28
K. HIGHEST FINISH GRADE ELEVATION AT TANK SLAB (FT):	648.36	648.36	648.36
L. MAX BURY DEPTH (K-J)(FT): MAX = 5.67'	6.79	5.15	4.08
M. LOWEST FINISH GRADE ELEVATION AT TANKS (FT):	647.5	647.5	647.5
N. MIN BURY DEPTH (M-J) (FT): MIN = 4.17'	5.93	4.29	3.22

TANK BURIAL DEPTH IS GOVERNED BY PREMIUM PRODUCT AT = 6.79'  
THE TOP OF TANKS SHALL BE SET AT 641.57' - APPROVAL MUST BE OBTAINED FROM OWNER AND TANK MFR

**HFA**  
ARCHITECTS  
ENGINEERS  
INTERIORS

**HARRISON FRENCH**  
ASSOCIATES, PLLC

105 S. Walnut St., Suite 3  
Indian Trail, NC 28071  
1-704-833-7700  
f888-2119685  
www.hfa-ac.com

**STIPULATION FOR REUSE**

THIS DRAWING HAS BEEN PREPARED FOR THE PROJECT AND SITE SPECIFIC TO THE PROJECT AND SITE. IT IS NOT TO BE REUSED FOR ANY OTHER PROJECT OR SITE WITHOUT THE WRITTEN CONSENT OF HARRISON FRENCH ASSOCIATES, PLLC. ANY REUSE OF THIS DRAWING FOR ANY OTHER PROJECT OR SITE WITHOUT THE WRITTEN CONSENT OF HARRISON FRENCH ASSOCIATES, PLLC IS STRICTLY PROHIBITED. HARRISON FRENCH ASSOCIATES, PLLC AND ITS EMPLOYEES SHALL NOT BE LIABLE FOR ANY REUSE OF THIS DRAWING FOR ANY OTHER PROJECT OR SITE WITHOUT THE WRITTEN CONSENT OF HARRISON FRENCH ASSOCIATES, PLLC.

**SAM'S MART**  
US HY 74 & TECHNOLOGY BLVD  
INDIAN TRAIL, NC 28079

JOB NUMBER: 07-16-80004

**ISSUE BLOCK**

STORE NO.:  
DOCUMENT DATE: 05-31-17  
CHECKED BY: JKH  
DRAWN BY: JMA  
PROTO CYCLE MAY-2017

**HARRISON FRENCH AND ASSOCIATES, PLLC**  
P-0402

Professional Engineer Seal: RYAN S. RAY, No. 030048

MAY 31 2017

**FUELING SITE PLAN**

SHEET: **FS2**

May 31 2017 4:05pm - User: jkh  
2017-05-31 08:00:04 - Sam's Mart - Indian Trail, NC Fueling Site Plan.dwg