

DATE PLOTTED: SEPTEMBER 21, 2017 PLOTTED BY: STEVE AT 11:48  
 1708B200B.DWG-09-21-17 AT 11:48 - STEVE SHEET SIZE: 24.0x36.0  
 1708B200B.DWG-09-08-17 AT 09:09 - STEVE SHEET SIZE: 24.0x36.0  
 © COPYRIGHT LAWRENCE L. CORLEY, THESE DRAWINGS / FILES, AS INSTRUMENTS OF SERVICE, ARE, AND SHALL REMAIN THE SOLE PROPERTY OF THE ARCHITECT. THEY ARE NOT TO BE REPRODUCED IN ANY FORM WITHOUT WRITTEN CONSENT OF THE ARCHITECT.

Order Plans @ WALKLINE

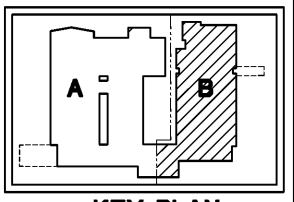
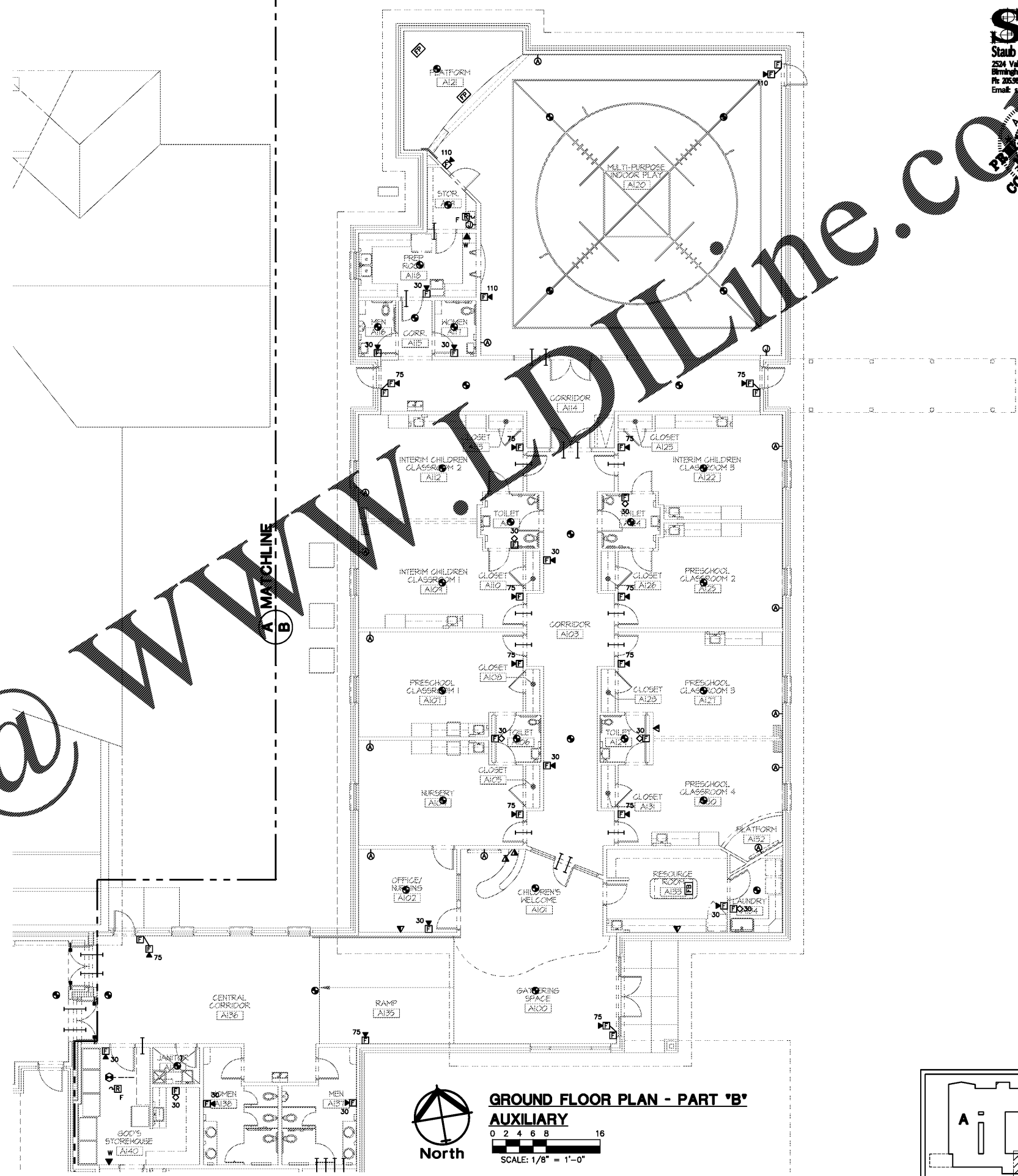

KEY PLAN

**GROUND FLOOR PLAN - PART "B"**  
**AUXILIARY**  
 0 2 4 6 8 16  
 SCALE: 1/8" = 1'-0"

**SET**  
 Staub Engineering Inc.  
 2524 Valleydale Road,  
 Birmingham, Alabama 35244  
 Ph: 205.981-8100 Fax: 205.981-8597  
 Email: staub@seta.com



**Corley Timothy Sweeney McCormac**  
 ARCHITECTS, INC.  
 THREE RIVERCHASE OFFICE PLAZA / SUITE 124 / HOOVER, ALABAMA 36244  
 T 205.443.3720 F 205.443.3720

**GROUND FLOOR PLAN**  
**PART "B"**  
**AUXILIARY**

08-30-17  
 ALABAMA  
 1904

**FIRST BAPTIST CHURCH**  
**CHILDREN'S ADDITION**  
 HAYDEN,

REVISED:  
**E320B**