

30 AUG 2017 3:04 PM C:\projects\1904-FBC-Hayden\1904-FBC-Hayden\1904-SD\A200-A120-Phase One.dwg PLOTTED BY: mgr/ffn

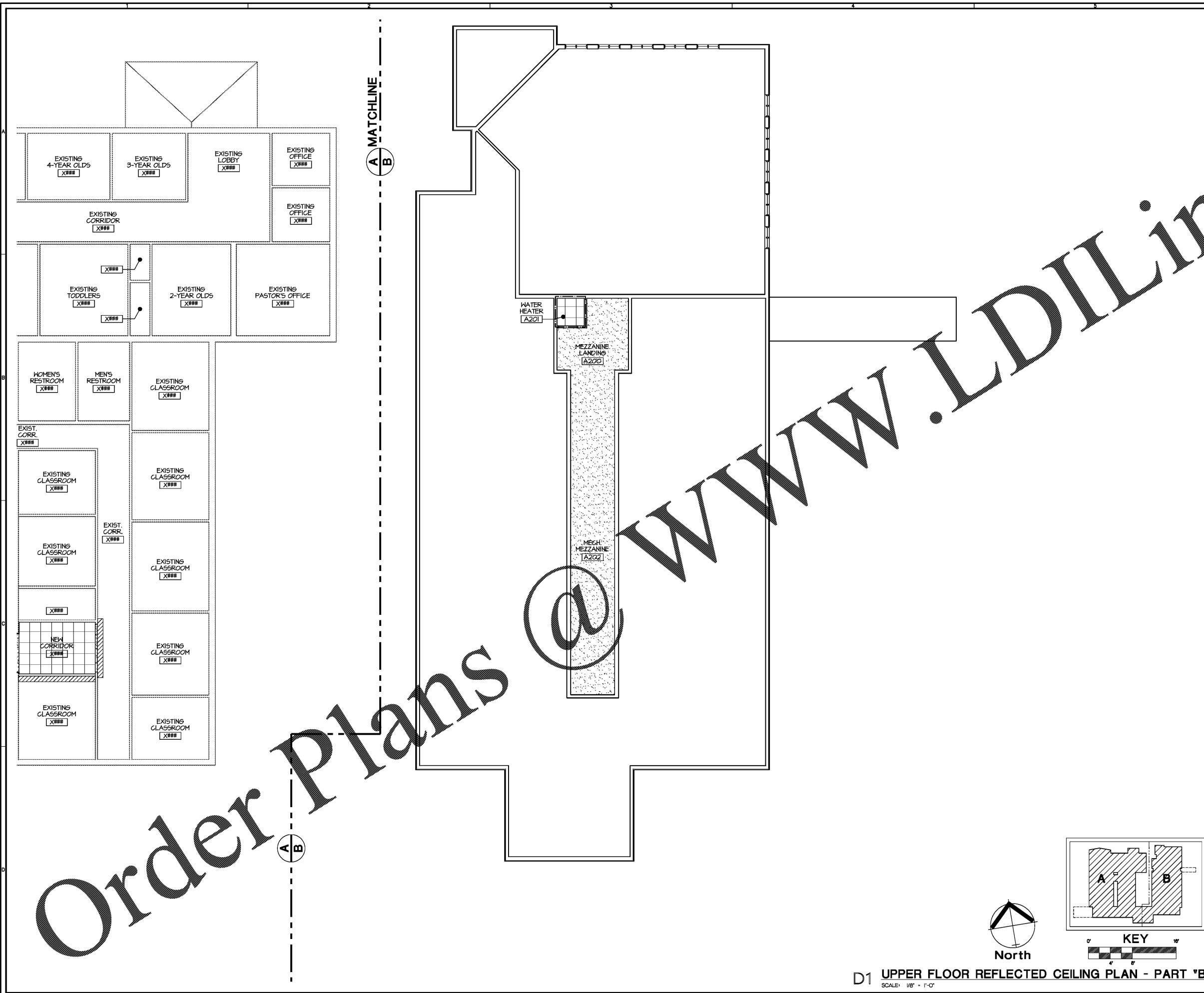

GENERAL REFLECTED CEILING NOTES

- IT IS THE INTENT OF THE CONTRACT DOCUMENTS TO PROVIDE FOR A COMPLETE AND FULLY SUPPORTED CEILING INSTALLATION IN ALL REQUIRED AREAS. IT IS THE RESPONSIBILITY OF THE GENERAL CONTRACTOR AND HIS SUBCONTRACTORS TO THOROUGHLY REVIEW DOCUMENTS AND COORDINATE ALL CEILING MATERIALS, EQUIPMENT, FIXTURES, INSTALLATION, LABOR, ETC. PROVIDE ALL NECESSARY LABOR, MATERIALS, SUPPORT, ETC. AS REQUIRED TO COMPLETE THE CEILING INSTALLATION.
- GENERAL - REFER ALSO TO GENERAL NOTES ON SHEET 6102 FOR ADDITIONAL INFORMATION.
 - CEILING HEIGHTS - REFER TO FINISH SCHEDULE. CEILING HEIGHTS SHALL MATCH EXISTING AT ADJACENT LOCATIONS, UNLESS NOTED OTHERWISE.
 - LAY-IN CEILING - CEILING TO BE EXTENDED ACOUSTICAL TILE LAY-IN CEILING, 2' x 2' OR 2' x 4' SIZE, UNLESS NOTED AS INDICATED ON REFLECTED CEILING PLAN. TILES SHALL WEIGH A MINIMUM OF ONE POUND PER SQUARE FOOT WHEN USED IN A FIRE RESISTANT CEILING ASSEMBLY.
 - GRID, DIFFUSERS, REGRIDDERS - POSITION AS INDICATED ON REFLECTED CEILING PLANS AND MECHANICAL PLANS. CONFLICTS SHALL BE VERIFIED PRIOR TO INSTALLATION.
 - SPRINKLER HEADS, SMOKE DETECTORS, SPEAKERS, ETC. - LOCATE THE CENTER OF CEILING TILE, UNLESS INDICATED OTHERWISE. THIS SHALL BE VERIFIED PRIOR TO INSTALLATION.
 - LIGHTS - POSITION AS INDICATED ON REFLECTED CEILING PLAN AND ELECTRICAL LIGHTING PLAN. CONFLICTS SHALL BE VERIFIED PRIOR TO INSTALLATION. EXISTING FIXTURES SHALL BE UTILIZED WHERE SHOWN. REMAINING EXISTING LIGHTS NOT REQUIRED SHALL BE TURNED OVER TO THE OWNER IF IN WORKING ORDER.
 - CEILING HUNG ACCESSORIES - INSTALL AS INDICATED IN DETAILS, AS REQUIRED BY MANUFACTURER AND AS REQUIRED BY FIELD CONDITIONS. SEE ALSO FOLLOWING NOTE.
 - SUPPORT - DO NOT HANG ANY ITEM FROM EXISTING OR NEW ROOF DECK. CONNECT OR SUSPEND ONLY FROM STRUCTURAL MEMBERS OR OTHER MEMBERS THAT ARE SECURED TO THE STRUCTURE.
 - SOFFITS - PROVIDE DROPPED GYPSUM WALLBOARD SOFFITS WHERE INDICATED. GYPSUM BOARD SHALL EXTEND AND BE SEALED TO ADJACENT WALLS AND EXTEND A MINIMUM OF 4" ABOVE THE ADJACENT HIGHER CEILING, UNLESS NOTED OTHERWISE. FRAMING SHALL BE BRACED AT 4'-0" O.C.
 - EXIT LIGHTS - EXISTING EXIT LIGHTS WHERE STILL REQUIRED SHALL REMAIN. EXISTING EXIT LIGHTS NOT REQUIRED SHALL BE RELOCATED TO NEW REQUIRED POSITIONS, UNLESS INDICATED OTHERWISE. NEW EXIT LIGHTS SHALL BE AS SHOWN ON ELECTRICAL DRAWINGS.
 - EXISTING CEILINGS - AREAS WITH EXISTING CEILINGS SHALL BE EXTENDED INTO NEW AREAS WHERE REQUIRED BY NEW CONSTRUCTION, AND SHALL MATCH EXISTING CONSTRUCTION, TYPE, COLOR AND SPACING OF GRID, FIXTURES, SPRINKLERS, DIFFUSERS, ETC. TAKE CARE NOT TO DAMAGE EXISTING CEILINGS TO BE REUSED OR EXTENDED. REPAIR OR REPLACE DAMAGED AREAS AT NO ADDITIONAL COST TO THE OWNER. WHERE EXISTING CEILINGS ARE REMOVED, TAKE CARE TO REMOVE ONLY THAT PORTION SO INDICATED TO BE REMOVED.
 - HANGER WIRE - LOCATE ALL HANGER WIRE AS REQUIRED BY MANUFACTURER, CODES, SPECIFICATIONS, OR AS OTHERWISE INDICATED FOR FULL SUPPORT. PROVIDE HANGER WIRES AT EACH CORNER AND MIDPOINT ON LONG SIDES OF 2' x 4' LIGHT FIXTURES, MIDPOINT OF CROSS TEES AT CEILING MOUNTED GRILLES OR EQUIPMENT AND 4'-0" O.C. EACH DIRECTION. PROVIDE HANGERS WITHIN 6" EACH SIDE OF ALL SPLICES IN MAIN TEES.
 - ACOUSTICAL TILE SUPPORT - WHENEVER ITEMS SUCH AS SMOKE DETECTORS, SIGNAGE, SPEAKERS, ETC. ARE ATTACHED TO CEILING TILES, PROVIDE CROSS BRACE SUPPORT SECURED TO EACH SIDE OF ITEM. BRACE SHALL BE LOCATED TO PROVIDE FULL SUPPORT OF ITEM WITHOUT ANY SAG, BOW OR THIST OF CEILING OR GRID.

REFLECTED CEILING PLAN LEGEND

- FLUORESCENT 2' x 4' LAY-IN (SEE ELECTRICAL)
- FLUORESCENT 2' x 2' LAY-IN (SEE ELECTRICAL)
- LAY IN VINYL-COATED GYPSUM BOARD PANEL
- RECESSED "DOWNLIGHT" (SEE ELECTRICAL)
- CEILING HUNG PENDANT LIGHT (SEE ELECTRICAL)
- EXISTING LAY-IN CEILING, FIELD VERIFY (SHADED LINE)
- INDICATES GYPSUM BOARD SOFFIT OR CEILING @ INTERIOR
- INDICATES FIBER-CEMENT SOFFIT, TYPICAL @ EXTERIOR
- INDICATES EXISTING CEILING TO BE PATCHED
- WALL SCONCE (SEE ELECTRICAL)
- STRIP FLUORESCENT LIGHT (SEE ELECTRICAL)
- SUPPLY AIR DIFFUSER (SEE MECHANICAL)
- RETURN AIR GRILLE (SEE MECHANICAL)
- EXHAUST FAN OR RETURN AIR GRILLE (SEE MECHANICAL)
- CEILING MOUNTED EXIT LIGHT W/ DIRECTIONAL ARROW (SEE ELECTRICAL)
- CEILING MOUNTED SMOKE DETECTOR (SEE ELECTRICAL)
- TRACK LIGHT (SEE ELECTRICAL)
- FIRE-RATED WALL (# OF DASHES INDICATE WALL RATINGS)
- 24" x 24" (NOMINAL SIZE) ACCESS PANEL IN GYPSUM BOARD MEMBRANE ABOVE CEILING; ALIGN BETWEEN TRUSSES

UPPER FLOOR REFLECTED CEILING PLAN PART "B"

08-30-17 1904

ALABAMA

FIRST BAPTIST CHURCH CHILDREN'S ADDITION HAYDEN.

REVISED:

A151B

Corley Timothy Sweeney McCornac
 ARCHITECTS, INC.
 THREE RIVERCHASE OFFICE PLAZA / SUITE 124 / HOOVER, ALABAMA 35244
 T 205-443-3790 F 205-443-3790
 www.ctsmarchitects.com