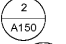
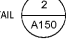

GENERAL NOTES

- SEE STRUCTURAL DRAWINGS FOR LOCATIONS AND SIZE OF STRUCTURAL ROOF REINFORCEMENTS.
- SEE MECHANICAL PLANS FOR ROOF TOP EQUIPMENT.
- COORDINATE ALL ROOF PENETRATIONS, FLASHING, AND REPAIR W/ CHIPOTLE CONSTRUCTION MANAGER PRIOR TO COMMENCEMENT OF WORK.
- DIMENSIONS FOR ROOF TOP EQUIPMENT WITH CURBS IS TO THE OUTSIDE FACE OF CURB. DIMENSIONS FOR EQUIPMENT WITHOUT CURBS ARE TO THE CENTER OF THE UNIT. ALL DIMENSIONS ARE FOR REFERENCE ONLY. ROOFING CONTRACTOR TO ADJUST AS NECESSARY IN FIELD. CONTACT ENGINEERING CONSULTANTS FOR ANY MAJOR MODIFICATIONS TO LAYOUT.
- IF LOCATION OR ORIENTATION OF A UNIT MUST CHANGE, NOTIFY ARCHITECT IMMEDIATELY.
- SEE M700 FOR PENETRATION DETAILS AT RTUS AND THE EXHAUST FAN.
- PROVIDE INSULATED CURBS FOR ALL EQUIPMENT IN EXPOSED DECK AREA ONLY.
- ALL UNUSED ROOFTOP EQUIPMENT TO BE REMOVED. PATCH ROOF AS NECESSARY.
- PROVIDE TAPERED INSULATED CRICKET AT ALL EQUIPMENT CURBS.
- LOCATE ALL UNITS SO DUCT DROPS BETWEEN TRUSS JOISTS. NOTIFY ARCHITECT IMMEDIATELY IF ANY UNITS NEED TO SHIFT FROM PLAN LOCATION SHOWN.

ROOF PLAN KEYNOTES

- EXIST. ROOFING TO REMAIN - DO NOT PENETRATE U.N.O.
- H.V.A.C. UNIT - REFER TO MECH. DWGS. - PROVIDE CURB PER DETAIL  A150
- GREASE EXHAUST FAN - REFER TO MECH. DWGS. - PROVIDE CURB SIM TO DETAIL  A150
- RESTROOM EXHAUST FAN - REFER TO MECH. DWGS. - PROVIDE CURB SIM. TO DETAIL  A150
- ICE MAKER CONDENSER - REFER TO MECH. DWGS. - INSTALL ON P.T. 4 X 4 SLEEPERS AS SHOWN. G.C. TO PROVIDE TIE DOWN STRAPS.
- WALK-IN COOLER CONDENSER - INSTALL ON P.T. 4X4 SLEEPERS AS SHOWN. G.C. TO PROVIDE TIE DOWN STRAPS.
- DUCT DROP(S) TO BE CONCEALED IN KITCHEN SOFFIT BELOW - V.L.F.
- DASHED LINES INDICATE EXIST. ROOF FRAMING CENTERLINES - V.L.F.
- DASHED LINE INDICATES LOCATION OF LEASE LINE - TYP.
- WALKWAY TUNNEL BY LANDLORD

NOTE:
ROOF ACCESS LADDER SHALL MEET ALL APPLICABLE O.S.H.A. & LOCAL CODE REQUIREMENTS

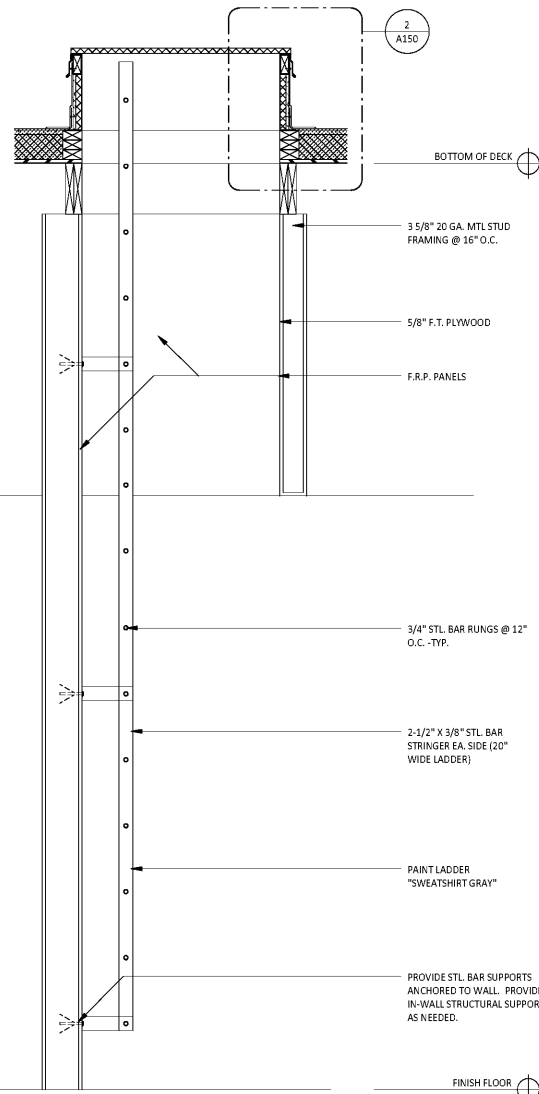

 **DETAIL @ ROOF ACCESS LADDER**
3/4" = 1'-0"

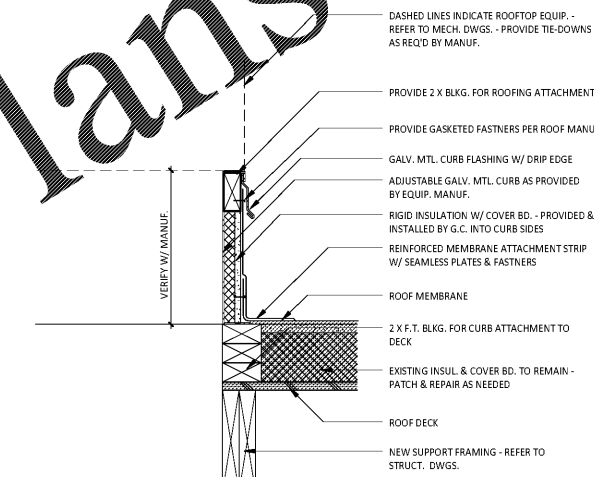

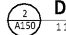
 **DETAIL @ CURB FLASHING**
1 1/2" = 1'-0"

NOTE:
PROVIDE CRICKETS OF BUILT-UP RIGID INSUL. @ ROOFTOP EQUIP. TO ENSURE POSITIVE DRAINAGE - TYP.

NOTE:
G.C. SHALL REVIEW RESPONSIBILITY MATRIX ON SHEET A001 PRIOR TO CONSTRUCTION

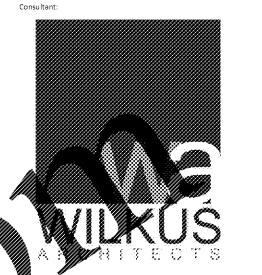
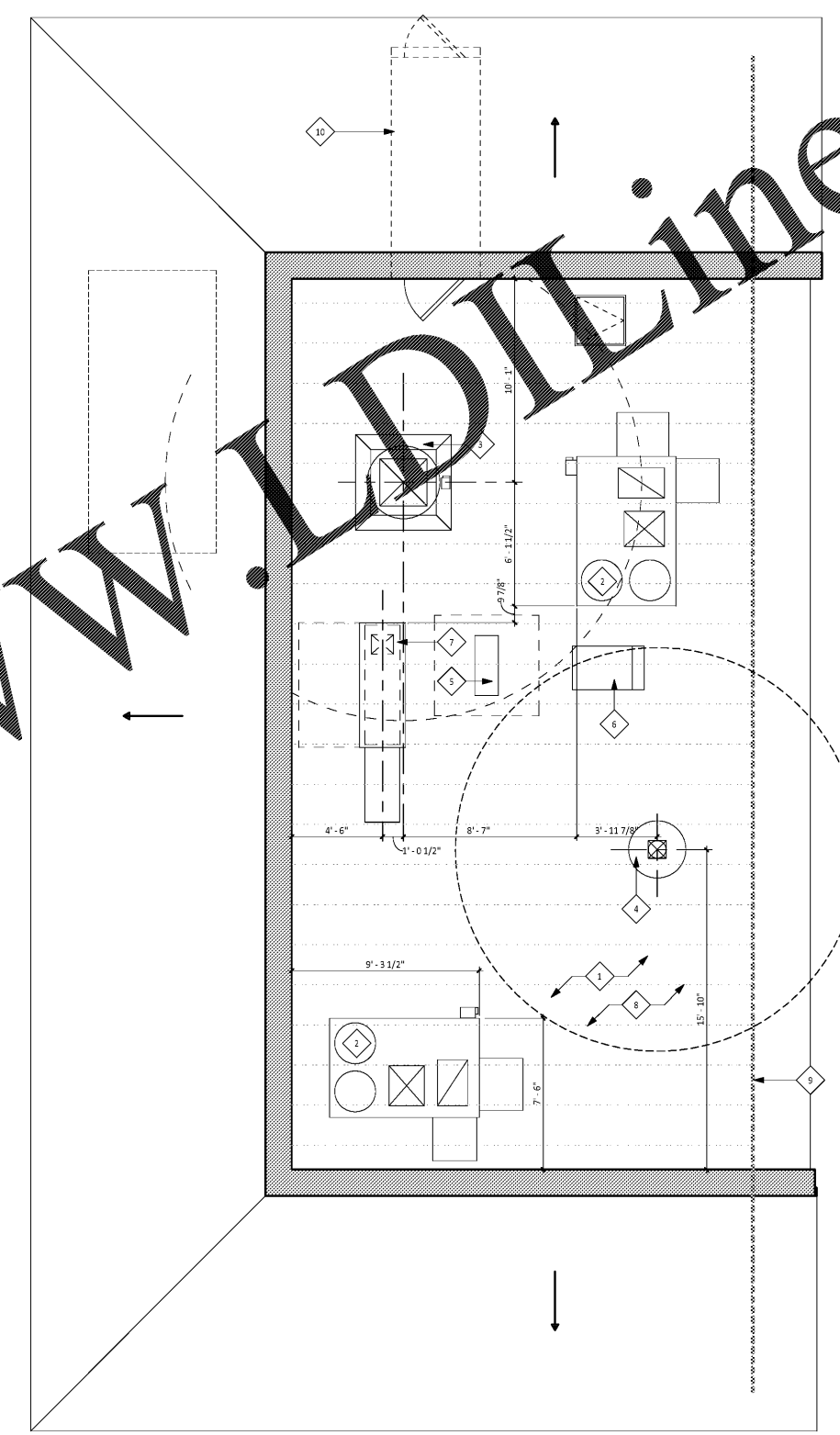

15 North Arroyo North, 1st Floor, SAN JOSE, CA 95128
Phone: 952.944.8965 www.wilkusarch.com

EXPIRES 12-31-17

SIGNATURE
30 August, 2017
DATE

COPYRIGHT 2017
THIS DRAWING IS AN INSTRUMENT OF SERVICE AND AS SUCH REMAINS THE PROPERTY OF CHIPOTLE MEXICAN GRILL, INC. PERMISSION FOR USE OF THIS DOCUMENT IS LIMITED AND CAN BE EXTENDED ONLY BY WRITTEN AGREEMENT WITH CHIPOTLE MEXICAN GRILL, INC.



STORE NO.: 3007
Purcellville

1200 Wolf Rock Drive, Suite 130
Purcellville, VA 20132

Date Received: 12-15-16 Permit Set

Revisions:
03-06-17 OWNER COMMENTS
08-23-17 CHIPOTLE COMMENTS

Drawn: D. Austin
Checked: M. Wilkus

Project No.: 2016-0424

Contents:
Architectural Roof Plan & Details

Order Plans @