

GENERAL NOTES

- ALL INTERIOR LIGHT FIXTURES AND LAMPS PROVIDED BY TENANT'S LIGHT/LAMP SUPPLIER.
- ALL INTERIOR LIGHT FIXTURES AND LAMPS INSTALLED BY GC. CAREFULLY REVIEW LIGHTING FIXTURE SCHEDULE ON SHEET E100.
- KITCHEN EXHAUST HOOD PROVIDED BY HS AND INSTALLED BY GC. GC TO COORDINATE PRESSURE TEST AND VIBRO GUARD WITH ENVIRONMENTAL, INC.
- ANSUL BOX & FIRE SUPPRESSION SYSTEM PROVIDED BY AND INSTALLED BY HS. HOOD INTERLOCK BY GC. ELECTRICAL CONNECTION BY GC, RE. ELEC.
- MENU BOARD ASSEMBLY PROVIDED BY TMB. INSTALLED BY G.C.
- PROVIDE BLOCKING ABOVE MENU BOARD ASSEMBLY FOR INSTALLATION.
- REFER TO "09900 PAINTING - GENERAL" IN SPECIFICATIONS FOR FINISHES AT EXPOSED CEILING AREAS IN ADDITION TO NOTES LISTED ON THIS SHEET AND A120
- UNISTRUT TO BE LEFT UNPAINTED. PROVIDE MATCHING CLOSER STRIPS AND END CAPS. CLOSER STRIP TO BE APPLIED TO THE UNDERSIDE OF THE UNISTRUT.
- ALL HEIGHTS ARE TO BOTTOM OF FIXTURE UNLESS NOTED OTHERWISE.
- LIGHT DETAILS ARE LOCATED ON SHEET A141. FIXTURE AND LAMP SPECIFICATIONS ARE LOCATED ON E100.
- ALL UNISTRUT SUPPORTING CEILING ELEMENTS AND/OR DUCT WORK SHALL NOT CONTAIN ANY ELECTRICAL CONDUIT. ALL ELECTRICAL CONDUIT MUST RUN IN SEPARATE UNISTRUT.
- ALL UNISTRUT, CONDUIT, SPRINKLER & WATER LINES SHALL BE INSTALLED TO THE BOTTOM OF THE DECK OR AS SHOWN IN DETAILS & LEFT UNPAINTED.
- ALL DIMENSIONS ARE TO FACE OF FRAMING, OR CENTERLINE OF FIXTURE UNLESS NOTED OTHERWISE.
- SEE ELECTRICAL DRAWINGS FOR SHATTER RESISTANT LAMP LOCATIONS.
- ALL EMERGENCY FIXTURES, LIGHTS AND STROBES SHALL BE ALIGNED OR CENTERED ON WALLS.
- FULL CERAMIC TILE COURSE SHALL TAKE PRECEDENCE OVER ANY CEILING/HEADER DIMENSION INDICATED IN THE PLAN, REFER TO A140.
- ALL CONDUIT AND PIPE PENETRATIONS OF THE SERVING LINE SOFFIT ARE TO BE HELD TIGHT TO THE DECK. PLEASE CONSULT WITH THE CHIPOTLE CM SHOULD ANY CONFLICTS ARISE.
- BATT INSULATION TO BE INSTALLED ABOVE THE RESTROOM CEILING.
- ALL LAY-IN CEILING PENETRATIONS TO BE HELD TIGHT TO WALLS. REFER TO PLUMBING DRAWINGS FOR DETAILS.
- REFER TO STRUCTURAL DRAWINGS FOR HOOD SUSPENSION DETAILS.
- ALL EXTERIOR BUILDING MOUNTED AND PATIO LIGHT FIXTURES AND LAMPS PROVIDED BY TENANT'S LIGHT/LAMP SUPPLIER, U.N.O.
- ALL EXTERIOR PARKING LOT LIGHT FIXTURES AND LAMPS PROVIDED BY AND INSTALLED BY G.C. CAREFULLY REVIEW LIGHTING FIXTURE SCHEDULE ON SHEET E100.
- ALL EXTERIOR BUILDING MOUNTED AND PATIO LIGHT FIXTURES AND LAMPS INSTALLED BY G.C. CAREFULLY REVIEW LIGHTING FIXTURE SCHEDULE ON SHEET E100.
- SECURITY CAMERA LOCATIONS ARE ONLY APPROXIMATE LOCATIONS. FOR GUIDANCE ON THE SPECIFIC LOCATION/ORIENTATION OF THESE CAMERAS, REFER TO A120 FOR FINISH SCHEDULE.
- REFER TO A120 FOR FINISH SCHEDULE.
- PROVIDE BLOCKING IN CEILING FOR CEILING MOUNTED PICK-UP SIGN, CENTER OVER LOW WALL, REFER TO A210

RCP SCHEDULE

ITEM #	DESCRIPTION	QTY	REMARKS
A1	2x2 LENSED TROFFER	9	SEE SHEET E100
B1	L.E.D. Recessed Canister Light	26	Refer to Elec. Dwg.
B2	RECESSED 6IN CAN LIGHT	8	SEE SHEET E100
C0	LOW PROFILE LED 1FT	2	SEE SHEET E100
C1	LOW PROFILE LED 2FT	4	SEE SHEET E100
C2	LOW PROFILE LED 3FT	11	SEE SHEET E100
C3	LOW PROFILE LED 4FT	7	SEE SHEET E100
C4	LOW PROFILE LED 5FT	12	SEE SHEET E100
C7	LED MENU CHANNEL LIGHT	2	SEE SHEET E100
E2	Exterior-Duty Remote Emergency Exit Light	3	Refer to Elec. Dwg.
H1	HOOD LIGHT	9	SEE SHEET E100

CONDUIT GUIDELINES

NO FLEXIBLE METALLIC CONDUIT IS ALLOWED IN ANY AREAS WHERE IT WOULD BE EXPOSED TO VIEW. ONLY RIGID METALLIC CONDUIT (THICK-WALL OR THIN-WALL AS NEEDED) IS ALLOWED IN THESE AREAS.

REFLECTED CEILING PLAN KEYNOTES

- LIGHTING FOR WALK-IN COOLER SHALL BE PROVIDED BY MANUF. & INSTALLED BY E.C.
- PROVIDE STAINLESS STL. CLOSURE BETWEEN PERIMETER OF HOOD & ADJACENT WALLS & CLGS.
- INDICATES SHELF-MOUNT TYPE 'C' FIXTURE
- SOFFIT FROM +/- 9'-0" A.F.F.; 5/8" GYP. BD. (PAINT "THIN ICE P3") OVER SUSPENDED MTL. STUD FRAMING SYSTEM - REFER TO SPEC.
- CLOSED-CIRCUIT SECURITY CAMERA - G.C. TO COORDINATE EXACT PLACEMENT W/ SECURITY SYSTEM INSTALLATION GUIDE PRIOR TO ROUGH-IN
- MENU BOARD SYSTEM - REFER TO DETAILS 2/A141, 3/A141, AND 4/A141
- NOT USED
- NOT USED
- AUDIO SYSTEM SPEAKER (6 THUS)
- PROVIDE MOUNTING ANGLE FOR TYPE 'C' FIXTURES @ CLG. - REFER TO 7/A141

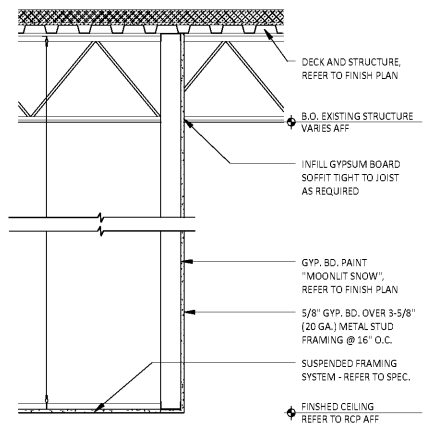

SECTION @ SOFFIT
A140 3/4" = 1'-0"

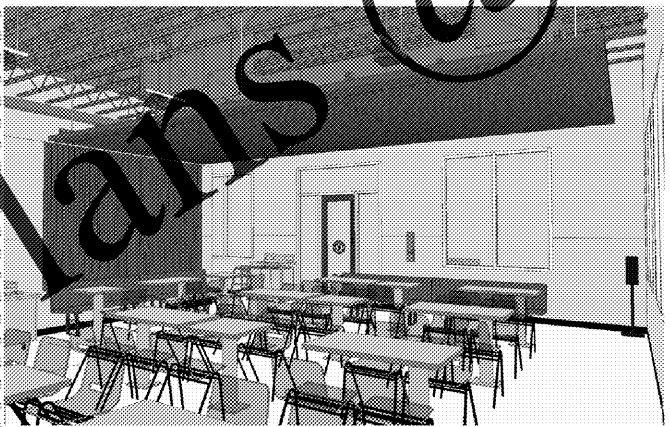

SLAT CEILING VIEW
A140

SECURITY SYSTEM

*REFER TO ELECTRICAL DRAWINGS FOR ADDITIONAL INFORMATION

DESCRIPTION	QTY	SUPPLIED BY	INSTALLED BY	UTILITIES			REMARKS
				ELEC	GAS	SEWER	
SECURITY MONITOR	1	SSS	SSS	•			GC RESPONSIBLE FOR COORDINATING SEQUENCING OF PREWIRING WITH COMPLETION OF INTERIOR FINISHES (GYP. BD. FINISHES)
SECURITY ALARM - MOTION DETECTORS	1	T.B.D.	T.B.D.	•			
72 HR SECURITY DVR	1	SSS	SSS	•			
Closed Circuit T.V. Camera - Indoor	5	SSS	SSS	•			

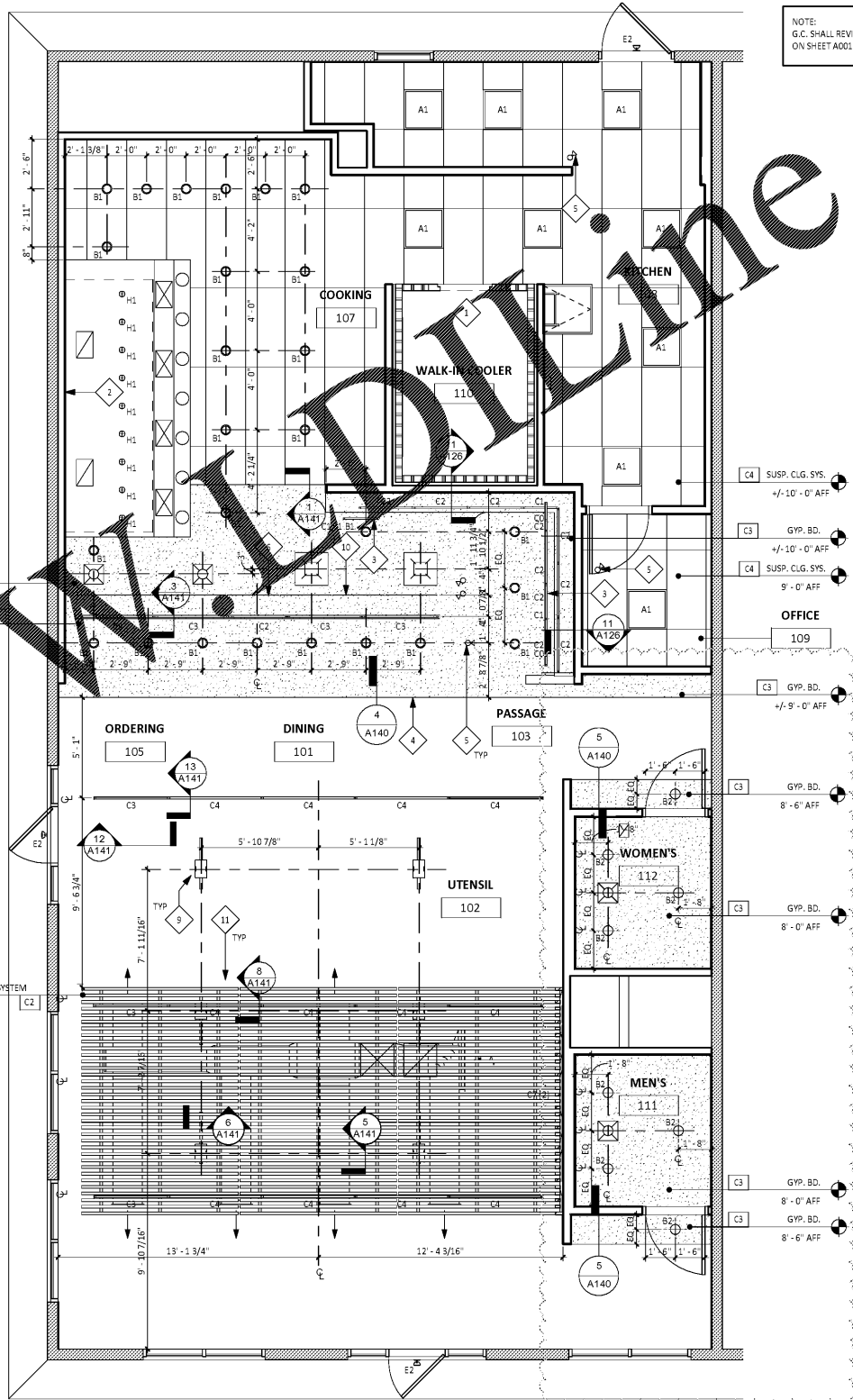

REFLECTED CEILING PLAN
A140 1/4" = 1'-0"



15. 18th Avenue North, 1st Floor, N.W. 53243
Phone: 952.944.1962 www.wilkusarch.com

EXPIRES 12-31-17
SIGNATURE
30 August, 2017
DATE

COPYRIGHT 2017
THIS DRAWING IS AN INSTRUMENT OF SERVICE AND AS SUCH REMAINS THE PROPERTY OF CHIPOTLE MEXICAN GRILL, INC. PERMISSION FOR USE OF THIS DOCUMENT IS LIMITED AND CAN BE EXTENDED ONLY BY WRITTEN AGREEMENT WITH CHIPOTLE MEXICAN GRILL, INC.



STORE NO.: 3007
Purcellville
1200 Wolf Rock Drive, Suite 130
Purcellville, VA 20132

Date Rec'd: 12-15-16 Permit Set

Revisions:
03-06-17 OWNER COMMENTS
08-23-17 CHIPOTLE COMMENTS

Drawn: D. Austin
Checked: M. Wilkus

Project No: 2016-0424

Contents:
Reflected Ceiling Plan

A140

