

- NOTES**
- BOUNDARY AND TOPOGRAPHIC INFORMATION PROVIDED BY STEADMAN AND ASSOCIATES, INC., IN DIGITAL FORMAT, SUPPLEMENTAL OFFSITE INFORMATION PROVIDED BY LEXINGTON COUNTY GIS.
 - ALL ELEVATIONS ARE BASED ON MSL DATUM.
 - THE CONTRACTOR SHALL CALL SC811, DIAL 811 FOR ALL UNDERGROUND UTILITIES LOCATIONS AT LEAST 72 HOURS PRIOR TO EXCAVATION. THE CONTRACTOR SHALL REPAIR ANY DAMAGE TO EXISTING UTILITIES OR STRUCTURES AT NO ADDITIONAL COST TO THE OWNER.
 - THE CONTRACTOR SHALL VERIFY ALL FIELD CONDITIONS PRIOR TO CONSTRUCTION AND NOTIFY THE ENGINEER IF ANY DIFFERING SITE CONDITIONS ARE NOTED.
 - ALL PAVING AND DRAINAGE WORK AND MATERIALS SHALL COMPLY WITH SCDOT STANDARD SPECIFICATIONS.
 - ALL DISTANCES INDICATED ARE TO FACE OF CURB, FACE OF BUILDING OR EDGE OF PAVEMENT UNLESS OTHERWISE NOTED.
 - ALL ANGLES ARE 90 DEGREE UNLESS OTHERWISE NOTED.
 - REFER TO ARCHITECTURAL DRAWINGS FOR BUILDING AND SURROUNDING AREA DIMENSIONS AND CONSTRUCTION.
 - ALL CURB AND GUTTER SHALL BE NORM. UNLESS OTHERWISE INDICATED.
 - ALL SIDEWALKS AND PAVEMENT MARKINGS SHALL BE ADA & M.U.T.C.O. COMPLIANT.
 - ALL TRAFFIC CONTROL MARKINGS ON SCDD RIGHT-OF-WAY SHALL BE THERMOPLASTIC.
 - REFER TO DETAILS ON SHEETS C6, C7 & C8.

- LEGEND**
- PROPOSED CURB AND GUTTER
 - PROPOSED ASPHALT PAVEMENT WITHIN DOT R/W
 - PROPOSED HEAVY-DUTY ASPHALT PAVEMENT
 - PROPOSED LIGHT-DUTY ASPHALT PAVEMENT
 - PROPOSED CONCRETE
 - PROPOSED CONCRETE PAVEMENT (COLORED BLACK AS DIRECTED BY OWNER)

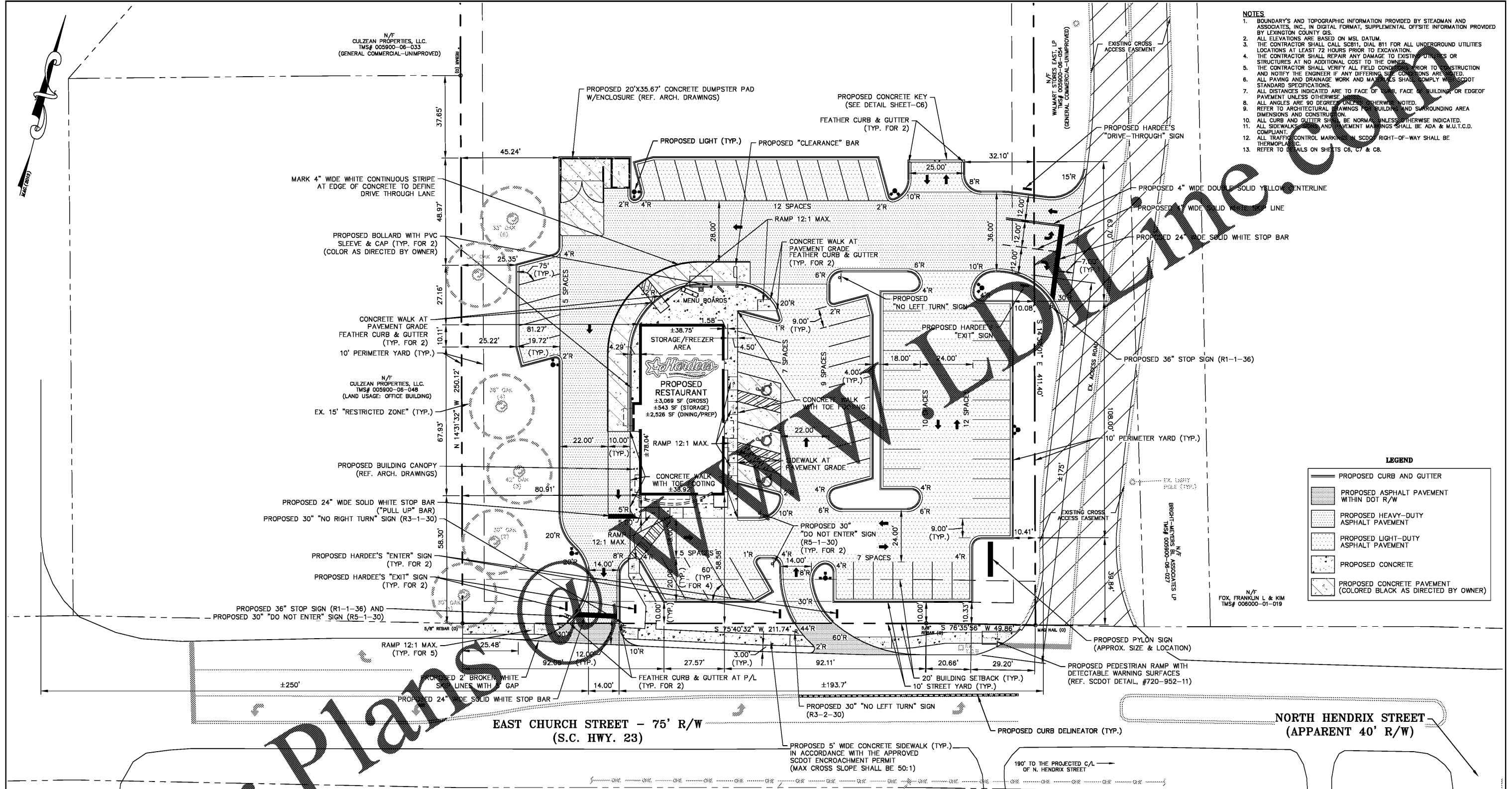

Order Plans

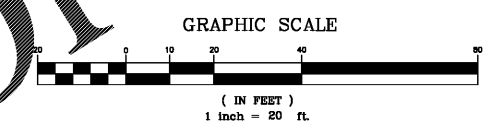

PARKING SUMMARY

MIN. PARKING SPACES REQ'D = 10 EMPL. @ 1 SPA./2 EMPL. ON GREATEST SHIFT = 5 SPACES
 MIN. PARKING SPACES REQ'D = 86 SEATS @ 1 SPACE/4 SEATS = 17 SPACES
 TOTAL MINIMUM PARKING SPACES REQ'D = 22 SPACES

STANDARD SPACES PROVIDED = 64 SPACES
 HANDICAPPED SPACES PROVIDED = 3 SPACES
 TOTAL SPACES PROVIDED = 67 SPACES

LOT SUMMARY

AREA = ±2.47 ACRES
 TMS# 005900-06-034
 ZONING = "C-1" (GENERAL COMMERCIAL)

DEVELOPER

MADHU SHRIVASTAVA
 SHIVA SHRI, LLC
 557 WHITEFORD WAY
 LEXINGTON, SC 29072
 PHONE: (803)348-7777
 FAX: (803) 356-2084

PROJECT No. 13078

HERITAGE ENGINEERING INC.

10719 WILSON BLVD. • P.O. BOX 923 • BLYTHEWOOD, S.C. 29016
 (803) 714-9632 OFFICE • (856) 787-9289 FAX

NO.	DATE	DESCRIPTION
3	3/6/2017	REV. DELINEATORS PER SCDOT
2	1/26/2017	ADD EDGE MARKING
1	12/22/2016	REV. PER OWNER & SCDOT

LAYOUT PLAN
PROPOSED HARDEE'S RESTAURANT

PREPARED FOR
SHIVA SHRI, LLC

IN THE TOWN OF BATESBURG-LEESVILLE, LEXINGTON COUNTY, SOUTH CAROLINA

DATE: OCT. 26, 2016 | SCALE: 1" = 20' | SHEET C2 OF 9