

This drawing is the property of J. E. STEWART ENGINEERING, INC. The design concepts and information contained herein are proprietary to this company and are submitted in confidence. They are not to be reproduced or used for any purpose for which the drawing is expressly issued. They are not transferable and must be used only for the purpose for which the drawing is expressly issued. They are not to be reproduced or otherwise used in any manner detrimental to the interest of J. E. STEWART ENGINEERING, INC.



DIABLOS

CITY OF AUGUSTA, GEORGIA

REV	DATE	DESCRIPTION	APP

ISSUE DATE: MAR 28, 2016
 DESIGNED BY: JES DRAWN BY: JES
 CHECKED BY: SUBMITTED BY: JES

STRUCTURAL

FOUNDATION
 PLAN

S101

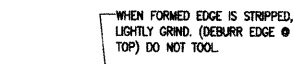

TYPICAL CONSTRUCTION JOINT

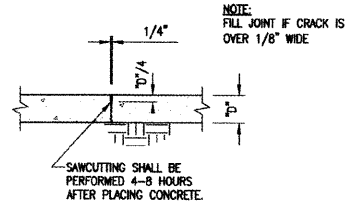

TYPICAL CONTROL JOINT "CJ"

1 DETAIL
 S101 Scale: NTS

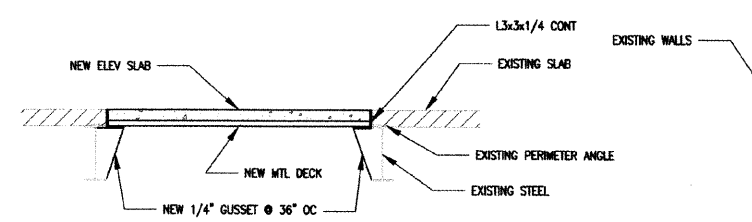

2 DETAIL
 S101 Scale: NTS

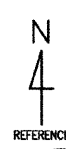
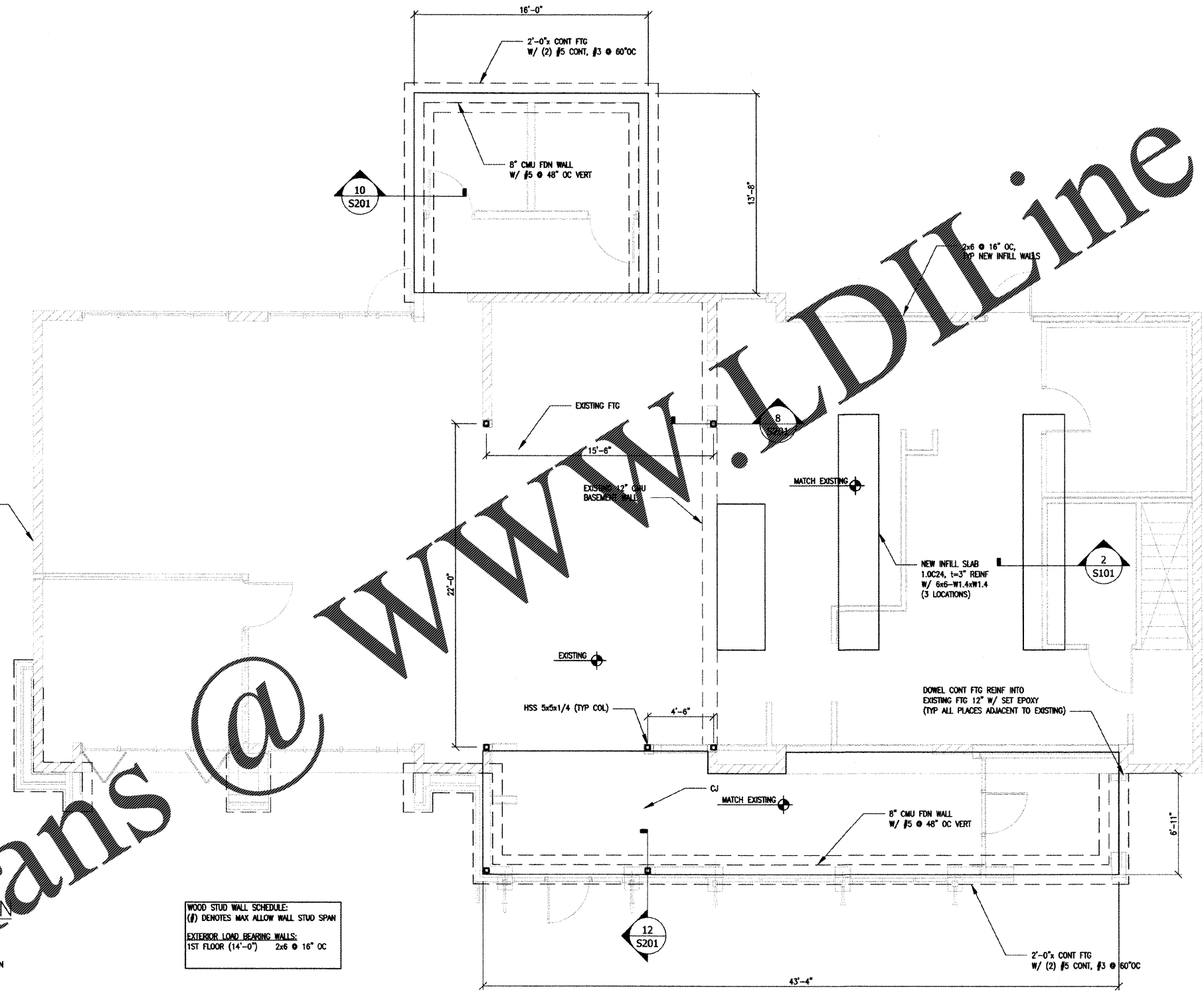

FOUNDATION PLAN

- 1/4" = 1'-0"
- FIN FLR EL = 0'-0" WITH (MATCH EXISTING)
- TOP OF CONCRETE SLAB ELEVATION
- TOP OF FOOTING ELEVATION = MATCH EXISTING
- PROVIDE (2) #4 48" @ MID-DEPTH OF SLAB AT ALL RE-ENTRANT CORNERS
- CONTRACTOR TO PROVIDE CONTROL AND CONSTRUCTION JOINTS AS NEEDED PER ACI RECOMMENDATIONS (REF CONCRETE NOTE 12 S100 FOR MIN REQUIREMENTS)
- VERIFY ALL DIMS WITH ARCH

WOOD STUD WALL SCHEDULE:

(#) DENOTES MAX ALLOW WALL STUD SPAN

EXTERIOR LOAD BEARING WALLS:

1ST FLOOR (14'-0") 2x6 @ 16" OC

PROPOSED BLDG SLAB CONSTRUCTION

4" CONCRETE SLAB REINFORCED WITH 6x6-W1.4xW1.4 FLAT SHEETS OVER VAPOR BARRIER AND COMPACTED STRUCTURAL FILL MATERIAL. REFERENCE GEOTECHNICAL REPORT FOR SUBGRADE PREPARATION AT BUILDING PAD

Order Plans @ WWW.LDLine.com