

Order Plans

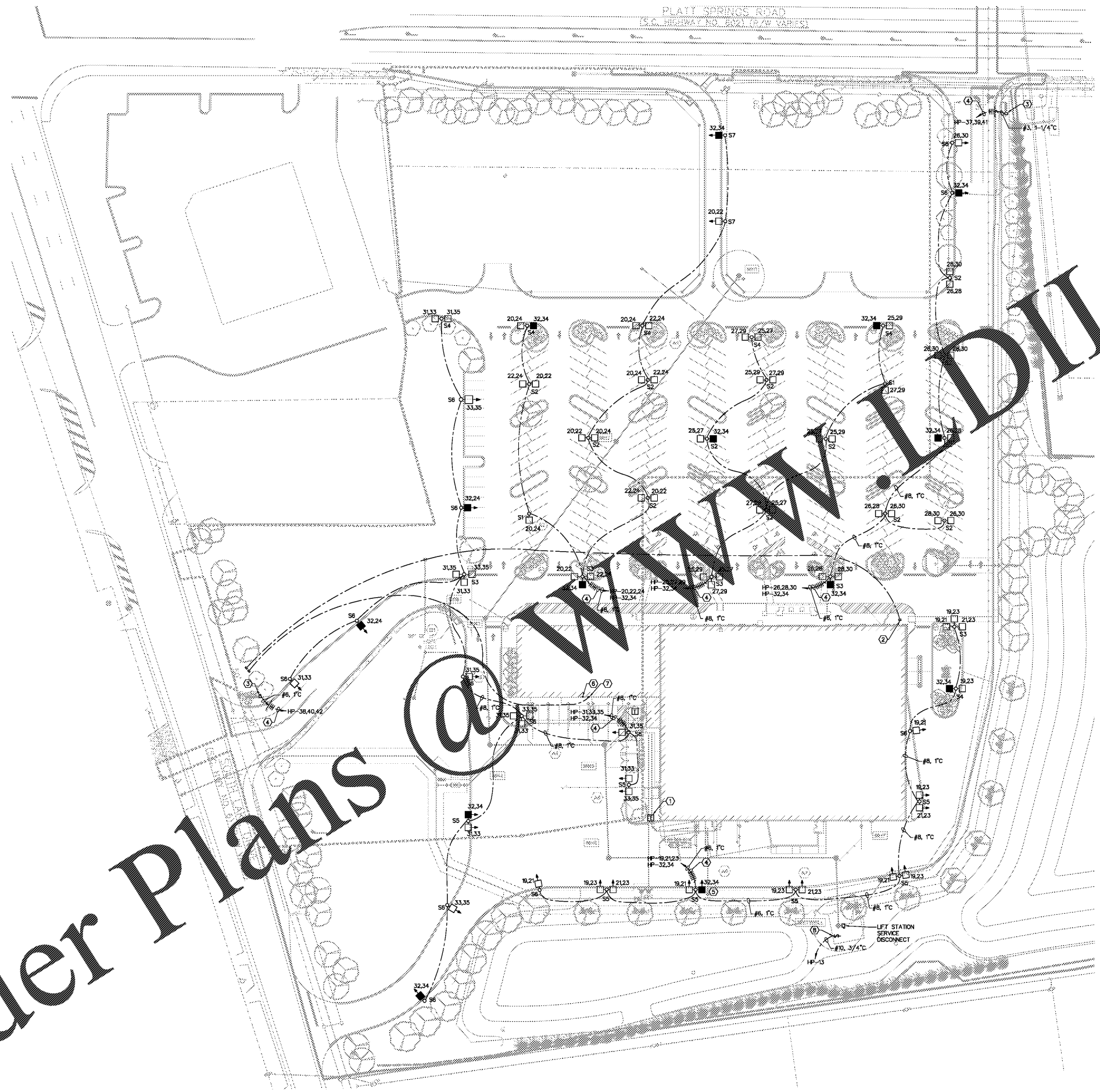

ELECTRICAL SITE PLAN
SCALE: 1" = 40'-0"

- NOTES**
- APPROXIMATE LOCATION OF UTILITY COMPANY PAD MOUNTED TRANSFORMER WITH 120/208 VOLT SECONDARY. EC SHALL COORDINATE CONCRETE PAD INSTALLATION WITH UTILITY COMPANY AND PUBlix INTERIOR CONTRACTOR.
 - APPROXIMATE LOCATION OF PVC FOR TELEPHONE. EC SHALL PROVIDE (2) 3" PVC CONDUITS WITH PULL STRINGS AND EXTEND TO EDGE OF PROPERTY AS SHOWN FOR TELEPHONE CONDUCTORS. EC SHALL EXTEND CONDUITS TO WITHIN 5' OF BUILDING IN LOCATION SHOWN AND COORDINATE CONNECTION TO TELEPHONE CONDUITS EXTENDED FROM PUBlix WITH INTERIOR CONTRACTOR. EC SHALL ALSO PROVIDE (1) 4" WITH PULL-STRING IN A SEPARATE TRENCH FROM FOR DATA.
 - APPROXIMATE LOCATION OF PYLON SIGN. PROVIDE 30/3/NF/NEMA 3R DISCONNECT AT SIGN FOR CIRCUITS SHOWN. ROUTE CONDUCTORS THRU LIGHTING CONTRACTOR. COORDINATE EXACT LOCATION WITH SIGN CONTRACTOR PRIOR TO ROUGH-IN.
 - ROUTE CIRCUITS VIA LIGHTING CONTRACTOR.
 - APPROXIMATE LOCATION OF DOUBLE DETECTOR CHECK VALVE. PROVIDE TAMPER SWITCH AND FIRE ALARM CONDUCTORS IN 3/4" TO PUBlix SPRINKLER MONITORING PANEL.
 - APPROXIMATE LOCATION OF PANEL 'HP'.
 - APPROXIMATE LOCATION OF PVC FOR TELEPHONE. EC SHALL PROVIDE (2) 4" PVC CONDUITS WITH PULL STRINGS AND EXTEND TO EDGE OF PROPERTY AS SHOWN FOR TELEPHONE CONDUCTORS.
 - PROVIDE SURFACE MOUNTED VAPOR TIGHT LED STRIP LIGHT (LITHONIA #DMW2 124 4000LM ACL MD MOUNT 40K BOCR OR EQUIVALENT) MOUNTED ON LIFT STATION STRUCTURE. PROVIDE FIXTURE WITH PHOTOCCELL CONTROL.
- GENERAL NOTE**
- ALL SITE LIGHTING CONDUCTORS SHALL BE #10 AWG IN 3/4" UON

1925 Prospect Ave.
Orlando, FL 32814
P (407) 661-9100
F (407) 661-9101
www.cpe.com

Colwell & Rest
Architects Engineers

CLIENT NAME
WindCrest Companies
605 E. Robinson Street, Suite 340
Orlando, Florida 32801

PROJECT NAME
Publix/Retail @ Lake Crossing
South Lake Drive & Platt Springs Road
Levington, South Carolina

REVISIONS

No.	Description	Date
A	100% Public Submission	03/17/17
B	100% Public	05/17/17
A	ISSUED FOR BUILDING PERMIT	08/10/17

DATE 03/17/17
DRAWN SW
CHECKED CS

PROJECT NO. 210102
DATE 03/17/17
DRAWN SW
CHECKED CS

Job Number: 51207
Colwill Engineering
Consulting Engineers, Inc.
Engineering Business No. CO 2007-PE
3750 East Adams Drive, Tampa, Florida 33606
Tel: 813-841-9988 Fax: 813-841-8484
© 2017 ALL RIGHTS RESERVED

ES100

ELECTRICAL SITE PLAN

WWW.DILine.com