

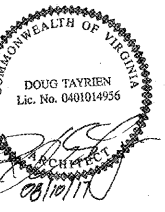

NEW FCAC STORE  
 2015 - JUNE - ER - RIGHT  
 1900 RICHMOND ROAD  
 WILLIAMSBURG, VA



ISSUE BLOCK	

PROPERTY NO.: 167739  
 6 DIGIT NO.: 785533  
 4 DIGIT NO.: 6868  
 AOR PROJECT NUMBER: 1655814  
 TO PERMIT: DATE: 08/10/17  
 TO BID: DATE: TBD  
 DRAWN BY: JD  
 CHECKED BY: MGC

SHEET TITLE:  
**REFLECTED  
 CEILING & FLOOR  
 FINISH PLAN**

SHEET NUMBER:  
**A2**

FLOOR FINISH KEY	
NOTE:	SUPPLIED AND INSTALLED BY GENERAL CONTRACTOR, UNLESS OTHERWISE NOTED.
PC:	POLISHED CONCRETE, REFER TO SPECIFICATION
SC:	SEALED CONCRETE, REFER TO SPECIFICATION
RB:	RESILIENT BASE: 6" WALL BASE (BLACK)
CPT:	CARPET TILE - 19.7" x 19.7" (BUFFALO) POLISHED CONCRETE TO EXTEND UNDER CARPET TILE TOTAL: 23.2 SQUARE YARDS (BSRO FURNISHED AND INSTALLED BY CONTRACTOR)
FLOOR FINISH NOTES	
1.	POSITION CARPET IN BLOWROOM SO THAT FULL TILES OCCUR AT TRANSITIONS AND PARTIAL TILES OCCUR ALONG THE WALL.
2.	SAFETY STRIPES FROM TILE WORKPOINT.

REFLECTED CEILING PLAN NOTES:  
 1. LOCATE LIGHT FIXTURES CENTERED IN THE ROOM OR OVER DOOR AS APPLIES, UNLESS DIMENSIONS NOTE OTHERWISE.  
 2. SEE MECHANICAL AND ELECTRICAL SHEETS FOR SYMBOL SPECIFICATION.

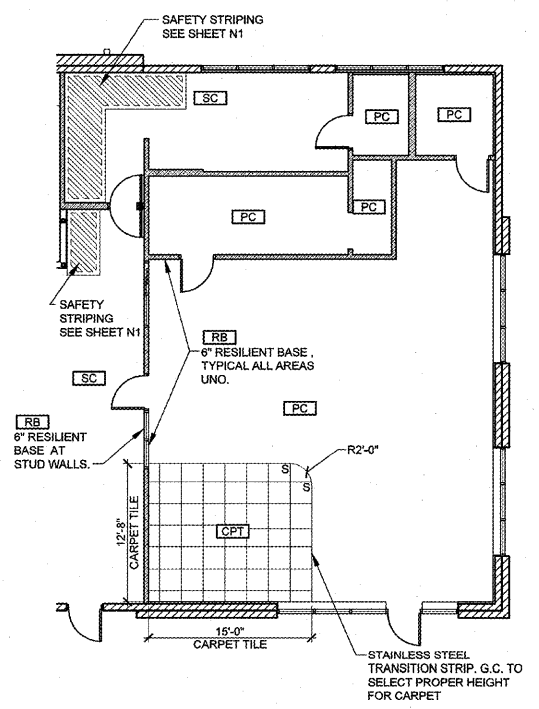
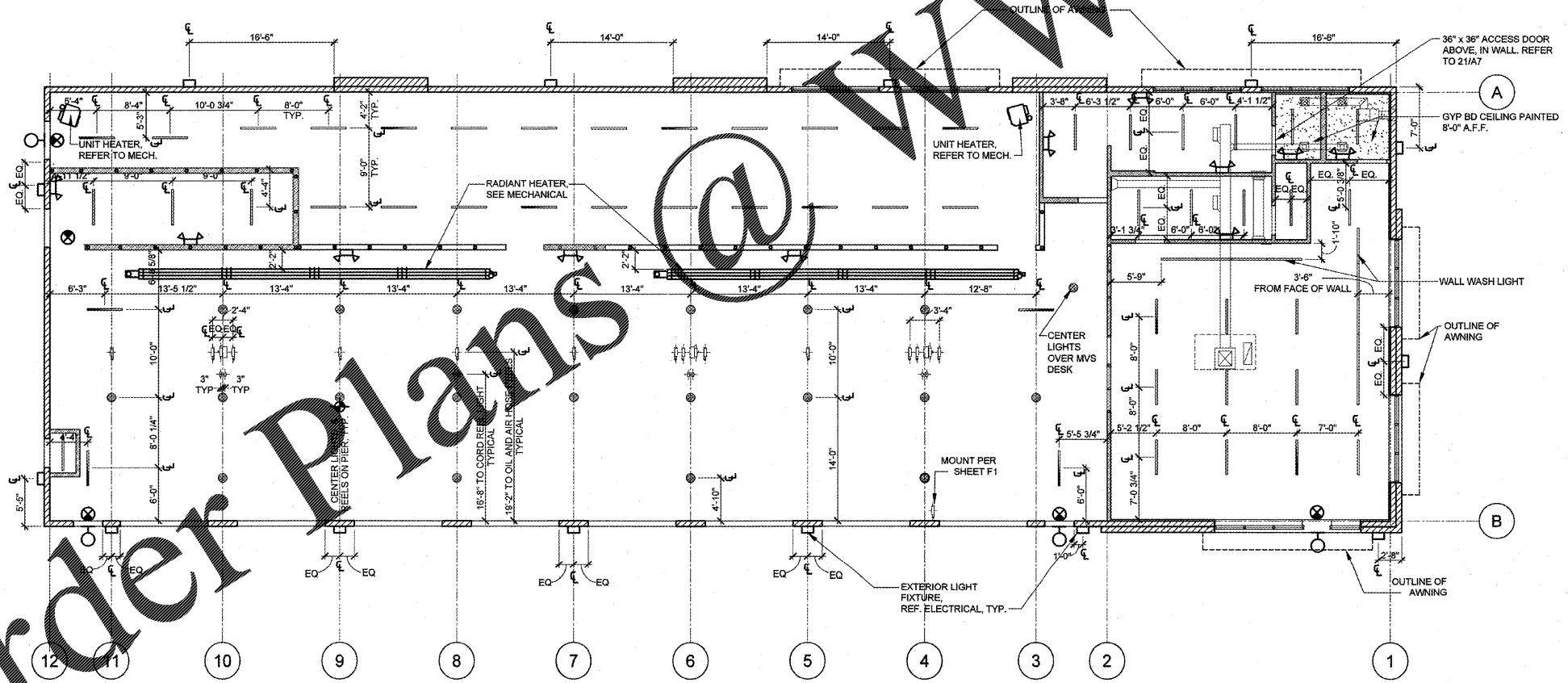

**16 REFLECTED CEILING PLAN**  
 SCALE: 1/8"=1'-0"

**20 FLOOR FINISH PLAN**  
 SCALE: 1/8"=1'-0"

Aug 03 2017 - 6:28am - USER: jstf16  
 P:\B560\Projects\Williamsburg\2015 - JUNE - ER - RIGHT\Drawings\06\_FCAC\_ER-A02.dwg

Order Plans @ WWW.LDILINO.COM