

NRD
 ARCHITECTS & ENGINEERS
 SUITE 300 AUTUMN WOODS BLVD. SUITE 300
 WARRISVILLE, NORTH CAROLINA 27578
 PH. 813.544.7231 FAX 813.544.4328
 A Division of LMHT Associates

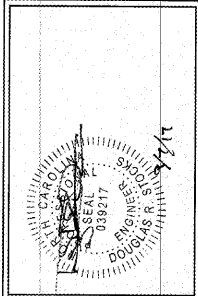

Hardee's
 HARDEE'S REVERSE PROTOTYPE
 BURLINGTON, NC 28605

OWNER: **BN**
 BODDIE-NOELL ENTERPRISES, INC.
 P.O. BOX 1908
 ROCKY MOUNT, N.C. 27802-1908
 (252) 937-2800

NO.	REVISIONS	DATE

ELECTRICAL
 SITE
 LIGHTING
 PLAN

DATE: 6-23-17

SHEET NUMBER:
E5

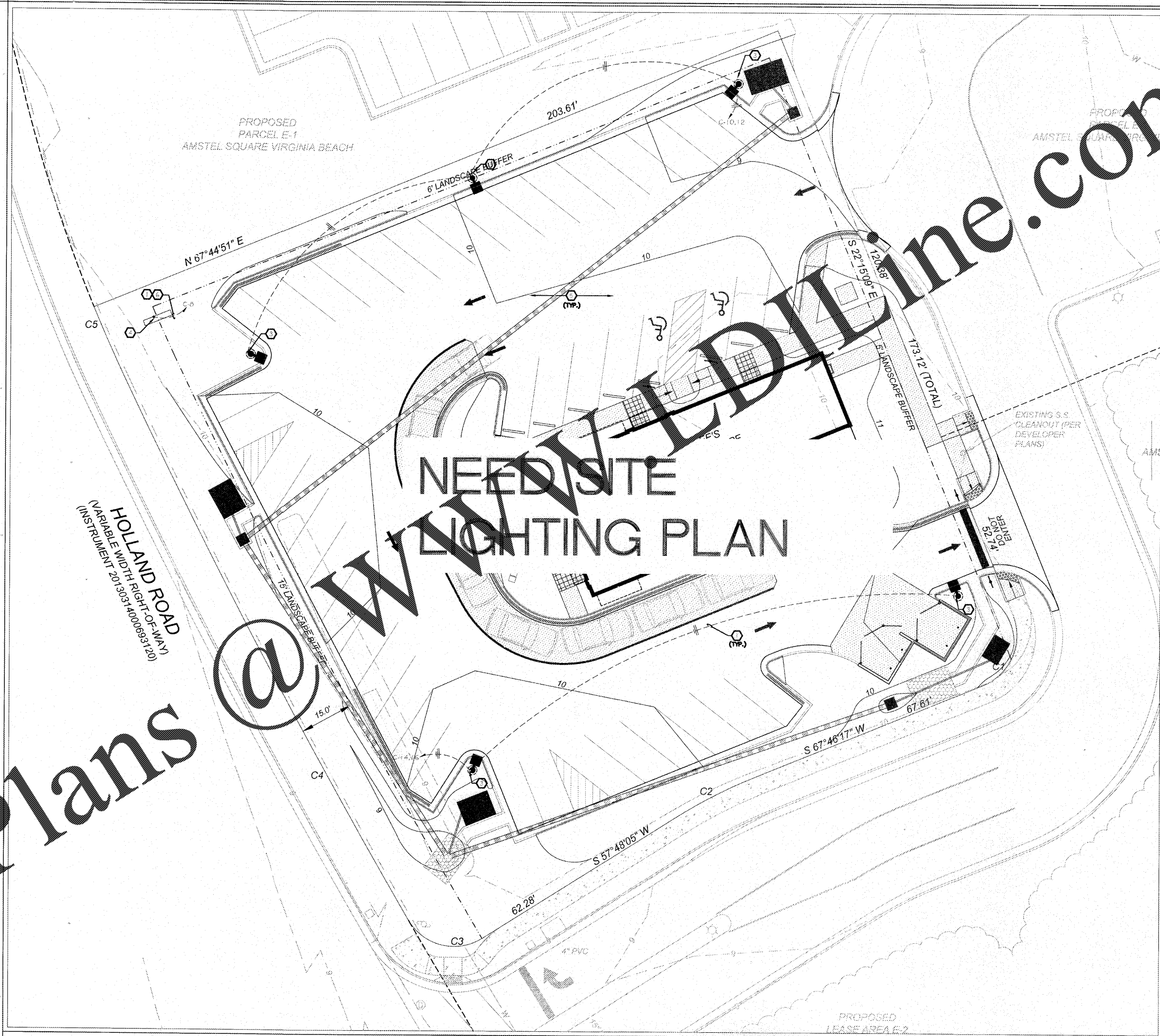

NOTE: SEE SHEETS CPI-1.0 THRU CPI-2.3 FOR CPI INFORMATION RELATED TO WIRING OF CONTROLS & ENERGY MANAGEMENT.

SITE LIGHTING CODED NOTE

- 1) ELECTRICAL CONTRACTOR SHALL PROVIDE ALL TRENCHING AND BACKFILL AS REQUIRED TO BURY ALL SITE LIGHTING AND SIGN CIRCUITS. RUN #8 CONDUCTORS IN 1" PVC CONDUIT AT A MIN. DEPTH OF 24" BELOW GRADE WITH ELECTRICAL WARNING TAPE 6" ABOVE CONDUIT.
- 2) FOR ADDITIONAL DRIVE THRU INFORMATION, REF. SHT. A-8.1.
- 3) POLE BASE FOR SITE LOT LIGHT, SEE DETAIL ON SHEET A-8.1.
- 4) POLE SIGN, CONSULT OWNER FOR VERIFICATION OF ELECTRICAL REQUIREMENTS.
- 5) SEE SHEET C-10 FOR PHOTO METRIC STUDY OF THIS PROPERTY & LOT LIGHT FIXTURE SELECTIONS.
- 6) #8, 1" (MINIMUM)

NOTE:
 1) THIS SITE DRAWING IS FOR CONSTRUCTION PURPOSES ONLY. REFER TO CIVIL DRAWINGS FOR FINAL SIGN AND MENU BOARD LOCATIONS, SITE LIGHTING LAYOUT AND LIGHTING PHOTOMETRICS.
 2) SEE CIVIL DRAWING FOR EXACT LOCATION OF YARD LIGHTS AND PRIME SIGNS. REFER TO PANEL SCHEDULES AND CIRCUITS. E.C. SHALL VERIFY SIGNAGE IS 3% OF SIGN AREA. E.C. SHALL CONFIRM THAT TRENCHES ARE DEPT. AS SHOWN ON SHEET. E.C. SHALL CONFIRM THAT TRENCHES ARE DEPT. AS SHOWN ON SHEET. E.C. SHALL CONFIRM THAT TRENCHES ARE DEPT. AS SHOWN ON SHEET. E.C. SHALL CONFIRM THAT TRENCHES ARE DEPT. AS SHOWN ON SHEET.

SITE LIGHTING PLAN

SCALE: 1"=20'-0" 1

Order Plans @ www.edline.com