

Order Plans

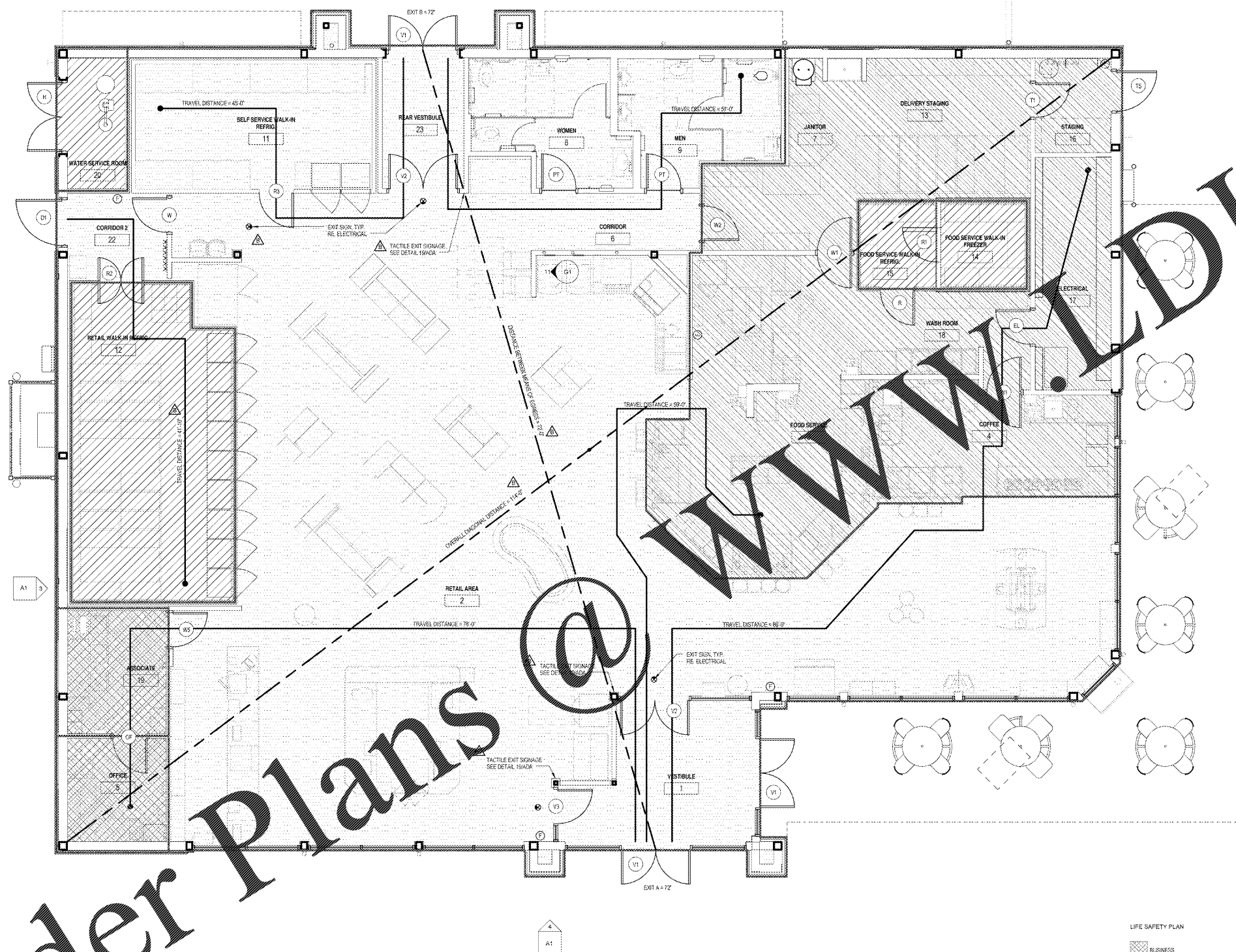

1 T.O. FLOOR SLAB
1/8" = 1'-0"

- LIFE SAFETY PLAN
- BUSINESS
 - MERCANTILE
 - MERCANTILE (KITCHEN)
 - STORAGE

EGRESS DATA - NEW MERCANTILE, UNSPRINKLERED
OCCUPANCY LOAD = 142

EGRESS CAPACITY

- MINIMUM EGRESS CAPACITY (IFC 1005.5.2)
REQUIRED = 98' (142 PERSONS @ 0.2 PERSON/FT)
PROVIDED = 144' (EXIT A = 72' , EXIT B = 72')

ARRANGEMENT OF EXITS

- SEPARATION DISTANCE: AT LEAST TWO EXITS SHALL HAVE A MINIMUM SEPARATION NOT LESS THAN ONE-HALF OF THE OVERALL LENGTH OF THE SPACE (IFC 1015.2.1)
OVERALL DIAGONAL DISTANCE = 114'-0"
MINIMUM REQUIRED DISTANCE BETWEEN MEANS OF EGRESS = 114'-0" / 2 = 57'-0"
DISTANCE BETWEEN MEANS OF EGRESS = 72'-0"

TRAVEL DISTANCES

- MAXIMUM TRAVEL DISTANCE REQUIRED FOR OCCUPANCY M
UNSPRINKLERED = 150 FEET (IFC 907.2.2.1)
ACTUAL MAXIMUM TRAVEL DISTANCE = 99'-0"

EMERGENCY SIGNALING AND LIGHTING

- REFER TO SHEET E2 FOR EMERGENCY LIGHTING AND EXIT SIGN LOCATION
- EXIT LIGHTS ARE TO BE MOUNTED AT THE GREATEST HEIGHT ALLOWABLE AND IN COMPLIANCE WITH CODES. EXIT LIGHTS LEADING FROM THE SALES FLOOR SHALL BE VISIBLE ABOVE STOCK AISLES.

FINISH CLASSIFICATIONS

- CLASS A FINISHES AT EXIT ENCLOSURES & EXIT PASSAGEWAYS (FLAME SPREAD 0-25 SMOKE DEVELOPMENT 0-450)
- CLASS R FINISHES AT CORRIDORS (FLAME SPREAD 26-75 SMOKE DEVELOPMENT 0-450)
- CLASS C FINISHES AT ROOMS AND ENCLOSED SPACES (FLAME SPREAD 76-200 SMOKE DEVELOPMENT 0-450)

OCCUPANCY LOAD CALCULATIONS				
OCCUPANCY TYPE	OCC. GROUP	AREA	OCC. / SF	OCCUPANT LOAD
BUSINESS	GROUP B	208 SF	100	21
MERCANTILE	GROUP M	934 SF	30	131
MERCANTILE (KITCHEN)	GROUP M	148 SF	200	30
STORAGE	GROUP S	522 SF	300	157
		8112 SF		142

NOTE

EXTERIOR OVERHANG AREA & OCCUPANCY LOAD SHALL BE AS SHOWN ON SHEET O5. AREA COMPLIES WITH IBC 510.4.1 (2014) CHAPTER 3, SECTION 303.2. SMALL ASSEMBLY SPACES, ITEM (1) AND (6) CLASSIFIED AS PART OF THE MERCANTILE OCCUPANCY.

CLIENT NAME
WAWA
280 WEST BALTIMORE PIKE
WAWA, PENNSYLVANIA 19063

PROJECT NAME
WAWA F85FB 2017.01 STORE #5254-OKE
OREGONCHOBEE RD & JENKINS RD
FT. PIERCE, FLORIDA

SHEET TITLE
LIFE SAFETY PLAN

Revision	Number	Description	Date
1	01	PRELIMINARY	07/26/2017
2	02	REVISED	07/26/2017
3	03	REVISED	07/26/2017
4	04	REVISED	07/26/2017
5	05	REVISED	07/26/2017
6	06	REVISED	07/26/2017
7	07	REVISED	07/26/2017
8	08	REVISED	07/26/2017
9	09	REVISED	07/26/2017
10	10	REVISED	07/26/2017
11	11	REVISED	07/26/2017
12	12	REVISED	07/26/2017
13	13	REVISED	07/26/2017
14	14	REVISED	07/26/2017
15	15	REVISED	07/26/2017
16	16	REVISED	07/26/2017
17	17	REVISED	07/26/2017
18	18	REVISED	07/26/2017
19	19	REVISED	07/26/2017
20	20	REVISED	07/26/2017