

**D** TANKFIELD REINFORCING DETAIL  
G-1 SCALE: 1/4" = 1'-0"

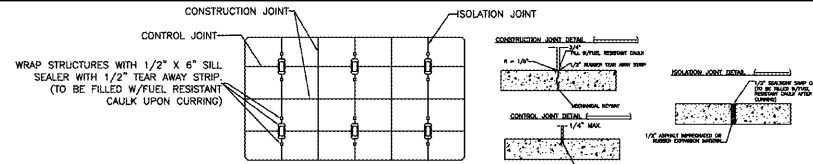

**C** TYPICAL CANOPY JOINT DETAIL  
G-1 SCALE: NTS

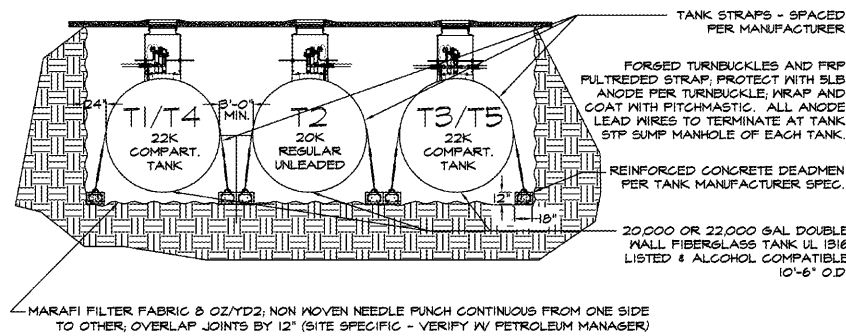

**B** TANK BURIAL  
G-1 SCALE: 1/8" = 1'-0"

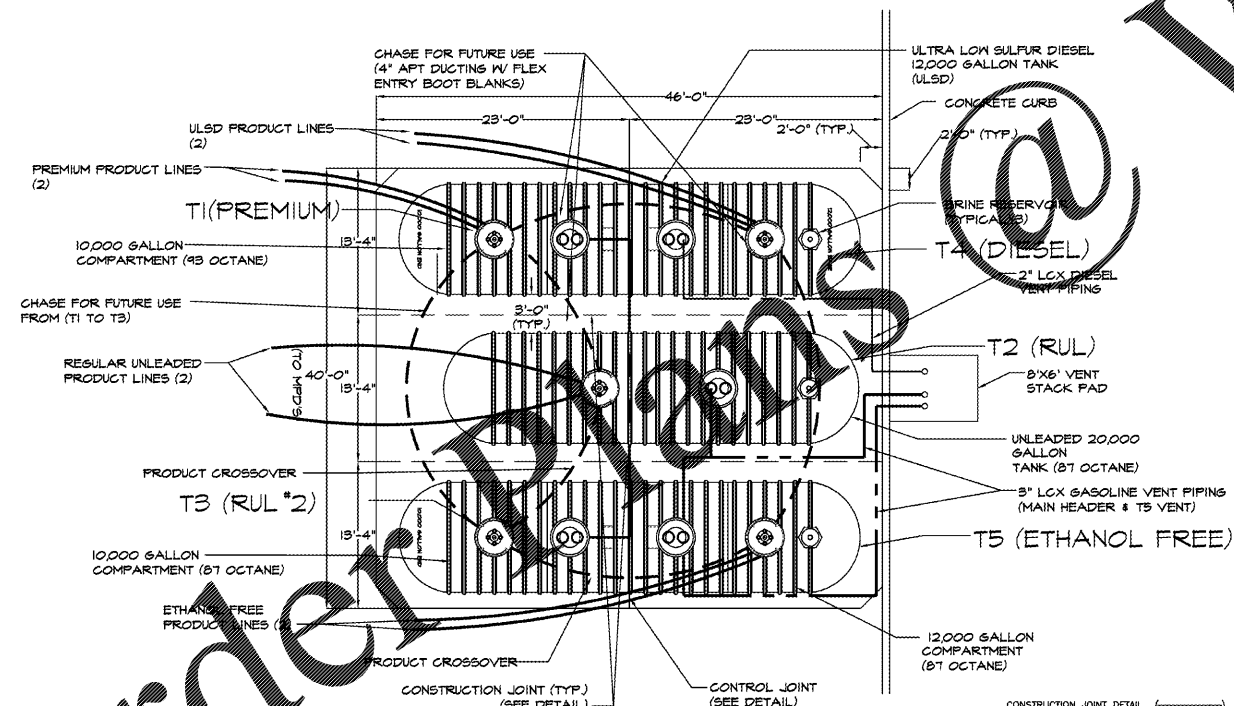

**A** TANK FIELD LAYOUT  
G-1 SCALE: 1/8" = 1'-0"

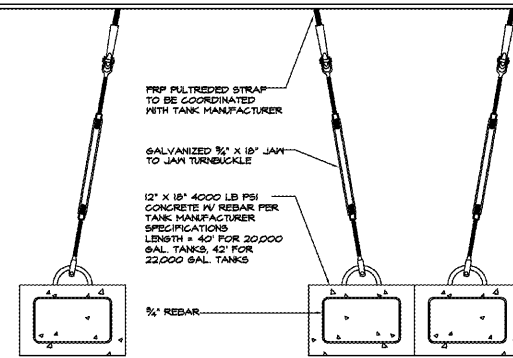

**E** TANK HOLD DOWN DETAIL  
G-1 SCALE: 1" = 1'-0"

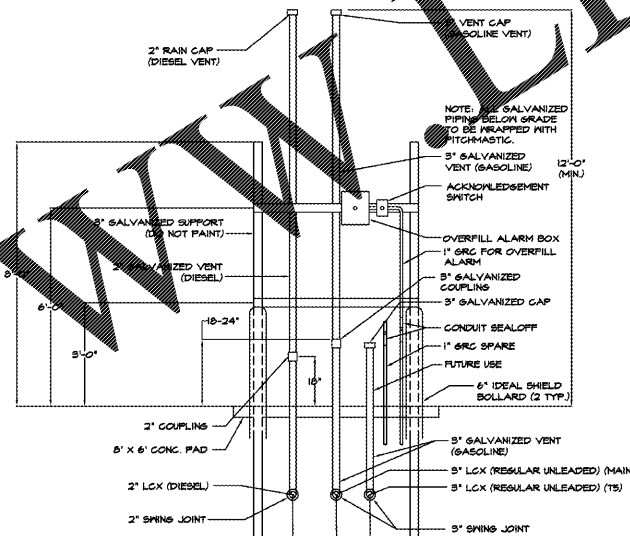

**F** VENT STACK  
G-1 SCALE: 3/8" = 1'-0"

XERXES® a xcel company		DEADMAN BURIAL WATER AT GRADE		Wawa	
TANK DATA		INSTALLATION		JWL	
NUM. CAP. (GAL.)	22000 (12 x 106)	TOTAL COVER INCLUDING SOIL & TOP SLAB (FT)	4.50	JWL	10/31/14
TYPE (SINGLE WALL = 1, DW = 2)	2	TOP SLAB THICKNESS (IN)	8.00		
DRY-1, WET-2	2	TOP SLAB LENGTH (FT)	40.00		
NOM. TANK DIA. (FT)	10	TOP SLAB WIDTH (FT)	13.00		
PROD. STORED (GAL.)	0	DEADMAN LSG (FT)	18.00		
SPEC. GRAV. USED	1.00	DEADMAN WID (IN)	12.00		
BRINE FILL (GAL.)	224	DEADMAN THK (IN)	12		
SAFETY FACTOR		# OF 42" DIAMETER SUMPS		2	
DOWN FORCE/UP FORCE =	1.47 : 1				
TOTAL WEIGHTS					
CONCRETE WEIGHT	47070.22 LBS				
BACKFILL WEIGHT	237121.83 LBS				
TANK WEIGHT	11500.00 LBS				
PRODUCT WEIGHT	0.00 LBS				
TOTAL DOWN FORCE	295692.05 LBS				
UP FORCES					
TANK DISP. FORCE	200517.43 LBS				
TOTAL UP FORCE	200517.43 LBS				
WORKSHEET					
TANK DATA					
SHELL DIAMETER	10.00 FT.	ACTUAL CAP (GAL.)	22176.60		
SHELL LENGTH	31.90 FT.	TANK WT. (LBS.)	11500.00		
DOME HEIGHT	5.00 FT.	DIA. (FT.)	41.90		
MID POINT HEIGHT	8.83 FT.	NUMBER OF RIBS	25.00		
COLUMN HEIGHT	13.83 FT.	DOME A. (SQ FT)	78.54		
RIB VOLUME	2631.00 CU. IN.	DOME VOL. (CU FT)	523.60		
REINFORCED CONCRETE VOLUMES (CU. FT.)					
TOP SLAB	408.89	DEADMAN	126.00		
FORCE = VOL. X 88 LBS/CF	35982.22	FORCE (LBS) = VOL. X 88 LBS/CF	11088.00		
TOP SLAB & DEADMAN FORCE		47070.22 LBS.			
BACKFILL VOLUMES (CU. FT.)					
OVER TANK SHELL	1417.39	OVER DEADMAN	1743.00		
OVER TANK DOMES	431.97	END WEDGE	359.67		
TOTAL WET VOLUME	3952.36				
FORCE = VOL. X 66 LBS/CF		237121.83 LBS.			
BUOYANCY					
SHELL VOLUME	2652.62 CUBIC FT.				
DOME VOLUME	523.60 CUBIC FT.				
RIB VOLUME	23.98 CUBIC FT.				
TOTAL VOLUME	3200.20 CUBIC FT.				
VOL. X 7.48 GAL/CU. FT.	24042.86 GALLONS				
FORCE = GAL. X 8.34 (LBS./GAL.)		200517.43 LBS.			

XERXES® a xcel company		DEADMAN BURIAL WATER AT GRADE		WAWA	
TANK DATA		INSTALLATION		JWL	
NUM. CAP. (GAL.)	20000	TOTAL COVER INCLUDING SOIL & TOP SLAB (FT)	4.50	JWL	11/16/11
TYPE (SINGLE WALL = 1, DW = 2)	2	TOP SLAB THICKNESS (IN)	8.00		
DRY-1, WET-2	2	TOP SLAB LENGTH (FT)	40.00		
NOM. TANK DIA. (FT)	10	TOP SLAB WIDTH (FT)	13.00		
PROD. STORED (GAL.)	0	DEADMAN LSG (FT)	18.00		
SPEC. GRAV. USED	1.00	DEADMAN WID (IN)	12.00		
BRINE FILL (GAL.)	194	DEADMAN THK (IN)	12		
SAFETY FACTOR		# OF 42" DIAMETER SUMPS		2	
DOWN FORCE/UP FORCE =	1.57 : 1				
TOTAL WEIGHTS					
CONCRETE WEIGHT	41966.67 LBS				
BACKFILL WEIGHT	224301.09 LBS				
TANK WEIGHT	8900.00 LBS				
PRODUCT WEIGHT	0.00 LBS				
TOTAL DOWN FORCE	274267.76 LBS				
UP FORCES					
TANK DISP. FORCE	175216.07 LBS				
TOTAL UP FORCE	175216.07 LBS				
WORKSHEET					
TANK DATA					
SHELL DIAMETER	10.00 FT.	ACTUAL CAP (GAL.)	19782.00		
SHELL LENGTH	27.73 FT.	TANK WT. (LBS.)	8900.00		
DOME HEIGHT	5.00 FT.	DIA. (FT.)	37.73		
MID POINT HEIGHT	8.83 FT.	NUMBER OF RIBS	22.00		
COLUMN HEIGHT	13.83 FT.	DOME A. (SQ FT)	78.54		
RIB VOLUME	2631.00 CU. IN.	DOME VOL. (CU FT)	523.60		
REINFORCED CONCRETE VOLUMES (CU. FT.)					
TOP SLAB	346.07	DEADMAN	120.00		
FORCE = VOL. X 88 LBS/CF	30566.67	FORCE (LBS) = VOL. X 88 LBS/CF	10560.00		
TOP SLAB & DEADMAN FORCE		41086.67 LBS.			
BACKFILL VOLUMES (CU. FT.)					
OVER TANK SHELL	1286.73	OVER DEADMAN	1660.00		
OVER TANK DOMES	431.97	END WEDGE	359.67		
TOTAL WET VOLUME	3738.36				
FORCE = VOL. X 60 LBS/CF		224301.09 LBS.			
BUOYANCY					
SHELL VOLUME	2251.61 CUBIC FT.				
DOME VOLUME	523.60 CUBIC FT.				
RIB VOLUME	23.98 CUBIC FT.				
TOTAL VOLUME	2809.19 CUBIC FT.				
VOL. X 7.48 GAL/CU. FT.	21009.12 GALLONS				
FORCE = GAL. X 8.34 (LBS./GAL.)		175216.07 LBS.			

**G** BUOYANCY CALCULATIONS  
G-1 SCALE: N.T.S.

**Order Now**

NOTES:  
1. TANK(S) SHALL BE UNDERWRITERS LABORATORY LISTED (UL-1316) AS CALLED FOR ON THE SITE SPECIFIC DRAWINGS OR AS DESIGNATED ON THE SUPPLEMENTAL CONDITIONS AND SHALL BE DOUBLE WALL TANKS OF FIBERGLASS REINFORCED PLASTIC (FRP) AS MANUFACTURED BY "XERXES CORPORATION". INSTALLATION OF TANKS & PIPING SHALL BE IN ACCORDANCE W/ THE LATEST EDITION OF THE INSTALLATION SPECIFICATION AS PROVIDED BY WAWA, INC. & MANUFACTURER'S INSTRUCTIONS.  
2. PRIOR TO TESTING, PETROLEUM CONTRACTOR SHALL VERIFY TIGHTNESS OF MANWAY BOLTS. VERIFY BOLTS TO BE SET PER MANUFACTURER TORQUE SETTINGS & ADJUST AS REQ. (TYP.)

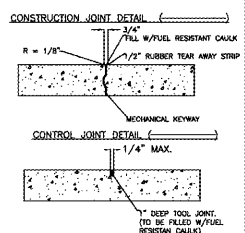

**stillwater TECHNOLOGIES**  
203 Hillcrest Street  
Orlando, Florida 32801  
(407) 206-7222  
(407) 206-7223 fax  
FL. Cert. of Auth. #8326  
STILLWATER PROJECT #464-108

FREDERICK A. BLECKMAN  
LICENSE  
No. 50701  
STATE OF FLORIDA  
PROFESSIONAL ENGINEER  
Date

**GASOLINE DETAILS**  
5575 OKEECHOBEE ROAD  
FT. PIERCE, ST. LUCIE COUNTY, FL  
(22,000 GAL. COMPARTMENTALIZED TANKS)

**Wawa**  
260 WEST BALTIMORE PIKE  
WAWA, PA 19063  
PHONE: 610-398-8000 FAX: 610-398-8965

SCALE: AS NOTED DATE: 4/01/14 DRAWN BY: DCV CHECKED BY: REK

ISSUE FOR PERMIT REVISION  
1. 11/10/16  
DATE

DATE: 4/01/14  
DRAWN BY: DCV  
CHECKED BY: REK

DRAWING NO. G-1  
SHEET NO. 2 OF 6