

LOCATION SKETCH

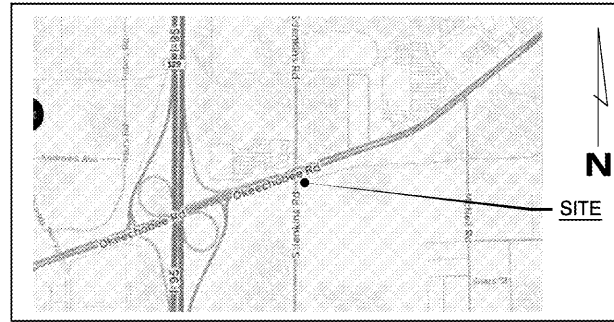

VICINITY SKETCH

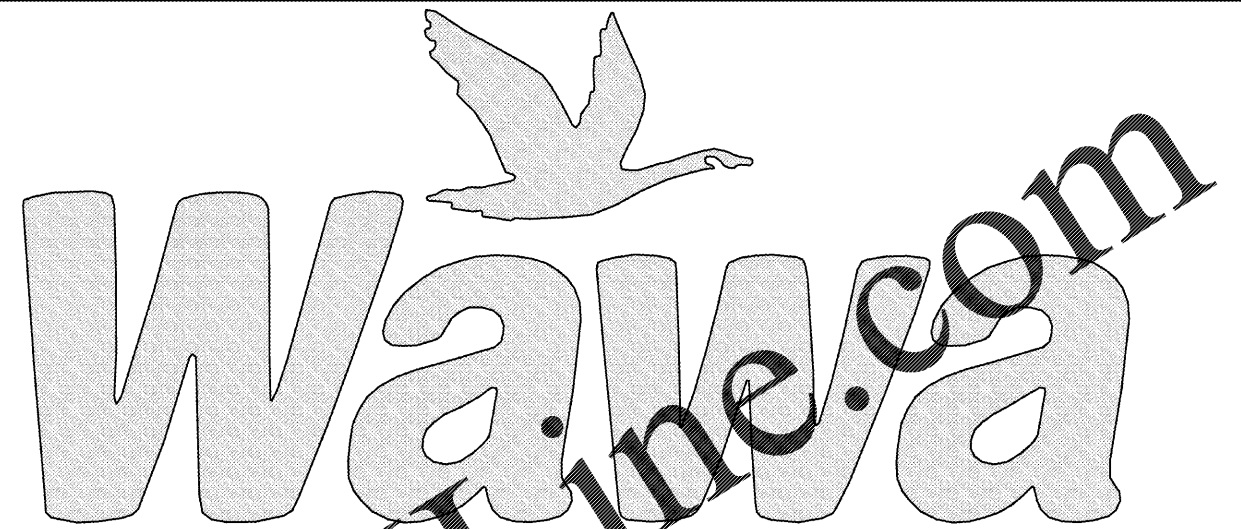

PETROLEUM STORAGE AND DISTRIBUTION SYSTEM CONSTRUCTION PLANS

5575 Okeechobee Road
Ft. Pierce, FL

APPLICANT:
WAWA, INC
7699 GOLF CHANNEL DR.
ORLANDO, FL 32819
(407) 408-6177
CONTACT: Scott Kearney, P.E.
EMAIL: scott.kearney@wawa.com

PETROLEUM ENGINEER:
STILLWATER TECHNOLOGIES, INC.
203 HILLCREST STREET
ORLANDO, FL 32801
(407) 206-7222; FAX (407) 206-7223
CONTACT: Rick Blecha, P.E.
EMAIL: rblecha@stillwatertech.com

- CODE REFERENCES:**
- NFPA 30 (2012) - FLAMMABLE & COMBUSTIBLE LIQUIDS
 - NFPA 30A (2012) - MOTOR FUEL DISPENSING FACILITIES
 - PE/VP 100-11 - RECOMMENDED PRACTICES FOR INSTALLATION OF UNDERGROUND LIQUID STORAGE SYSTEMS
 - N.E.C. 2011
 - FLORIDA BUILDING CODE (FBC) 2014 5th Edition
 - FLORIDA FIRE PREVENTION CODE (5th Edition)

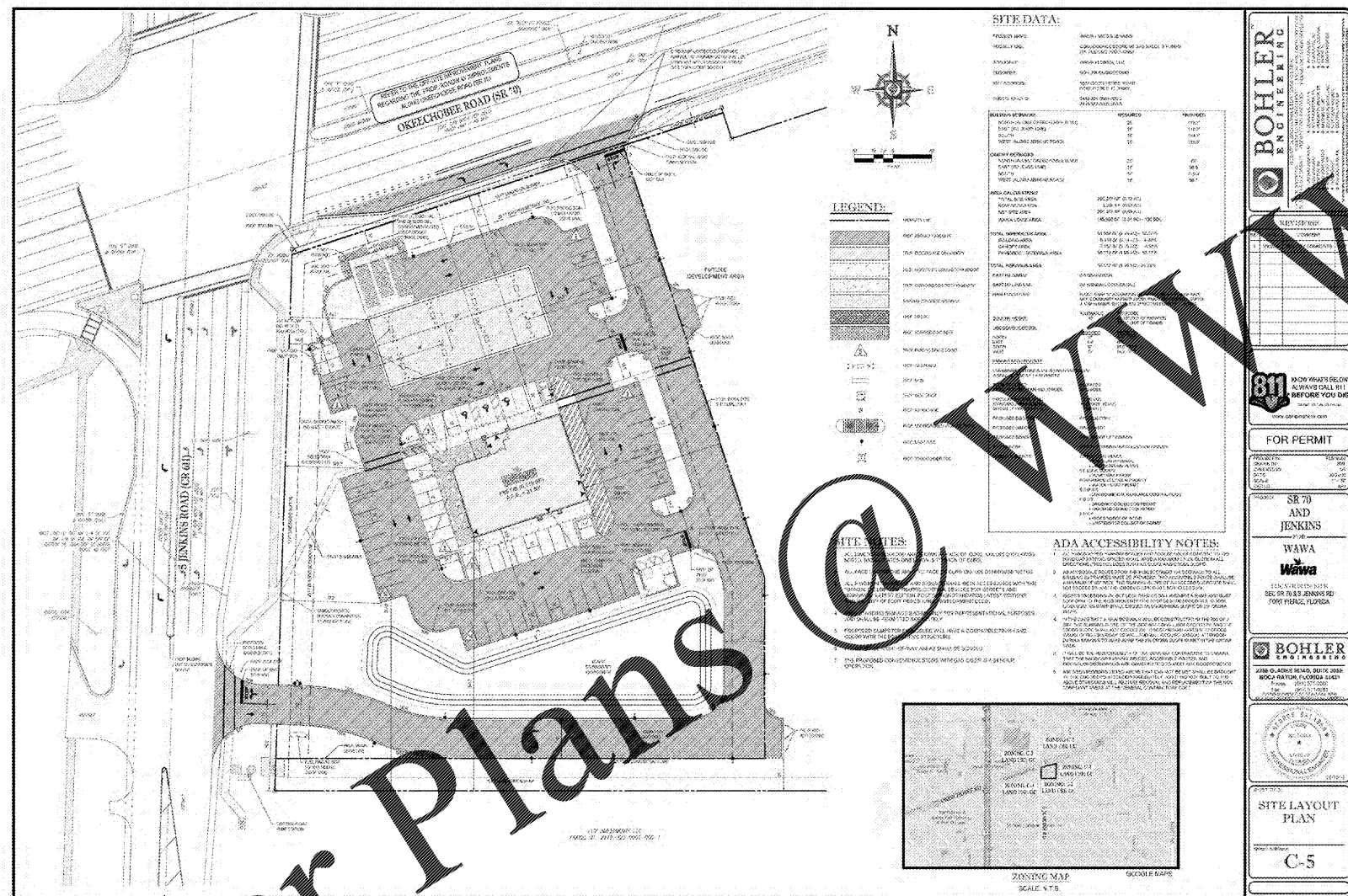

CIVIL SITE PLAN
N.T.S.
(FOR REFERENCE ONLY)

PARCEL ID: 419-322-000-000-5
ADDRESS: 5575 OKEECHOBEE DR.
FT. PIERCE, FL
LEGAL DESCRIPTION: REFERENCE CIVIL PLANS BY BOHLER ENGINEERING

PETROLEUM DRAWING INDEX

DRAWING NO.	DESCRIPTION	DATE	REV. DATE	REV. DATE	REV. DATE
6-0	COVER SHEET (22,000 GAL. COMPARTMENTALIZED TANKS)	4/01/14	11/10/16		
6-1	TANK DETAILS (22,000 GAL. COMPARTMENTALIZED TANKS)	4/01/14	11/10/16		
6-2	TANK DETAILS (22,000 GAL. COMPARTMENTALIZED TANKS)	4/01/14	11/10/16		
6-3	GAS/DIESEL DISPENSER DETAILS (STACK B)	4/01/14	11/10/16		
6-4	GAS/DIESEL SUMP DETAILS	4/01/14	11/10/16		
6-5	GENERAL NOTES & LEGEND (22,000 GAL. COMPARTMENTALIZED TANKS)	4/01/14	11/11/16		

stillwater TECHNOLOGIES
203 Hillcrest Street
Orlando, Florida 32801
(407) 206-7222
(407) 206-7223 fax
FL. Cert. of Auth. #8326
STILLWATER PROJECT #464-108

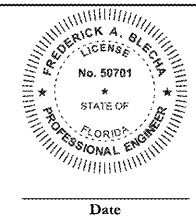

COVER SHEET
5575 OKEECHOBEE ROAD
FT. PIERCE, ST. LUCIE COUNTY, FL
(22,000 GAL. COMPARTMENTALIZED TANKS)

SCALE	DATE	DRAWN BY	CHECKED BY
AS NOTED	04/01/14	DCV	REK

Wawa
260 WEST BALTIMORE PIKE
WAWA, PA 19063
PHONE: 610-358-8000
FAX: 610-358-6868

DRAWING NO. G-0
1 OF 6 SHEET NO.

J:\64 Wawa Inc\464-108 Wawa Pet. Distribution & Retail\Civil Plans\464-108-C5_Cover.dwg