

DEMOLITION PLAN / EROSION CONTROL PLAN

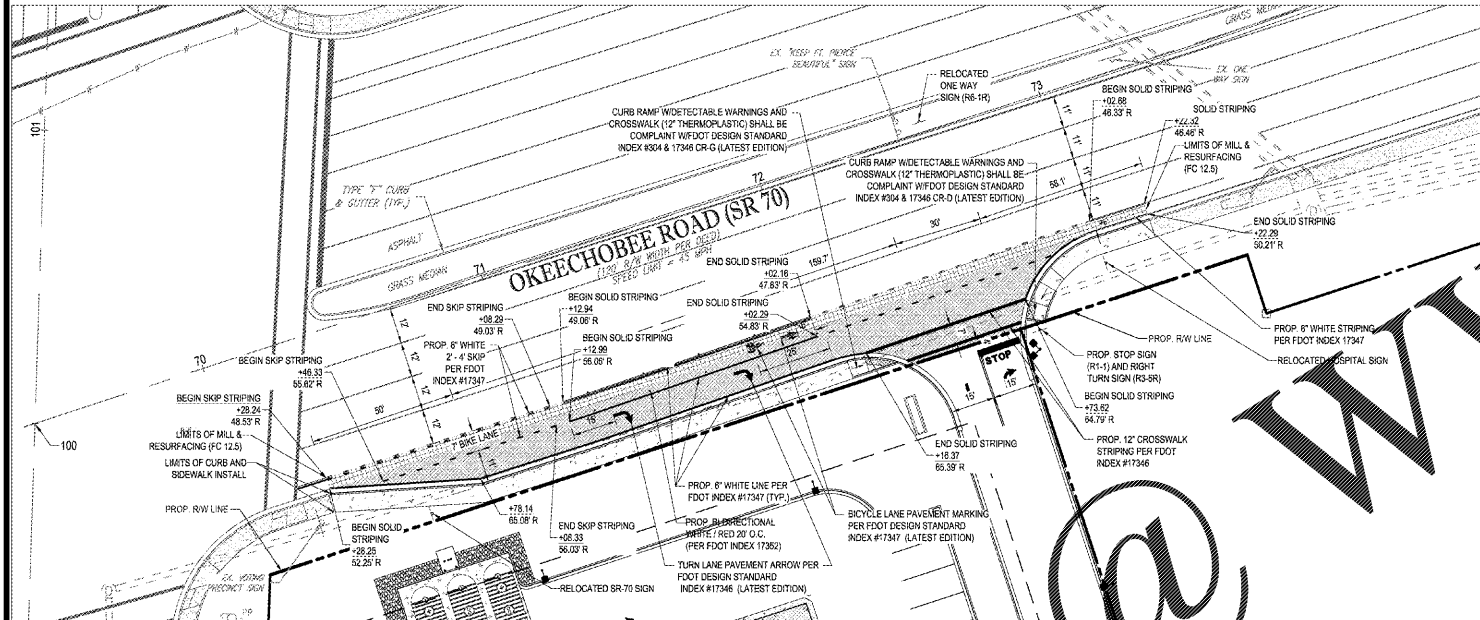

PAVEMENT MARKING AND SIGNAGE PLAN

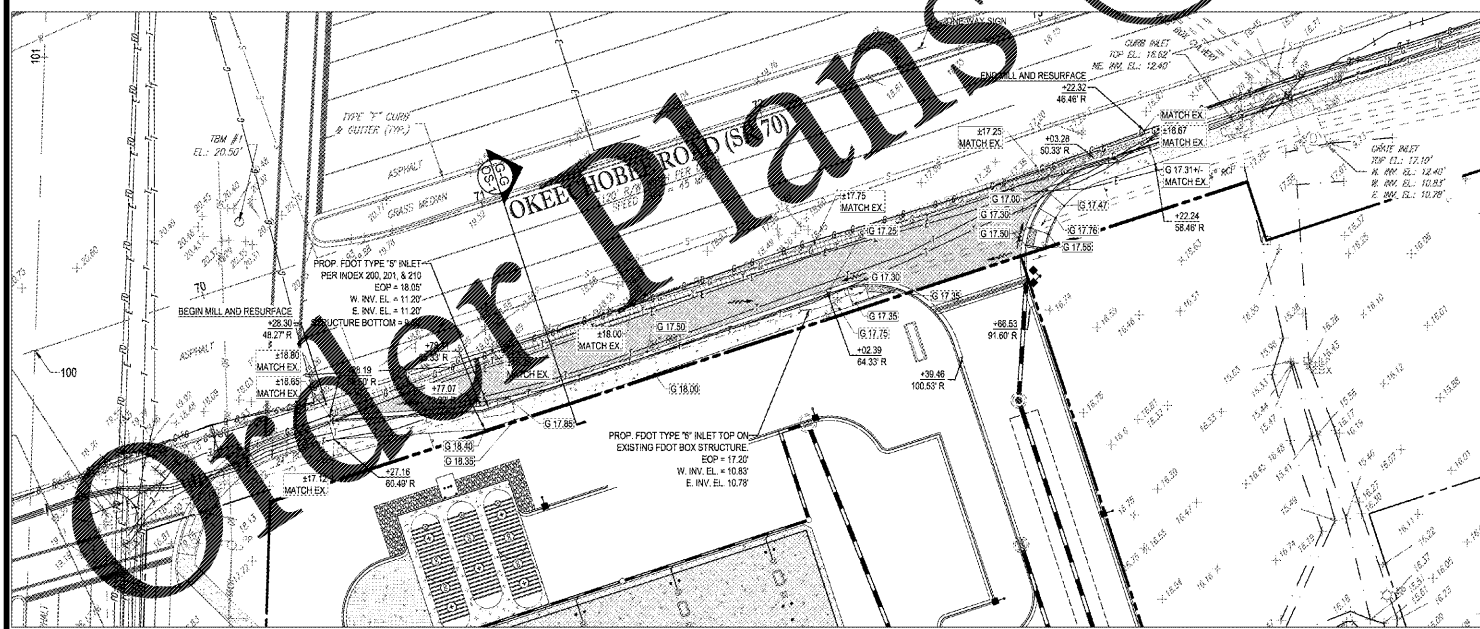

PAVING & GRADING / UTILITY PLAN

LEGEND:

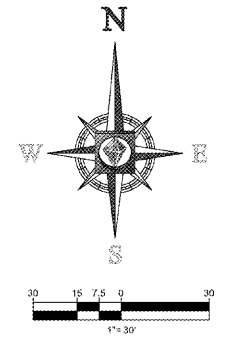
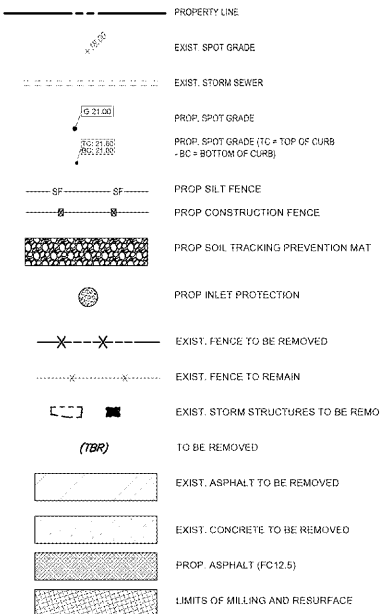

GENERAL NOTES:

1. CONTRACTOR WILL BE RESPONSIBLE FOR VERIFYING THE LOCATION AND DEPTH OF ALL EXISTING UTILITIES PRIOR TO CONSTRUCTION.
2. CONTRACTOR SHALL SUBMIT SHOP DRAWINGS TO THE ENGINEER FOR REVIEW AND APPROVAL PRIOR TO CASTING STRUCTURES.
3. COORDINATE ALL UTILITY LEADS AND BUILDING CONNECTIONS WITH THE ARCHITECTURAL PLANS.
4. STANDARD INDEXES REFER TO THE LATEST EDITION OF F.D.O.T. "ROADWAY AND TRAFFIC DESIGN STANDARDS".
5. ALL DISTURBED AREAS WITHIN RIGHT-OF-WAY WILL NEED TO BE SODED.
6. ANY SIDEWALK THAT IS DAMAGED OR BROKEN DURING CONSTRUCTION SHALL BE REPLACED BY CONTRACTOR.
7. CONTRACTOR TO COORDINATE WITH FDOT, ST. LUCIE COUNTY, AND THE CITY OF FORT PIERCE FOR EVERYTHING RELATED TO MOT OF PROPOSED ROADWORK.

PAVING AND GRADING NOTES:

1. GENERAL:
 - A. ALL ELEVATIONS SHOWN ARE IN REFERENCE TO THE SURVEYORS' DATUMS AND MUST BE VERIFIED BY THE GENERAL CONTRACTOR PRIOR TO GROUND BREAK.
 - B. ALL GRADES SHOWN REFERENCE TO PROPOSED ELEVATIONS ABOVE EDGE OF PAVEMENT, UNLESS OTHERWISE NOTED. "TOP OF CURB" IS GRADE OF CURB ELEVATION. "EDGE OF PAVEMENT" IS GRADE OF PAVED GRADE. "BOTTOM OF RETAINING WALL" IS BOTTOM OF RETAINING WALL ELEVATION.
 - C. ALL ATTACHED UTILITY TILES SHALL BE A PART OF THESE PLANS. THE GEOTECHNICAL REPORT HAS SET FORTH THEREIN ARE A PART OF THE REQUIRED CONSTRUCTION DOCUMENTS AND IN CASE OF CONFLICT SHALL TAKE PRECEDENCE OVER ANY SPECIFICATIONS UNLESS OTHERWISE NOTED ON THE PLANS. THE CONTRACTOR SHALL VERIFY THE SPECIFICATIONS IN WRITING IN THE EVENT OF ANY DISCREPANCY BETWEEN THE GEOTECHNICAL REPORT AND PLANS, ETC.
 - D. ALL UNDERGROUND UTILITIES SHALL BE COMPLETED PRIOR TO CONSTRUCTION OF LIMEROCK OR PAVEMENT. CUT OR DAMAGED BY CONSTRUCTION, SHALL BE PROPERLY RESTORED AT CONTRACTOR'S EXPENSE.
 - E. WHERE ANY PROPOSED PAVEMENT IS TO BE CONNECTED TO EXISTING PAVEMENT, THE EXISTING EDGE OF PAVEMENT SHALL BE SAW CUT TO ENSURE A PROPER JOINT.
 - F. PRIOR TO THEIR CONSTRUCTION OR INSTALLATION, SHOP DRAWINGS SHALL BE SUBMITTED AND APPROVED BY THE ENGINEER OF RECORD. IT IS THE RESPONSIBILITY OF THE CONTRACTOR TO OBTAIN ALL OTHER AGENCY APPROVALS IF REQUIRED.
2. MATERIALS:
 - A. BASE COURSE SHALL BE ABC-3 PER F.D.O.T. SPECIFICATIONS, OR EQUIVALENT LIMEROCK THICKNESS W/ MIN. LBR-100 (MAX. 6" LIFTS).
 - B. ASPHALT SURFACES SHALL BE TYPE FC-12.5 TRAFFIC D ASPHALTIC CONCRETE, UNLESS OTHERWISE SPECIFIED ON THE PLANS, AND SHALL BE A MINIMUM OF 1-1/2" THICK, AND CONSTRUCTED IN TWO 3/4" LIFTS, WITH TACKCOAT BETWEEN LIFTS.
 - C. REINFORCED CONCRETE SLABS SHALL BE CONSTRUCTED OF CLASS I CONCRETE WITH A MINIMUM STRENGTH OF 3,000 PSI AND SHALL BE REINFORCED WITH A 6" x 6" NO. 8 GAUGE WIRE MESH.
3. INSTALLATION:
 - A. SUBGRADE FOR ROADWAY SHALL BE COMPACTED TO A MINIMUM OF 98% OF THE MAXIMUM DENSITY (AASHTO T-99), TO A MIN. 12" AND SHALL HAVE A MINIMUM LBR 40.
 - B. BASE COURSE MATERIAL FOR PAVED AREAS SHALL BE A MINIMUM THICKNESS OF 6" PLACED IN ONE LIFT. BASE COURSE MATERIAL SHALL HAVE A MINIMUM MARSHALL STABILITY OF 1000, UNLESS OTHERWISE INDICATED (OR LBR-100).
 - C. BASE COURSE SHALL BE COMPACTED TO 98% OF THE MAXIMUM DENSITY AS PER AASHTO T-99.
 - D. INSTALLATION OF THE WEARING SURFACE SHALL CONFORM WITH THE REQUIREMENTS OF THE D.O.T. STANDARD SPECIFICATIONS FOR TYPE FC-12.5 TRAFFIC D ASPHALTIC CONCRETE OR THE LATEST REVISION.
4. TESTING:
 - A. THE FINISHED SURFACE OF THE BASE COURSE AND THAT OF THE WEARING SURFACE SHALL NOT VARY MORE THAN 1/4" FROM THE TEMPLATE. ANY IRREGULARITIES EXCEEDING THIS LIMIT SHALL BE CORRECTED.
 - B. DENSITY TESTS SHALL BE TAKEN BY AN INDEPENDENT TESTING LABORATORY CERTIFIED BY THE STATE OF FLORIDA, WHERE DIRECTED BY THE ENGINEER.
 - C. ALL TESTING COSTS (PAVING) SHALL BE PAID FOR BY THE CONTRACTOR.
 - D. DENSITY TESTS ON THE STABILIZED SUBGRADE SHALL BE SUPPLIED TO THE ENGINEER OF RECORD AND GEOTECHNICAL ENGINEER AND APPROVED BEFORE ANY BASE IS CONSTRUCTED.
 - E. DENSITY TESTS AND "AS-BUILT" TESTS ON THE FINISHED BASE SHALL BE SUPPLIED TO THE GEOTECHNICAL ENGINEER, AND APPROVED BEFORE ANY ASPHALT PAVEMENT IS CONSTRUCTED.



DATUM NOTE:

CONTROL BENCHMARK: SAINT LUCIE COUNTY BENCHMARK DESCRIBED AS SAINT LUCIE COUNTY 2004 VERTICAL CONTROL DISK IN CONCRETE LOCATED AT THE NORTHEAST CORNER OF JENKINS AND OKEECHOBEE ROADS 47.5' SOUTHEAST OF A TYPICAL CONCRETE POWER POLE AT THE INTERSECTION OF AN 8" CONCRETE SIDEWALK 14' NORTHWEST OF THE SOUTHWEST CORNER OF THE PARKING LOT PARALLEL TO OKEECHOBEE ROAD.

ELEVATION: 19.13' (NORTH AMERICAN VERTICAL DATUM 1988)

ON-SITE TBM #1: STATION IS DESCRIBED AS A LB-7652 NAIL AND DISK SET ON TOP OF CONCRETE SIDEWALK LOCATED 105.04' NORTH AND 31.89' EAST OF THE NORTHWEST CORNER OF SUBJECT PARCEL.

ELEVATION: 20.50' (NORTH AMERICAN VERTICAL DATUM 1988)

ON-SITE TBM #2: STATION IS DESCRIBED AS A LB-7652 NAIL AND DISK SET ON TOP OF GRATE INLET LOCATED 33.18' NORTH AND 269.81' WEST OF THE NORTHEAST CORNER OF SUBJECT PARCEL.

ELEVATION: 17.92' (NORTH AMERICAN VERTICAL DATUM 1988)

FEMA MAP INFORMATION:

ACCORDING TO FEDERAL EMERGENCY MANAGEMENT AGENCY'S FLOOD INSURANCE RATE MAP (FIRM) PANEL 167 OF 420, COMMUNITY-PANEL NUMBER 125111 C0167 J, ST. LUCIE COUNTY, FLORIDA, EFFECTIVE DATE OF FEBRUARY 18, 2012, THE PROPERTY DESCRIBED HEREON LIES COMPLETELY WITHIN ZONE "X".

SIGNAGE NOTES:

1. ALL PAVEMENT MARKINGS AND SIGNAGE SHALL BE IN ACCORDANCE WITH THE "MANUAL ON UNIFORM TRAFFIC CONTROL DEVICES FOR STREETS AND HIGHWAYS", LATEST EDITION, FDOT DESIGN STANDARDS AND LOCAL DEVELOPMENT CODE.
2. FREE STANDING SIGNAGE SHOWN FOR REPRESENTATIONAL PURPOSES ONLY, AND SHALL BE PERMITTED SEPARATELY. CONTRACTOR TO COORDINATE WITH WAWA SIGN VENDOR FOR PERMITTED LOCATION AND SIZE.
3. ALL PAVEMENT MARKINGS WITHIN FOOT RIGHT-OF-WAY SHALL BE THERMOPLASTIC.
4. REQUIRED EXISTING STRIPING TO BE REMOVED SHALL BE DONE BY MILLING & RESURFACING EXISTING AT A MINIMUM OF 1.5" OF FC AND REPLACED WITH AT A MINIMUM OF 1.5" OF FC 12.5.

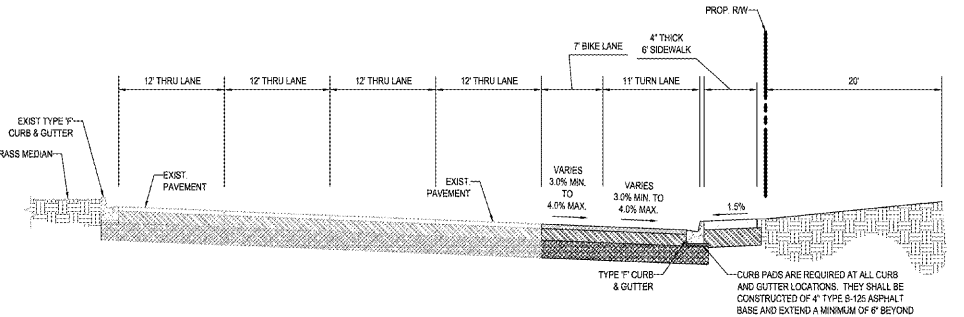

SECTION G-G SCALE: H: 1" = 10', V: 1" = 5'

BOHLER ENGINEERING
 2255 GLADES ROAD, SUITE 305E
 BOCA RATON, FLORIDA 33431
 Phone: (561) 571-0280
 Fax: (561) 571-0281
 Florida Business Certificate of Authority No. 00788
 License #1602 - ARCHITECTURE - BOCA RATON, FL
 License #1603 - SURVEYING - BOCA RATON, FL
 License #1604 - ELECTRICAL - BOCA RATON, FL
 License #1605 - MECHANICAL - BOCA RATON, FL
 License #1606 - PLUMBING - BOCA RATON, FL
 License #1607 - CIVIL - BOCA RATON, FL
 License #1608 - STRUCTURAL - BOCA RATON, FL
 License #1609 - LAND SURVEYING - BOCA RATON, FL
 License #1610 - GEOTECHNICAL - BOCA RATON, FL
 License #1611 - ENVIRONMENTAL - BOCA RATON, FL
 License #1612 - SOIL REMEDIATION - BOCA RATON, FL
 License #1613 - WATER RESOURCES - BOCA RATON, FL
 License #1614 - TRANSPORTATION - BOCA RATON, FL
 License #1615 - MARINE - BOCA RATON, FL
 License #1616 - AVIATION - BOCA RATON, FL
 License #1617 - HISTORIC PRESERVATION - BOCA RATON, FL
 License #1618 - PALEONTOLOGY - BOCA RATON, FL
 License #1619 - OCCUPATIONAL SAFETY AND HEALTH - BOCA RATON, FL
 License #1620 - GENERAL CONTRACTING - BOCA RATON, FL
 License #1621 - CONSTRUCTION MANAGEMENT - BOCA RATON, FL
 License #1622 - CONSTRUCTION INSPECTION - BOCA RATON, FL
 License #1623 - CONSTRUCTION DOCUMENT PREPARATION - BOCA RATON, FL
 License #1624 - CONSTRUCTION ADMINISTRATION - BOCA RATON, FL
 License #1625 - CONSTRUCTION ESTIMATION - BOCA RATON, FL
 License #1626 - CONSTRUCTION SCHEDULING - BOCA RATON, FL
 License #1627 - CONSTRUCTION SAFETY - BOCA RATON, FL
 License #1628 - CONSTRUCTION TRAINING - BOCA RATON, FL
 License #1629 - CONSTRUCTION TESTING - BOCA RATON, FL
 License #1630 - CONSTRUCTION EQUIPMENT MAINTENANCE - BOCA RATON, FL
 License #1631 - CONSTRUCTION MATERIALS TESTING - BOCA RATON, FL
 License #1632 - CONSTRUCTION QUALITY CONTROL - BOCA RATON, FL
 License #1633 - CONSTRUCTION RECORD MANAGEMENT - BOCA RATON, FL
 License #1634 - CONSTRUCTION SITE INVESTIGATION - BOCA RATON, FL
 License #1635 - CONSTRUCTION SURVEILLANCE - BOCA RATON, FL
 License #1636 - CONSTRUCTION TRAFFIC CONTROL - BOCA RATON, FL
 License #1637 - CONSTRUCTION UTILITIES - BOCA RATON, FL
 License #1638 - CONSTRUCTION WASTE MANAGEMENT - BOCA RATON, FL
 License #1639 - CONSTRUCTION WATER RESOURCES - BOCA RATON, FL
 License #1640 - CONSTRUCTION WEATHER - BOCA RATON, FL
 License #1641 - CONSTRUCTION ZONING - BOCA RATON, FL
 License #1642 - CONSTRUCTION PROFESSIONAL LIABILITY INSURANCE - BOCA RATON, FL
 License #1643 - CONSTRUCTION PROFESSIONAL LIABILITY INSURANCE - BOCA RATON, FL
 License #1644 - CONSTRUCTION PROFESSIONAL LIABILITY INSURANCE - BOCA RATON, FL
 License #1645 - CONSTRUCTION PROFESSIONAL LIABILITY INSURANCE - BOCA RATON, FL
 License #1646 - CONSTRUCTION PROFESSIONAL LIABILITY INSURANCE - BOCA RATON, FL
 License #1647 - CONSTRUCTION PROFESSIONAL LIABILITY INSURANCE - BOCA RATON, FL
 License #1648 - CONSTRUCTION PROFESSIONAL LIABILITY INSURANCE - BOCA RATON, FL
 License #1649 - CONSTRUCTION PROFESSIONAL LIABILITY INSURANCE - BOCA RATON, FL
 License #1650 - CONSTRUCTION PROFESSIONAL LIABILITY INSURANCE - BOCA RATON, FL

REVISIONS

REV	DATE	COMMENT	BY
1	8/9/2016	PER CITY COMMENTS	SMT
2	10/20/2016	REVISIONS PER SFVWD COMMENTS	SMT
3	4/10/2017	PER CITY OF FORT PIERCE COMMENTS	DJE
4	4/24/2017	PER CITY OF FORT PIERCE COMMENTS	SGM
5	5/12/2017	PER CITY OF FORT PIERCE COMMENTS	SGM
6	6/21/2017	PER FDOT COMMENTS	SGM
7	7/14/2017	PER FDOT COMMENTS	SGM

811 KNOW WHAT'S BELOW ALWAYS CALL 811 BEFORE YOU DIG
 www.callsunshine.com

APPROVED FOR CONSTRUCTION
 PROJECT No: FLB15009
 DRAWN BY: DJE
 CHECKED BY: GJR
 DATE: 08/24/16
 SCALE: 1" = 30'
 CAD ID: OS-1

PROJECT: SR 70 AND JENKINS FOR WAWA
 LOCATION OF SITE: SEC SR 70 & JENKINS RD FORT PIERCE, FLORIDA

BOHLER ENGINEERING
 2255 GLADES ROAD, SUITE 305E
 BOCA RATON, FLORIDA 33431
 Phone: (561) 571-0280
 Fax: (561) 571-0281
 Florida Business Certificate of Authority No. 00788
 License #1602 - ARCHITECTURE - BOCA RATON, FL
 License #1603 - SURVEYING - BOCA RATON, FL
 License #1604 - ELECTRICAL - BOCA RATON, FL
 License #1605 - MECHANICAL - BOCA RATON, FL
 License #1606 - PLUMBING - BOCA RATON, FL
 License #1607 - CIVIL - BOCA RATON, FL
 License #1608 - STRUCTURAL - BOCA RATON, FL
 License #1609 - LAND SURVEYING - BOCA RATON, FL
 License #1610 - GEOTECHNICAL - BOCA RATON, FL
 License #1611 - ENVIRONMENTAL - BOCA RATON, FL
 License #1612 - SOIL REMEDIATION - BOCA RATON, FL
 License #1613 - OCCUPATIONAL SAFETY AND HEALTH - BOCA RATON, FL
 License #1614 - TRANSPORTATION - BOCA RATON, FL
 License #1615 - MARINE - BOCA RATON, FL
 License #1616 - AVIATION - BOCA RATON, FL
 License #1617 - HISTORIC PRESERVATION - BOCA RATON, FL
 License #1618 - PALEONTOLOGY - BOCA RATON, FL
 License #1619 - OCCUPATIONAL SAFETY AND HEALTH - BOCA RATON, FL
 License #1620 - GENERAL CONTRACTING - BOCA RATON, FL
 License #1621 - CONSTRUCTION MANAGEMENT - BOCA RATON, FL
 License #1622 - CONSTRUCTION INSPECTION - BOCA RATON, FL
 License #1623 - CONSTRUCTION DOCUMENT PREPARATION - BOCA RATON, FL
 License #1624 - CONSTRUCTION ADMINISTRATION - BOCA RATON, FL
 License #1625 - CONSTRUCTION ESTIMATION - BOCA RATON, FL
 License #1626 - CONSTRUCTION SCHEDULING - BOCA RATON, FL
 License #1627 - CONSTRUCTION SAFETY - BOCA RATON, FL
 License #1628 - CONSTRUCTION TRAINING - BOCA RATON, FL
 License #1629 - CONSTRUCTION TESTING - BOCA RATON, FL
 License #1630 - CONSTRUCTION EQUIPMENT MAINTENANCE - BOCA RATON, FL
 License #1631 - CONSTRUCTION MATERIALS TESTING - BOCA RATON, FL
 License #1632 - CONSTRUCTION QUALITY CONTROL - BOCA RATON, FL
 License #1633 - CONSTRUCTION RECORD MANAGEMENT - BOCA RATON, FL
 License #1634 - CONSTRUCTION SITE INVESTIGATION - BOCA RATON, FL
 License #1635 - CONSTRUCTION SURVEILLANCE - BOCA RATON, FL
 License #1636 - CONSTRUCTION TRAFFIC CONTROL - BOCA RATON, FL
 License #1637 - CONSTRUCTION UTILITIES - BOCA RATON, FL
 License #1638 - CONSTRUCTION WASTE MANAGEMENT - BOCA RATON, FL
 License #1639 - CONSTRUCTION WATER RESOURCES - BOCA RATON, FL
 License #1640 - CONSTRUCTION WEATHER - BOCA RATON, FL
 License #1641 - CONSTRUCTION ZONING - BOCA RATON, FL
 License #1642 - CONSTRUCTION PROFESSIONAL LIABILITY INSURANCE - BOCA RATON, FL
 License #1643 - CONSTRUCTION PROFESSIONAL LIABILITY INSURANCE - BOCA RATON, FL
 License #1644 - CONSTRUCTION PROFESSIONAL LIABILITY INSURANCE - BOCA RATON, FL
 License #1645 - CONSTRUCTION PROFESSIONAL LIABILITY INSURANCE - BOCA RATON, FL
 License #1646 - CONSTRUCTION PROFESSIONAL LIABILITY INSURANCE - BOCA RATON, FL
 License #1647 - CONSTRUCTION PROFESSIONAL LIABILITY INSURANCE - BOCA RATON, FL
 License #1648 - CONSTRUCTION PROFESSIONAL LIABILITY INSURANCE - BOCA RATON, FL
 License #1649 - CONSTRUCTION PROFESSIONAL LIABILITY INSURANCE - BOCA RATON, FL
 License #1650 - CONSTRUCTION PROFESSIONAL LIABILITY INSURANCE - BOCA RATON, FL

SHEET TITLE: OFF-SITE PLAN
 SHEET NUMBER: OS-1

4/10/2017 10:05:58 AM TO: JENKINS@BOHLERENGINEERING.COM FROM: JENKINS@BOHLERENGINEERING.COM
 4/10/2017 10:05:58 AM TO: JENKINS@BOHLERENGINEERING.COM FROM: JENKINS@BOHLERENGINEERING.COM
 4/10/2017 10:05:58 AM TO: JENKINS@BOHLERENGINEERING.COM FROM: JENKINS@BOHLERENGINEERING.COM