

NOTES TO KITCHEN ELECTRICAL PLANS

- ALL ELECTRICAL WORK SHALL COMPLY WITH IBC, IFC, IMC, NFPA, NEC, SCDHEC AND OTHER APPLICABLE CODES AND STANDARDS.
- DO NOT ROUGH FROM THESE DRAWINGS - ROUGH ONLY FROM EQUIPMENT SUPPLIERS' APPROVED SHOP DRAWINGS AND DIMENSIONED SPOT ROUGH-IN PLANS. CONTRACTOR IS CAUTIONED THAT ELECTRICAL WORK SHOWN IS BASED ON A KITCHEN DESIGN WHICH MAY NOT EXACTLY MATCH THE FINAL EQUIPMENT LAYOUT PROVIDED ON THE JOB. INCLUDE IN BID SUFFICIENT LABOR, MATERIALS AND OPERATIONS TO MAKE MINOR REVISIONS TO THE WORK SHOWN AT NO ADDITIONAL COST TO THE OWNER.
- SEE FOOD SERVICE PLANS FOR KITCHEN EQUIPMENT DESIGNATIONS. COORDINATE ALL FINAL EQUIPMENT LOCATIONS AND ELECTRICAL REQUIREMENTS WITH THE SUPPLIERS' APPROVED SHOP DRAWINGS. PROVIDE ALL OUTLET DEVICES AND POWER CONNECTIONS FOR EQUIPMENT AND CONNECT ALL EQUIPMENT COMPLETE. WHERE FUSIBLE DISCONNECTS ARE REQUIRED, PROVIDE FUSING TO MATCH EQUIPMENT NAMEPLATE REQUIREMENTS.
- PROVIDE 120-VOLT POWER CONNECTION FOR HOOD FIRE SUPPRESSION SYSTEM AND INTERLOCK COMPLETE WITH FIRE ALARM SYSTEM. COORDINATE WITH FOOD SERVICE AND FIRE SUPPRESSION SYSTEM VENDORS AND PROVIDE ASSOCIATED ELECTRICAL WORK AS REQUIRED FOR MANUAL EMERGENCY POWER OFF (EPO) DEVICE AND OPERATION.
- COORDINATE WITH FOOD SERVICE VENDOR AND PROVIDE ALL CONTACTORS, RELAYS, MODULES, WIRING, LABOR AND ASSOCIATED WORK AS REQUIRED TO DISCONNECT ALL HEAT AND FUEL SOURCES FROM ALL KITCHEN EQUIPMENT UNDER HOOD, INCLUDING ALL POWER AND GAS SOLENOIDS WHERE APPLICABLE. SHUTDOWN METHOD SHALL BE IN ACCORDANCE WITH LOCAL CODES AND AS APPROVED BY AHJ. CONNECT COMPLETE TO SOUND GENERAL ALARM UPON HOOD SUPPRESSION ACTIVATION.
- SEE MECHANICAL AND FOOD SERVICE PLANS FOR EXACT LOCATIONS OF SUPPLY AND EXHAUST FANS. INTERLOCK FANS WITH HOOD SUPPRESSION SYSTEM AND CONNECT COMPLETE TO TURN SUPPLY FAN OFF AND EXHAUST FAN ON UPON ACTIVATION OF SYSTEM.
- FINAL TYPEWRITTEN PANELBOARD DIRECTORIES SHALL IDENTIFY EQUIPMENT SERVED BY TAGS AS DIRECTED BY OWNER. ALL UNDERHOOD EQUIPMENT SHALL BE INDICATED AS SUCH IN DIRECTORY.
- ALL 15 AND 20 AMPERE RECEPTACLES LOCATED IN THE KITCHEN, SERVING, DISHWASHING AND RELATED AREAS SHALL BE GFCI TYPE.

FOODSERVICE ELECTRICAL SCHEDULE												
ITEM NO.	QTY.	DESCRIPTION	ELECTRICAL					ROUGH-IN / CONNECTION				REMARKS
			VOLTS	PH.	KW	HP	AMPS	TYPE	NEMA	ROUTING	HGT AFF	
2	1	2-SECTION REACH-IN FREEZER	120	1			12.00	C&P	5-20P	WL	8"	
3	1	2-SECTION REACH-IN REFRIGERATOR	120	1			10.70	C&P	5-15P	WL	8"	
6	1	60" RANGE	120	1			4.00	C&P	5-15P	WL	24"	
7	1	DOUBLE DECK CONVECTION OVEN	120	1	35.20	3/4	19.60		5-15P	WL	48"	
8	1	HOOD	120	1								NOTE 26
8.1	1	FIRE SUPPRESSION SYSTEM	120	1								NOTE 26
14.1	1	ICE MACHINE	120	1			11.70	JBOX		WL	60"	NOTE 5

CONVENIENCE OUTLET SCHEDULE				
ID NO.	QTY.	RECEPTACLE TYPE	NEMA	HGT AFF
CO-1	5	DUPLEX RECEPTACLE	5-20R	48"
CO-2	3	DUPLEX RECEPTACLE	5-20R	78"

NEW PANEL															
SCHEDULE - PANELBOARD LK TYPE: <input type="checkbox"/> NQOD <input type="checkbox"/> I-LINE VOLTAGE: <input type="checkbox"/> 208/120V, 3 ϕ , 4W, WYE <input type="checkbox"/> 480/277V, 3 ϕ , 4W, WYE MOUNTING: <input type="checkbox"/> FLUSH <input type="checkbox"/> SURFACE AIC RATING: 35K															
150 AMP <input type="checkbox"/> MLO <input type="checkbox"/> MCB <input type="checkbox"/> NF <input type="checkbox"/> LDCIR <input type="checkbox"/> 480/277V, 3 ϕ , 4W, WYE ACCESSORY: <input type="checkbox"/> FEED-THRU LUGS TOTAL SPACES: 42															
NO.	LOAD DESCRIPTION	REMARK	BRKR	CIRCUIT	LOAD KVA	BUSSING			LOAD KVA	CIRCUIT	BRKR	AMP	REMARK	LOAD DESCRIPTION	NO.
						A	B	C							
1	REACH-IN FRZ				1.2	1.2	1.2	1.2	1.2	1.2		20		RECEPT	1
2	REACH-IN REF				1.2	1.2	1.2	1.2	1.2	1.2		20		RECEPT	2
3	RANGE				1.9	1.9	1.9	1.9	1.9	1.9		20		ICE MACHINE	3
4	CONV. OVEN				1.2	1.2	1.2	1.2	1.2	1.2		20		ICE RECEPT	4
5	RECEPT				1.2	1.2	1.2	1.2	1.2	1.2		20		OFFICE RECEPT	5
11	SPARE				0.8	0.8	0.8	0.8	0.8	0.8		20		STB	11
12	SPARE				0.8	0.8	0.8	0.8	0.8	0.8		20		STB	12
13	SPARE				0.8	0.8	0.8	0.8	0.8	0.8		20		STB	13
14	SPARE				0.8	0.8	0.8	0.8	0.8	0.8		20		STB	14
15	SPARE				0.8	0.8	0.8	0.8	0.8	0.8		20		STB	15
16	SPARE				0.8	0.8	0.8	0.8	0.8	0.8		20		STB	16
17	SPARE				0.8	0.8	0.8	0.8	0.8	0.8		20		STB	17
18	SPARE				0.8	0.8	0.8	0.8	0.8	0.8		20		STB	18
19	SPARE				0.8	0.8	0.8	0.8	0.8	0.8		20		STB	19
20	SPARE				0.8	0.8	0.8	0.8	0.8	0.8		20		STB	20
21	SPARE				0.8	0.8	0.8	0.8	0.8	0.8		20		STB	21
22	SPARE				0.8	0.8	0.8	0.8	0.8	0.8		20		STB	22
23	SPARE				0.8	0.8	0.8	0.8	0.8	0.8		20		STB	23
24	SPARE				0.8	0.8	0.8	0.8	0.8	0.8		20		STB	24
25	SPARE				0.8	0.8	0.8	0.8	0.8	0.8		20		STB	25
26	SPARE				0.8	0.8	0.8	0.8	0.8	0.8		20		STB	26
27	SPARE				0.8	0.8	0.8	0.8	0.8	0.8		20		STB	27
28	SPARE				0.8	0.8	0.8	0.8	0.8	0.8		20		STB	28
29	SPARE				0.8	0.8	0.8	0.8	0.8	0.8		20		STB	29
30	SPARE				0.8	0.8	0.8	0.8	0.8	0.8		20		STB	30
31	SPARE				0.8	0.8	0.8	0.8	0.8	0.8		20		STB	31
32	SPARE				0.8	0.8	0.8	0.8	0.8	0.8		20		STB	32
33	SPARE				0.8	0.8	0.8	0.8	0.8	0.8		20		STB	33
34	SPARE				0.8	0.8	0.8	0.8	0.8	0.8		20		STB	34
35	SPARE				0.8	0.8	0.8	0.8	0.8	0.8		20		STB	35
36	SPARE				0.8	0.8	0.8	0.8	0.8	0.8		20		STB	36
37	SPARE				0.8	0.8	0.8	0.8	0.8	0.8		20		STB	37
38	SPARE				0.8	0.8	0.8	0.8	0.8	0.8		20		STB	38
39	SPARE				0.8	0.8	0.8	0.8	0.8	0.8		20		STB	39
40	SPARE				0.8	0.8	0.8	0.8	0.8	0.8		20		STB	40
41	SPARE				0.8	0.8	0.8	0.8	0.8	0.8		20		STB	41
42	SPARE				0.8	0.8	0.8	0.8	0.8	0.8		20		STB	42
43	SPARE				0.8	0.8	0.8	0.8	0.8	0.8		20		STB	43
44	SPARE				0.8	0.8	0.8	0.8	0.8	0.8		20		STB	44
45	SPARE				0.8	0.8	0.8	0.8	0.8	0.8		20		STB	45
46	SPARE				0.8	0.8	0.8	0.8	0.8	0.8		20		STB	46
47	SPARE				0.8	0.8	0.8	0.8	0.8	0.8		20		STB	47
48	SPARE				0.8	0.8	0.8	0.8	0.8	0.8		20		STB	48
49	SPARE				0.8	0.8	0.8	0.8	0.8	0.8		20		STB	49
50	SPARE				0.8	0.8	0.8	0.8	0.8	0.8		20		STB	50
CONNECTED LOAD, KVA: A 4.6 B 3.1 C 2.3						NEUTRAL			CONNECTED LOAD, KVA: A 4.4 B 5.1 C 4.7						
KVA THIS PANEL: A 9.0 B 8.2 C 7.0															

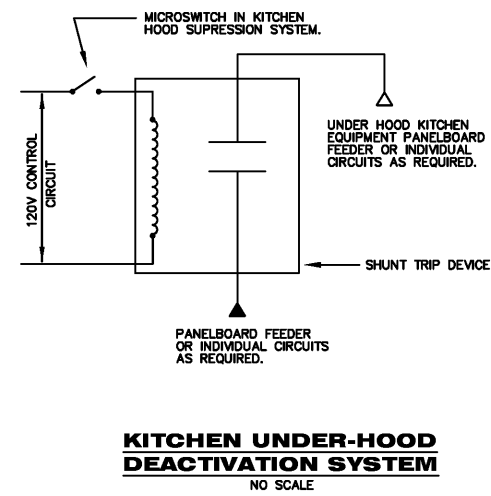
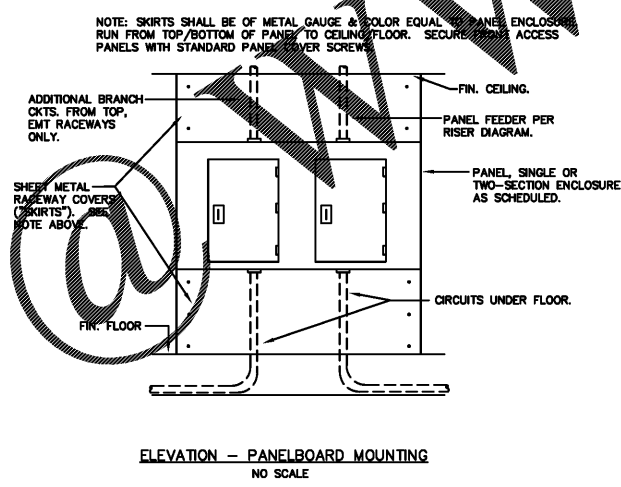

- NOTES TO KITCHEN HOOD ELECTRICAL PLANS**
- PROVIDE 120V. POWER SUPPLY CONNECTION FOR HOOD FIRE SUPPRESSION SYSTEM. VERIFY FINAL LOCATION PRIOR TO ROUGHING.
 - SEE MECHANICAL PLANS FOR EXACT LOCATIONS FOR SUPPLY AND EXHAUST FANS. INTERLOCK FANS WITH FIRE SUPPRESSION SYSTEM UNDER HOOD AND CONNECT COMPLETE TO TURN SUPPLY FAN OFF AND RETURN FAN ON UPON ACTIVATION OF HOOD SUPPRESSION SYSTEM.
 - CONTRACTOR SHALL VISIT SITE PRIOR TO BIDDING AND VERIFY EXISTING UNDER-HOOD EQUIPMENT CIRCUITS AND CIRCUIT SIZES. INCLUDE ALL REQUIRED WORK IN BID FOR A COMPLETE AND OPERABLE SYSTEM.
 - PROVIDE ALL SHUNT TRIP OPERATORS, RELAYS, CONTACTORS, MODULES, WIRING AND THE LIKE TO DISCONNECT POWER FROM ALL KITCHEN EQUIPMENT UNDER HOOD UPON ACTIVATION OF HOOD SUPPRESSION SYSTEM. CONNECT COMPLETE TO SOUND GENERAL ALARM UPON HOOD ACTIVATION.
 - FINAL TYPEWRITTEN PANELBOARD DIRECTORIES SHALL IDENTIFY EQUIPMENT SERVED BY TAGS AS DIRECTED BY OWNER.

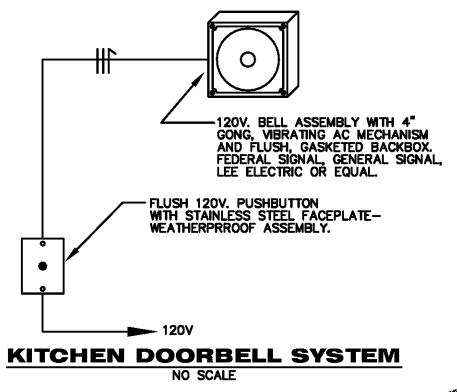
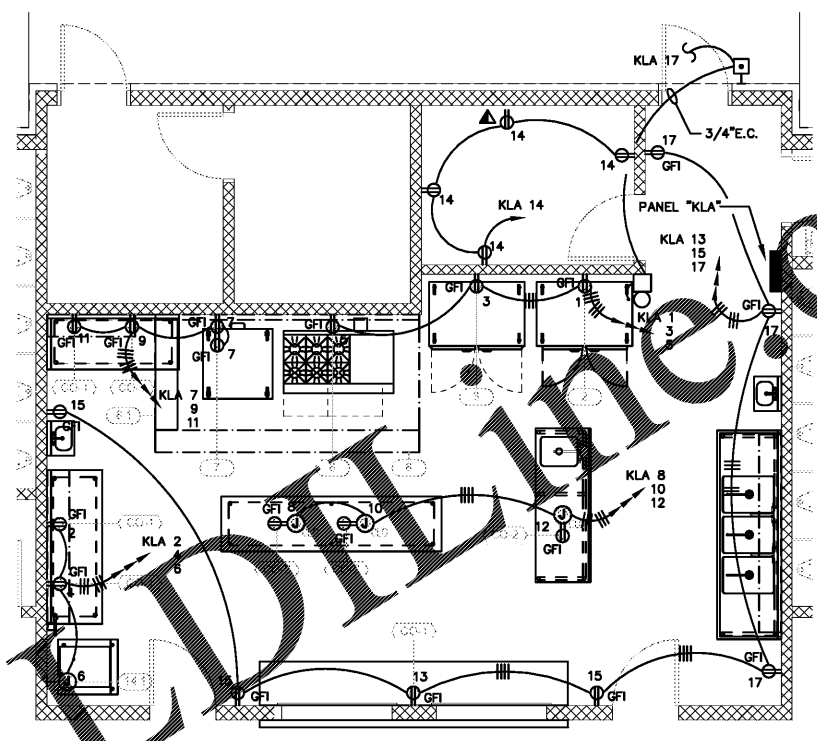

Order Plans

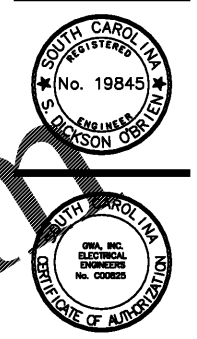

McCready/Snow Architects, PA
Architects and Planners
1000 North Main Street, Suite 1000
Columbia, SC 29201
803/737-1567
www.mccreadysnow.com

Electrical Plan - Kitchen
Pinewood Community Bldg.
Richland County
Old Garners Ferry Road
Columbia, SC 29209

Pricing set only - NOT FOR CONSTRUCTION

Drawn: - MRD/CJA Checked: - SDO
Revised: -
Project No.: #####
File: -

GWA inc. Electrical Engineers
Midlands Office - Main
168 Laurelhurst Avenue
Columbia, SC 29210
(803)252-6919
Fax (803)799-5494
gwa@gwainc.net
http://www.gwainc.net