

General Notes:

- Design Specifications: International Building Code (2015 Edition).  
Design Loads:  
Snow load: 10 PSF  
Floor live load: Pedestrian: 85 PSF  
Golf Car: 1,000lb wheel load  
Dead load: Actual  
Wind Velocity: 117 MPH  
Exposure Category: B
- In case of a discrepancy in dimensions or details, between Civil and Structural drawings, not affecting strength, the Civil plans shall govern. For dimensions and details not shown, see Civil's plans.
- The construction falsework (if any) is the responsibility of the Contractor. The design shall be performed by a Registered Engineer and shall be submitted for approval before commencing of the work.
- Where a detail is shown on Structural drawings for one condition, it shall apply to all similar or like conditions, unless noted or shown otherwise on plans.
- All items shall be tightly anchored or attached square, plumb, and true, or in other planes and shapes as shown on the drawings. Joints shall be tight, even, and free of offsets. No field altering of any members will be allowed that will cause them not to be in accordance with the drawings and specifications, without written approval of the Project Engineer.
- The dimensions shown with a suffix "±" are approximate and shall be verified by the Contractor before fabrication.
- If the Contractor finds a difference between these drawings & existing conditions, or finds any other conditions which prohibit execution of the work as directed in these drawings, the Contractor shall notify the Engineer immediately.
- Any revision/modification to the original design during the shop drawing process, the Contractor shall clearly cloud line all the changes and shall receive approval from the Engineer in writing before fabrication. Any costs associated with correcting the unapproved change shall be at the Contractor's expense.

Concrete:

- Concrete minimum compressive strength at 28 days shall be 3,000 PSI.
- Reinforcement: all mild reinforcement bar shall be A615 grade 60 steel. All welded wire fabric shall conform to ASTM A185, grade 65. All welded wire fabric shall be in sheets and shall be supported on chairs.
- Bending dimensions & tolerances for reinforcing bar shall conform to current CRSI Manual of Standard Practice.
- Lap splices shall conform to the current CRSI Manual of Standard Practice unless otherwise noted.
- Horizontal construction joints to be scrubbed with a coarse wire brush at the approximate time of initial set to remove all laitance and to produce a roughened surface.
- Concrete work shall comply with ACI "Specifications for Structural Concrete" (ACI 301-10) and applicable provisions of ACI 318-11. Keep a copy of ACI Field Reference Manual (ACI SP-15-10) Which includes ACI 301 and other ACI and ASTM references on the job.
- Detailing, fabricating, and placing of reinforcing steel and accessories shall be in accordance with ACI "Details and Detailing of Concrete Reinforcement" (ACI 315-99) and shall comply with (ACI 318-11) and with (ACI 301-10).
- The contractor shall select the testing laboratory & employ the laboratory at the contractor's expense to perform concrete strength testing per ACI 318-11. Final selection of testing laboratory shall be approved by engineer.

Timber:

- All timber materials shall conform to the approved standards of the American Wood Preservers' Association. Each piece shall be treated in accordance with AWPA UC4B standards, and certified by an approved inspection agency. Any timber in contact with the soil shall be treated for ground contact, and shall be so indicated with the treated quality stamp on each piece. Any timber in contact with masonry or steel shall be treated. All cuts, holes, and machine areas shall be liberally brushed with a solution of copper naphthenate containing a min. of 2% metallic copper in accordance with AWPA standard M4.
- All lumber beams shall be #1 southern pine. Decking planks & timber posts shall be #2 southern pine. All pieces shall bear the grade mark of a recognized agency or independent inspection service certified by the board of review, American lumber standard committee.
- Metal timber connectors shall be H.D.G. according to ASTM123 or ASTM153, and shall be installed in strict accordance with the manufacturer's specification.
- Metal timber connector designation as by Simpson's strong tie shall be H.D.G. Product substitutions shall be permitted only if submitted in advance, as outlined in specifications, and approved by the engineer as an equal.
- Screws shall be made of stainless steel as well. Screw spacing shall be sufficient to develop maximum connection strength without splitting the members. All split members shall be replaced.
- All bolts used in timber connections shall be hot dip galvanized with hot dip galvanized Ogee washer. Bolts, nuts and washer used together in all other conditions, shall be H.D.G.
- All deckings and rails shall be installed with grain concave down.

Timber Pile:

- All timber piling shall be southern pine grade #2.
- 4x6 and 6x6 timber piles shall be treated with waterborne preservative per AWPA U1-UC4B.
- Field cuts, holes and other penetrations shall be field treated per AWPA M4.
- The minimum piling allowable bearing capacity shall be 1 kip.
- The lengths of embedment of timber piles given on the plans are to be considered as approximate and contractor shall determine the pile embedment length to comply with the minimum required resistance by driving test piling or other means.
- All pile construction shall comply to South Carolina Department of Transportation (SCDOT) standard specifications for highway construction section 711 of the 2007 edition. Acceptable method of installing 4x6 and 6x6 piles shall be Water Jet Driven.
- Piles shall be southern pine (long leaf, slash, loblolly and short leaf pines) conforming to ASTM D25-12 and ASTM 2889-12. Piles shall have a 25" minimum tip circumference. The piles shall be conditioned prior to treatment by air or kiln drying only.

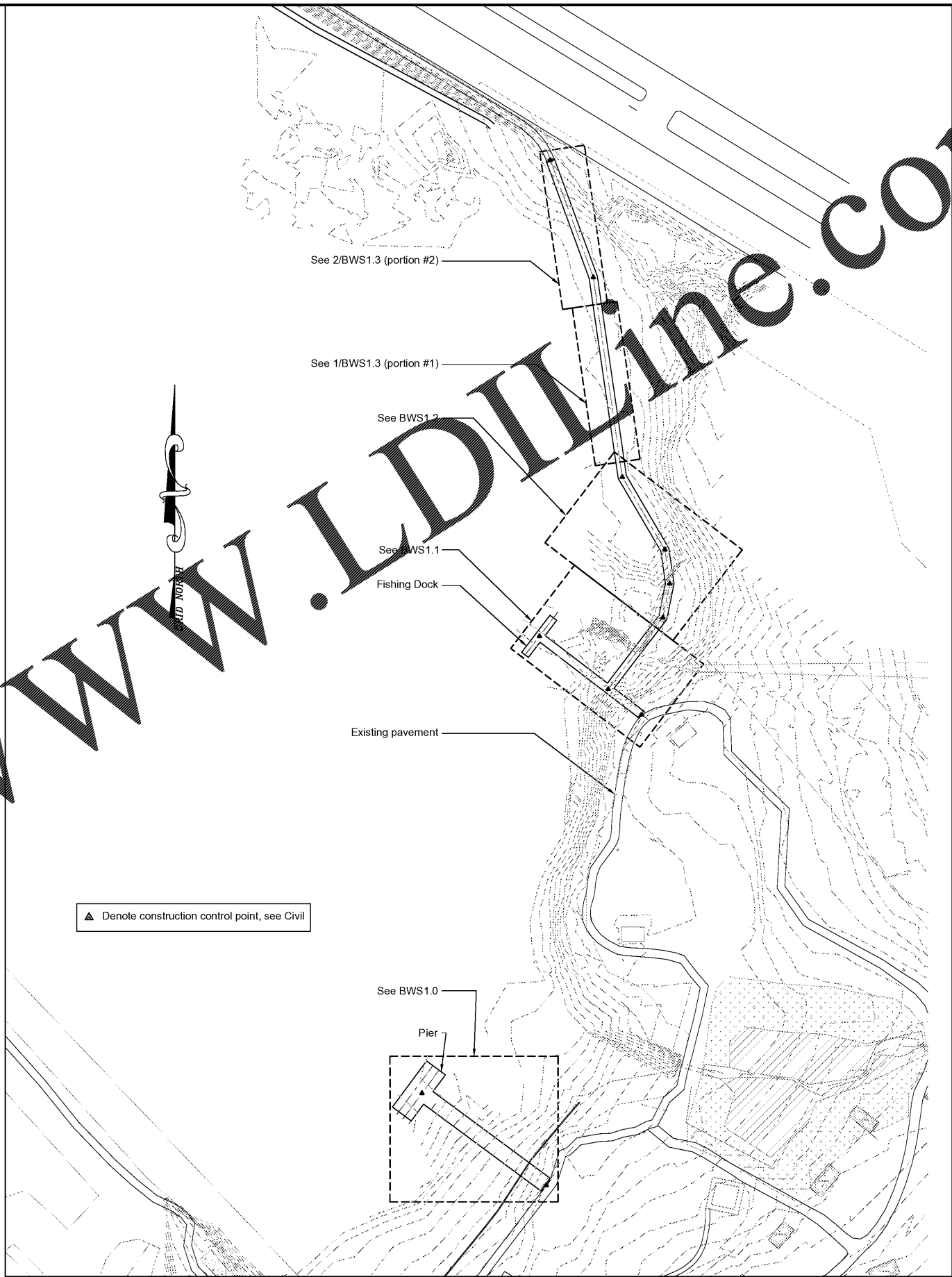

Key Plan  
Scale: 1/64" = 1'-0"

Drawing File: 399935-165.dwg Plotter: Aug 24, 2017 1:49pm

Online Plans @



Chao & Associates, Inc.  
Civil - Structural - Survey  
7 Clusters Court  
Columbia, SC 29210  
Voice: (803) 772-8420  
Fax: (803) 772-9120  
Email: consult@chaoinc.com



General Notes & Key Plan  
Pinewood Lake Park Fishing Pier & Boardwalk  
Prepared for:  
Richland County  
Richland County, South Carolina

Drawn: LPL	Checked: CJC	Project No.: 399935D
Revised:		File: 399935-165.dwg

BWS0.0  
Sheet Number  
8/14/2017  
Date