

Aug 11, 2017 - 3:09pm \\PALMETO\Grimball\Projects on Maple\N-S Projects\PineWood Lake Community Center\Bare08.08.17.dwg

MATCH LINE
MATCH LINE

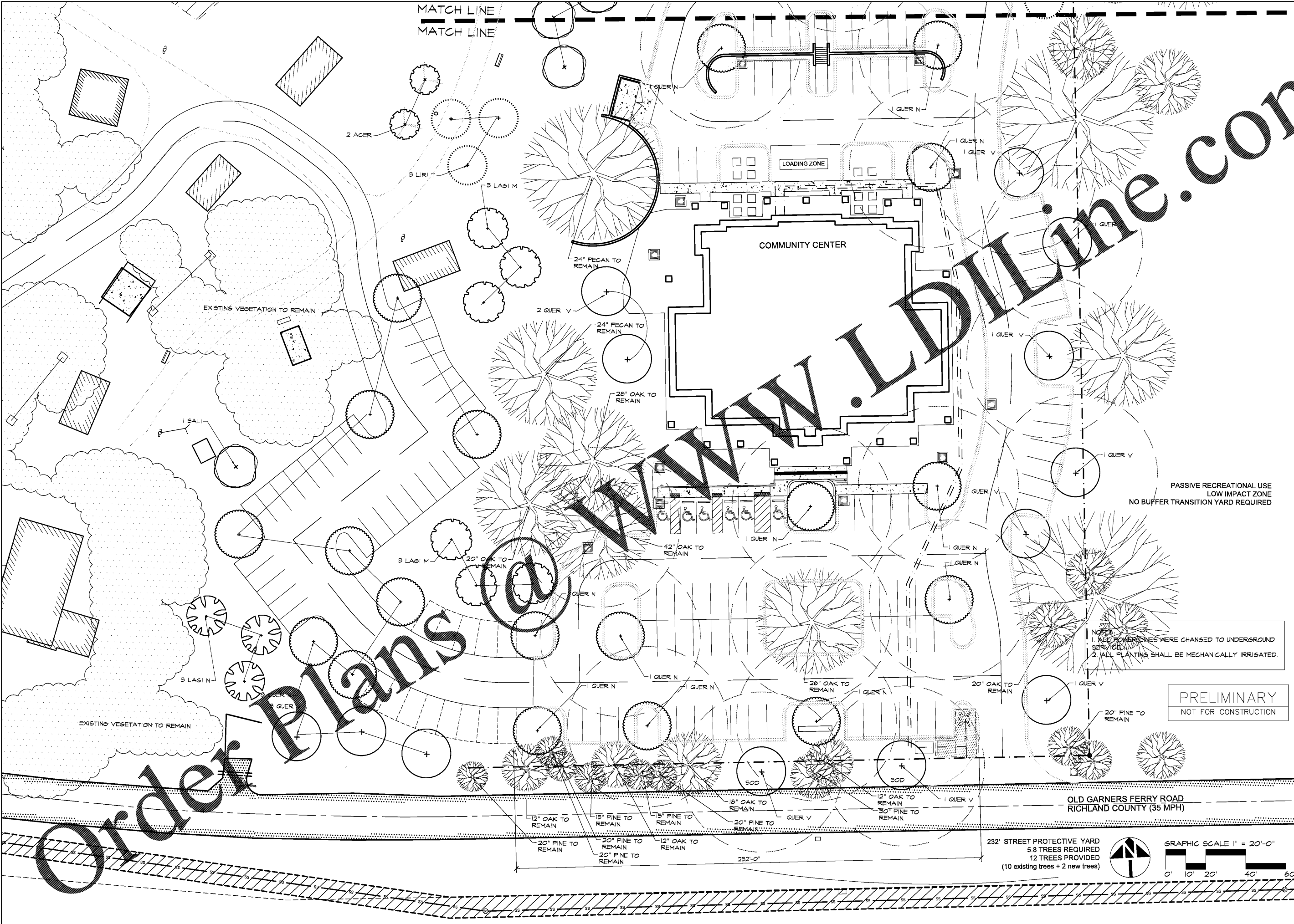

WWW.LDLINE.COM

Order Plans @

EXISTING VEGETATION TO REMAIN

EXISTING VEGETATION TO REMAIN

COMMUNITY CENTER

LOADING ZONE

PASSIVE RECREATIONAL USE
LOW IMPACT ZONE
NO BUFFER TRANSITION YARD REQUIRED

NOTES:
1. ALL POWER LINES WERE CHANGED TO UNDERGROUND SERVICE LINES.
2. ALL PLANTING SHALL BE MECHANICALLY IRRIGATED.

PRELIMINARY
NOT FOR CONSTRUCTION

OLD GARNERS FERRY ROAD
RICHLAND COUNTY (35 MPH)

232' STREET PROTECTIVE YARD
5.8 TREES REQUIRED
12 TREES PROVIDED
(10 existing trees + 2 new trees)

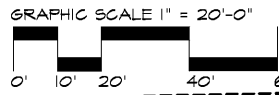

| Revisions | Date |
|-----------|------|
| | |
| | |
| | |

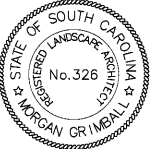

GRIMBALL PINWOOD LAKE PHASE TWO
& ASSOCIATES
COTTERILL

LANDSCAPE ARCHITECTS & LAND PLANNERS
600 BELTLINE BOULEVARD COLUMBIA, SC 29205 (803)738-9525

This drawing and the design thereon is the property of Grimalli-Cotterill & Associates. The reproduction, copying or use of this drawing without consent is prohibited and any violation will be subject to legal action.

Drawn by: TGV
 Checked by: MDG
 Date: 8.08.17
 Drawing No. L.3
 Sheet No. 3 OF 4