

**SIGN-OFF PROCEDURE:**

1. THE G.C. SHALL SEND THE CONDUIT LAYOUT DRAWINGS TO THE SYSTEM INSTALLER FOR THEIR REVIEW, COMMENT AND MARK UP.
2. THE SYSTEM INSTALLER SHALL MARK UP THE PLAN WITH ANY CHANGES OR ADDITIONAL DETAILS, THEN SIGN AND DATE WITH THEIR COMPANY NAME AND SEND IT BACK TO THE G.C.
3. UPON RECEIPT OF THE PLAN THE G.C. WILL THEN THEN SIGN AND DATE WITH THEIR COMPANY NAME INDICATING THAT THEY ACCEPT THE MARKED UP PLAN WITH E.C..

	COMPANY	SIGNATURE	DATE
SYSTEM VENDOR			
GENERAL CONTRACTOR			
ELECTRICAL CONTRACTOR			

Issued:	Date:
A Client Review Set	04/07/17
B Permit Set	04/07/17
C Bid Set	09/05/17
D	

Revisions:	Date:
1	
2	
3	
4	
5	
6	
7	
8	
9	

BOX PROVIDED BY SECURITY/FIRE ALARM VENDOR RUN 3/4" CONDUIT TO BACK OF BOX AT 8'-10" A.F.F.

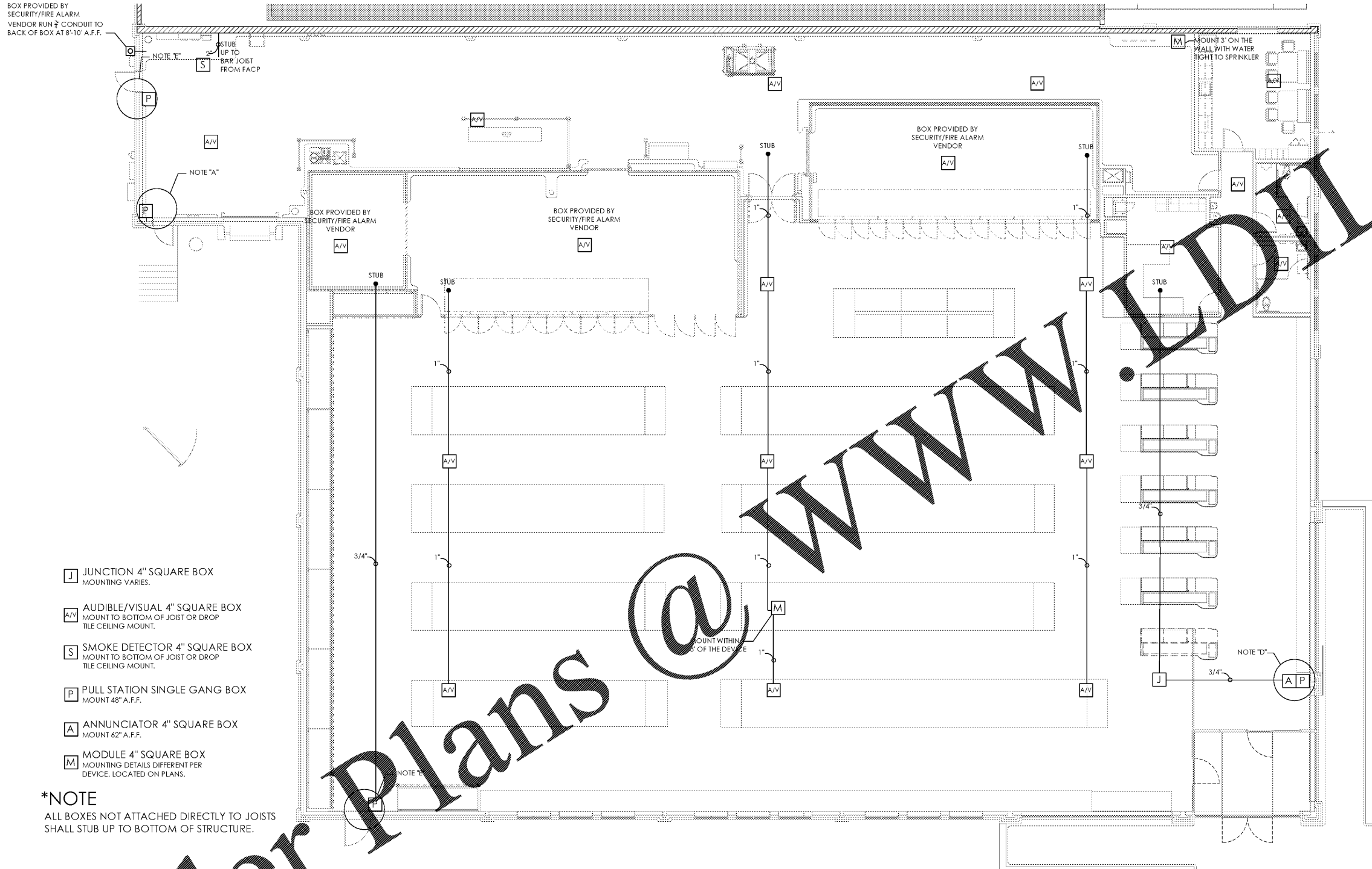

- J** JUNCTION 4" SQUARE BOX  
MOUNTING VARIES.
- A/V** AUDIBLE/VISUAL 4" SQUARE BOX  
MOUNT TO BOTTOM OF JOIST OR DROP TILE CEILING MOUNT.
- S** SMOKE DETECTOR 4" SQUARE BOX  
MOUNT TO BOTTOM OF JOIST OR DROP TILE CEILING MOUNT.
- P** PULL STATION SINGLE GANG BOX  
MOUNT 48" A.F.F.
- A** ANNUNCIATOR 4" SQUARE BOX  
MOUNT 62" A.F.F.
- M** MODULE 4" SQUARE BOX  
MOUNTING DETAILS DIFFERENT PER DEVICE, LOCATED ON PLANS.

**\*NOTE**  
ALL BOXES NOT ATTACHED DIRECTLY TO JOISTS SHALL STUB UP TO BOTTOM OF STRUCTURE.

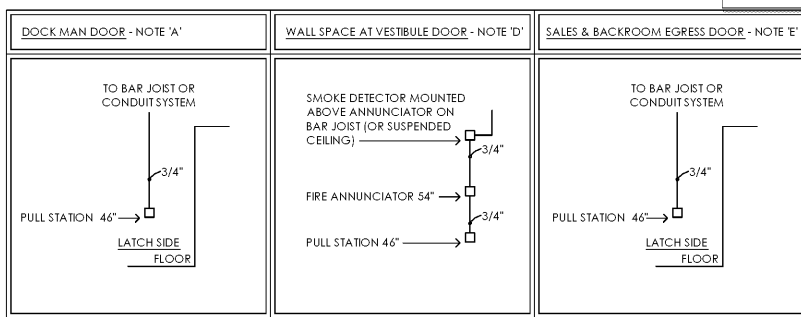

**NOTE:**

THIS CONDUIT DRAWING IS FOR REFERENCE ONLY. THE ELECTRICAL CONTRACTOR SHALL COORDINATE ALL FIRE ALARM SYSTEM (IF REQUIRED) AND SECURITY SYSTEM REQUIREMENTS WITH ALDI'S FIRE ALARM AND SECURITY SYSTEM VENDOR(S) AND SHALL PROVIDE ALL RACEWAYS, CONDUIT AND BOXES AS REQUIRED FOR INSTALLATION OF SYSTEM EQUIPMENT, DEVICES AND CABLING. ALL REQUIRED RACEWAYS, CONDUIT AND BOXES SHALL BE FURNISHED AND INSTALLED BY THE ELECTRICAL CONTRACTOR FOR USE BY THE FIRE ALARM AND SECURITY SYSTEM INSTALLER(S). REFER TO SIGN-OFF PROCEDURE LOCATED ON THIS SHEET.

**DO NOT SCALE PLANS**

Copying, Printing, Software and other processes required to produce these prints can stretch or shrink the actual paper or layout. Therefore, scaling of this drawing may be inaccurate. Contact ms consultants with any need for additional dimensions or clarifications.

**ms consultants, inc.**  
engineers, architects, planners  
2221 Schrock Road  
Columbus, Ohio 43229-1547  
phone 614.898.7100  
fax 614.898.7570

DRAWN BY: ZRD  
REVIEWED BY: KFF/DED

Seal

PROFESSIONAL OF RECORD:  
DANIEL E. DOWLER No. 0402054658  
EXP. DATE: 02/28/2019

**ALDI Inc.**  
1985 Old Union Church Road  
Salisbury, NC 28146  
(704) 642-0023  
(704) 642-0078 fax

ALDI Inc. Store #: 161  
VA Beach Blvd & Thalia  
4220 Virginia Beach Blvd  
Virginia Beach, VA 23452  
Willis Wayside  
Project Name & Location:

**Fire Alarm Conduit Plan**  
Drawing Name:

Prototype Rls. 02/08/17	Project No. 40320-40
Type: RHSD-V7	CLP-101

Scale: As Noted Drawing No.

**Order Plans**

**D1** Fire Alarm Conduit Plan  
SCALE: 1/8" = 1'-0"  
PLAN NORTH