

KEYED NOTES:
 NUMBERS 00 THRU 49 ARE
 CONTRACTOR PROVIDED (Furnished & Installed)

- 00 CFB 6" PALLET BUMPER REFER TO DWG. B1/A502 - CONTRACTOR SHALL FULLY WELD ALL SEAMS AND GRIND SMOOTH PRIOR TO PAINT
- 01 CRTB 4" CONC. CART BUMPER - PROVIDE SAWN OR TOOLED JOINTS AT ALL CORNERS
- 02 STB TUBE STEEL - NOT USED
- 03 ROOF ACCESS LADDER
- 04 CG-ST PROVIDE AT ALL INSIDE AND OUTSIDE CORNERS OF UTILITY ROOM AND BACK ROOM
- 05 BLRD-2 10" Ø PIPE BOLLARD - SEE STRUCTURAL DWGS.
- 06A 3/8" x 4" x 12" w/ LLV BENT PLATE PALLET BUMPER: HOLD TIGHT TO WALL - TYP @ MEAT COOLER & RECALL SHELVING
- 06B REVERSE ANGLE PALLET BUMPER - HOLD TIGHT TO WALL
- 07 McCUE BUMPER GUARD - REFER TO INTERIOR ELEVATIONS FOR LOCATIONS; INSTALL PER MFR RECOMMENDATIONS; SEE SPEC.
- 08 WATER HEATER SHELF - SEE INT. ELEV. A1/A213
- 09 NOT USED
- 10 WALK OFF MAT, FULL SIZE OF ENTRY VESTIBULE. VENDOR QUOTE WILL BE PROVIDED BY ALDI CONSTRUCTION MANAGER DURING BID
- 11 6" THICK EQUIPMENT PAD - VERIFY SIZE W/ ELEC AND PLUMBING CONTRACTORS PRIOR TO INSTALLATION
- 12 HOLLOW METAL FRAMED "ONE WAY" TEMPERED WINDOW W/ REMOVABLE STOP ON SALES ROOM SIDE
- 13 CRT-RL CART RAILING - 6'-0" X 2'-11" HIGH REFER TO ELEVATIONS - COORD LAYOUT WITH ALDI CONSTRUCTION REPRESENTATIVE. NOT USED WITH CART WALL OPTION.
- 14 BLRD-3 3" GALVANIZED STEEL POSTS - CENTERED WITHIN ROWS. ATTACH OWNER PROVIDED STARTER CHAINS FOR CART SYSTEM - COORD LAYOUT WITH ALDI CONSTRUCTION REPRESENTATIVE
- 15 MOP BASIN - INSTALL BOTTOM OF BASIN @ FINISHED FLOOR ELEVATION

- 16 S5BR SEE DETAIL A2.C3/A511
- 17 ANODIZED ALUMINUM DOOR PROTECTORS (QUANTITY OF 4) COORD LOCATIONS WITH ALDI CONSTRUCTION REPRESENTATIVE. SEE SPECIFICATION SECTION 055000
- 18 PIPE RAILINGS
- 19 STAINLESS STEEL COLUMN COVERS TO 6'-0" A.F.F. - SEE DETAIL A3/A513
- 20 BLRD-4 SEE SECTION A1/A302
- 21 TR-1 TRASH RECEPTACLE - VERIFY LOCATION WITH OWNER'S REPRESENTATIVE
- 22 UPS SHELF. REFER TO INTERIOR ELEVATIONS FOR LOCATION C3/A513
- 23 FIRE EXTINGUISHER
- 24 FIRE & WATER SERVICE - SEE PLUMBING DWGS.
- 25 ROOF LEADER - SEE PLUMBING DRAWINGS

- 26 AC-5 HAND DRYER - PROVIDE 24" WIDE X 32" TALL X 1/16" THICK BRUSHED STAINLESS STEEL WALL GUARD WITH SATIN FINISH BELOW HAND DRYER. PROVIDE 1/2" RADIUS CORNERS ON WALL GUARD.
- 27 SALES FLOOR FLAT STEEL FOR MERCHANDISE GONDOLAS. COORD LOCATIONS WITH ALDI CONSTRUCTION REP. SEE SPEC. SECTION 055000; PT-3 / CL-5
- 28 HANGING SIGN FRAME - GRAPHIC INSERT PROVIDED BY OWNER. SEE DETAILS C2.D2/A602.
- 29 (4) HEAVY DUTY COAT HOOKS. REFER TO SPEC SECTION 102813 FOR ALL REQUIRED COAT HOOKS, SHELVES, HOOKS AND ROLLER SHADE REQUIREMENTS.
- 30 ROOF LEADER CLEAN-OUT ON EXTERIOR
- 31 HOSE BIB
- 32 REMOTE FIRE DEPARTMENT CONNECTION - SEE FIRE PROTECTION DWGS.
- 33 STRIPE AREA IN FRONT OF IMPACT DOORS, EGRESS DOOR, MANAGER'S DESK, AND ELEC PANELS PT-10/CL-4.
- 34 IMPACT DOORS & HARDWARE - SEE SPEC; INSTALL PER MFR'S WRITTEN INSTRUCTIONS.

- 35 BR FLOOR MOUNTED BUMPER RAIL - PRE-DRILL MOUNTING HOLES PRIOR TO INSTALLATION OF MULTIDECK UNITS. HOLD AS CLOSE AS POSSIBLE TO MULTIDECK UNITS - SEE SPEC; INSTALL PER MFR'S WRITTEN INSTRUCTIONS.
- 36 DOCK LEVELER AND SEAL - SEE SPEC; INSTALL PER MFR'S WRITTEN INSTRUCTIONS.
- 37 McCUE SECURITY RAILING - SEE SPEC; INSTALL PER MFR'S WRITTEN INSTRUCTIONS.
- 38 TRACK GUARDS - SEE SPEC; INSTALL PER MFR'S WRITTEN INSTRUCTIONS.
- 39 McCUE EQUIPMENT GUARDRAIL - SEE SPEC; INSTALL PER MFR'S WRITTEN INSTRUCTIONS.
- 40 AC-1 BABY CHANGING STATION
- 41 RECALL SHELVING - SEE A401 FOR ADDITIONAL INFORMATION
- 42 BR-C McCUE CARTSTOP UG150 12 - SEE SPEC; INSTALL PER MFR'S WRITTEN INSTRUCTIONS
- 43 WP-1 WOOD PANEL; INSTALL PER MFR'S WRITTEN INSTRUCTIONS

NUMBERS 50 THRU 69 ARE
 OWNER FURNISHED & CONTRACTOR INSTALLED -
 REFER TO APPENDIX 'A' OF THE PROJECT MANUAL

- 50 HANGING "NO PARKING" SIGN
- 51 CHECK OUT COUNTER WITH DUMP BIN - PARTIALLY ASSEMBLED
- 52 CHECKOUT COUNTERS - PARTIALLY ASSEMBLED
- 53 INTERIOR GRAPHICS & MILLWORK - TO BE INSTALLED PRIOR TO STORE TURNOVER TO OPERATIONS
- 54 COOLER/FREEZER RACKING SYSTEM
- 55 SAFE & SAFE CABINET. SEE DETAILS C1.B2/A513
- 56 LOCKERS
- 57 CABINETS & CASEWORK
- 58 COAT CLOSET
- 59 TABLE & CHAIRS

- 60 WALL MOUNTED SACKING COUNTER
- 61 CG-A INSTALL AT ALL INSIDE AND OUTSIDE CORNERS AT SALES AND HALL
- 62 POWER WALL - REFER TO ELECTRICAL DRAWINGS
- 63 SPOT MERCHANDISER
- 64 STAINLESS STEEL BASE PROTECTION ATTACHED TO SPOT MERCHANDISER FRAME
- 65 MERCHANDISING FIXTURES. GC TO PROVIDE (1) CARPENTER W/ TOOLS AND (2) LABORERS FOR TWO DAYS TO HELP INSTALL FIXTURES
- 66 BATTERY CHARGERS
- 67 BACK STOCK SHELVING. GC TO INSTALL
- 68 ALDI MIRROR

NUMBERS 70 THRU 99 ARE
 OWNER PROVIDED (Furnished & Installed) -
 REFER TO APPENDIX 'B' OF THE PROJECT MANUAL

- 70 WALK-IN COOLER
- 71 WALK-IN FREEZER
- 72 PALLET JACKS/STACKERS
- 73 FUTURE CHECKOUT
- 74 MULTIDECK UNIT
- 75 AUTOMATIC SLIDING DOORS WITH BREAKAWAY HINGED EMERGENCY EXIT
- 76 TIME CLOCK MOUNTING BRACKET
- 77 DUMPSTER
- 78 I.T. RACK
- 79 WALK-IN MEAT COOLER
- 80 SHOPPING CARTS
- 81 BALER
- 82 UNDER COUNTER PART SAFE
- 83 FLOOR SCRAPER
- 84 REFRERATOR COMPRESSOR
- 85 SOAP DISPENSER
- 86 TOILET TISSUE DISPENSER - SEE DRAWING 215
- 87 TRAC SYSTEM

Issued:	Date:
A Client Review Set	04/07/17
B Permit Set	04/07/17
C Bid Set	09/05/17
D	
Revisions:	Date:
1	
2	
3	
4	
5	
6	
7	
8	
9	

DO NOT SCALE PLANS
 Copying, Printing, Software and other processes required to produce these prints on stretch or shrink the actual paper or layout. Therefore, scaling of this drawing may be inaccurate. Contact us consultants with any need for additional dimensions or clarifications.

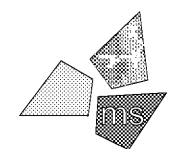

ms consultants, inc.
 engineers, architects, planners
 2221 Schrock Road
 Columbus, Ohio 43229-1547
 phone 614.898.7100
 fax 614.898.7570

DRAWN BY: MYG
 REVIEWED BY: MJB/CLR

Seal
 PROFESSIONAL OF RECORD:
 ERIC ELIZONDO No. 0401016074
 EXP. DATE: 06/30/2018

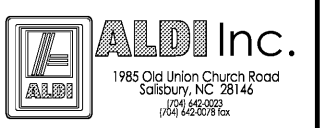

ALDI Inc. Store #: 161
 VA Beach Blvd & Thalia
 4220 Virginia Beach Blvd
 Virginia Beach, VA 23452
 Willis Wayside
 Project Name & Location:

Keyed Notes Plan	
Drawing Name:	
Prototype Rls. 02/08/17	Project No. 40320-40
Type: RHSD-V7	
Scale: As Noted	Drawing No. A-102

WWW.Online.com

Order Plans @

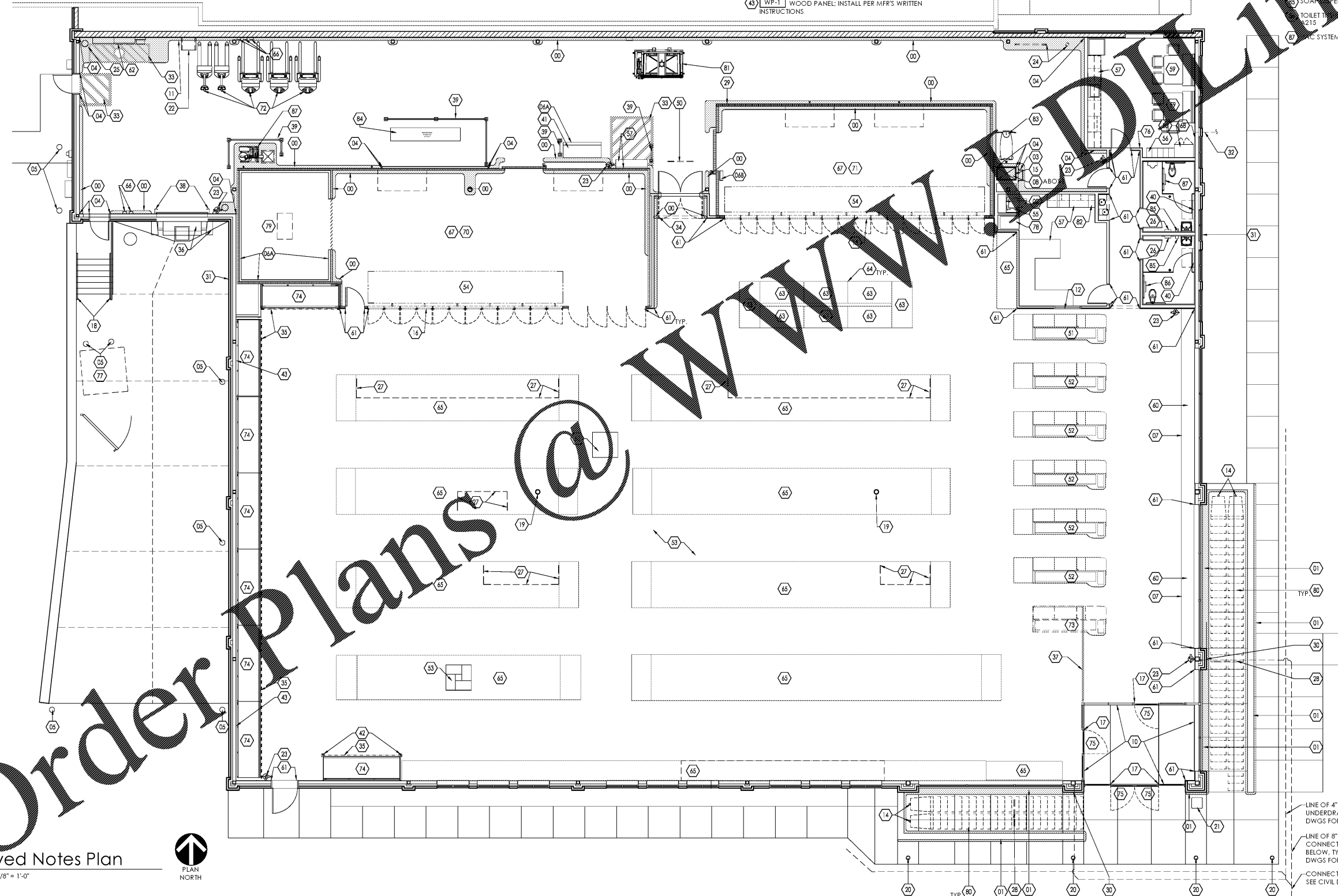

- NOTES:
- A. VERIFY INSTALLATION OF ALL OWNER FURNISHED ITEMS WITH OWNER'S REPRESENTATIVE.
 - B. REFER TO DRAWING A-603 FOR COLOR/ FINISH/ MATERIAL SCHEDULES.

LINE OF 4" PERFORATED UNDERDRAIN, TYP. SEE CIVIL DWGS FOR CONTINUATION
 LINE OF 8" DIA. DOWNSPOUT CONNECTION LOCATION BELOW, TYP. SEE CIVIL DWGS FOR CONTINUATION
 CONNECT TO STORM LINE. SEE CIVIL DRAWINGS

1 Keyed Notes Plan
 SCALE: 1/8" = 1'-0"



PLOTTED: 9/1/2017 1:14 PM